



# INSTALLATION INSTRUCTIONS

Accessory

**AUXILIARY LED  
LIGHTS**  
P/N 0SV41-HL3-A10

Application

**SXS700 M2/M4**

Publication No.

**MII 17775**

Issue Date

**August 2022**

**Honda Dealer: Please give a copy of these instructions to your customer.**

## PARTS LIST

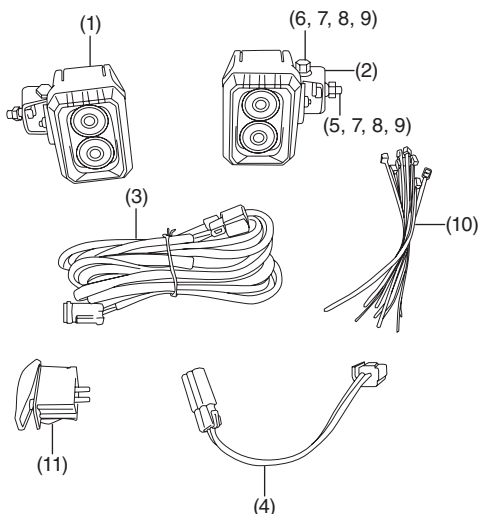

No.	Description	Qty
(1)	Auxiliary light	2
(2)	Auxiliary light mounts	2
(3)	Auxiliary light wire harness	1
(4)	Fuse box jumper harness	1
(5)	8 x 20 mm bolt	2
(6)	8 x 50 mm bolt	2
(7)	8 mm nut	4
(8)	8 mm lock washer	4
(9)	8 mm flat washer	4
(10)	Zip tie	10
(11)	Switch	1

## REQUIRED ACCESSORIES

The items below are required for the installation of this accessory.

### Fuse Box

Sold separately (P/N 0SS25-HL4-A00)

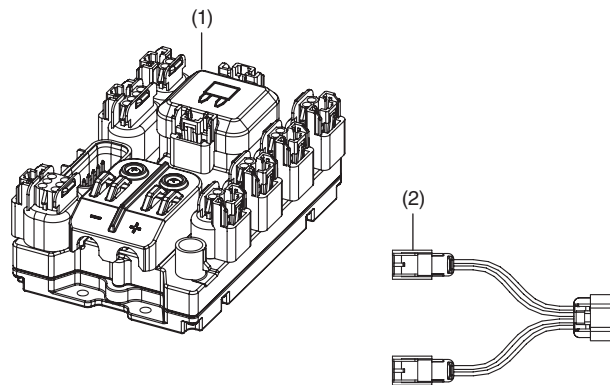

No.	Description	Qty.
(1)	Fuse box switcher	1
(2)	Harness, 4-pin to 2-pin (Y-splitter)	1

**Fuse Box Wiring Kit**  
**Sold separately (P/N 0SS26-HL3-A00)**

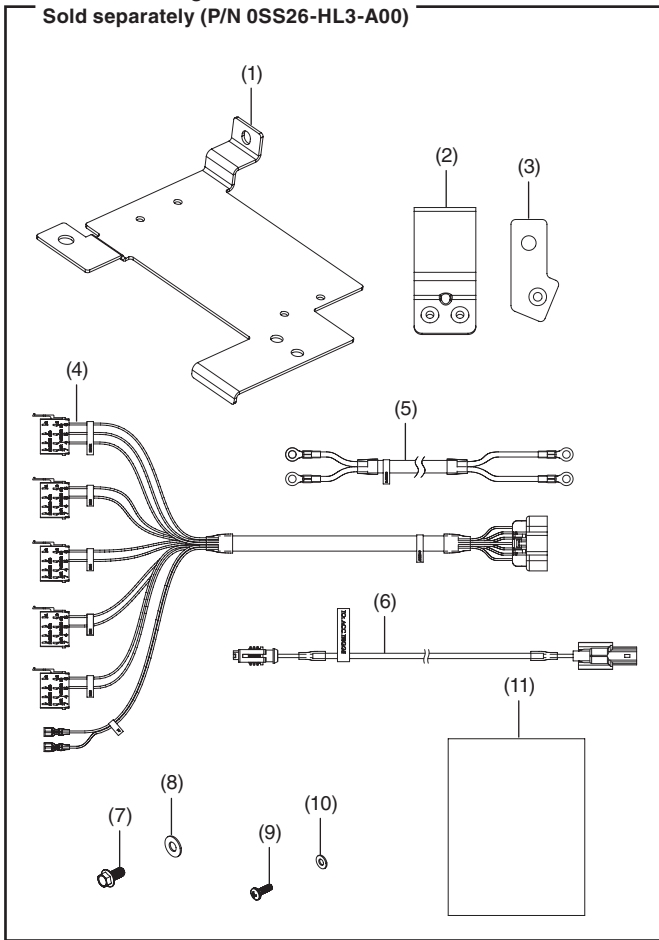

No.	Description	Qty
(1)	Fuse box mounting plate	1
(2)	Fuse plate, under bracket	1
(3)	Fuse plate, radiator tab bracket	1
(4)	Switch wiring harness	1
(5)	Input power cable	1
(6)	Accessory trigger cable	1
(7)	6 x 12 mm flange bolt	3
(8)	6 x 14 mm washer	3
(9)	4 x 0.7 screw	4
(10)	4 mm washer	4
(11)	Installation Instructions URL	1

**Bus Bar Kit**  
**Sold separately (P/N 0SS27-HL3-A00)**

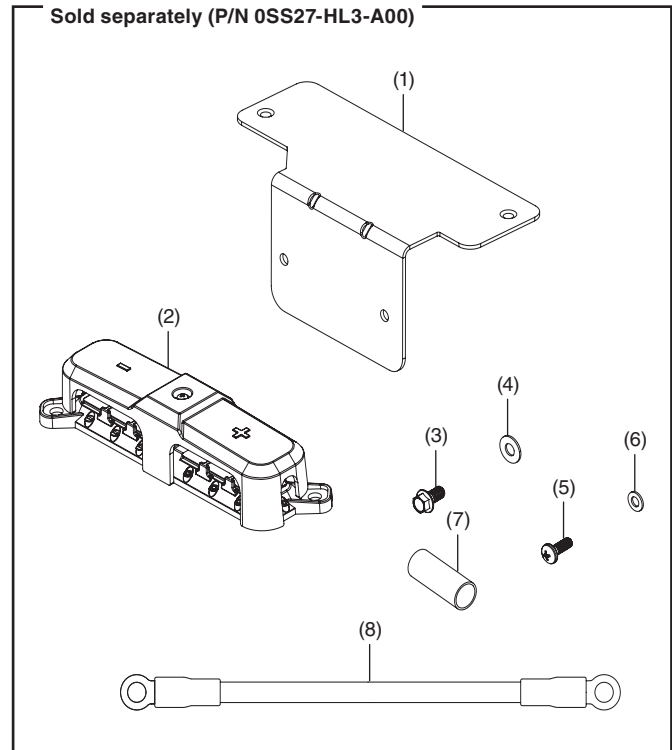

No.	Description	Qty
(1)	Bus bar mounting plate	1
(2)	Bus bar	1
(3)	6 x 12 mm flange bolt	1
(4)	6 x 14 mm washer	1
(5)	5 x 14 mm screw	1
(6)	5 x 10 mm washer	1
(7)	Heat shrink	1
(8)	Harness, #6 AWG ground cable (21'')	1

#### Optional Light Bar Aux. Clamp

Sold separately (P/N 0SV31-HL3-201A (38 mm))  
(P/N 0SV31-HL3-302A(41 mm))  
(P/N 0SV31-HL3-301B (44 mm))  
(P/N 0SV31-HL4-201A (45 mm))  
(P/N 0SV31-HL6-301A (51 mm))

Optional bar clamps are available for mounting this accessory to the cab frame or front bumper.

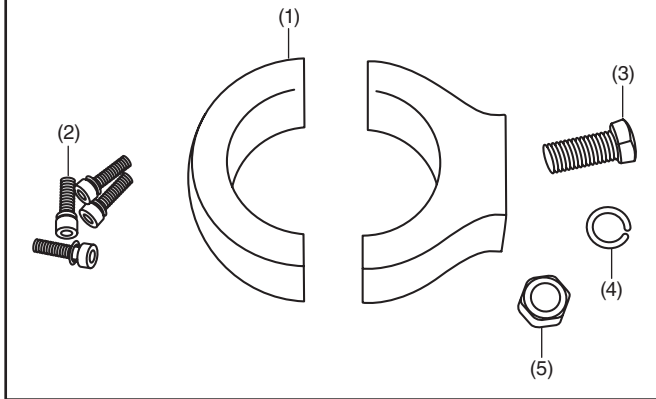

No.	Description	Qty
(1)	Clamp	1
(2)	Hex screw 4 × 10 mm	4
(3)	Bolt, 8 × 30 mm	1
(4)	Lock washer	1
(5)	Nut, 8 mm	1

## TOOLS AND SUPPLIES REQUIRED

End wrench 13 mm

Allen wrench 4 mm

Allen wrench 3 mm

## APPLICATION

Clamps can be used to mount the auxiliary lights to various tubular bar locations.

Vehicle	Part	Position	Clamp size
Pioneer 500/520	OPS frame	A-pillar/cross bar	41 mm
	OE bumper	Upper cross bar	38 mm
	Accessory bumper	Lower cross bar	38 mm
	Accessory bumper	Upper cross bar	44 mm
Pioneer 700 M2/M4	OPS frame	A-pillar/cross bar	41 mm
	OE bumper	Upper cross bar	38 mm
	Accessory bumper	Lower cross bar	38 mm
	Accessory bumper	Upper cross bar	44 mm
Pioneer 1000 M3/M5	OPS frame	A-pillar/cross bar	45 mm
	OE bumper	Upper cross bar	45 mm
	Accessory bumper	Lower cross bar	45 mm
	Accessory bumper	Upper cross bar	45 mm

## TORQUE CHARTS

Tighten all screws, bolts, and nuts to their specified torque values. Refer to the Service Manual for the torque values of the removed parts.

Item	N-m	kgf-m	lbf-ft
4 × 14 mm socket screw	2.8	0.3	2
8 × 20 mm bolt	24.5	2.5	18
8 × 50 mm bolt	10	1.2	7.4
6 × 10 mm set screw	7	0.7	5.2

## USE AND CARE INFORMATION

- Check the accessory mounts frequently and retighten if necessary.
- When this accessory becomes dirty, rinse it thoroughly with cool water to remove loose dirt, and then wash with warm, soapy water and a clean cloth or sponge. Do not use a brush to clean this accessory as it may scratch the surface.
- Never use petroleum solvents such as gasoline, thinner and benzine to clean this accessory. Also do not use acid or alkaline cleaners.

## INSTALLATION

1. Install all required accessories before starting installation.
2. Clamp  
Disassemble the clamp by unscrewing the allen screws with a 3 mm allen wrench.

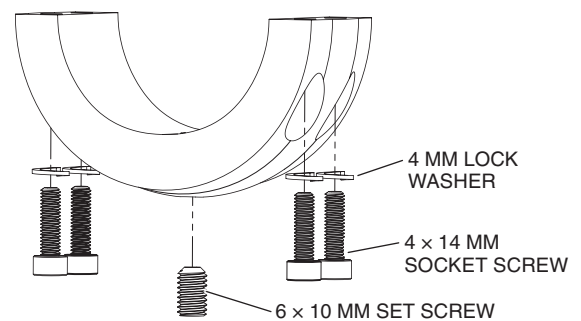
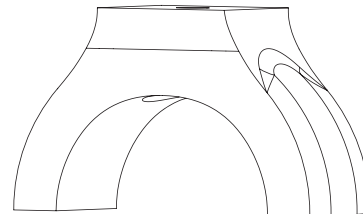

3. Mount light to clamp

Use the 8 × 20 mm bolt that is installed in the auxiliary light mount and screw it into the flat surface of the clamp. Do not fully tighten the bolt yet. Follow step 4, 5, or 6 depending on the mounting location.

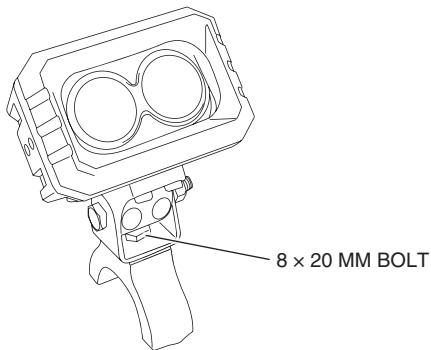

4. 41 mm clamp mounting

Mount the clamp to the cab frame where desired. Choose which way to mount the clamp, then tilt the light to achieve proper aim when mounted. Tighten the bolt on the light clamp.

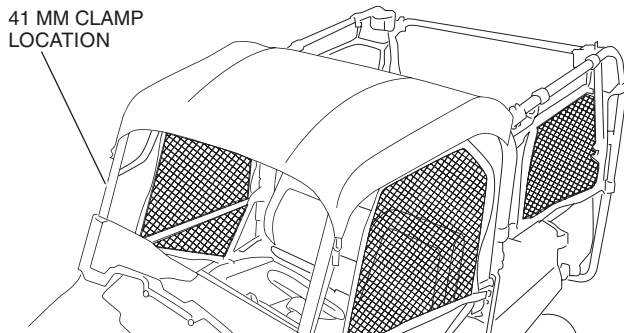

5. 38 mm clamp mounting

Mount the clamp to the front bumper cross bar. Rotate the clamp so that the light is leaning towards the grill at a 45 degree angle, then tilt the light forward to the desired adjustment. Tighten the bolt on the light clamp.

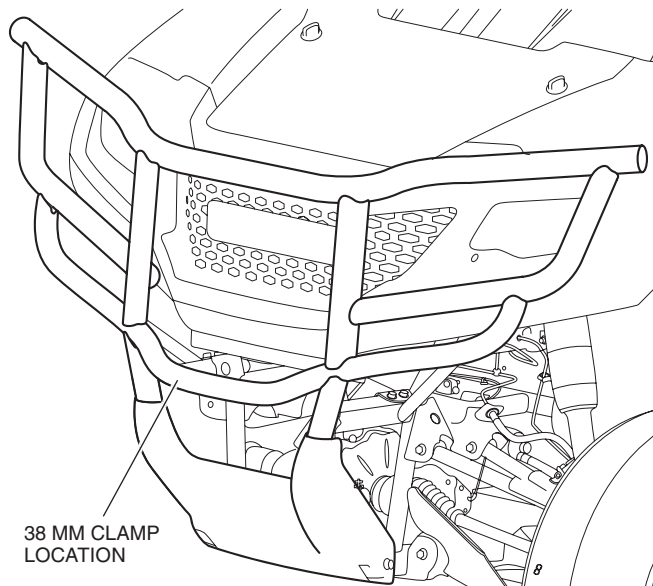
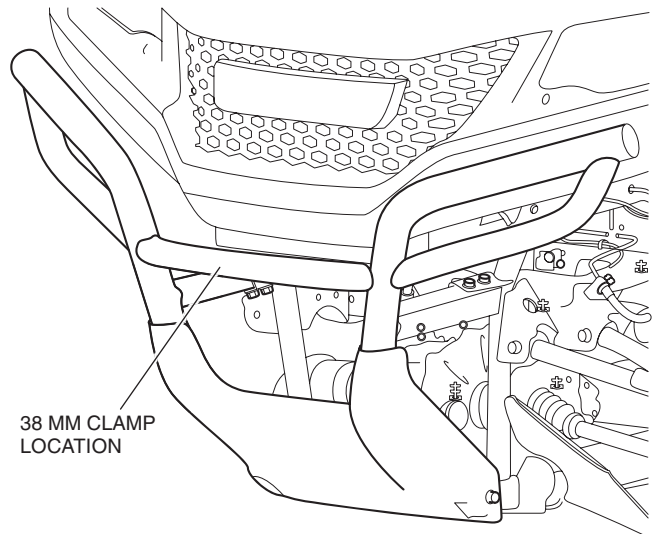

## 6. 44 mm clamp mounting

Mount the clamp to the front bumper upper cross bar (signature bumper only). Rotate the clamp so that the light is leaning towards the grill at a 45 degree angle, then tilt the light forward to desired adjustment. Tighten the bolt on the light clamp.

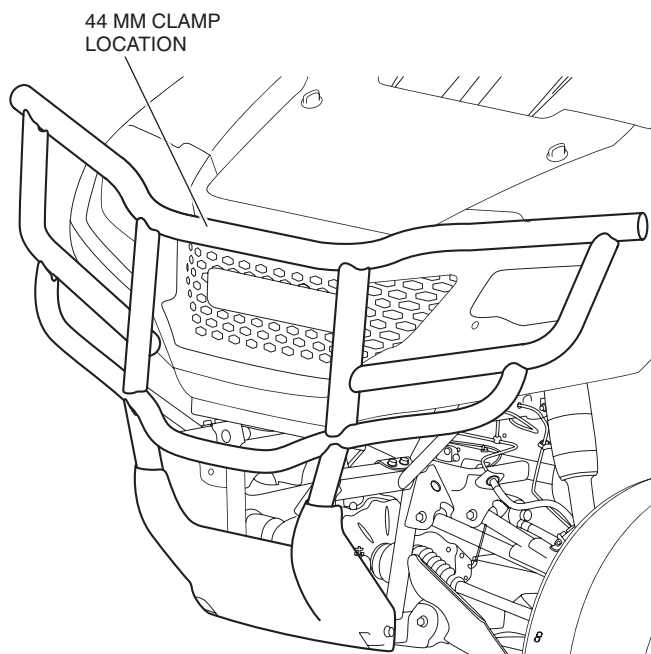

## 7. Clamp assembly

Once you have the tube clamp and light placed, first install the other half of the clamp with the socket bolts, then tighten the set screw to secure it to the tube.

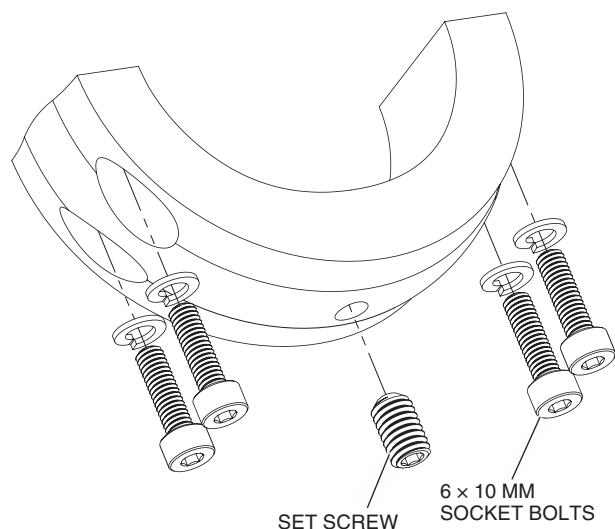

## ELECTRICAL CONNECTIONS

1. Route provided auxiliary light wire harness (3) to both of the lights and connect them.

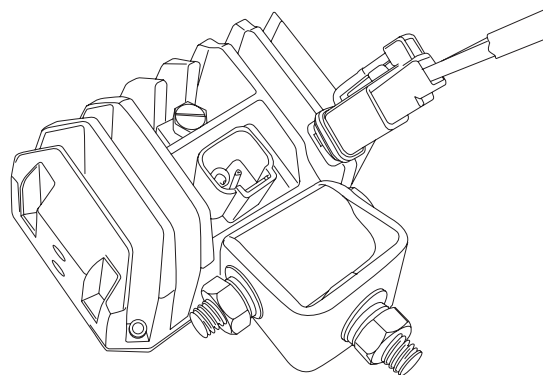

2. Using the provided zip ties, route the auxiliary light wire harness to the dashboard and into the auxiliary fuse box. Take care to ensure the wire harness does not interfere with any hot or moving parts.
3. Route the aux light wire harness to the auxiliary fuse box, remove the connector cap and connect it to one of the switch connectors of the fuse panel (SW3 or SW4). Use the fuse box jumper (4) for 2021 and older models.

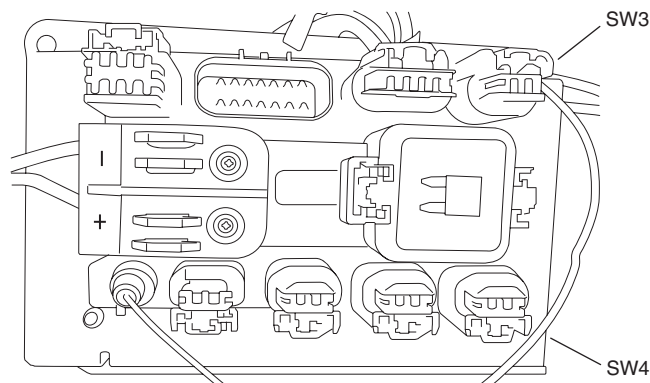

4. Install the provided switch (11) in the desired switch location. Connect the switch to the electrical connector with the same number (3 or 4) as the one you connected to on the fuse box.

**In dash Switch Locations shown. (Vehicle may have switch location in different areas. Consult your owner's manual & Accessories kits for your specific options)**

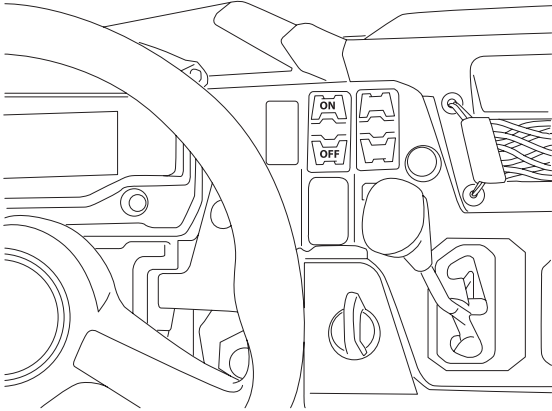

**Older Switch Panel image shown.**

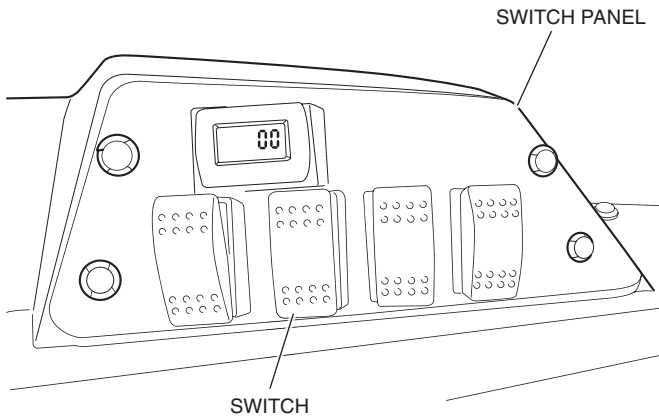

5. Use any remaining supplied zip ties to secure the wire harness away from any hot or moving parts.
6. With the vehicle powered on, turn on the auxiliary lights to confirm proper operation. Aim the beam pattern as desired and torque all fasteners.