



# INSTALLATION INSTRUCTIONS

Accessory

GLASS WINDSHIELD  
P/N 0SU95-HL3-A00

Application

SXS700M2/M4

Publication No.

MII 17775

Issue Date

July 2022

**Honda Dealer: Please give a copy of these instructions to your customer.**

## PARTS LIST

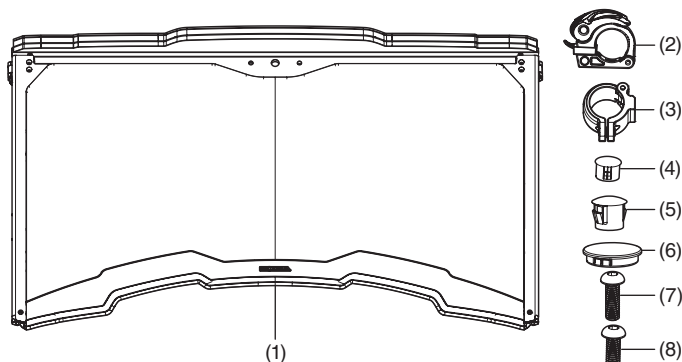

No.	Description	Qty
(1)	Windshield assembly	1
(2)	Upper cam lock	2
(3)	Lower cam lock	2
(4)	Small plug	2
(5)	Medium plug	4
(6)	Large plug	1
(7)	18 mm socket head bolt	4
(8)	16 mm socket head bolt	4

## TOOLS AND SUPPLIES REQUIRED

4 mm hex wrench

Torque wrench

## TORQUE CHART

Tighten all screws, bolts, and nuts to their specified tightening torque values. Refer to the Service Manual for the tightening torque values of the removed parts.

Item	N·m	kgf·m	lbf·ft
Bolt	5	0.5	4

## USE AND CARE INFORMATION

- Check the accessory mount frequently and retighten if necessary.
- Replace this accessory with a new one if it is damaged or discolored excessively.
- When this accessory becomes dirty, rinse it thoroughly with cool water to remove loose dirt, then wipe with a clean cloth or sponge.
- Do not use a brush to clean this accessory as it may scratch the surface.
- Never clean with or expose this accessory to petroleum solvents such as gasoline, thinner, benzene, acid, or alkaline cleaners.

## INSTALLATION

**NOTE:** If installing a complete hard cab, install this accessory before installing the roof and door kits. To save time, install the inner and outer strikers of the hard door kit before installing this accessory.

**NOTE:** Remove and discard the rubber shipping band from the upper cam locks before installation of this accessory.

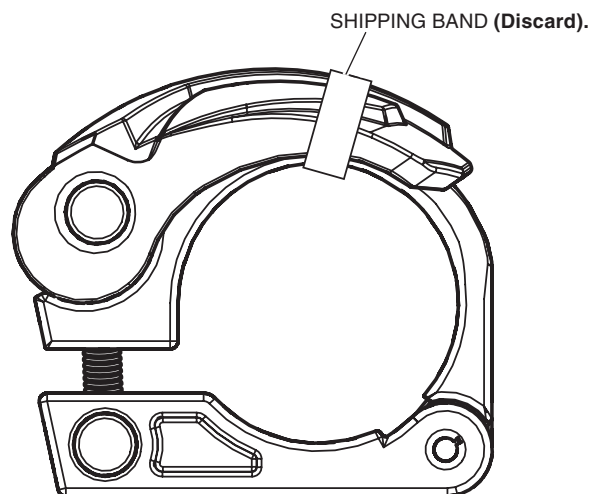

1. Fit the two lower cam locks around the front side bars of the OPS in the locations shown.

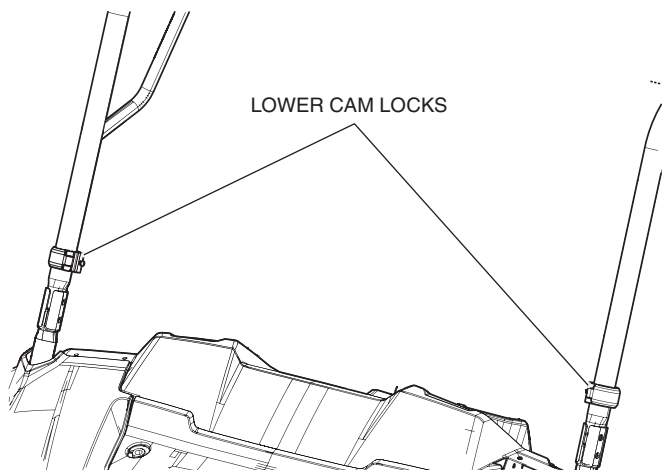

2. Loosely fasten the cam locks using one 16 mm socket head bolt each.

**Note:** Lightly tighten the bolts at this time. The cam lock should be free to rotate and slide up and down.

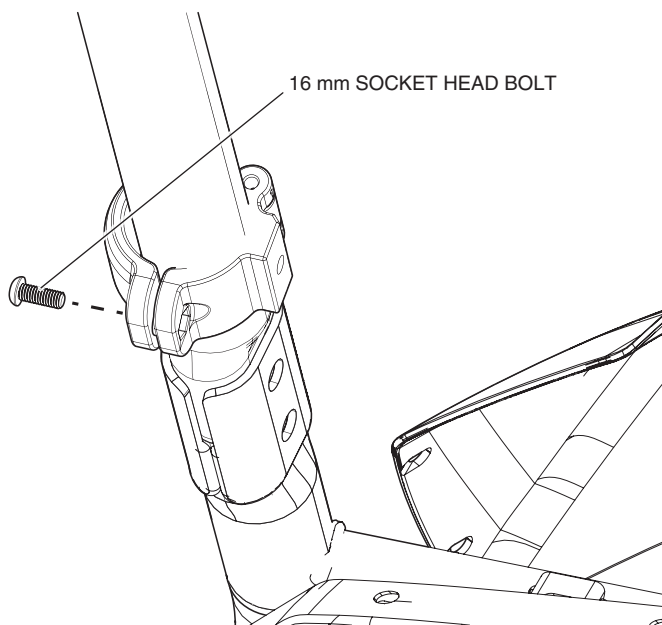

3. Fasten the upper cam locks to the upper corners of the windshield using two 18 mm socket head bolts each as shown.

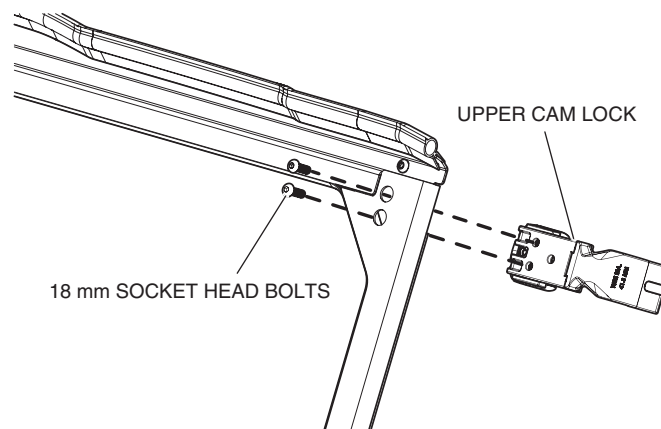

4. Open the upper cam locks.

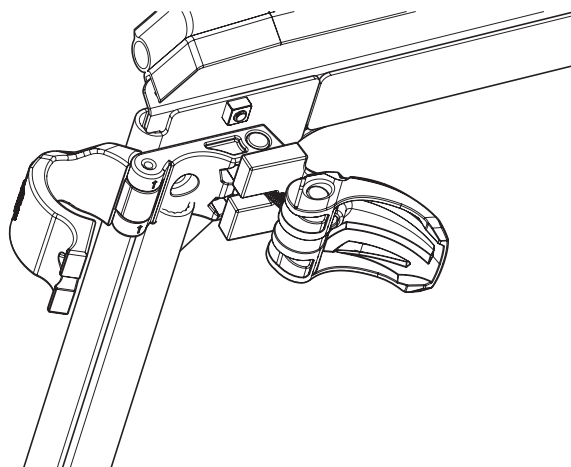

5. Place the windshield onto the front OPS and fit the upper cam locks over the side bars of the OPS.

**Note:** Lightly tighten the upper cam locks at this time. The windshield assembly should be free to slide up and down the OPS.

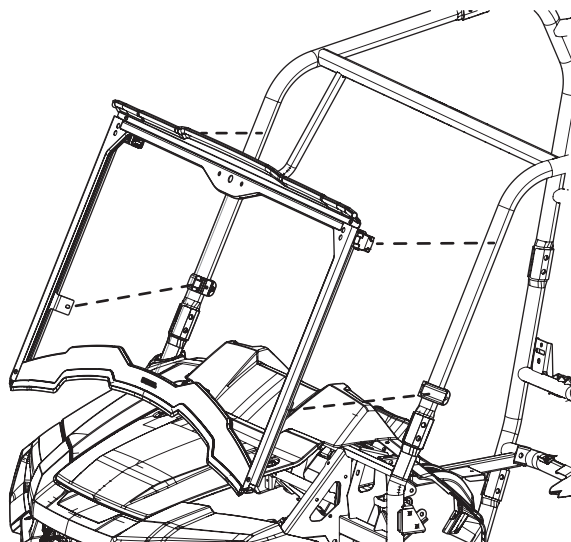

6. Move the windshield up or down until the bottom of the windshield assembly fits securely to the vehicle hood as shown.

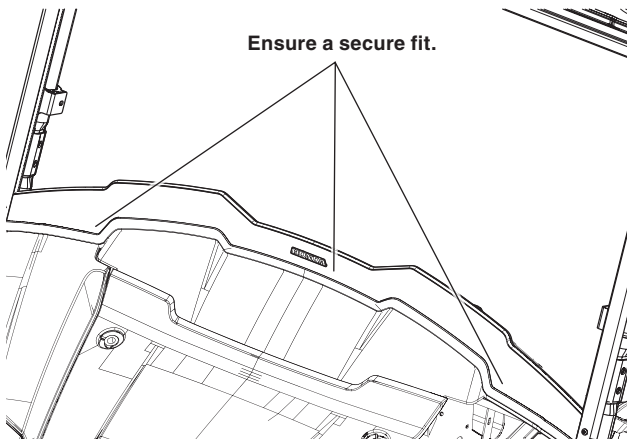

7. Move the two lower cam locks till they are flush with the windshield brackets and fasten using one 16 mm socket head bolt each.

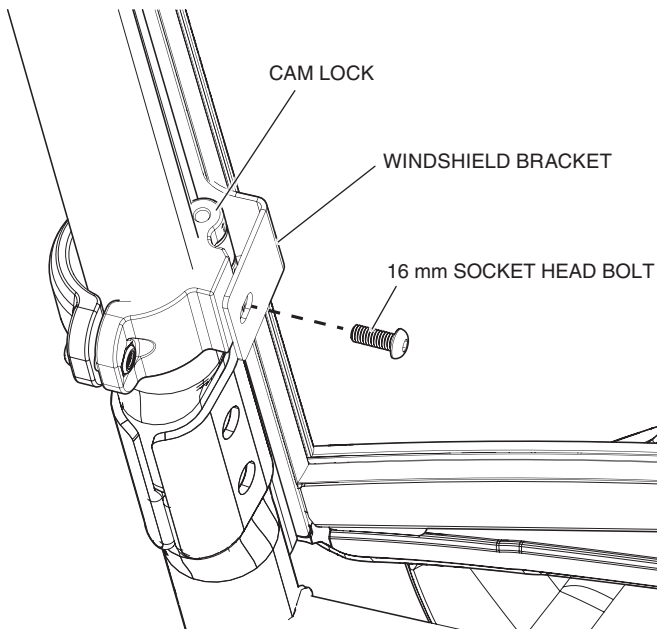

8. Tighten all four cam locks to secure the windshield into position.  
9. Insert the four small plugs into the upper cam lock bolt holes on the windshield.

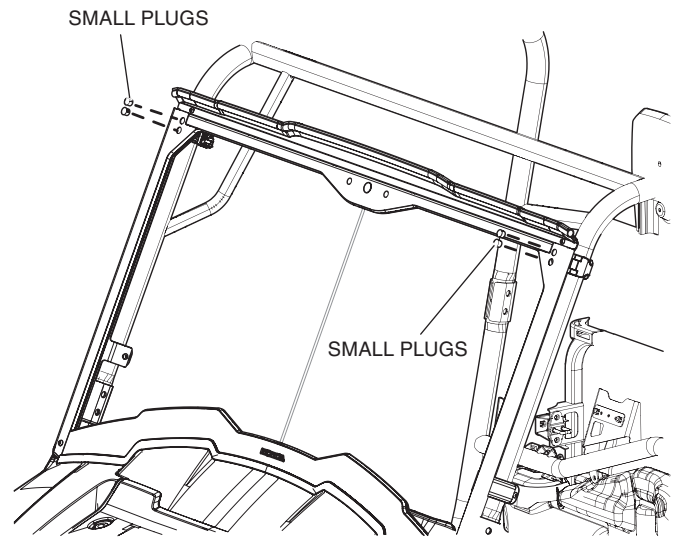

## IF NOT USING WASHER/WIPER KIT

10. Insert two medium plugs and one large plug into the center holes on the windshield. If using a washer/wiper kit leave these plugs out, as these holes are used for the washer/wiper.

