



INSTALLATION INSTRUCTIONS

Accessory

40 INCH LED LIGHT BAR
P/N 0SV31-HL6-A10

Application

SXS1000S2X/S2XD/S2R/
S2RD/S4X/S4XD

Publication No.

MII 17811

Issue Date

May 2022

Honda Dealer: Please give a copy of these instructions to your customer.

PARTS LIST

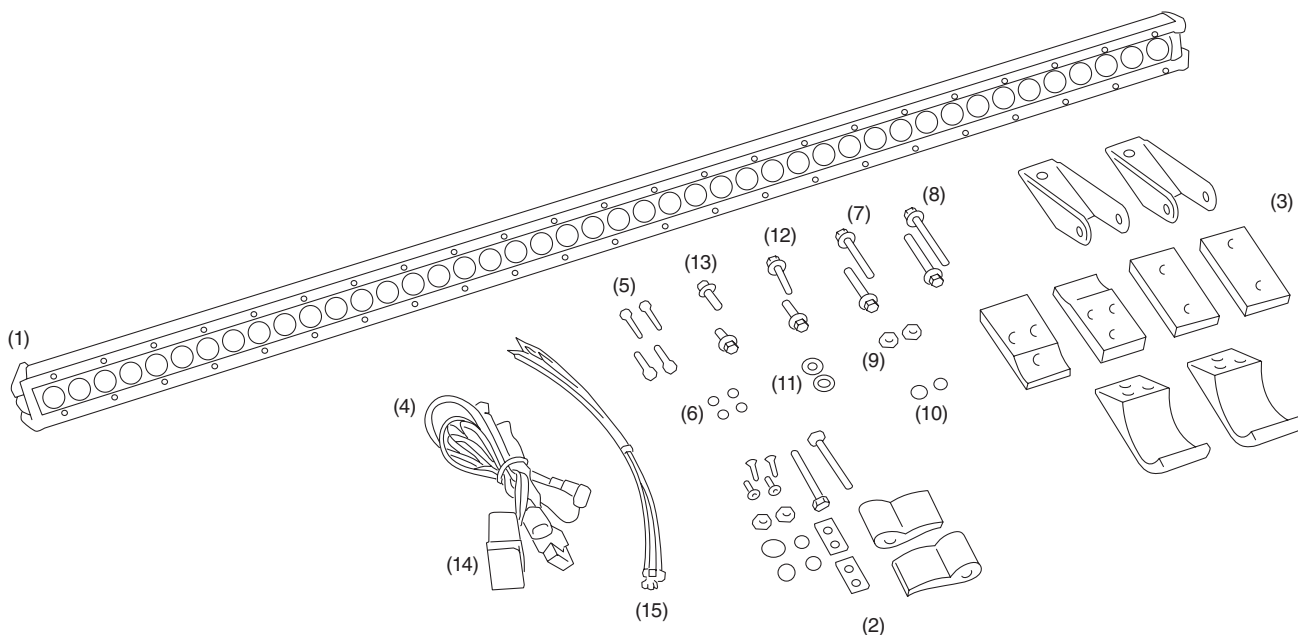

No.	Description	Qty
(1)	40 Inch light bar	1
(2)	Light bar mounts	2
(3)	Light bar tube clamp assembly	2
(4)	Light bar wire harness	1
(5)	M6 × 22 mm Cap head screw	4
(6)	M6 Lock washer	4
(7)	M8 × 40 mm Flanged bolt	2
(8)	M8 × 50 mm Flanged bolt	2
(9)	M8 Nut	2
(10)	M8 Lock washer	2
(11)	M8 Flat washer	2
(12)	M8 × 15 mm Flanged bolt	2
(13)	M8 × 25 mm Flanged bolt	2
(14)	Switch	1
(15)	Zip tie	12

REQUIRED ACCESSORIES

The items below are required for the installation of this accessory.

Fuse Box
Sold separately (P/N 0SS25-HL4-A00)

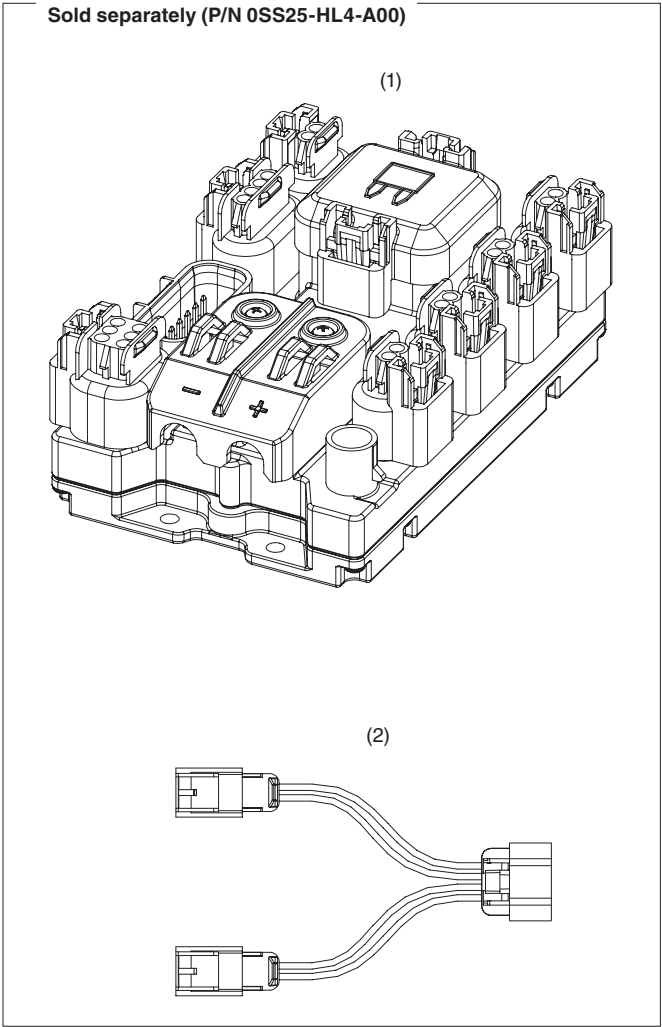

No.	Description	Qty
(1)	Fuse box switcher	1
(2)	Harness, 4-pin to 2-pin (Y-splitter)	1

Busbar
Sold separately (P/N 0SS27-HL6-A00)

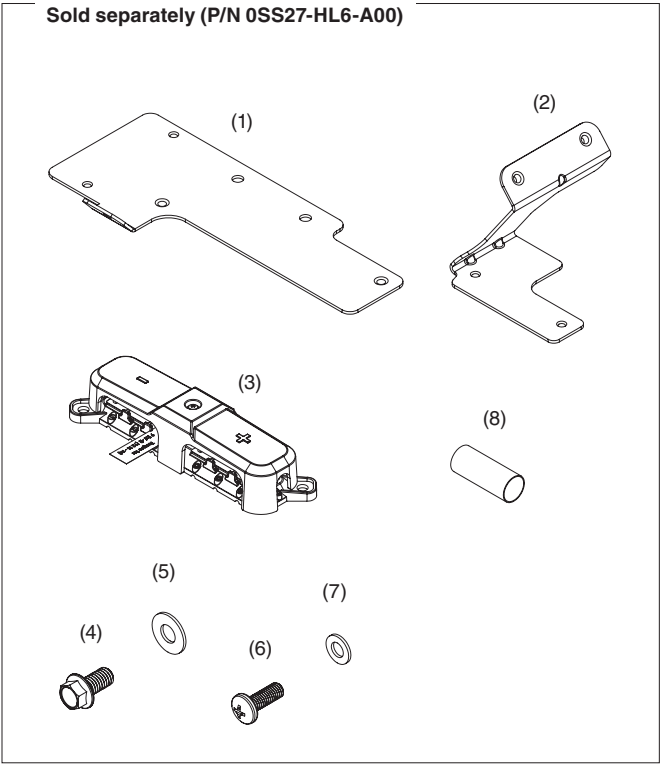

No.	Description	Qty
(1)	Main busbar mounting plate	1
(2)	Busbar lower support bracket	1
(3)	Busbar	1
(4)	M6 × 12 mm flange screw (8 mm head)	4
(5)	M6 × 14 mm flat washer	4
(6)	Phillips pan-head screw M5 × 14 mm	2
(7)	M5 × 10 mm flat washer	2
(8)	Heat shrink	2

Fuse Box Mount Kit
Sold separately (P/N OSS26-HL6-A00)

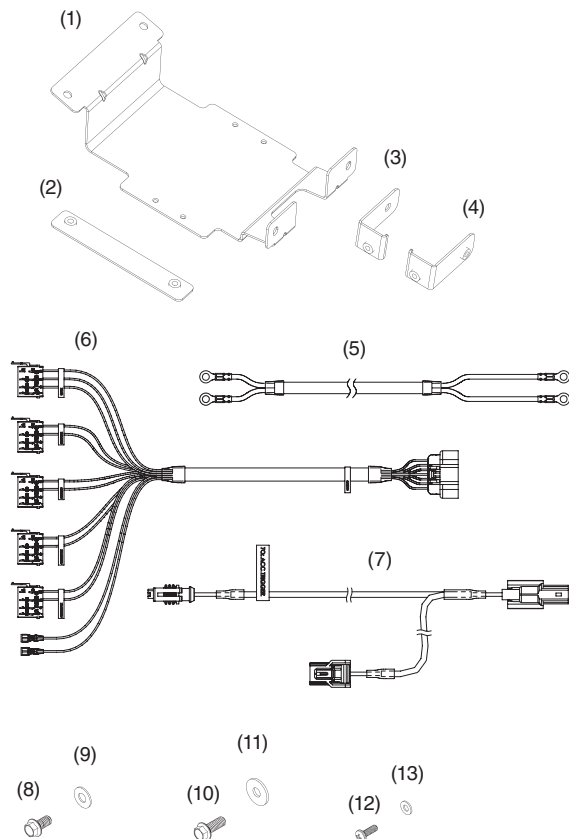

No.	Description	Qty
(1)	Fuse box mounting plate	1
(2)	Front under bracket	1
(3)	Driver side L-bracket	1
(4)	Passenger side L-bracket	1
(5)	Input power cables	1
(6)	Switch wiring harness	1
(7)	Accessory trigger cable	1
(8)	8 mm hex head M6 flange screw, 12 mm long	4
(9)	M6 flat washer, 14 mm o.d.	4
(10)	8 mm hex head M6 flange screw, 16 mm long	2
(11)	M6 flat washer, 18 mm o.d.	2
(12)	M4 x 0.7 phillips screw, 12 mm long	4
(13)	M4 flat washer	4

TOOLS AND SUPPLIES REQUIRED

End wrench 13 mm

Allen wrench 4 mm

Allen wrench 3 mm

TORQUE CHART

Tighten all screws, bolts, and nuts to their specified torque values. Refer to the Service Manual for the torque values of the removed parts.

Item	N-m	kgf-m	lbf-ft
6 x 22 mm Socket screw	10	1.2	7.4
M8 Bolt	24.5	2.5	18

USE AND CARE INFORMATION

- Check the accessory mounts frequently and retighten if necessary.
- When this accessory becomes dirty, rinse it thoroughly with cool water to remove loose dirt, and then wash with warm, soapy water and a clean cloth or sponge. Do not use a brush to clean this accessory as it may scratch the surface.
- Never use petroleum solvents such as gasoline, thinner and benzine to clean this accessory. Also do not use acid or alkaline cleaners.

INSTALLATION

NOTE: Light bar tube clamp assembly

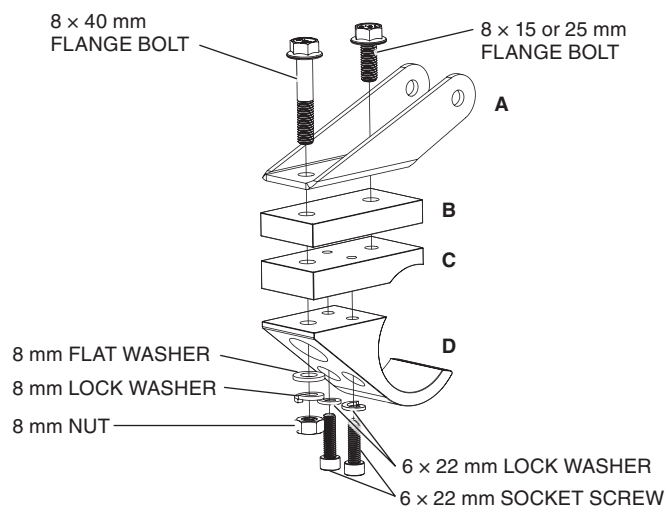

1. Install all required accessories before starting installation.
2. Measure 13.5" from the center mount of the roof to the inside of "C".

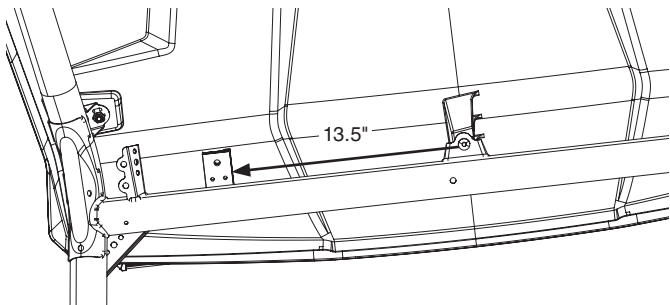

3. With the top of "C" against the underside of the roof, mark the roof through the hole. (It maybe helpful to have "B" on top of "C" to take up the gap)
Remove mount "C" and use the 21/64" drill bit to drill through the marked hole on the roof. Do this for the left and right side.

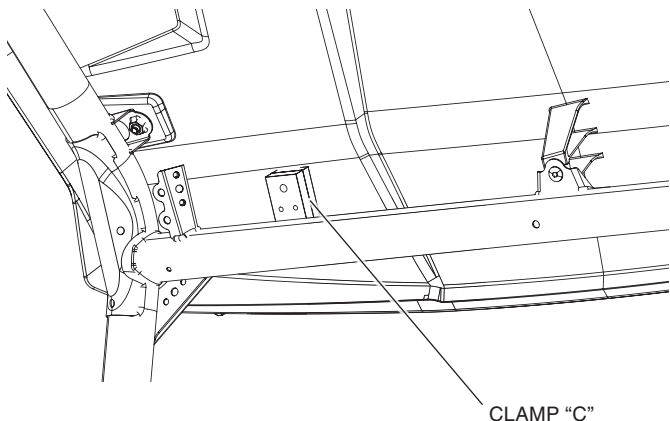

4. On the top side of the roof, line up the back hole of "A" with the hole that was drilled in Step 2.
Make sure "A" is centered over mount "C".
Mark the front hole of "A" and drill through the roof with the 21/64" drill bit.

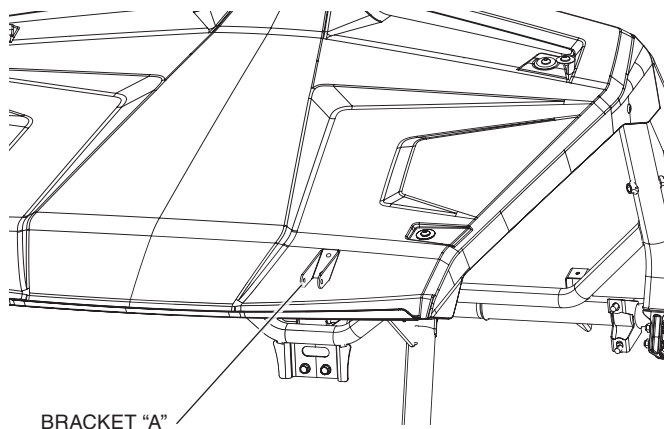

5. Use the supplied hardware to bolt the clamp assembly together. Piece "B" is a spacer only to be used with the stock roof (If using the aluminum roof do not use piece "B". The roof will be sandwiched between pieces "A" and "B" (or pieces "A" and "C" if using the aluminum roof).

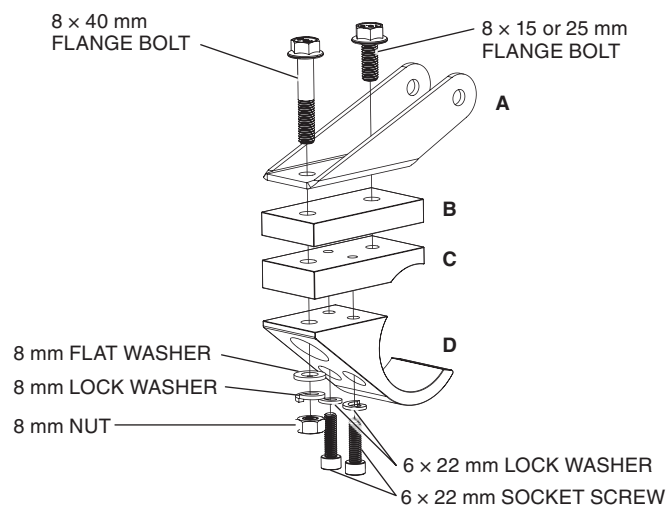

6. Loosely install the bottom mounts onto the light bar 7 inches inboard from from each end of the the light bar.

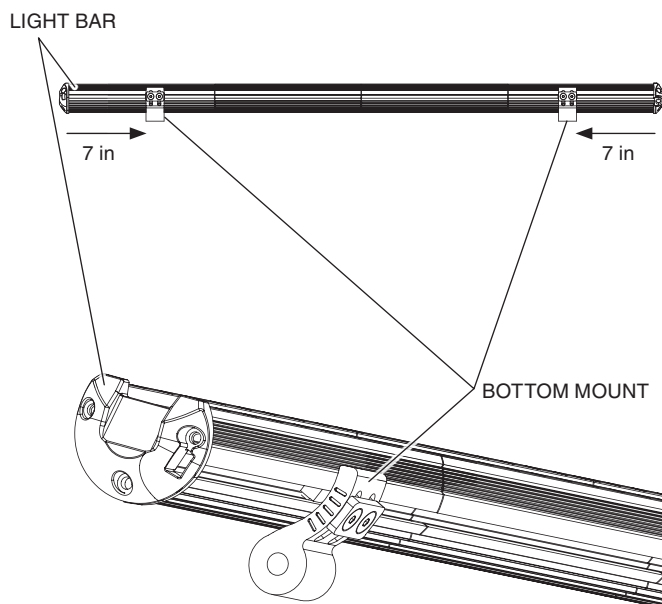

7. Use the hardware supplied to mount the light bar to the brackets "A".

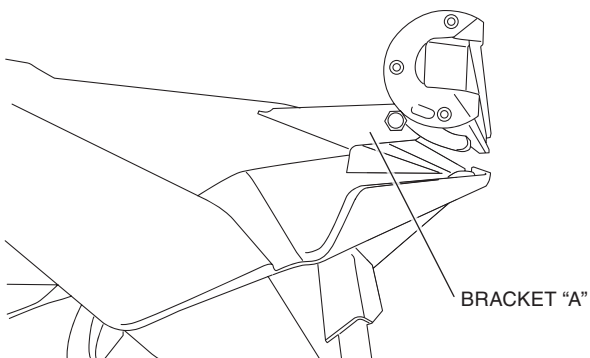

8. Route the wire from the light bar down the A pillar. Use the supplied zip ties to secure it.

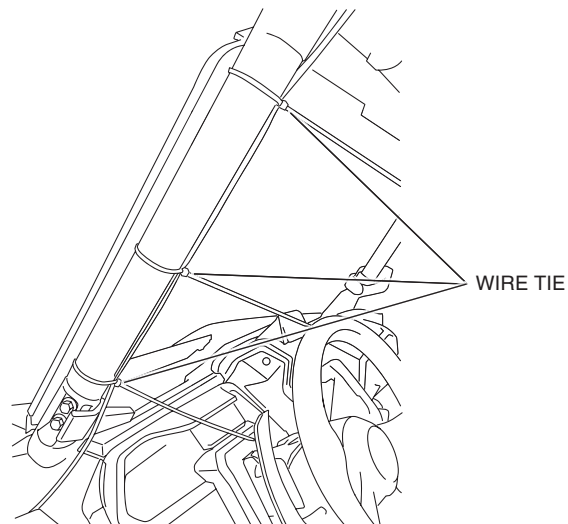

9. Route the wire through the gap in the body that the A pillar goes through.

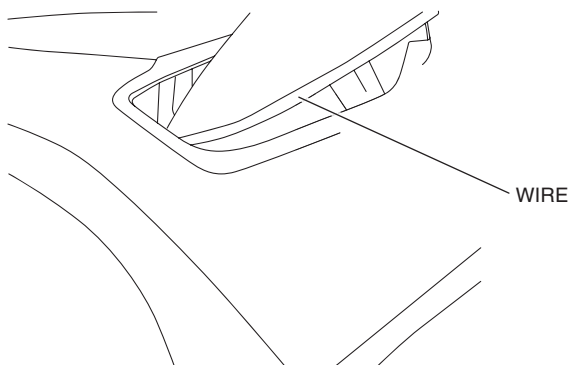

10. Remove the hood and pull back the rubber guard so you can access the back of the instrument panel. (The Fuse Box is not shown in image.)

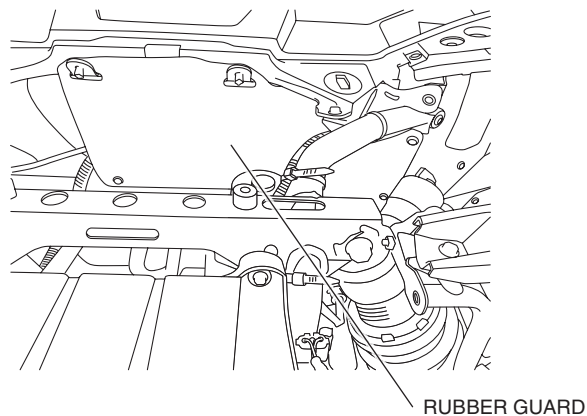

11. Connect the supplied harness to an open power connector on the fuse box. Make sure the load on that fuse is not more than the rated fuse size.

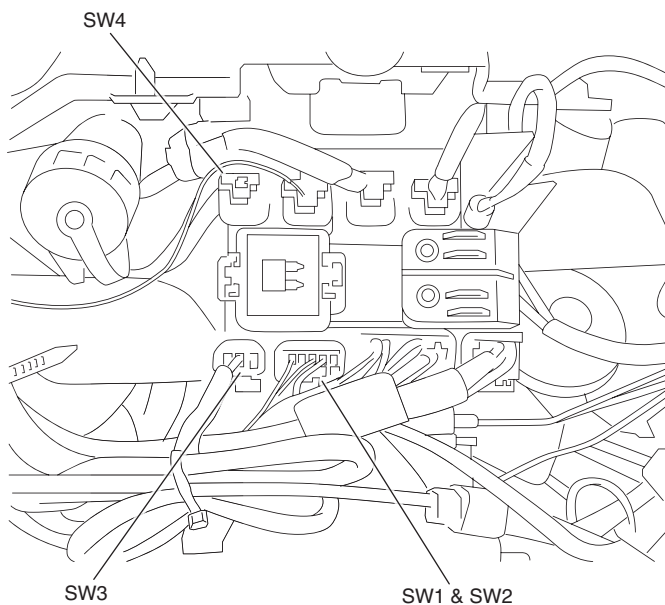

12. Remove the Switch Blank. Use care to not damage, as they need to be used again.

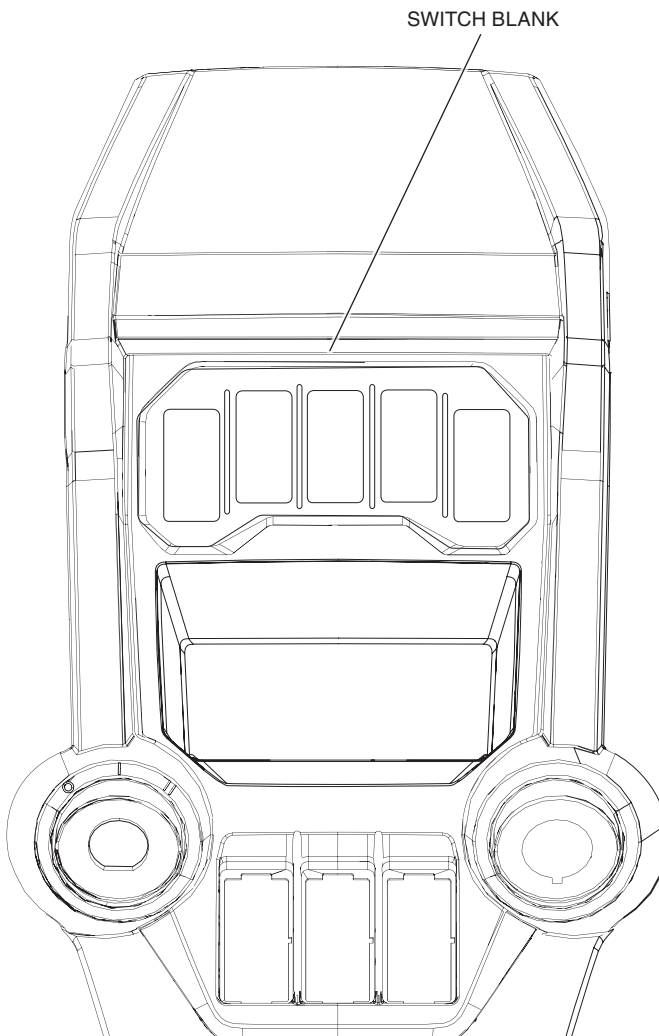

13. Route corresponding SW connector (used for fuse box connection) through blank and connect to switch. Fit the Light Bar switch into the open slot. (See Fuse Box Mount Kit Installation Instructions for details)

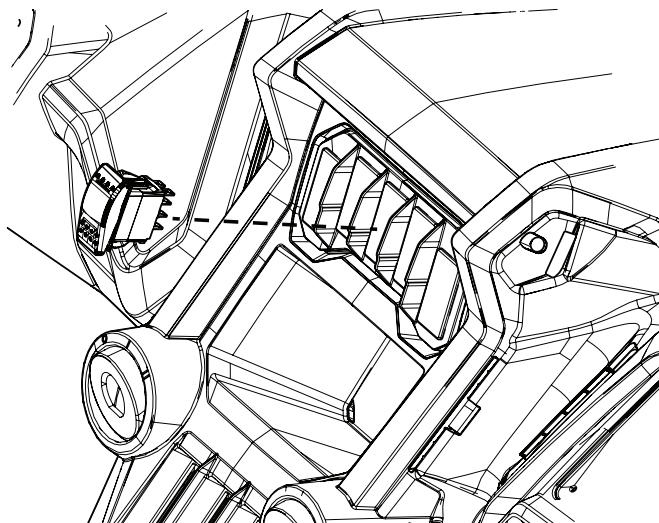

14. Aim lights and tighten bolts.
15. Use the supplied zip ties to secure the wire harness away from any hot or moving parts.
16. Reinstall the rubber guard and hood.