



INSTALLATION INSTRUCTIONS

Accessory

POWERED SUBWOOFER
P/N 0SS22-HL6-A50

Application

**SXS1000S2X/S2XD/S2R/
S2RD/S4X/S4XD**

Publication No.

MII 17811

Issue Date

May 2022

Honda Dealer: Please give a copy of these instructions to your customer.

PARTS LIST

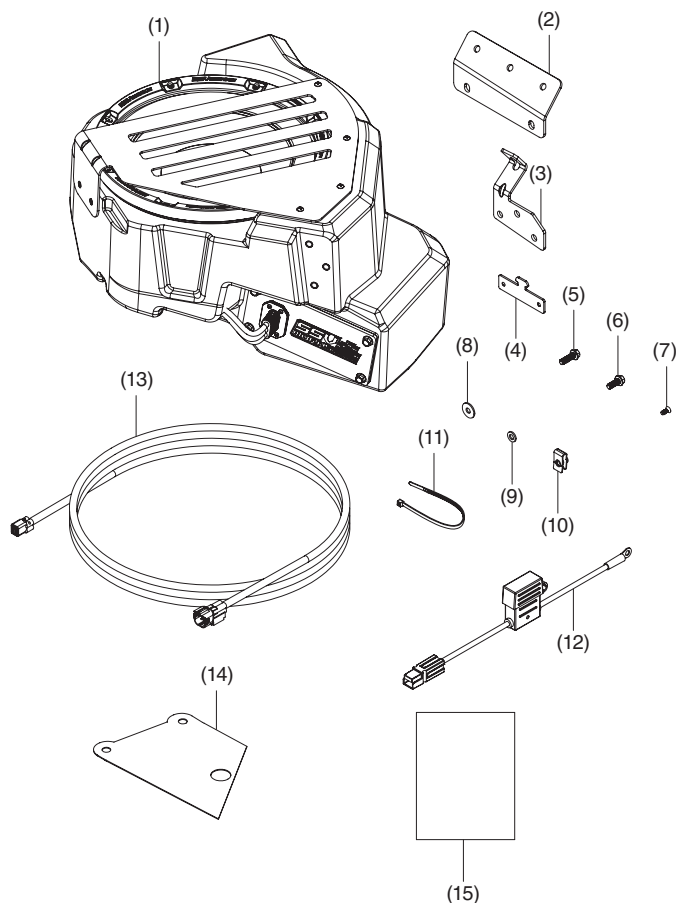

No.	Description	Qty
(1)	Powered subwoofer enclosure	1
(2)	Upper bracket	1
(3)	Bottom bracket	1
(4)	Cable bracket	2
(5)	M6 × 20 mm, hex head flange screw	2
(6)	M6 × 16 mm, hex head flange screw	9
(7)	M4 × 10 mm, flat head phillips screw	4
(8)	Large, M6 flat washer	2
(9)	Small, M6 flat washer	9
(10)	M6 u-nut	2

No.	Description	Qty
(11)	10" zip ties, black	5
(12)	In-line fuse holder	1
(13)	Subwoofer extension harness	1
(14)	Subwoofer wire drill template	1
(15)	Installation Instructions URL	1

REQUIRED ACCESSORIES

The items below are required for the installation of this accessory.

Busbar

Sold separately (P/N 0SS27-HL6-A00)

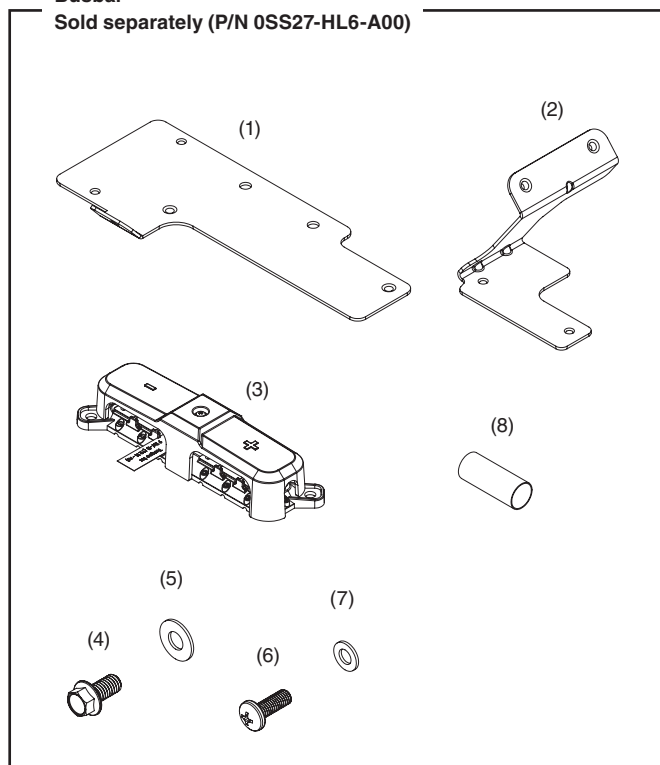

No.	Description	Qty
(1)	Main busbar mounting plate	1
(2)	Busbar lower support bracket	1
(3)	Busbar	1
(4)	M6 × 12 mm flange screw (8 mm head)	4
(5)	M6 × 14 mm flat washer	4
(6)	Phillips pan-head screw M5 × 14 mm	2
(7)	M5 × 10 mm flat washer	2
(8)	Heat shrink	2

Audio System

Sold separately (P/N 0SS22-HL6-A00)

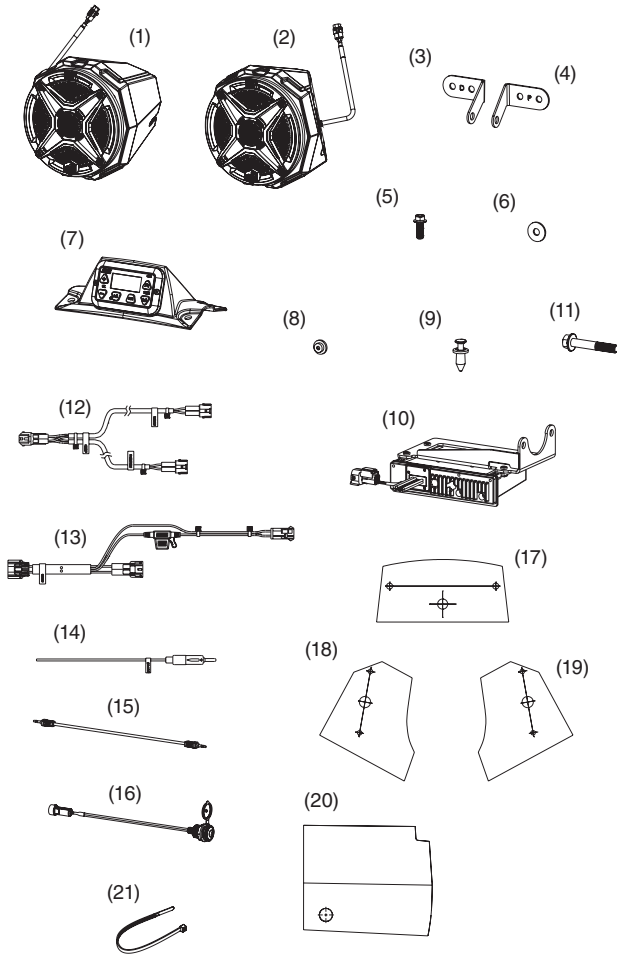

No.	Description	Qty
(1)	Driver Side Speaker Pod	1
(2)	Passenger Side Speaker Pod	1
(3)	Driver Side Speaker Pod Bracket	1
(4)	Passenger Side Speaker Pod Bracket	1
(5)	8 mm Flange Bolt	8
(6)	Washer	8
(7)	Radio Controller w/ Dash Kit	1
(8)	1/8 in Drill guide	4
(9)	Trim Clips	4
(10)	Radio MCU w/ Mounting Bracket	1
(11)	12 mm Flange Bolt	2
(12)	Speaker Harness	1
(13)	Radio Power Harness	1
(14)	Antenna Cable	1
(15)	3.5 mm Aux Cable	1
(16)	Aux In Socket	1
(17)	Radio Controller Cable Drill Template	1

No.	Description	Qty
(18)	Driver Speaker Enclosure Drill Template	1
(19)	Passenger Speaker Enclosure Drill Template	1
(20)	Aux In Socket Drill Template	1
(21)	8 in Zip Ties	10

TOOLS AND SUPPLIES REQUIRED

Drill

Drill bit (5/16")

Torque wrench/driver

Allen bit (4 mm)

Socket (6 mm for 3-passenger models)

Socket (8 mm)

Trim clip removal tool

Tape

Blue liquid threadlocker

TORQUE CHART

Item	N·m	kgf·m	lbf·ft
8 mm flange screw (M6 thread)	7.8	0.8	5.8
4 mm allen screw (M4 thread)	2.5	0.3	2.0

INSTALLATION

1. Install all required accessories before starting installation.
2. Refer to the vehicle service manual and remove the following parts:
 - Hood
 - Ground Cable connection to battery
 - Glove Box Removal
3. Remove the 5 trim clips from the outer body panel located on the passenger side inner fender.

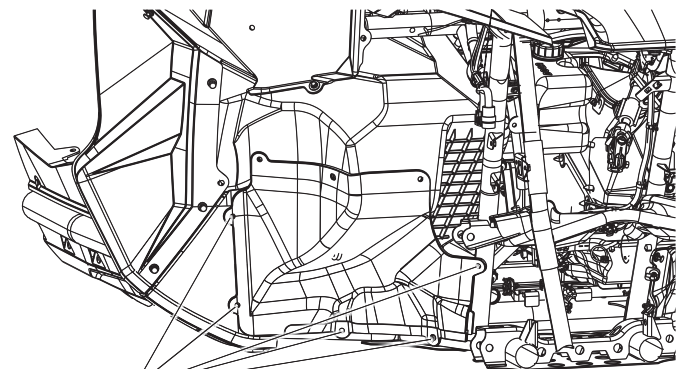

PANEL CLIPS

4. Remove the 3 trim clips shown from the passenger side floorboard area.

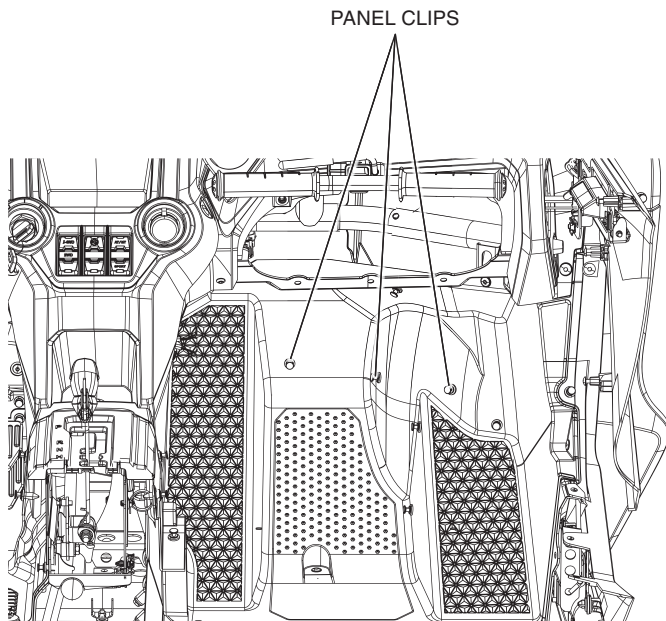

5. Remove the outer body panel from passenger side fender and set it side.

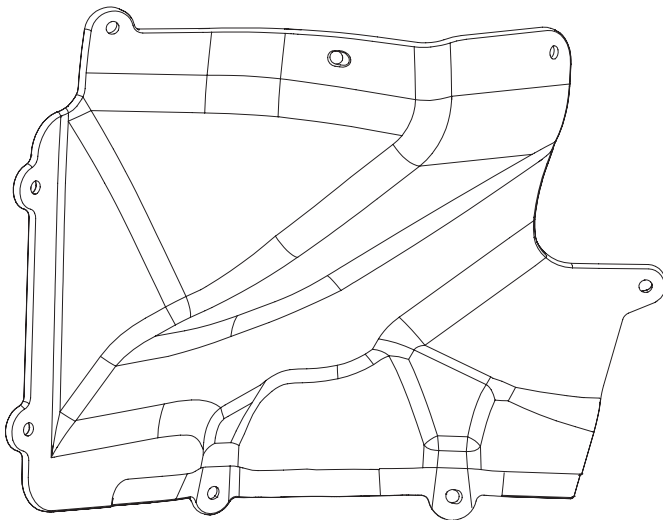

6. Remove the factory M6 Allen head bolt from the passenger side floorboard foot area.

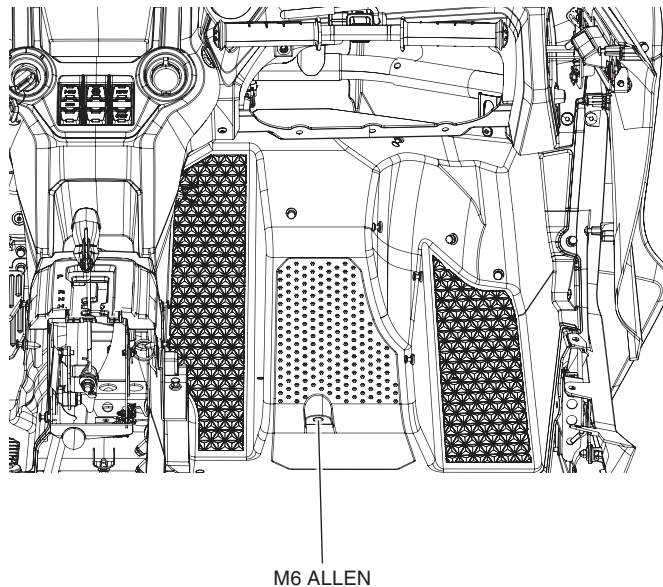

7. Slide the 2 supplied u-nuts over the left panel clip holes used to mount the glove box as shown.

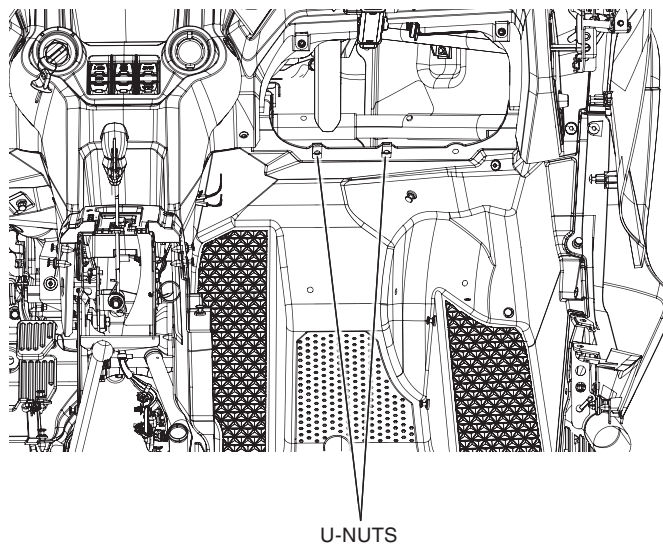

8. Align the included Subwoofer Drill Template with the two right panel clip holes. Lay flatly and Drill a 7/8" hole.

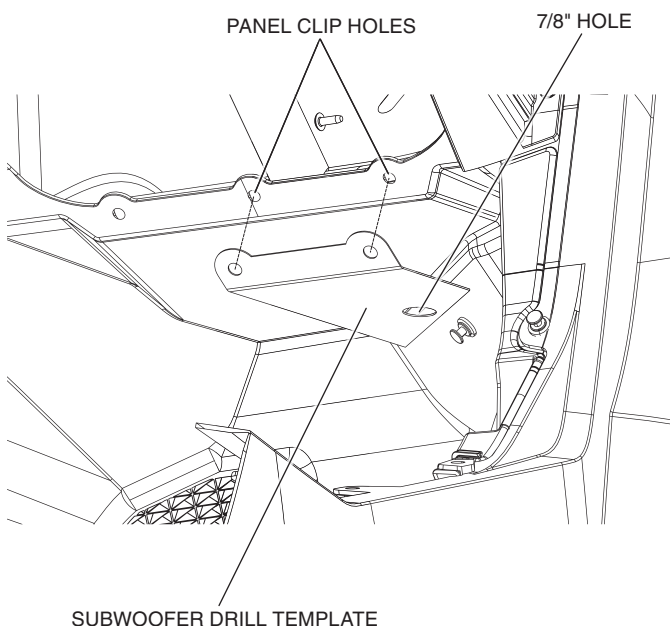

9. Attach the supplied Subwoofer Extension Harness to the subwoofer input cable coming out of the Subwoofer Enclosure.

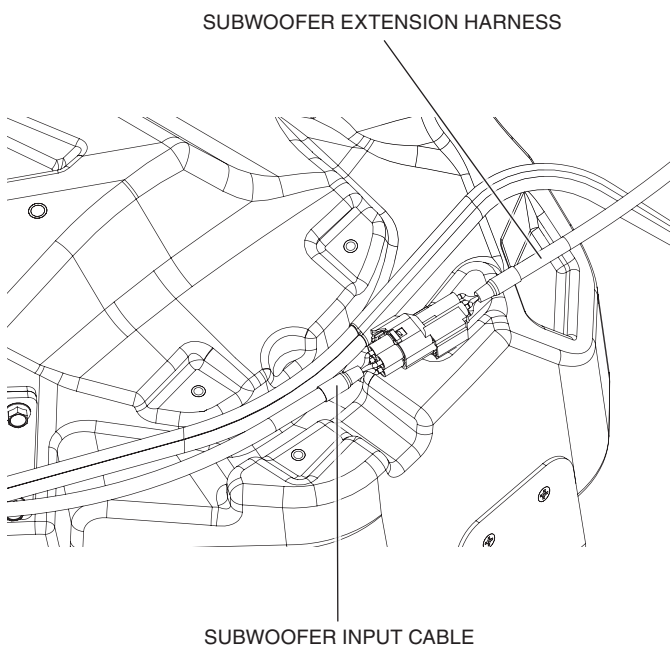

10. Route the power and input cables through the channel of the subwoofer enclosure. Install the 2 Cable Brackets using the 4 supplied M4 screws. The brackets will secure the power and input cables in the channel as shown. Torque to 3 N-m or 2 lbf-ft.

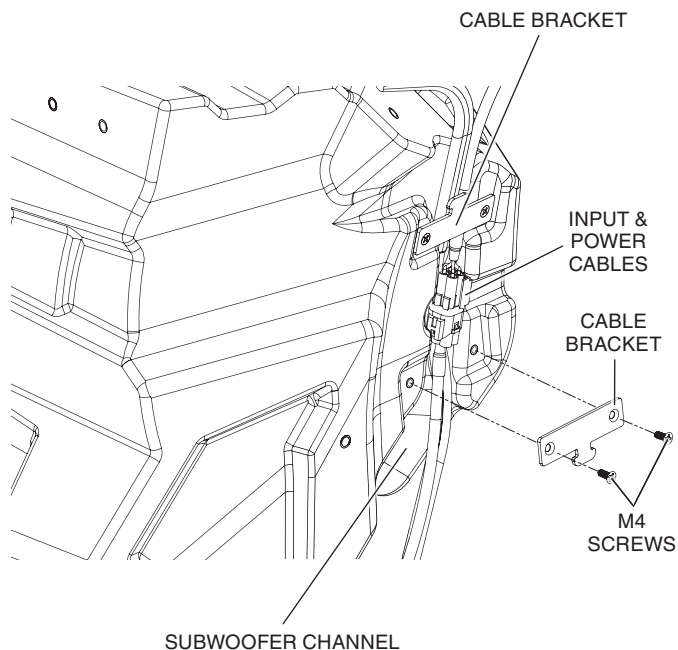

11. Attach the Bottom Bracket to the subwoofer enclosure using 3 M6 × 16 mm bolts and Small M6 Washers provided. Torque to 8 N-m or 6 lbf-ft.

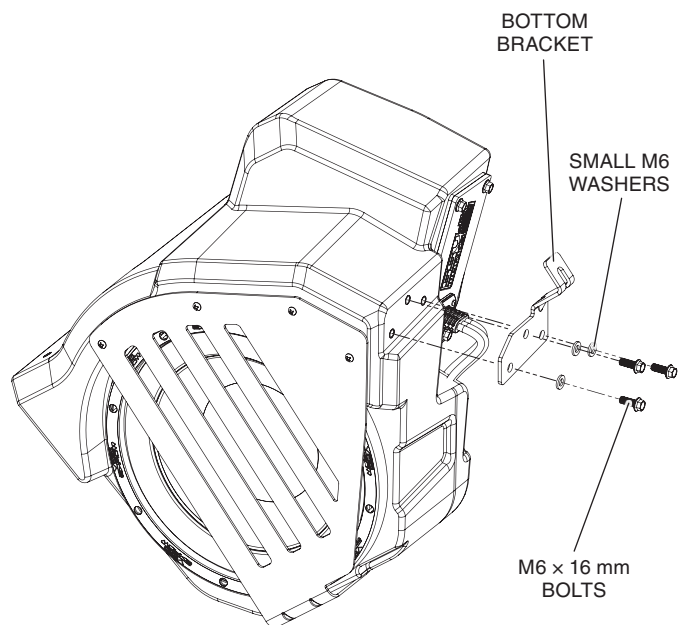

12. Attach the Upper Bracket to the subwoofer enclosure using 3 M6 × 16 mm bolts and 3 small M6 washers provided. Torque to 8 N·m or 6 lbf·ft.

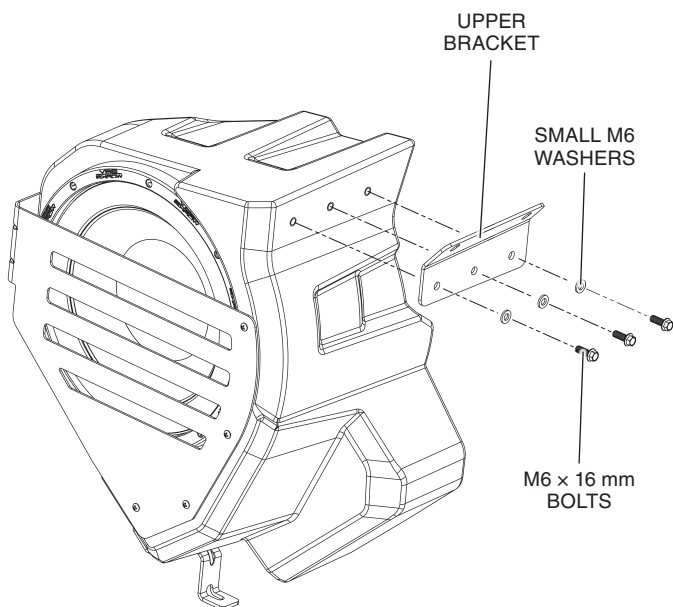

13. Install the subwoofer by placing the Upper Bracket against the previously installed U-nuts and swing the Lower Bracket into place.

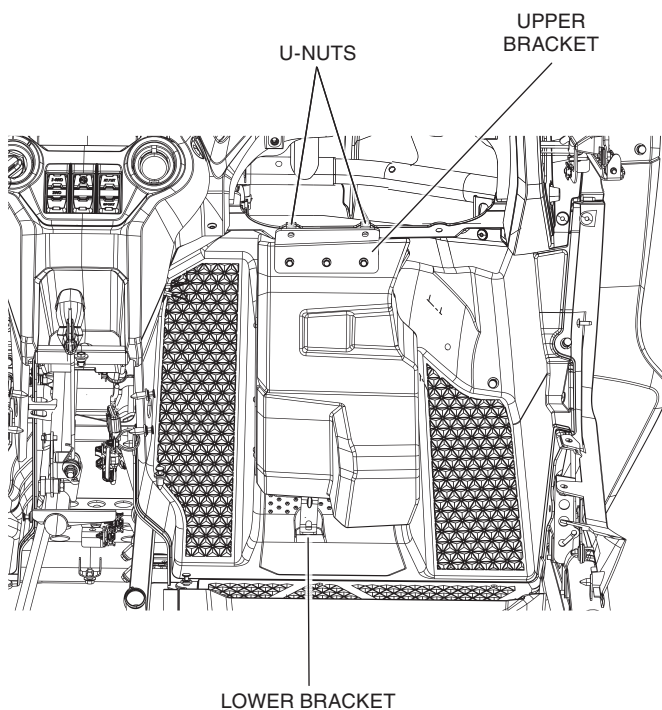

14. Replace the factory allen head M6 screw with the supplied M6 × 16 mm screw and small M6 washer. Install through the subwoofers lower bracket. Torque to 8 N·m or 6 lbf·ft.

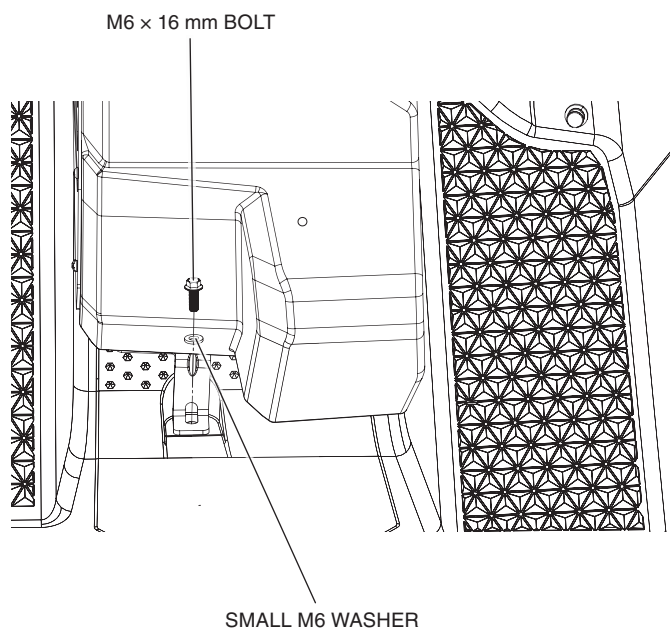

15. Route the power cables and the Subwoofer Extension Harness through the 7/8" hole previously drilled in Step 7 and into glove box cavity.

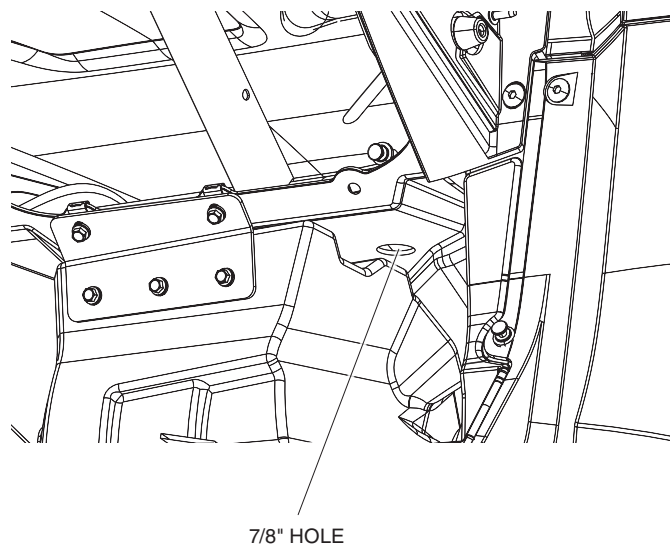

16. Route the Subwoofer Extension Harness towards the Radio MCU located on passenger side.

SUBWOOFER EXTENSION HARNESS

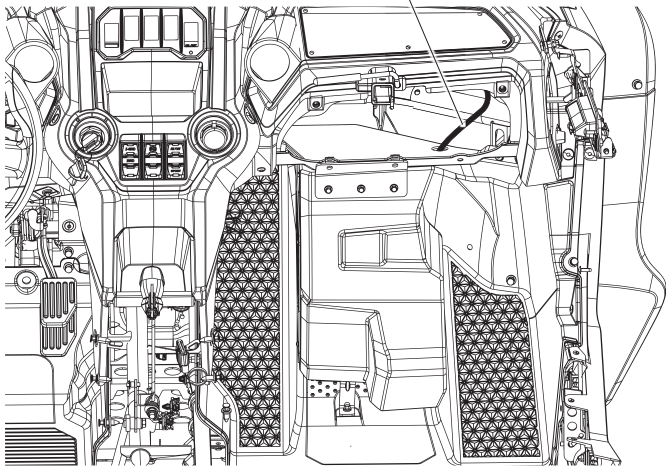

17. Connect the Subwoofer Extension Harness to the Line Out / Ext. Amp Trigger Output of the Radio MCU.

RADIO MCU

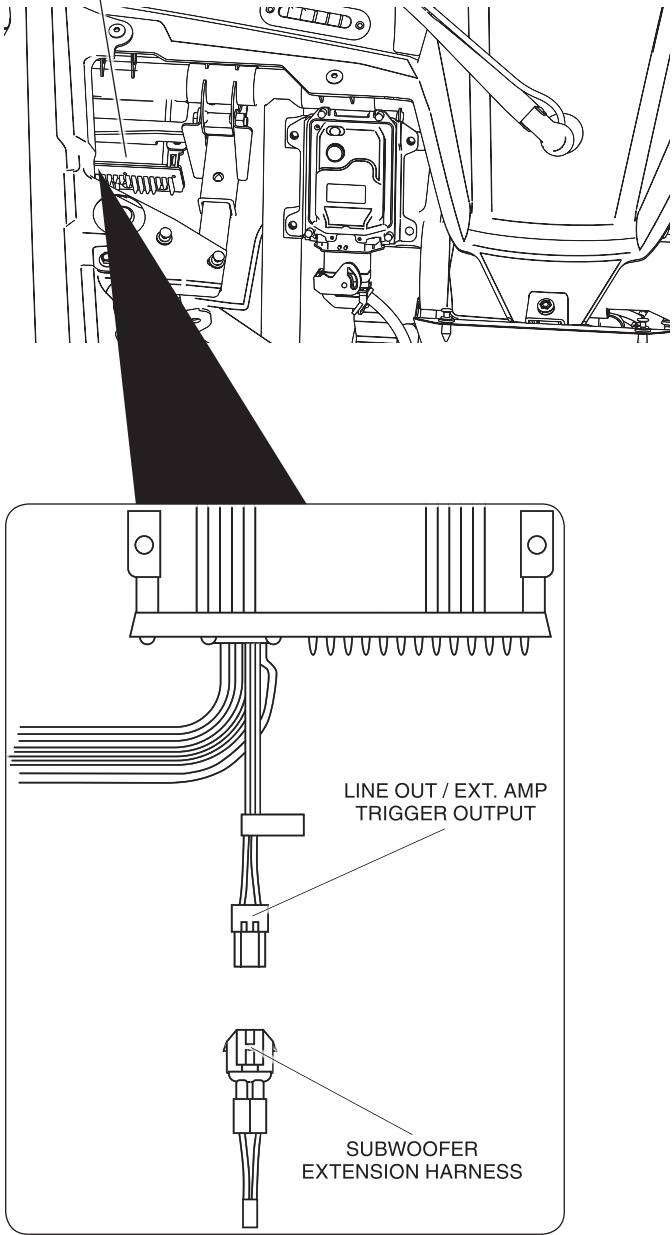

18. Run the power and ground cables behind the glove box towards the front of the vehicle. Route the cables along the cross bar towards the bus bar located on the driver side firewall. Zip tie as needed.

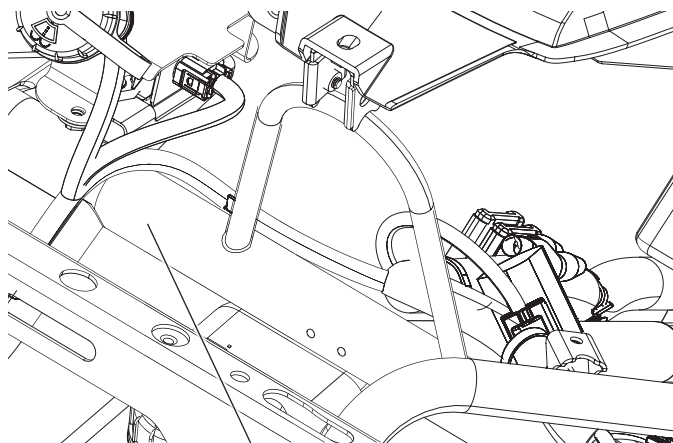

CROSSBAR

19. Connect the ground cable (-) from the subwoofer enclosure to the busbar. Connect the provided In-Line Fuse Holder to the positive (+) side of the busbar. Zip tie fuse holder as needed.

Torque nuts to 9 lb ft (12 Nm).

⚠ WARNING: Do not to exceed the recommended torque specs or damage to busbar module can occur.

NEGATIVE (-)
FROM SUBWOOFER ENCLOSURE

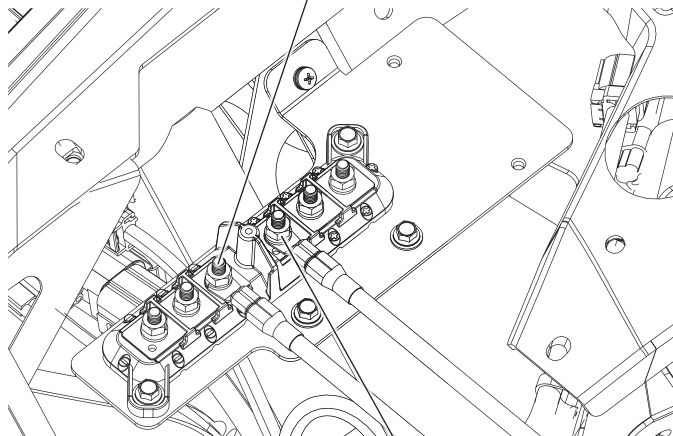

POSITIVE (+)
FROM IN-LINE FUSE HOLDER

20. Connect the In-Line Fuse Holder to the power lead connector coming from the subwoofer enclosure.

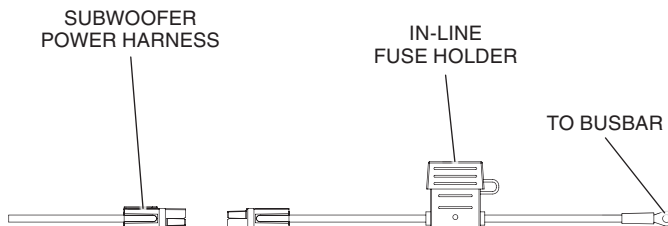

21. Reinstall the glove box sliding the bottom lip behind the sub woofer Upper Bracket. Reinstall the two upper factory screws and the internal trim clip removed during disassembly.

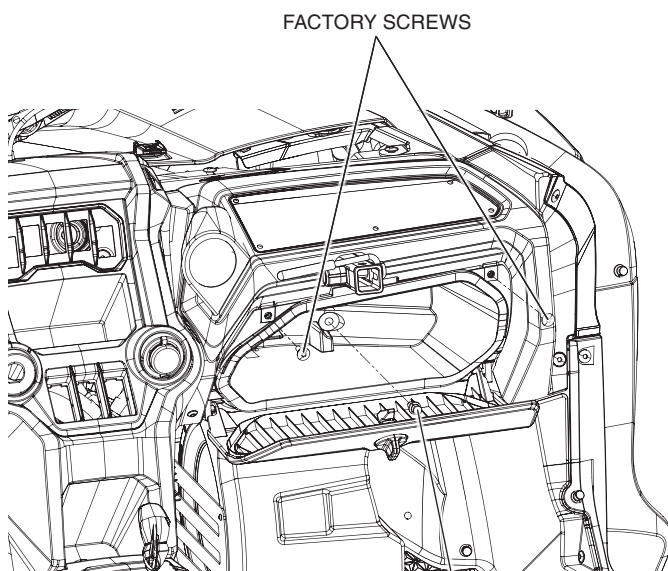

TRIM CLIP

22. Using the 2 supplied M6 × 20 mm bolts and Small M6 washers, screw through the subwoofer Upper Bracket and the lower glove box mounting holes into the previously installed UNuts. Reinstall the previously removed trim clip in the remaining glove box mounting point. Torque to 8 N·m or 6 lbf·ft.

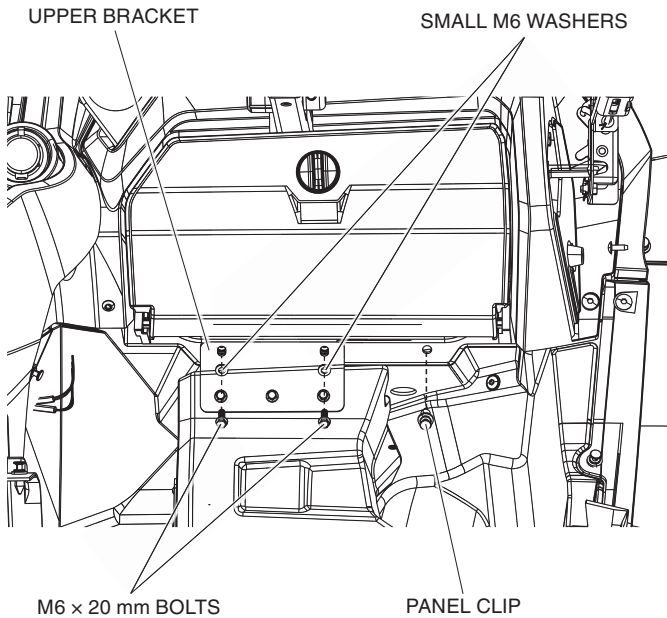

23. Using 2 supplied M6 × 16 mm bolts and 2 Large M6 Washers, screw through the body panels and into the threaded inserts of the subwoofer enclosure at the marked locations. Before doing so, check to make sure the inserts on subwoofer enclosure are aligned to the holes of the body panel. Torque to 8 N·m or 6 lbf·ft.

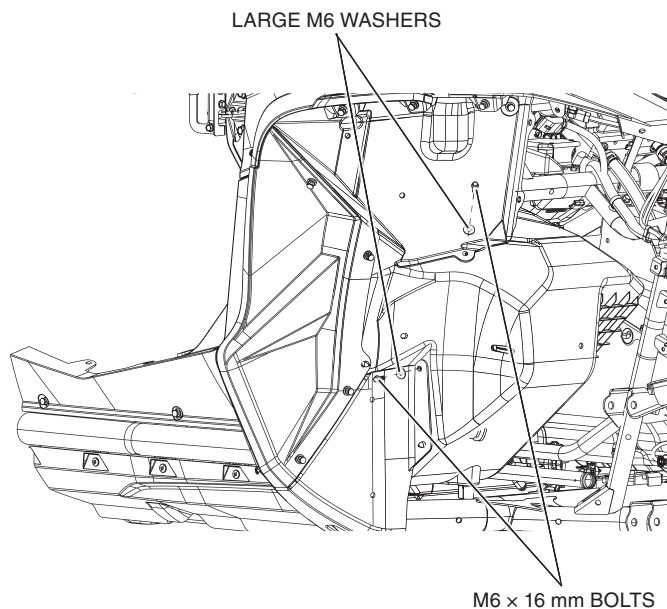

24. Reinstall the outer body panel by using the panel clips previously removed.

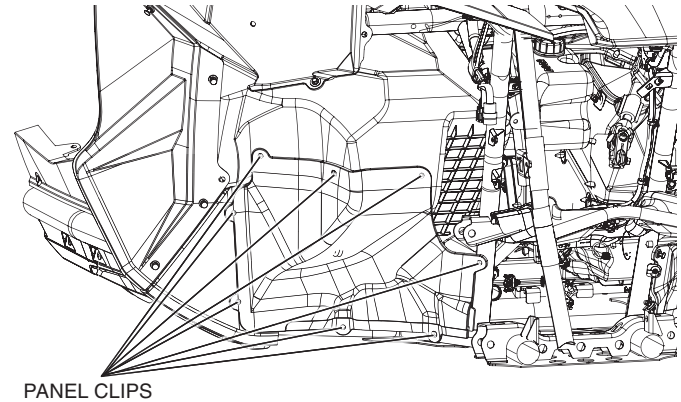

25. Reinstall the following in accordance with the vehicle service manual.

- Hood
- Ground Cable connection to battery

<TEMPLATE>

Subwoofer wire drill template

Cut template along the lines.

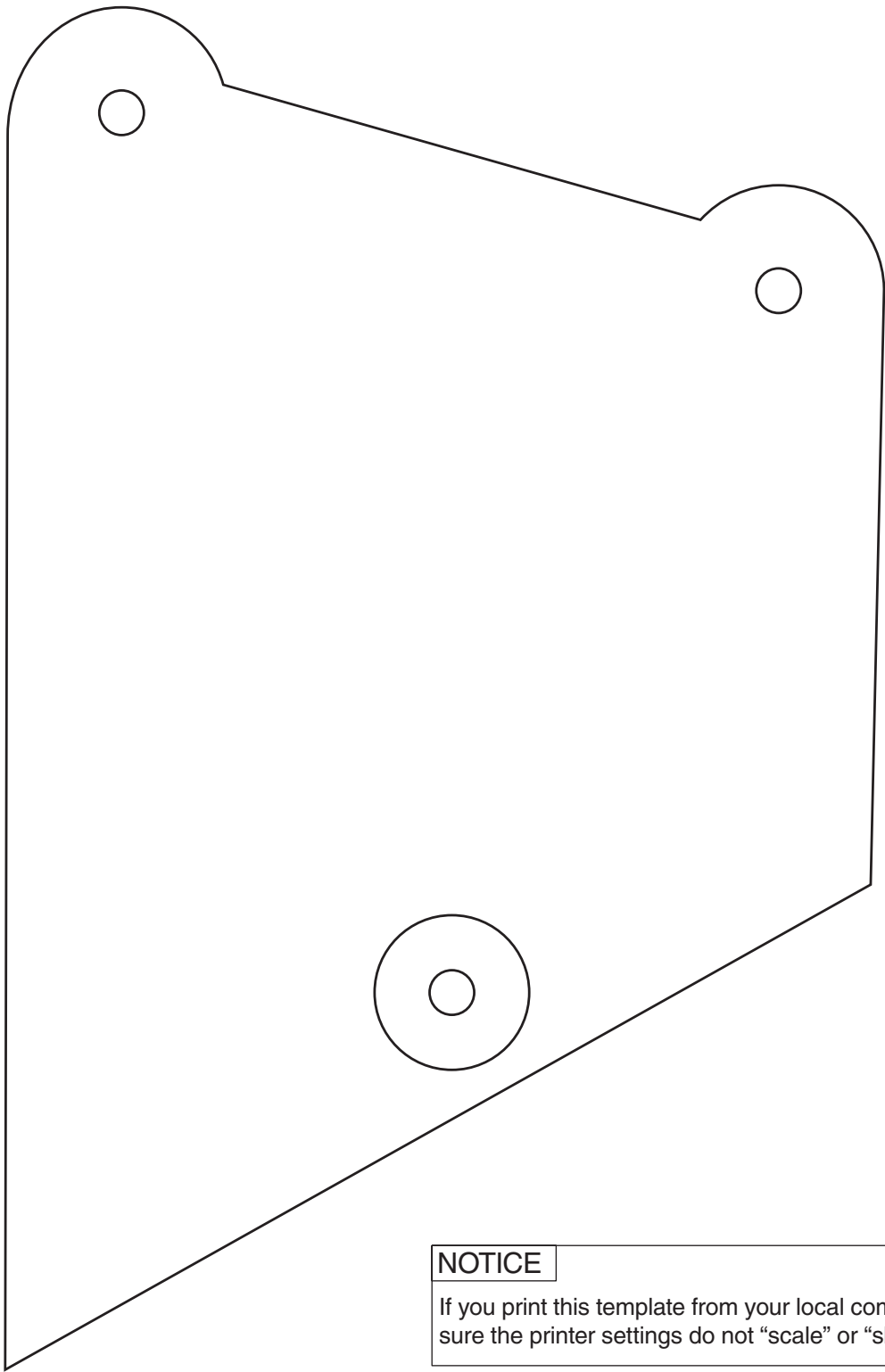

NOTICE

If you print this template from your local computer, make sure the printer settings do not “scale” or “shrink” the page.

