



INSTALLATION INSTRUCTIONS

Accessory

WINCH MOUNT KIT
P/N 0SL70-HL6-A00

Application

SXS1000S2X
SXS1000S2R

Publication No.

MII 17575

Issue Date

January 2021

Honda Dealer: Please give a copy of these instructions to your customer.

PARTS LIST

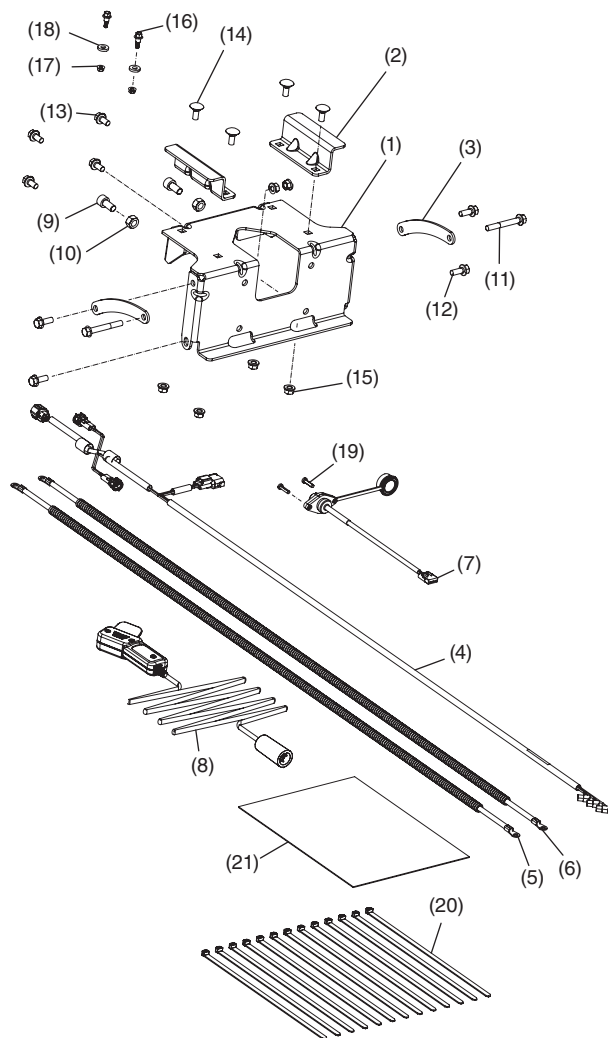

No.	Description	Qty
(1)	Winch bracket	1
(2)	Angle bracket	2
(3)	Plate bracket	2
(4)*	Winch & Accessory sub harness	1
(5)	Winch power cable - blue	1
(6)	Winch power cable - yellow	1
(7)	Remote control sub harness	1
(8)	Winch remote control	1
(9)	10 mm socket bolt	2
(10)	10 mm nut	2
(11)	8 mm bolt (long)	2
(12)	8 mm bolt (medium)	4
(13)	8 mm bolt (short)	4
(14)	8 mm square neck bolt	4
(15)	8 mm nut	6
(16)	5 mm shoulder bolt	2
(17)	5 mm nut	2
(18)	Rubber washer	2
(19)	#8 Screw	2
(20)	Wire Tie	13
(21)	Installation Instructions URL	1

* If Accessory Switch Plate 0SA30-HL6-A00 is installed then the Accessory Sub-harness will already be installed.

WINCH KIT

Sold separately (P/N 0SL71-HL6-A00)

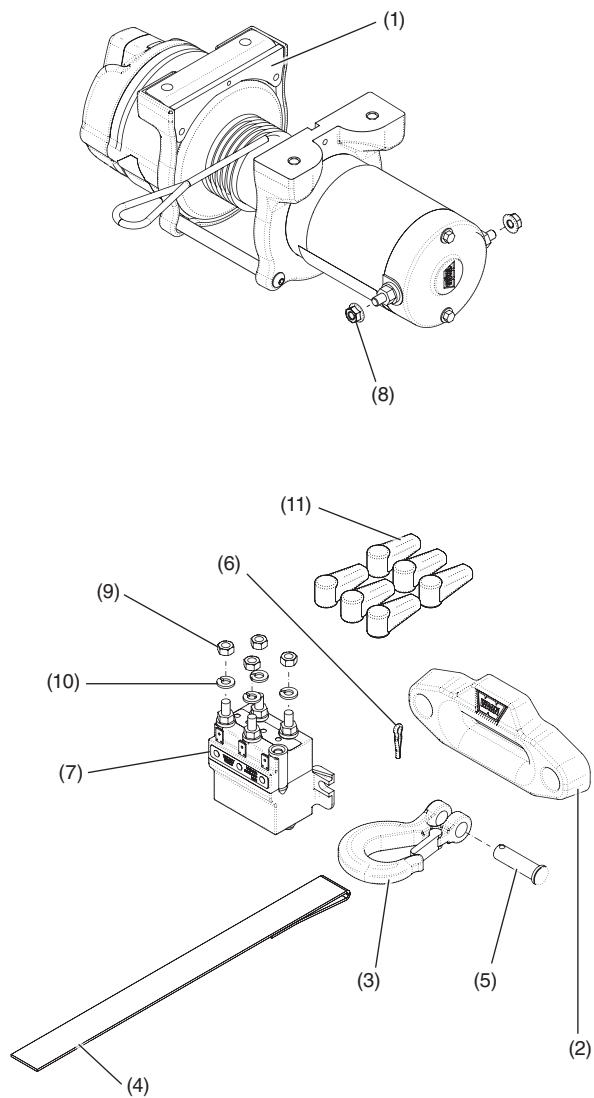

No.	Description	Qty
(1)	Winch	1
(2)	Fairlead	1
(3)	Clevis Hook	1
(4)	Hook Strap	1
(5)	Clevis Pin	1
(6)	Clevis Cotter Pin	1
(7)	Contactor	1
(8)	M6 Flange Nut	2
(9)	M6 Nut	4
(10)	M6 Lock Washer	4
(11)	Terminal Boot	6

WINCH KIT

Sold separately (P/N 0SL71-HL6-A20)

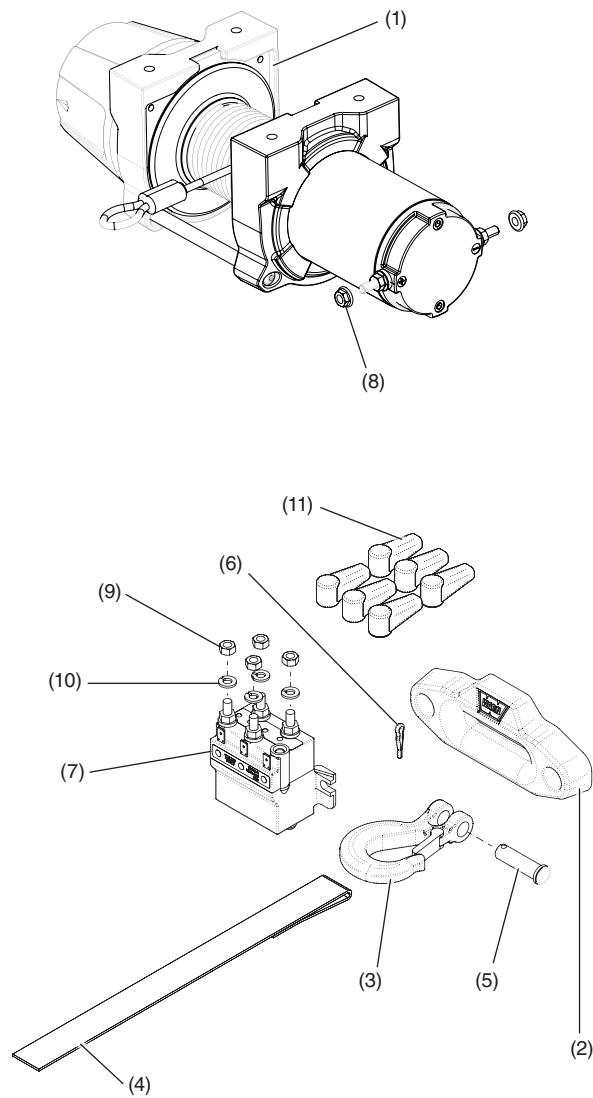

No.	Description	Qty
(1)	Winch	1
(2)	Fairlead	1
(3)	Clevis Hook	1
(4)	Hook Strap	1
(5)	Clevis Pin	1
(6)	Clevis Cotter Pin	1
(7)	Contactor	1
(8)	M6 Flange Nut	2
(9)	M6 Nut	4
(10)	M6 Lock Washer	4
(11)	Terminal Boot	6

CUSTOMER INFORMATION:

The information in these installation instructions is intended for use only by skilled technicians who have the proper tools, equipment, and training to correctly and safely add equipment to your SxS. These procedures should not be attempted by "Do-it-yourselfers."

BEFORE YOU BEGIN

This kit describes the installation of a WARN SxS winch. Please read WARN's Winching Technique guide provided with the winch prior to use of this product.

TOOLS AND SUPPLIES REQUIRED

Torque wrench

Ratchet

Socket (8, 10, 12 and 14 mm)

Open end wrench (8, 10, 12, 14 and 15 mm)

Phillips® screwdriver

Power drill

3.7 mm (#25 or 9/64") drill bit

18 mm hole saw

Hex wrench (8 mm)

TORQUE CHART

Tighten all screws, bolts, and nuts to their specified torque values. Refer to the Service Manual for the torque values of the removed parts.

Item	N·m	kgf·m	lbf·ft
5 mm flange nut and bolt	5.2	0.5	3.8
6 mm winch motor terminal nut	5.7	0.6	4.2
6 mm contactor terminal nuts	3.6	0.37	2.7
8 mm flange nut and bolt	27	2.8	20
10 mm nut and bolt	39	4.0	29

MAXIMUM WINCH CAPACITY

Winch Capacity 3,500 lb (1,588 kg)

SAFETY

When installing your SxS winch system, read and follow all mounting and safety instructions. Always use caution when working with electricity and verify that there are no exposed electrical connections before energizing your winch circuit. For specifications and performance data, refer to the specification sheet supplied with your winch.

INSTALLATION

⚠ CAUTION

- To prevent burns, allow the engine, exhaust system, radiator, etc., to cool before installing the accessory.

NOTE:

- Disconnect the battery negative (-) cable before installing this accessory.
- The memory of the clock will be erased when you disconnect the battery. Reset the clock after reconnecting the battery.
- Cut the wire ties at 5 mm from the lock part after attaching them to the wire harnesses. Do not allow the cut part of the wire tie to interfere with another harness or brake hose.
- Reinstall the removed parts on the vehicle and make sure that the wires and harnesses are not pinched.
- Always perform the heavy installation work with two people.
- For installation of this accessory on a SxS equipped with a horn, refer to the installation instructions included with the horn mount.

1. Install the Honda Signature Accessory Front Bumper of choice.

NOTE:

- This winch cannot be used with the stock bumper. A Honda Signature Accessory Front Bumper must be used with this winch.

NOTE:

- The Honda Signature Accessory Front Bumper Installation Instructions will include a NOTE about where to begin the Winch Mount installation.

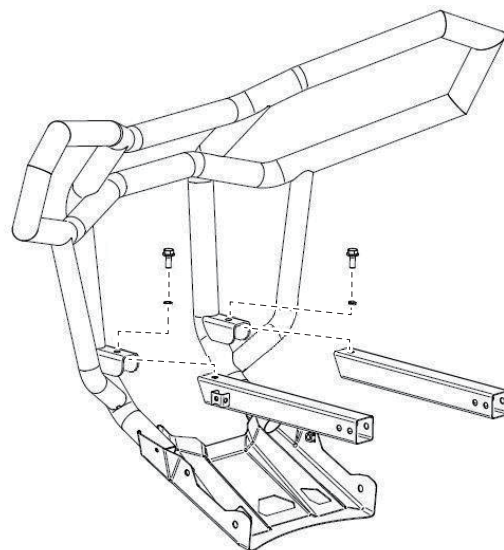

2. Confirm that the accessory front bumper mounting struts are loosely installed.

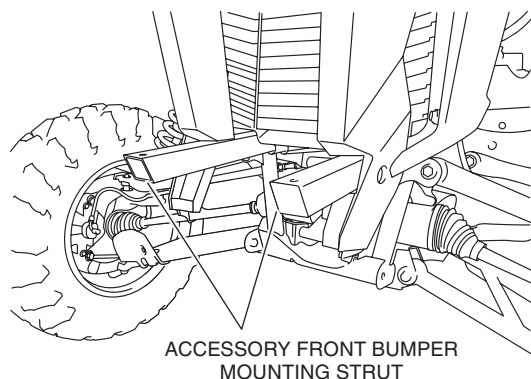

3. Remove the front mounting bolt from each bumper mounting strut as shown.

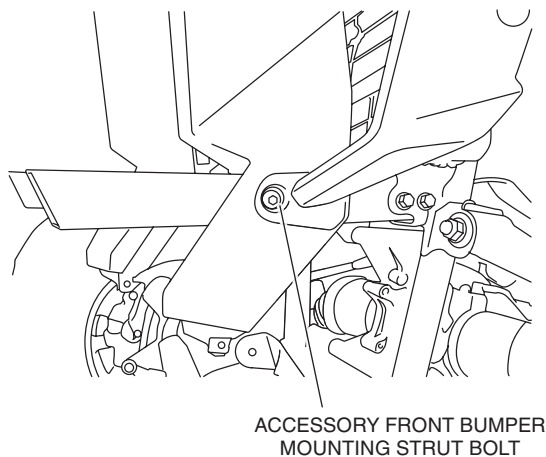

WINCH MOUNT BRACKET PRE-ASSEMBLY

4. Loosely install the angle brackets to the winch bracket with the square neck bolts and flange lock-nuts.

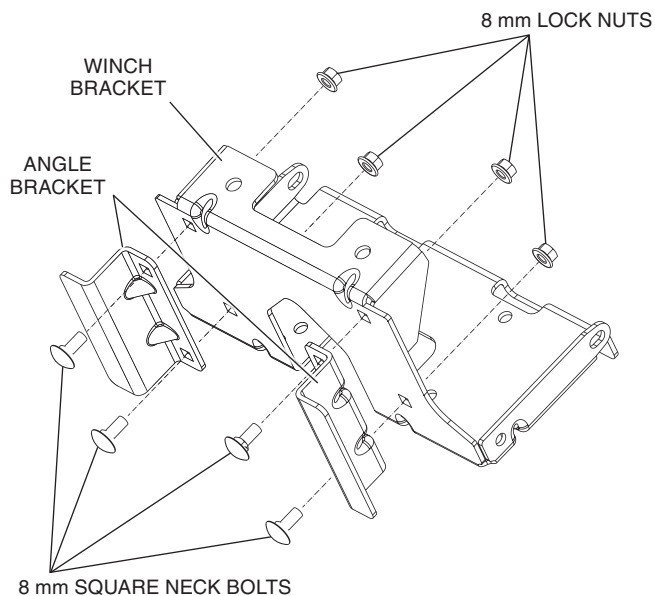

5. Loosely install the fairlead to the winch mount with the 10 mm socket head bolt and 10 mm nuts as shown.

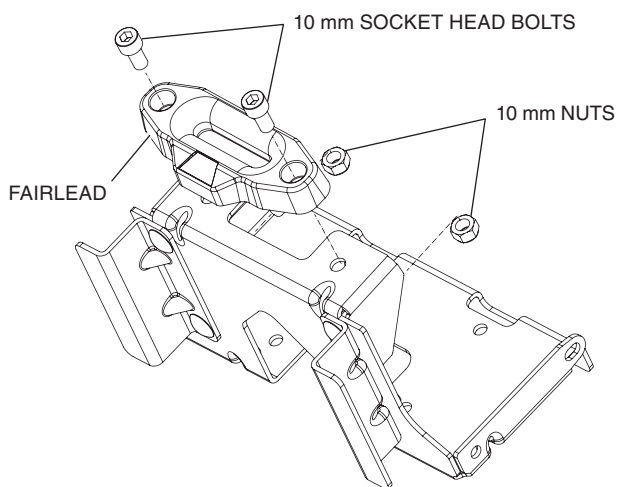

6. Loosely install the winch to the winch bracket with the short 8 mm flange bolts.

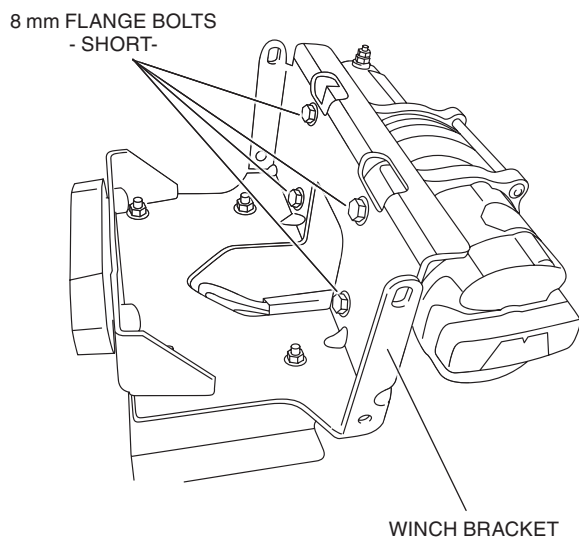

7. Loosely install the plate brackets to the winch bracket with the medium 8 mm flange bolts and flange lock-nuts as shown.

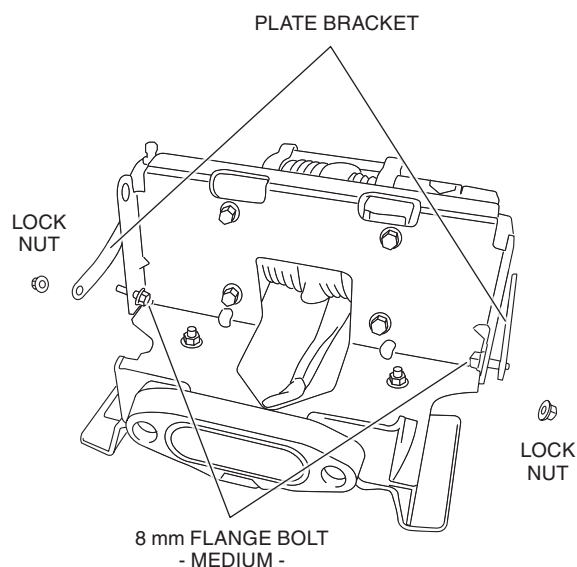

WINCH INSTALLATION

8. Slide the winch assembly onto the front bumper struts as shown.

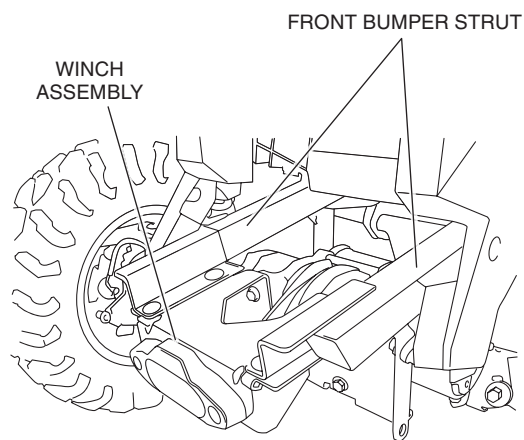

9. Continue sliding the winch assembly onto the bumper struts until winch mount holes are aligned with the holes in the bumper strut and frame.
10. Loosely install a long 8 mm flange bolt through each plate bracket, the bumper strut, and into the frame as shown.

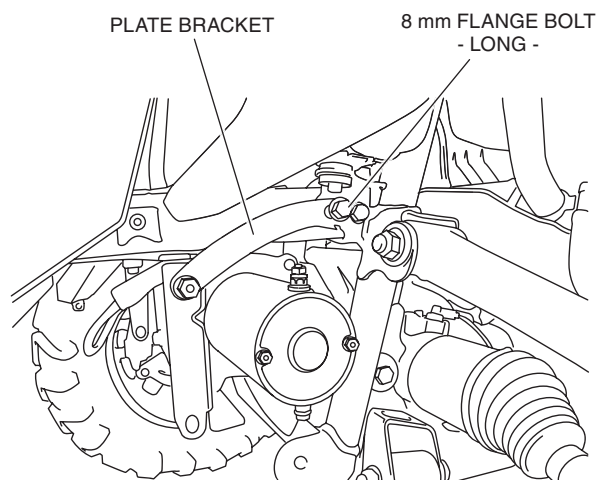

11. Reinstall accessory front bumper mounting strut bolt, removed in step 3. Pull the winch rope through the fairlead, then through abrasion sleeve, and install the hook strap and hook to the rope with the pin and cotter as shown.

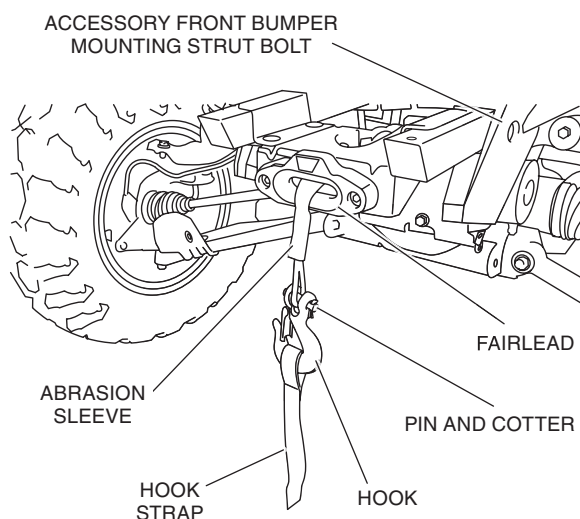

12. Loosely install the accessory front bumper with the medium 8 mm flange bolts at the position shown.

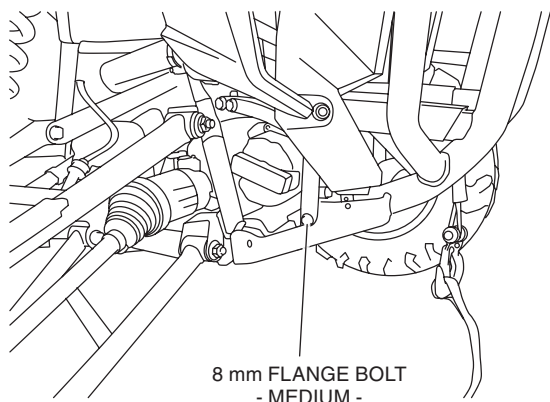

13. See your accessory front bumper installation instructions to complete bumper installation. Tighten ALL the hardware at this time, to the specification in the Torque Chart.

ELECTRICAL INSTALLATION

14. Release the three clips and then remove the battery case cover as shown.

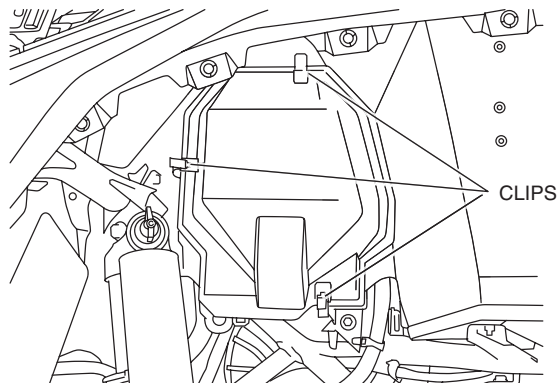

15. Disconnect the negative (-) cable from the battery.

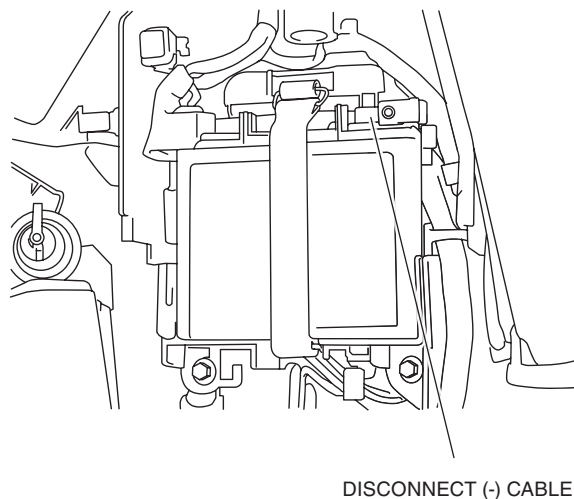

16. Turn the lock knobs and release the bosses by pulling the front hood upward and remove completely by releasing the clips.

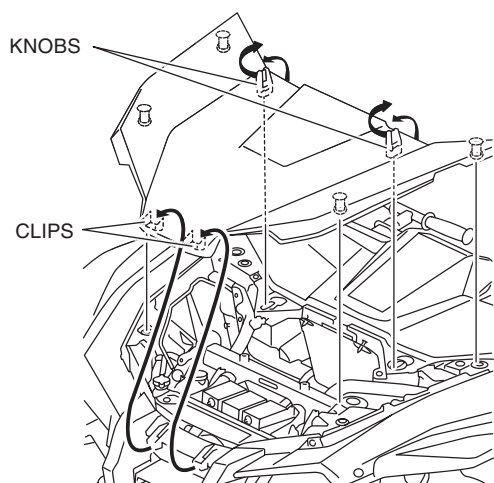

17. Remove the following:

- Trim clips
- Socket bolts
- Bolts
- Rubber splash shield
- Rear hood

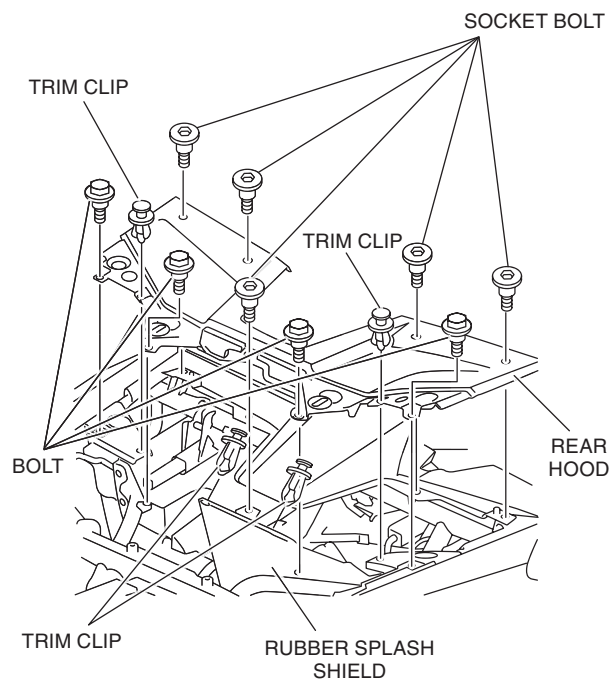

18. Find the black and red cables anchored to the instrument panel at the location shown.
19. Remove the blue protective tape from terminals.

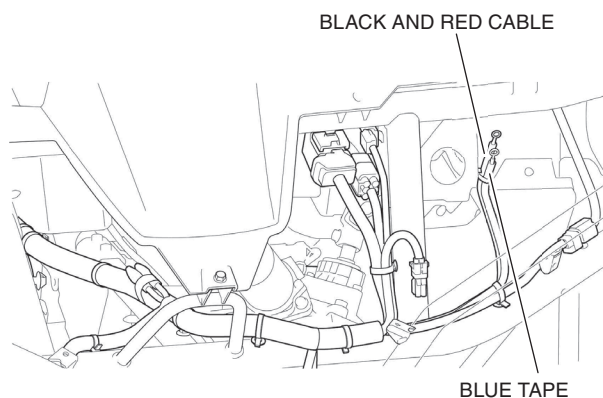

20. Install a rubber terminal boot over the end of the red and black cables as shown.

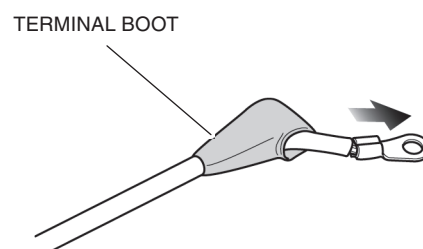

21. Install the contactor at the location shown with the 5 mm shoulder bolts, rubber washers and flange

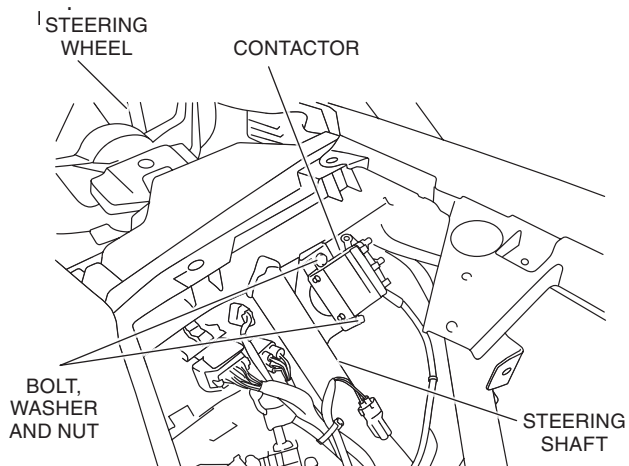

22. Install the black and red cables to the corresponding color contactor terminals with an M6 lock washer and M6 nut as shown.

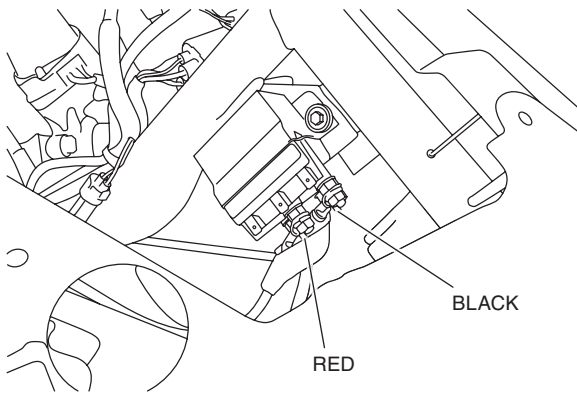

23. Install a rubber terminal boot over both ends of each winch power (blue and yellow cable) as shown.

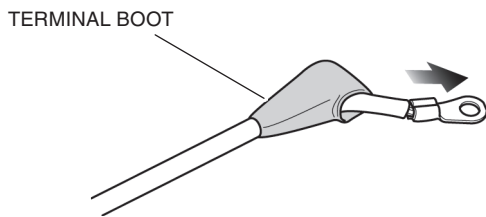

24. Route the winch power cables along the frame tube and connect them to the winch motor (blue cable to top terminal, yellow cable to bottom terminal) with M6 flange nuts.

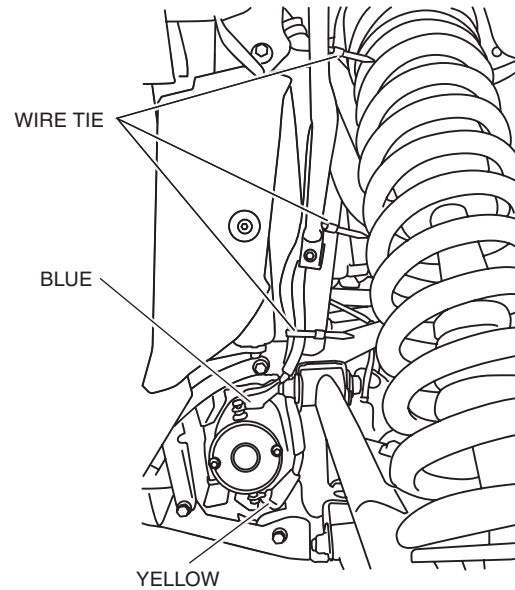

25. Secure the power cables to the frame tube with three wire ties at the locations shown.
26. Route the winch power cables along the frame tube and secure them to the tube with three wire ties at the locations shown.

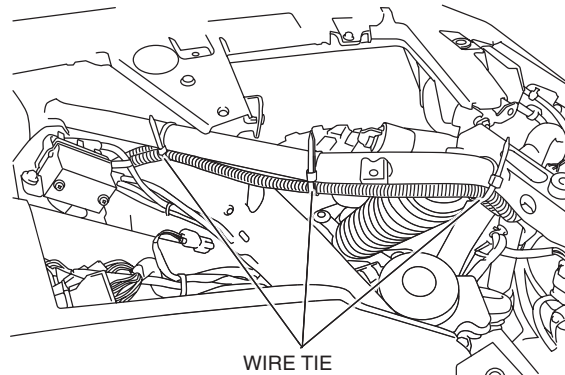

27. Connect the winch power cables to the corresponding color terminals of the contactor with an M6 lock washer and M6 nut as shown.

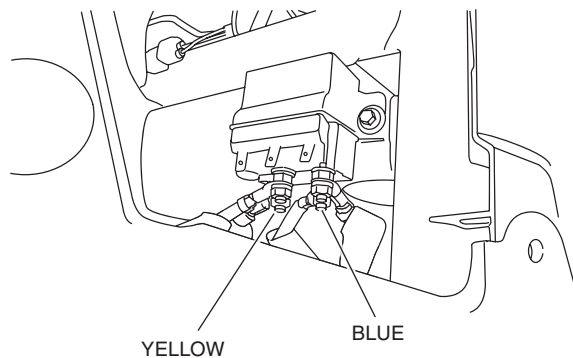

28. Pull a rubber terminal boot over all (blue, yellow, red and black) power cable terminals at the contactor.

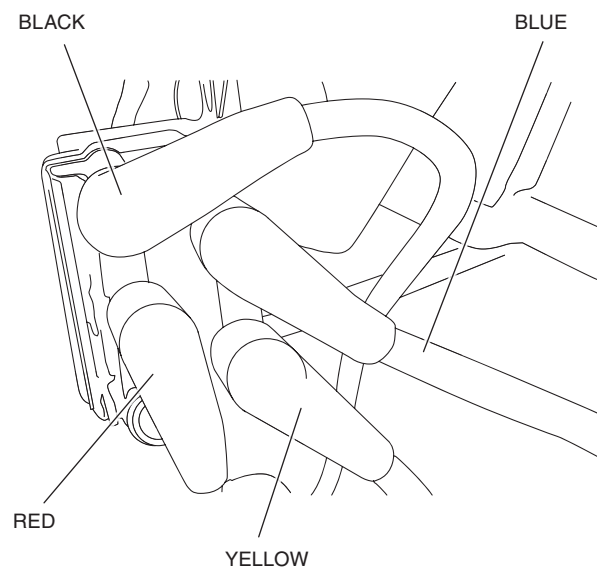

29. Pull a rubber terminal boot over each power cable on winch motor.

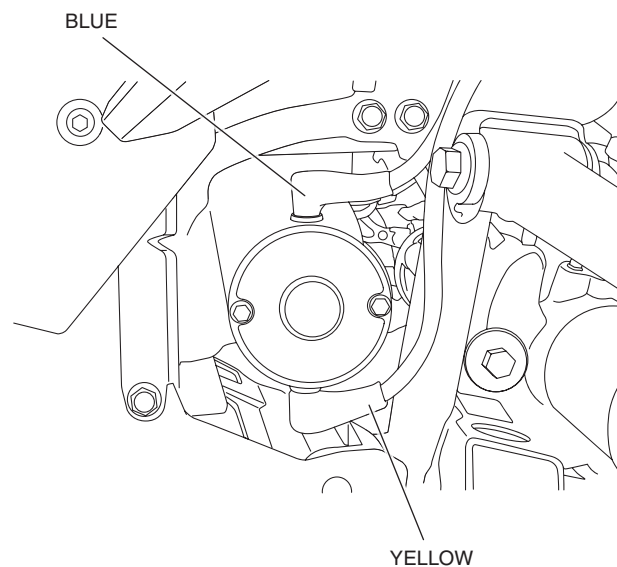

30. Remove the trim clips, socket bolts and glove box as shown.

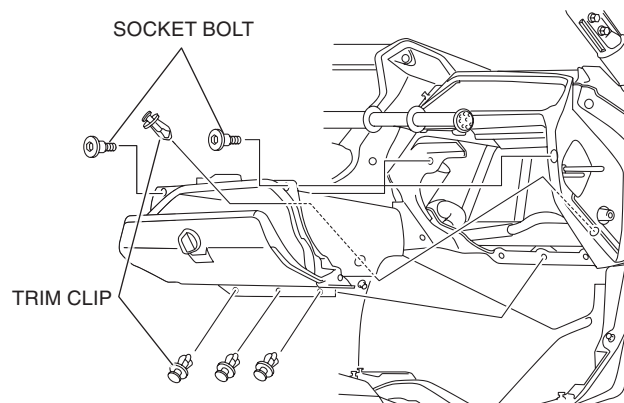

31. Remove glove box door by flexing the plastic at the hinge to free the door hinge pin.

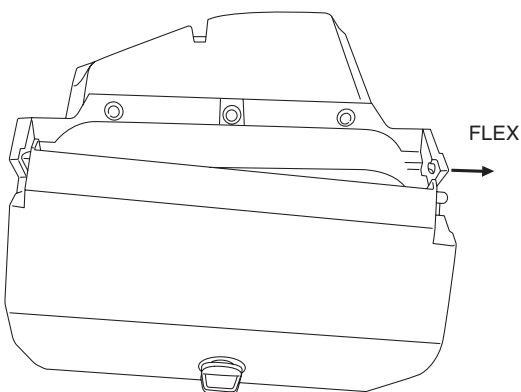

32. Locate three index marks on the inside top surface of the glove box and drill a 3/4" (18 mm) hole at the center index mark and two 9/64" (3.7 mm or #25 drill bit) hole at each of the outer index marks.

NOTE:

- Remove any burrs from the edge of the hole.

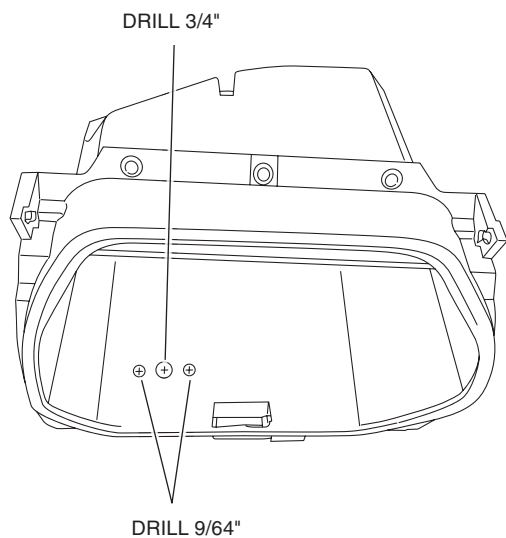

33. Disconnect the vehicle main harness connector from the accessory socket.

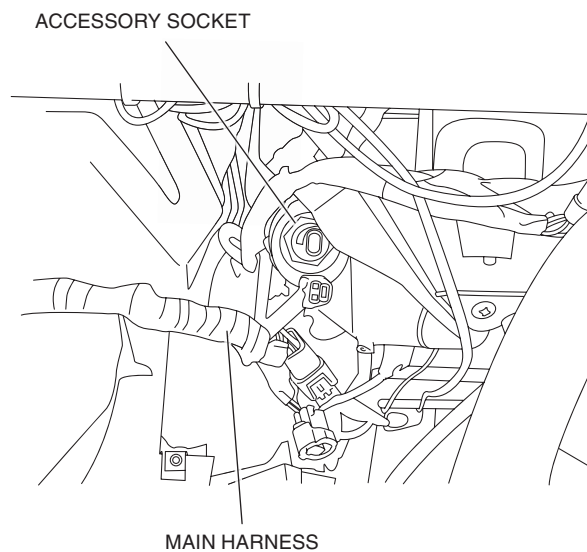

34. Install and connect the accessory sub-harness to the main harness and accessory socket.

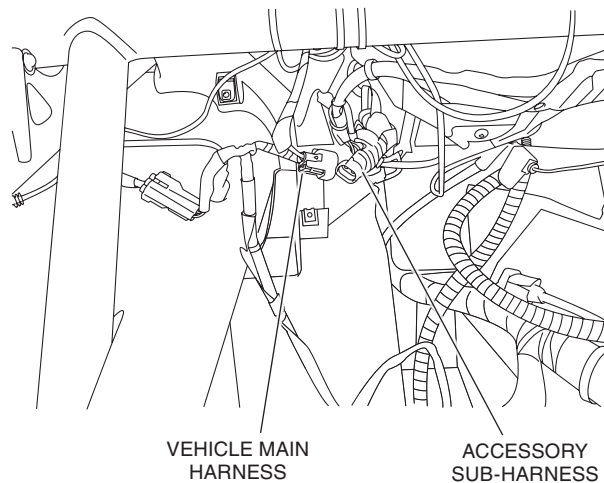

35. Reinstall glove box.

36. Pass the remote control sub-harness through the hole in the glove box.

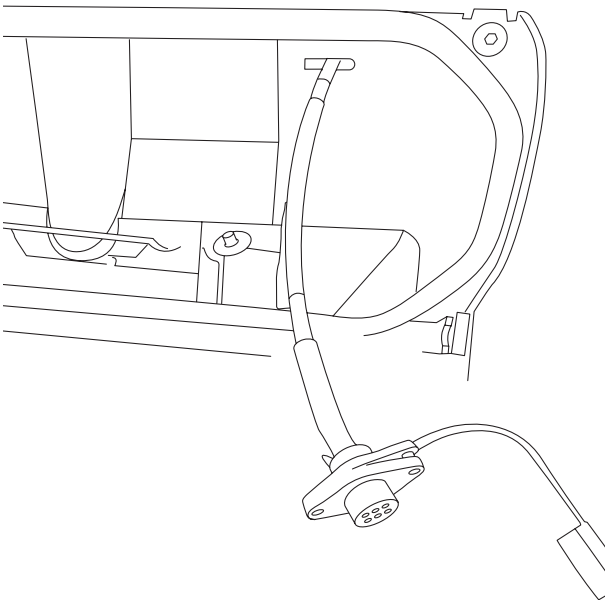

37. Install the remote control connector into the glove box with the #8 screws as shown.

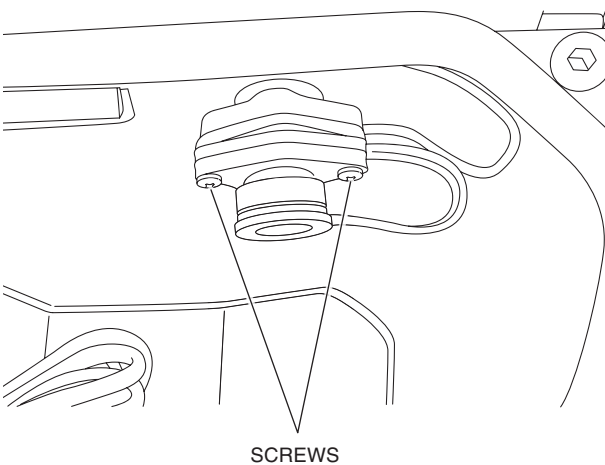

38. Route and connect control sub-harness to winch contactor.

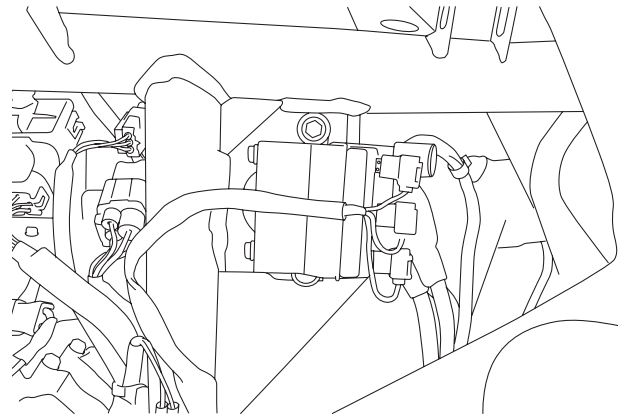

39. Connect the accessory sub-harness to the winch control socket harness (glove box).

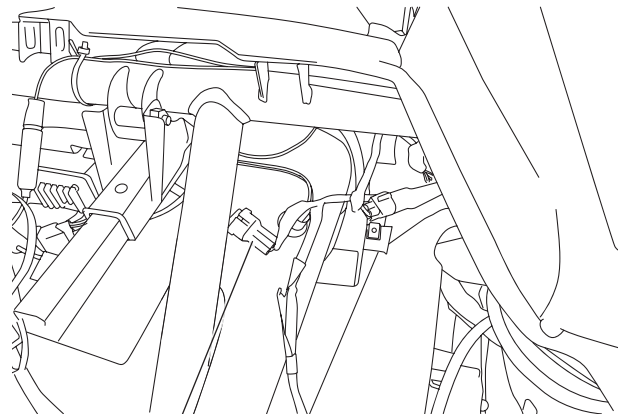

ACCESSORY
SOCKET HARNESS

40. Route the accessory sub-harness as shown. Secure using seven wire ties in the locations shown.

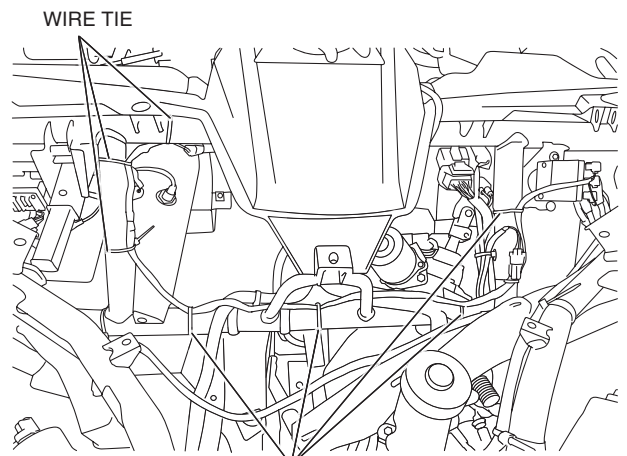

WIRE TIE

41. Locate the black power wire with the angle battery terminal. Wire is behind the gray relays. Remove tape.

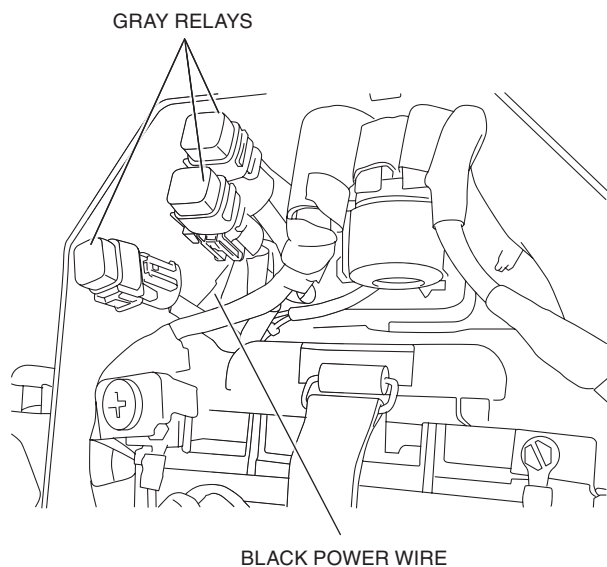

42. Remove starter relay by sliding rubber strap off the battery box plastic tab. Remove left relay terminal boot and connect the black power wire.

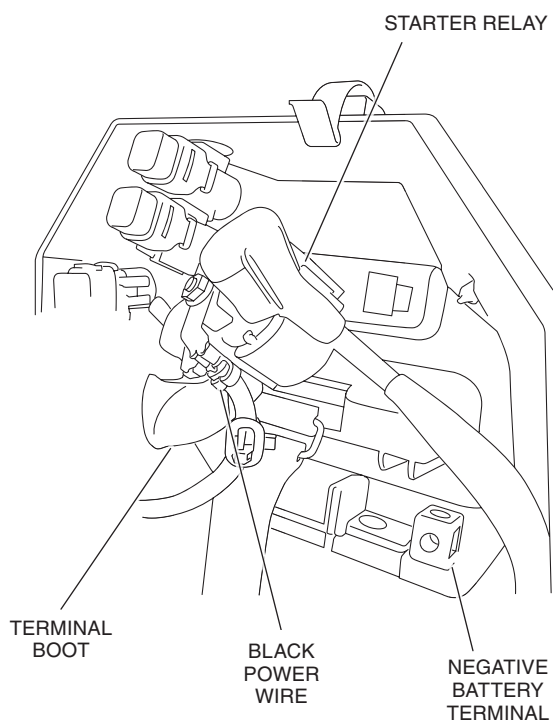

43. Reinstall terminal boot and return rubber relay strap to the battery box tab.
44. Reconnect the negative (-) cable to the battery.

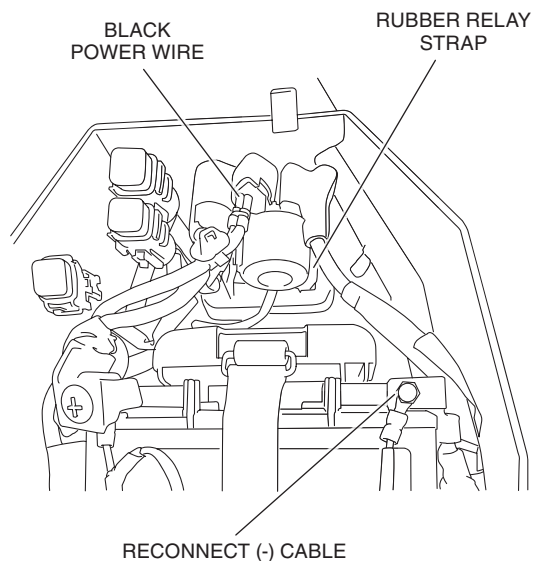

CHECK THE SYSTEM:

Before using the winch, verify the following:

- The wiring to all components is correct. All loose wires are secured tightly using wire-ties.
- There are no exposed wires or terminals. Cover any exposed wires or terminals with terminal boots, heat shrink tubing, or electrician's tape.
- Turn the vehicle ignition switch to the ON position.
- Check the winch for proper operation. The wire rope should spool in and out in the direction indicated on the switch.

