



INSTALLATION INSTRUCTIONS

Accessory
**WINDSHIELD WIPER
WASHER KIT
P/N 0SE10-HL6-A10**

Application
**After 21YM
SXS1000S2X/S2XD/S2R/
S2RD/S4X/S4XD**

Publication No.
MII 17811
Issue Date
May 2022

Honda Dealer: Please give a copy of these instructions to your customer.

PARTS LIST

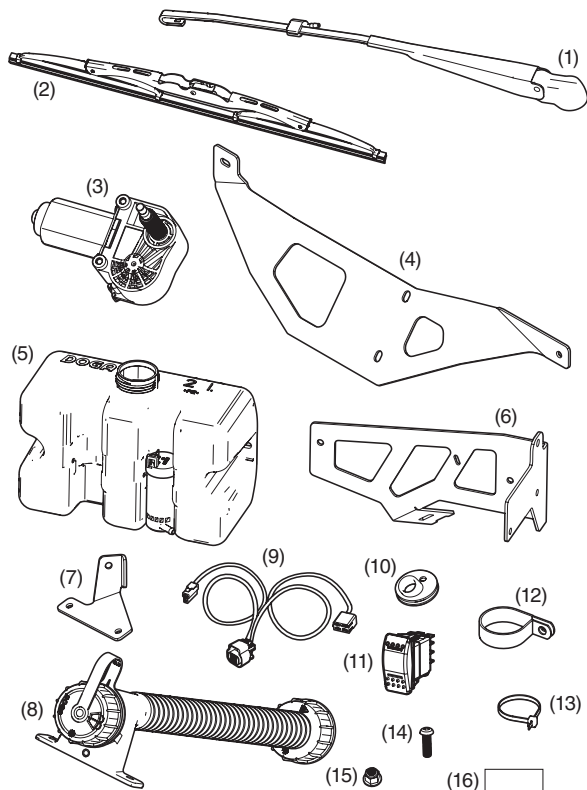

No.	Description	Qty
(1)	Wiper arm	1
(2)	Wiper blade	1
(3)	Motor	1
(4)	Motor bracket	1
(5)	Washer tank	1
(6)	Washer tank bracket	1
(7)	Filler spout bracket	1
(8)	Filler spout	1
(9)	Wiring harness	1
(10)	Spindle close off grommet	1
(11)	Switch	1
(12)	P-clamp	2
(13)	Nylon cable tie	4
(14)	M6 × 20 mm button head bolt	6
(15)	M6 nyloc nut	6
(16)	Trim	1

REQUIRED ACCESSORIES

The items below are required for the installation of this accessory.

Glass Windshield
Sold separately (P/N 0SU85-HL6-A00)

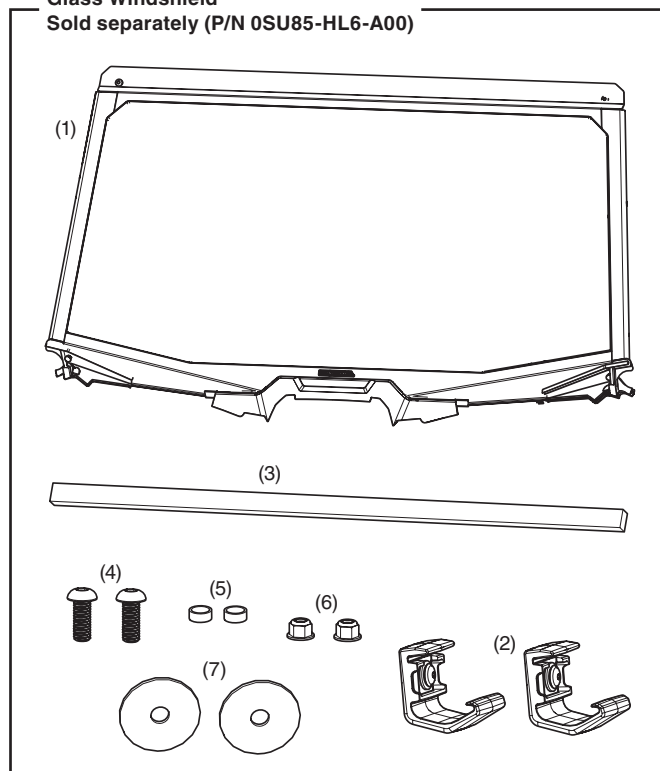

No.	Description	Qty
(1)	Glass windshield	1
(2)	Mounting clamp	2
(3)	Foam seal	1
(4)	8 × 20 mm button head bolt	4*
(5)	Spacer	2
(6)	8 mm nylock nut	2*
(7)	Fender washer	2
(8)	Installation instructions URL (not shown)	1

* Two of the 8 × 20 mm button head bolts and both of the 8 mm nyloc nuts will come pre-installed in the windshield.

Fuse Box

Sold separately (P/N 0SS25-HL4-A00)

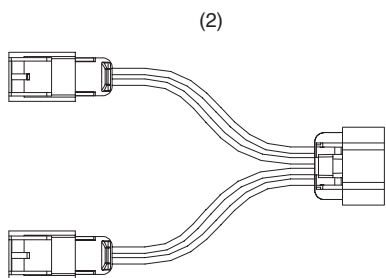
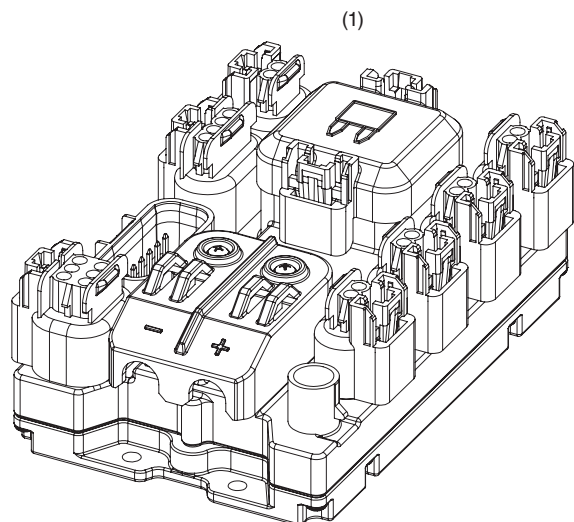

No.	Description	Qty
(1)	Fuse box switcher	1
(2)	Harness, 4-pin to 2-pin (Y-splitter)	1

Busbar

Sold separately (P/N 0SS27-HL6-A00)

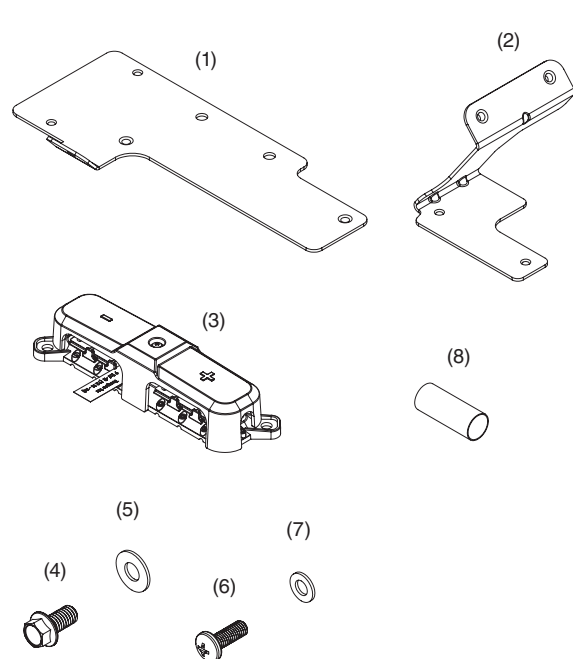

No.	Description	Qty
(1)	Main busbar mounting plate	1
(2)	Busbar lower support bracket	1
(3)	Busbar	1
(4)	M6 × 12 mm flange screw (8 mm head)	4
(5)	M6 × 14 mm flat washer	4
(6)	Phillips pan-head screw M5 × 14 mm	2
(7)	M5 × 10 mm flat washer	2
(8)	Heat shrink	2

Fuse Box Mount Kit
Sold separately (P/N OSS26-HL6-A00)

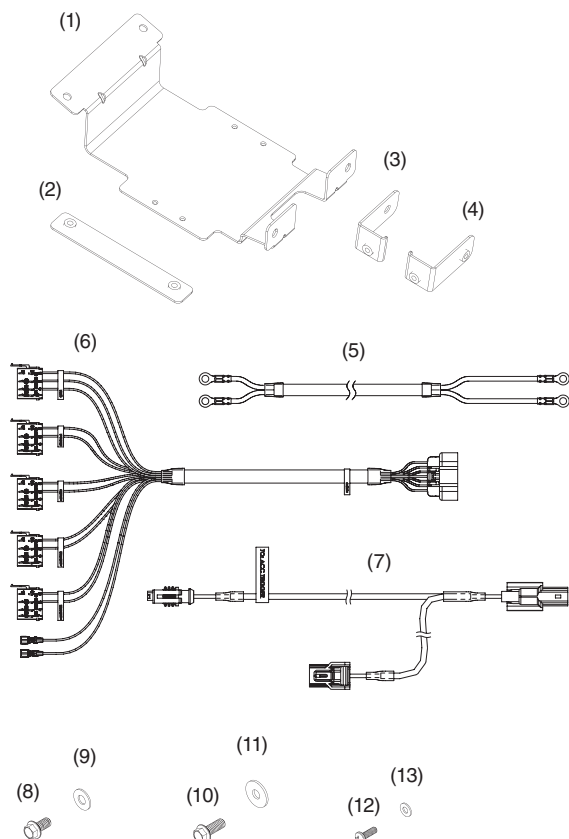

No.	Description	Qty
(1)	Fuse box mounting plate	1
(2)	Front under bracket	1
(3)	Driver side L-bracket	1
(4)	Passenger side L-bracket	1
(5)	Input power cables	1
(6)	Switch wiring harness	1
(7)	Accessory trigger cable	1
(8)	8 mm hex head M6 flange screw, 12 mm long	4
(9)	M6 flat washer, 14 mm o.d.	4
(10)	8 mm hex head M6 flange screw, 16 mm long	2
(11)	M6 flat washer, 18 mm o.d.	2
(12)	M4 x 0.7 phillips screw, 12 mm long	4
(13)	M4 flat washer	4

TOOLS AND SUPPLIES REQUIRED

Power drill

1 1/4 inch saw bit

13 mm socket wrench

T25 Torx wrench

Pencil

TORQUE CHART

Tighten all screws, bolts, and nuts to their specified tightening torque values. Refer to the Service Manual for the tightening torque values of the removed parts.

Item	N·m	kgf·m	lbf·ft
M6 Bolt	32	35	24

USE AND CARE INFORMATION

- Check the accessory mount frequently and retighten if necessary.
- Replace this accessory with a new one if it is damaged or discolored excessively.
- Never clean with or expose this accessory to petroleum solvents such as gasoline, thinner, benzene, acid, or alkaline cleaners.

INSTALLATION

1. Install all required accessories before starting installation.
2. Remove the glass windshield (if installed) and the hood from the vehicle and set aside.
3. Remove the heat shield and instrument panel and set aside.

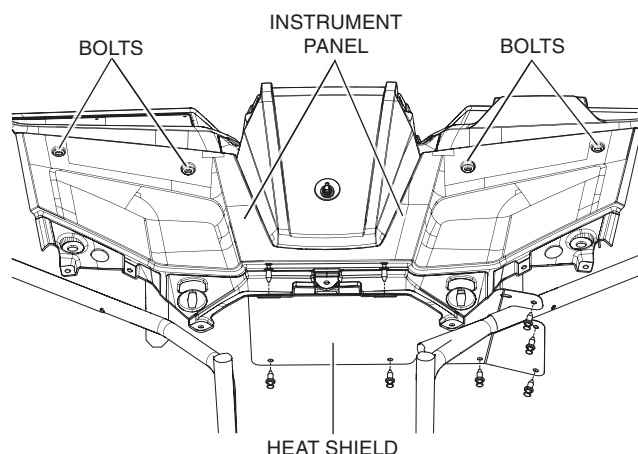

- Attach the rubber trim to the small tab on the washer tank bracket, then connect the washer tank to the washer tank bracket using two M6 × 20 mm button head bolts and two M6 nyloc nuts as shown.

NOTE: Ensure the rubber trim does not cover the hole on the tank bracket tab.

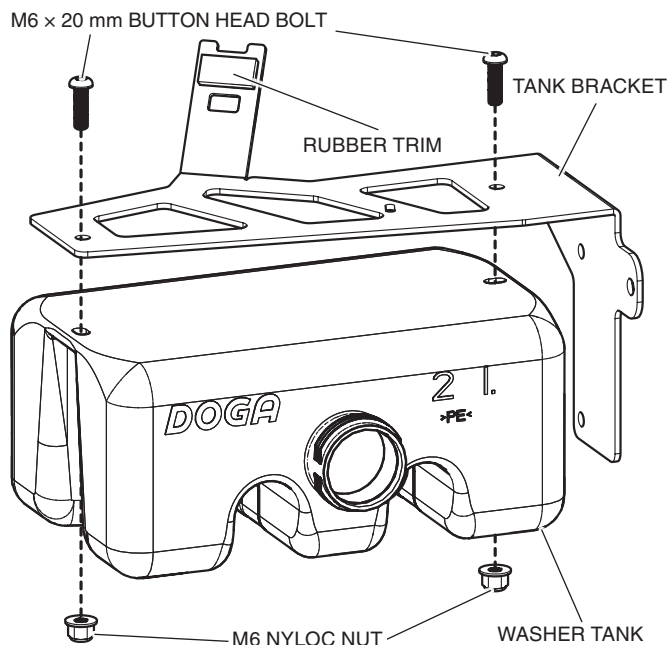

- Remove the clip securing the wiring harness to the frame, then move the wiring harness out of the way. Fit the washer tank into the hood compartment using two P-Clamps, two M6 × 20 mm button head bolts, two M6 nyloc nuts and one cable tie as shown.
- Route a second cable tie through the open slot in the washer tank bracket. Attach the wiring harness to the washer tank bracket using the cable tie as shown.

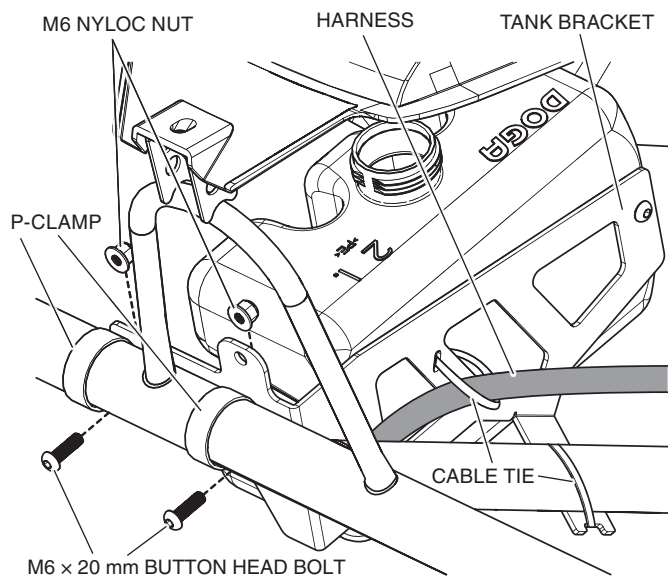

- Insert the wiring harness clip into the hole in the washer tank bracket.

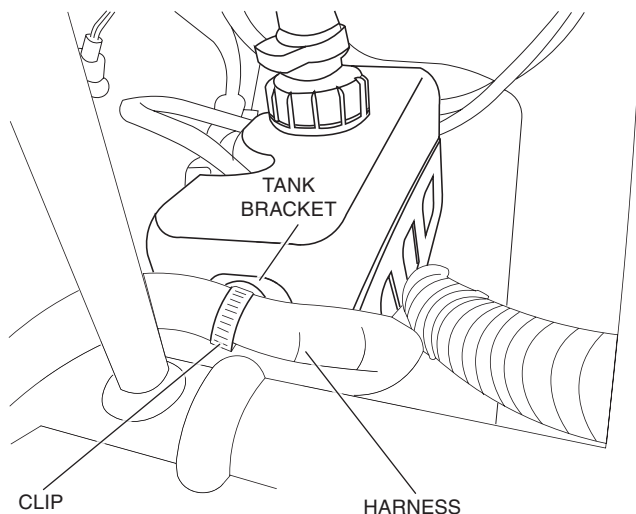

- Cut out the included drill template and place it into the recessed area on top of the instrument panel. Mark the location of the drill hole using a pencil, then remove the template. Drill a hole in the dash panel with a 1 1/4 inch hole saw bit using the marked lined as a guide.

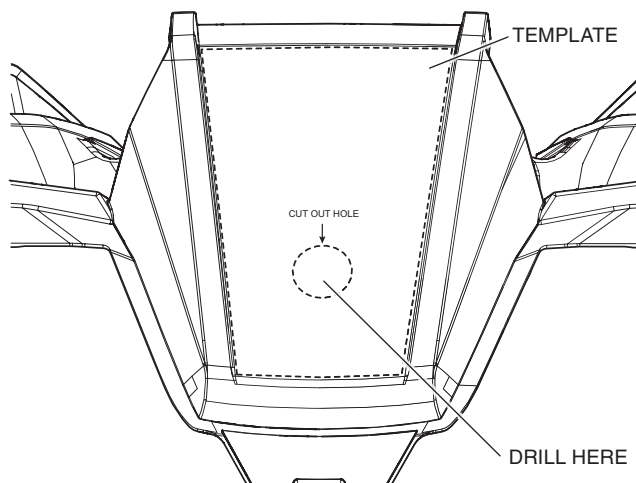

9. Fix the wiper motor to the motor bracket using two M6 × 20 mm button head bolts. The spindle on the motor should be on the same side of the bracket as the two mounting tabs at the ends of the bracket as shown.

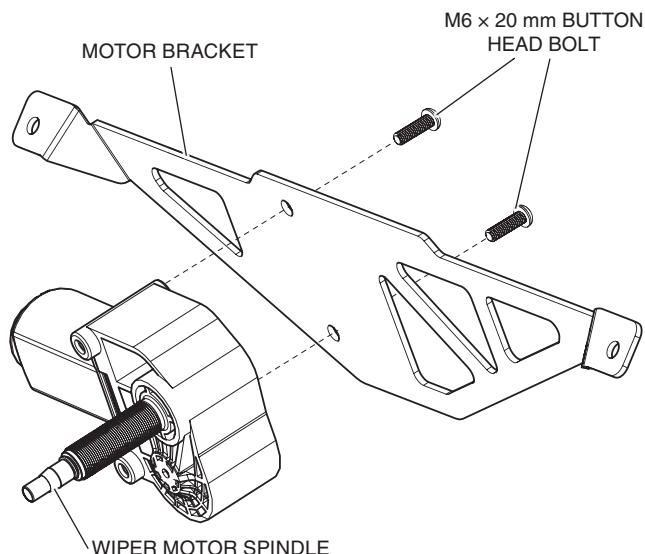

10. Position the motor bracket underneath the edge of the vehicle body panel, lining up the holes in the bracket with the holes in the body panel. The spindle of the wiper motor will protrude through the drilled hole. With the bracket held in place, reinstall the instrument panel. Two of the bolts used to reinstall the panel will hold the bracket in place.

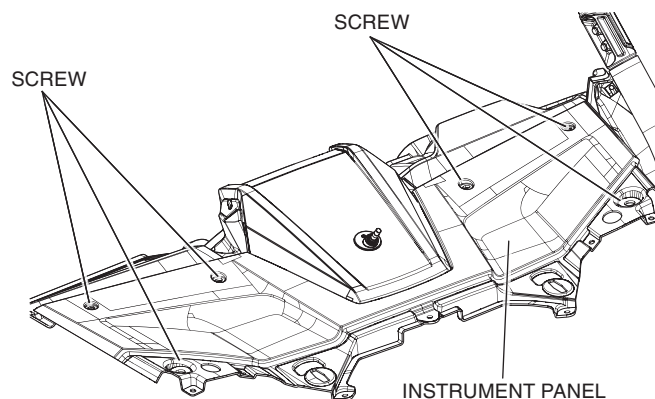
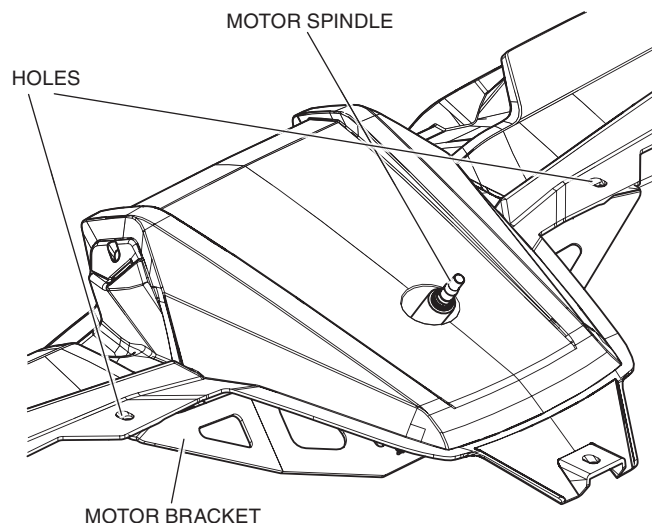

11. Fit the spindle grommet into the drilled hole in the dash panel such that the motor spindle protrudes through the central hole of the spindle grommet as shown.

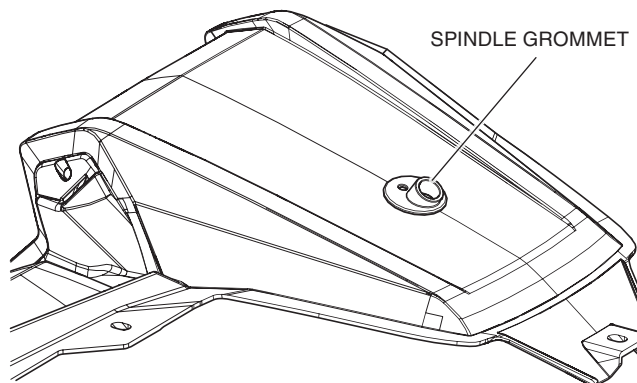

12. Attach the filler bracket to the end of the filler spout using two M6 × 20 mm button head bolts and two M6 nyloc nuts as shown.

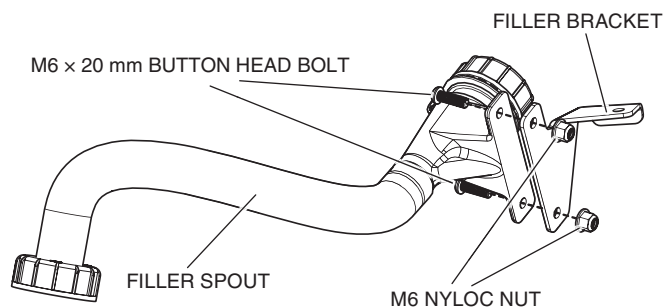

13. Screw the end of the filler spout onto the top of the washer tank as shown.

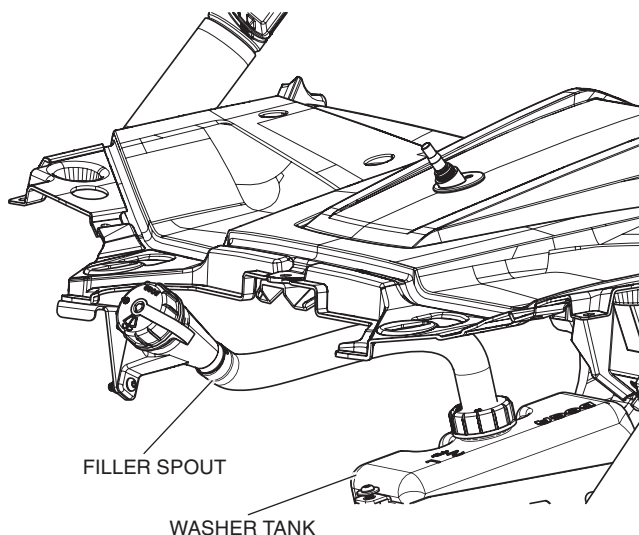

14. Attach the filler bracket to the front edge of the instrument panel using the original instrument panel bolt.

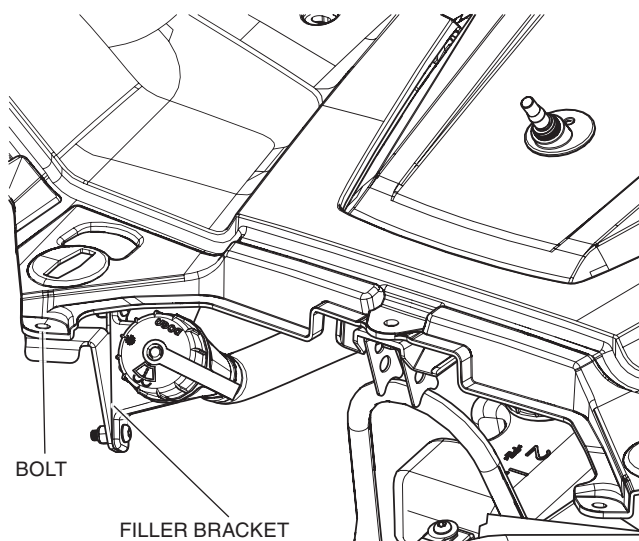

15. Connect the wiring harness to Fuse Box. Connect supplied harness to washer and wiper motors as shown.
(The fuse box is not shown in image.)

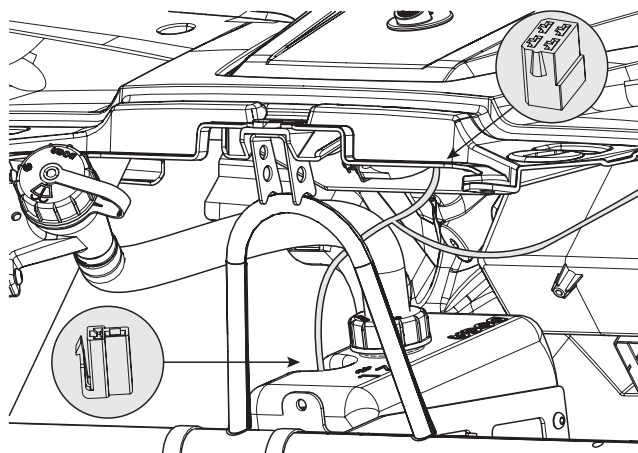

16. Connect the supplied harness to an open power connector on the fuse box. Make sure the load on that fuse is not more than the rated fuse size.

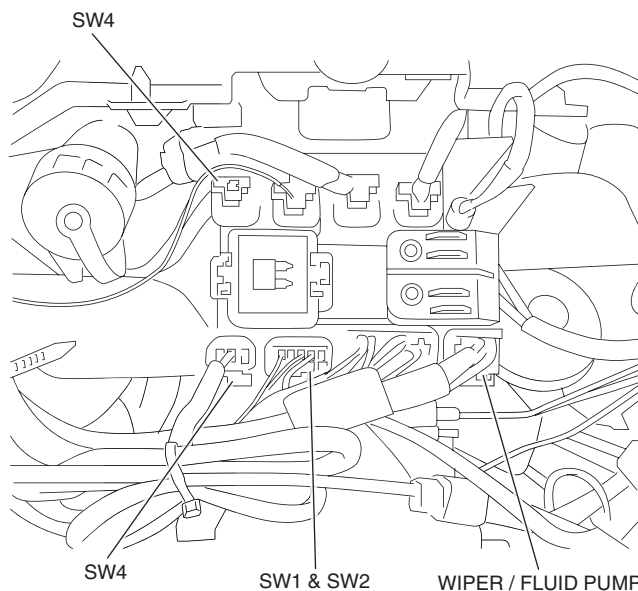

17. Place the plastic cap over the wiper spindle then fit the wiper arm, 8 mm toothed washer and 8 mm spindle nut over the motor spindle. Fasten loosely so the wiper arm can rotate.

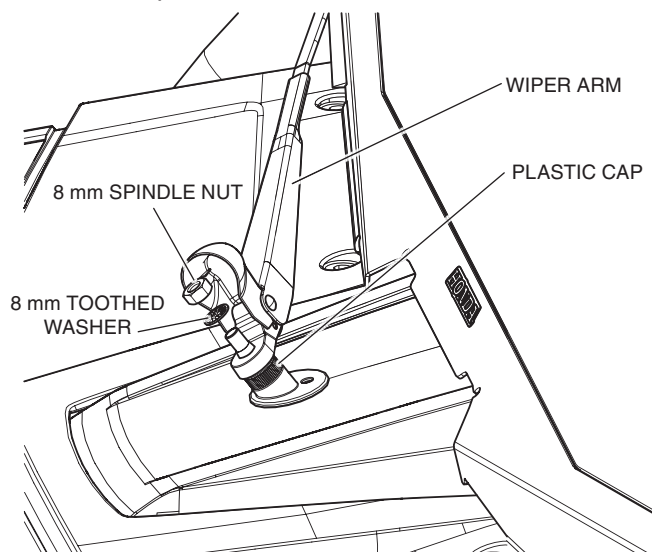

18. Route the washer hose on the wiper arm through the opening on the spindle grommet. Attach the open end of the hose to the washer motor as shown.

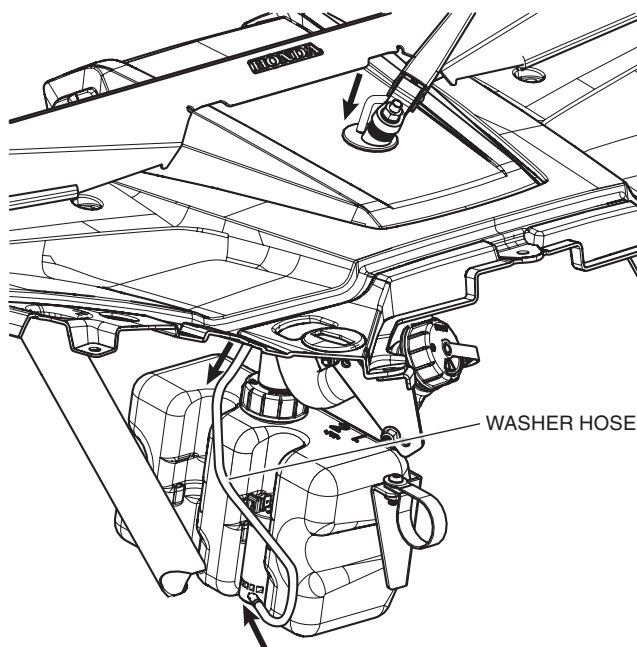

19. Reinstall the glass windshield per the windshield instructions, then attach the wiper blade to the wiper arm.

20. Position the wiper arm as shown, then tighten the 8 mm spindle nut to hold the wiper arm in place.

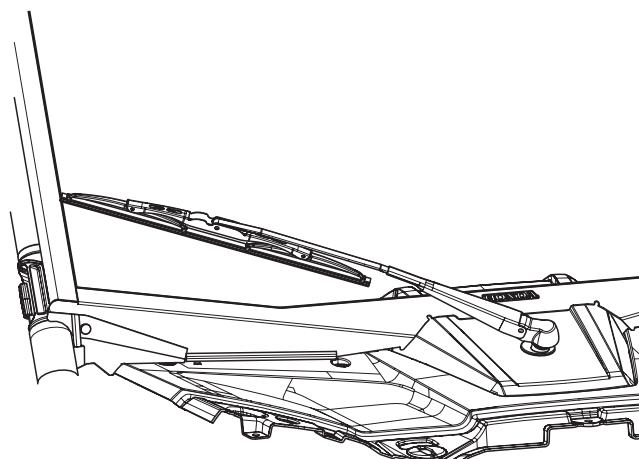

21. Remove the Switch Blank. Use care to not damage, as they need to be used again.

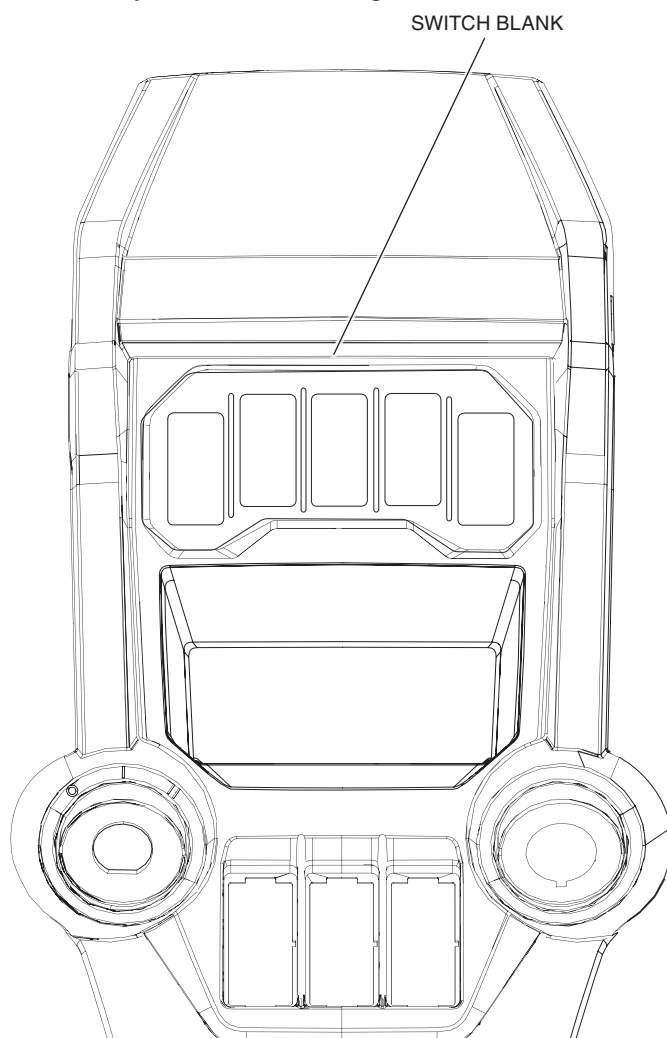

22. Fit the Wiper/Fluid switch into the open slot.
Connect to related wiring from Fuse Box Mount Kit.

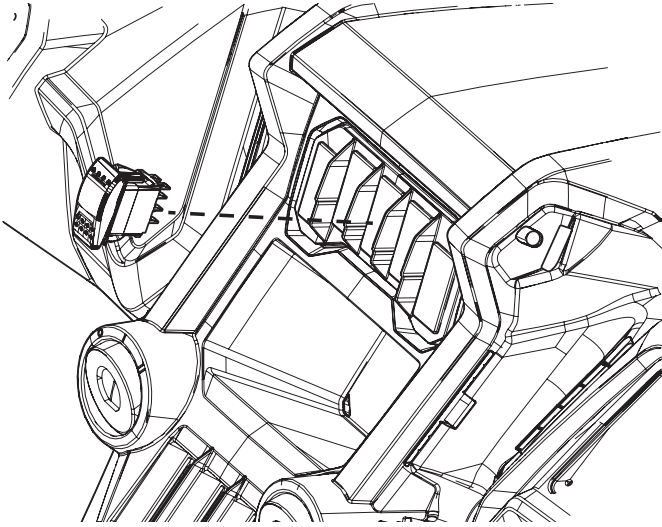

23. Fill the washer tank with windshield washer fluid.
24. Reinstall the heat shield and the hood of the vehicle.
25. Test the function of the windshield/washer.
- Switch DOWN: Off
 - Switch UP: Wiper On
 - Switch pressed and held UP: Wiper and Washer On



SCALE
10 20 30 40 50mm

SCALE
10 20 30 40 50mm

CUT OUT HOLE

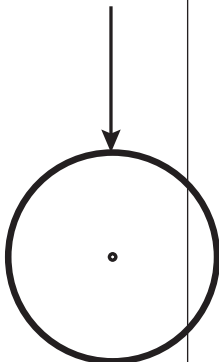

NOTICE
If you print this template from your local computer, make sure the printer settings do not "scale" or "shrink" the page.

<TEMPLATE>