



# INSTALLATION INSTRUCTIONS

Accessory

FABRIC UPPER DOORS  
P/N 0SR90-HL6-A01

Application

SXS1000S2X  
SXS1000S2R

Publication No.

MII 16561

Issue Date

January 2026

Honda Dealer: Please give a copy of these instructions to your customer.

## PARTS LIST

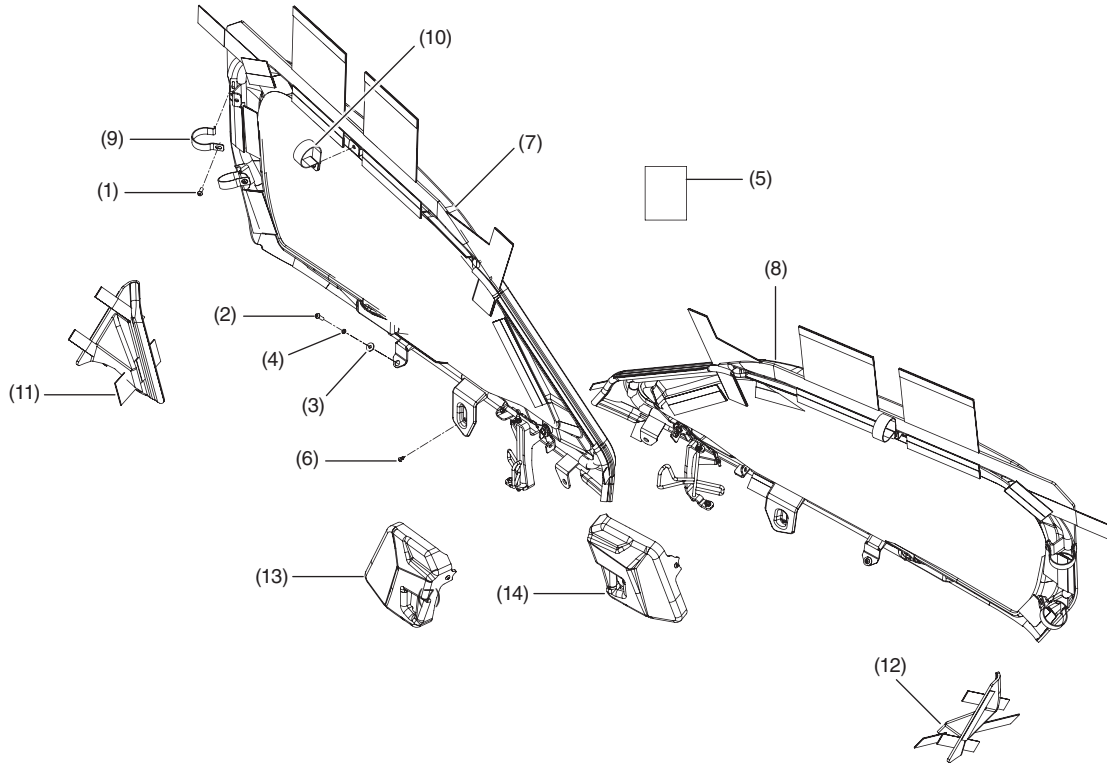

No.	Description	Qty
(1)	4 x 16 mm button head screw	12
(2)	4 x 20 mm button head screw	2
(3)	Fender washer	2
(4)	Spring lock washer	2
(5)	Installation Instructions URL	1
(6)	Phillips head screw	2
(7)	Driver side Upper Door	1
(8)	Passenger side Upper Door	1
(9)	C-Clamp	4
(10)	P-Clamp	2
(11)	Driver side Rear corner	1
(12)	Passenger side Rear corner	1
(13)	Driver side Handle cover	1
(14)	Passenger side Handle cover	1
(15)	Zipper Lubricant (Not Shown)	1

## TOOLS REQUIRED

- 4 mm Hex head socket
- 5 mm Hex head socket
- 6 mm Hex head socket
- Phillips screwdriver
- Two 7 mm open end wrenches
- 10 mm Socket
- Torque wrench

## TORQUE CHART

Tighten all screws, bolts, and nuts to their specified torque values. Refer to the Service Manual for the torque values of the removed parts.

Item	N-m	kgf-m	lbf-ft
4 x 16 mm button head screw	11	1.1	8.5
4 x 20 mm button head screw	11	1.1	8.5
Self-Tapping Phillips head screw	1	0.1	0.8

## Care and Maintenance

Routinely clean and lubricate the window zipper using the suppliers lubricant.



# INSTALLATION

1. Remove original bolts and washers from roof.

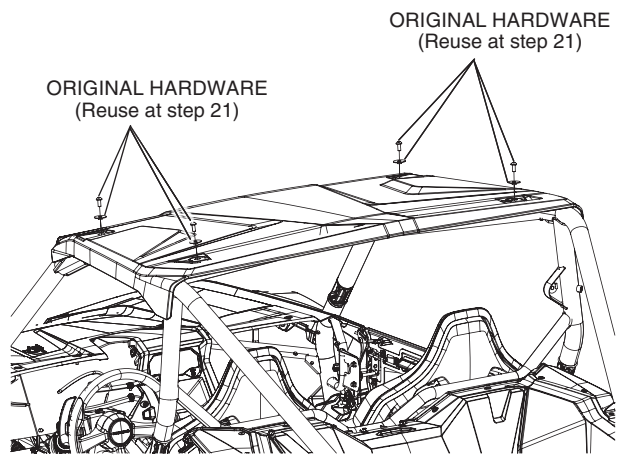

2. Remove original net attachment from driver side door.

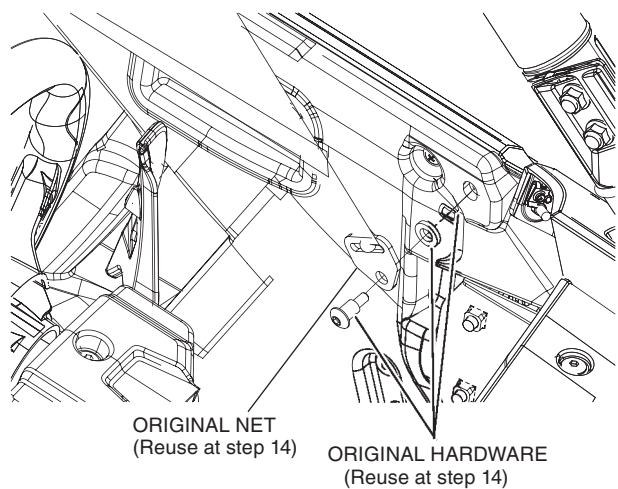
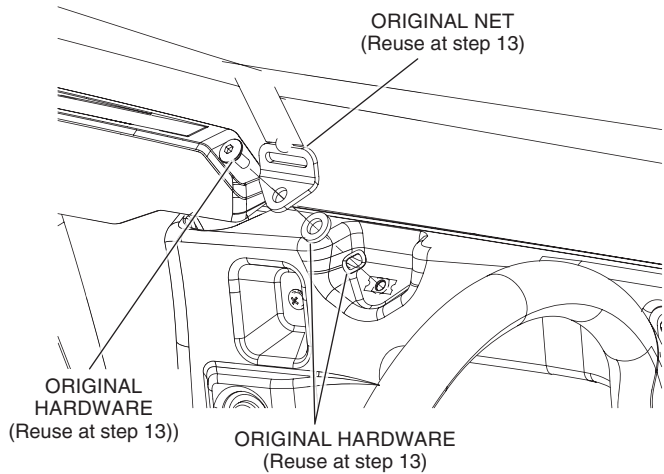

3. Remove original hardware from door.

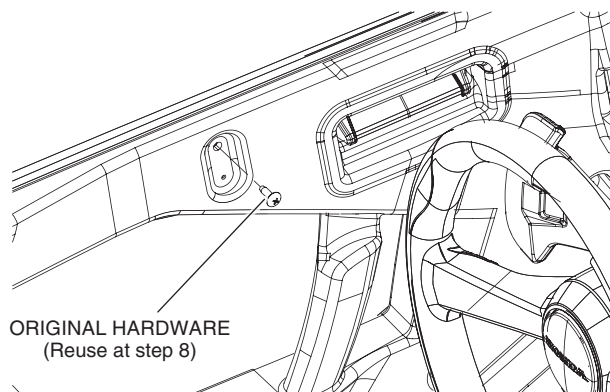

4. Install a P-clamp on the top driver side OPS bar (as shown).

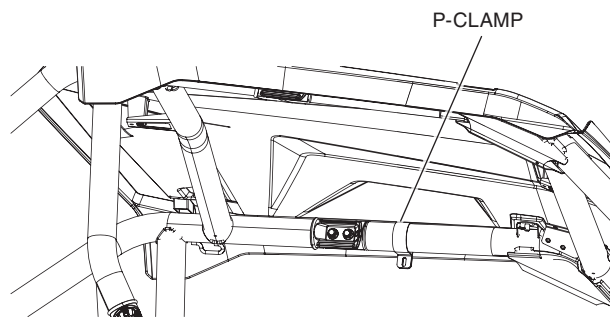

5. Install two C-clamps on the vertical OPS tube (as shown).

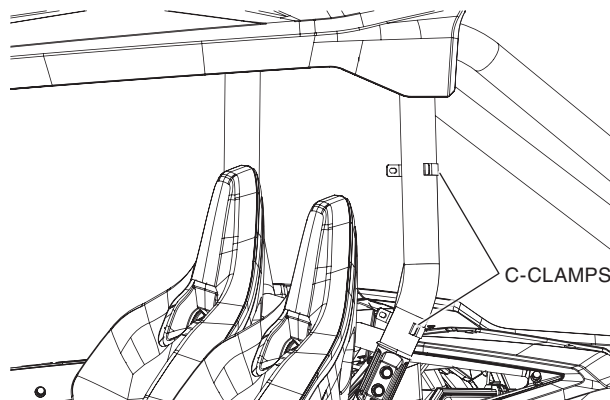

- Place the Fabric Upper Door on the original door making sure the top section is under the original roof. Make sure the holes are lined up.

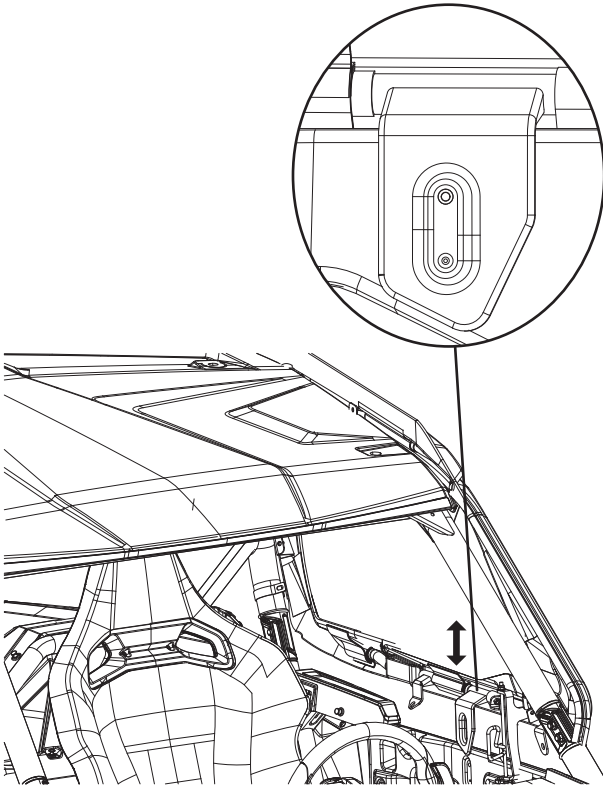

- Wrap the two upper straps on the Fabric Upper Door around the top OPS bar. Position one strap on each side of the previously installed P-Clamp (as shown).

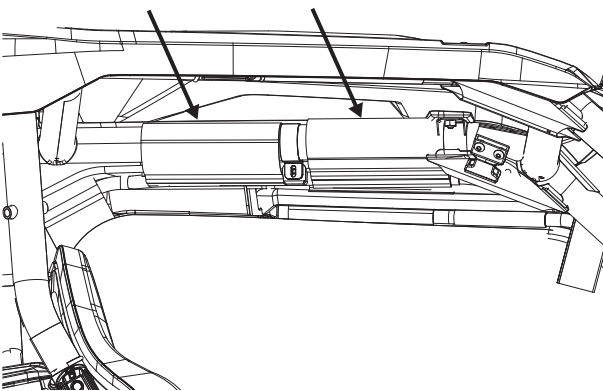

- Use a self-tapping phillips head screw and the original bolt to secure the bracket on the Fabric Upper Door to the original door and tighten.

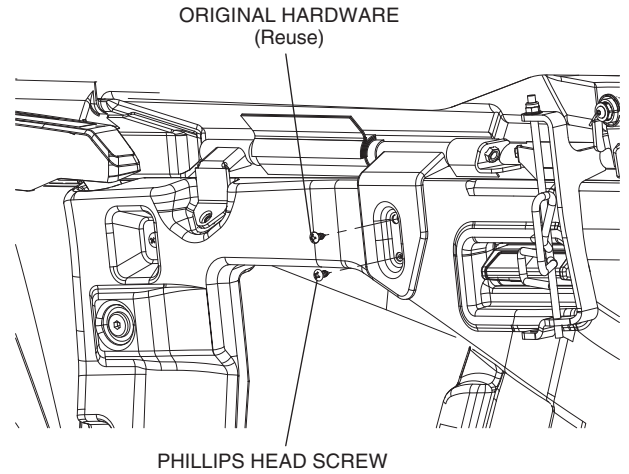

- Unzip the window. Install the driver side Fabric Upper Door on the C-clamp using two 4 x 16 mm button head screw. Do not tighten.

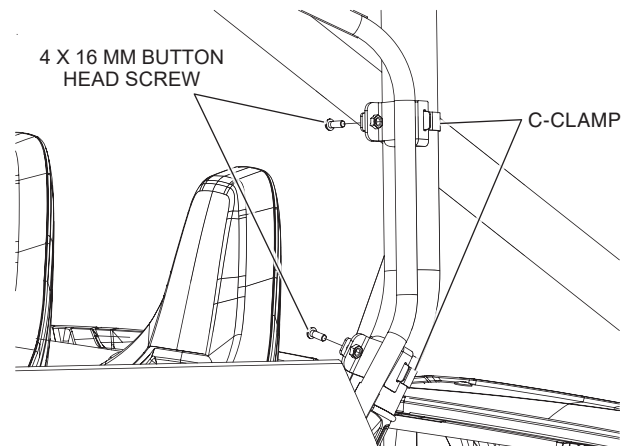

- Install the Fabric Upper Door on the P-clamp at the highest position possible then tighten.

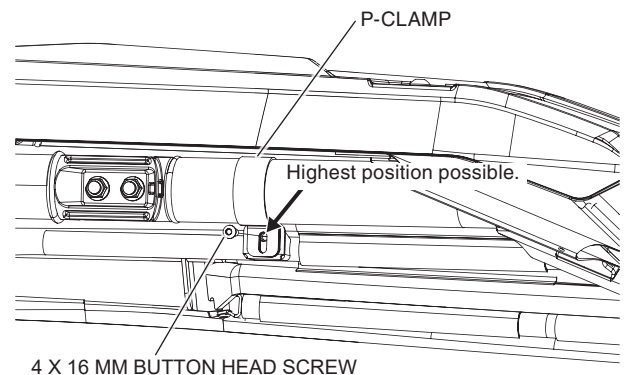

11. Wrap the upper strap on the Fabric Upper Door around the vertical OPS at the highest position possible then tighten.

Highest position possible.

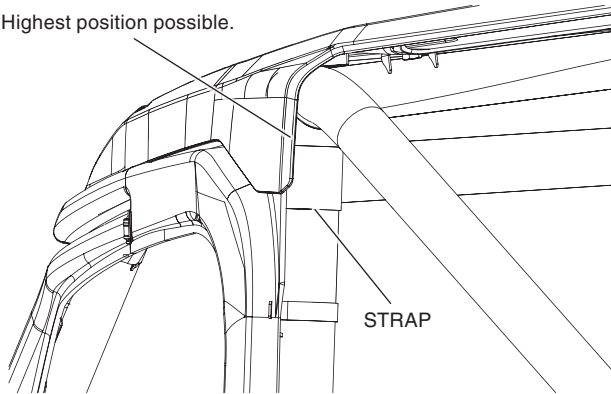

12. Tighten the previously installed hardware.

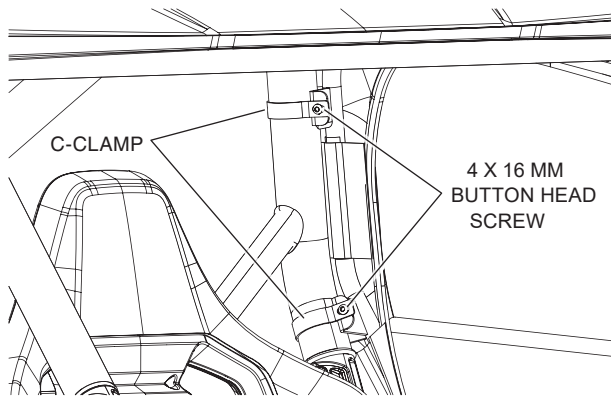

13. Install the original net on the door using the original hardware and a 4 x 20 mm button head screw, spring lock washer and fender washer (as shown).

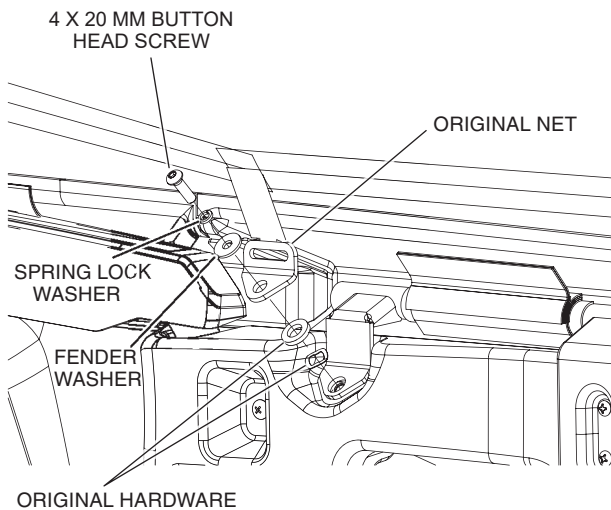

14. Install the original net on the door using the original hardware (as shown).

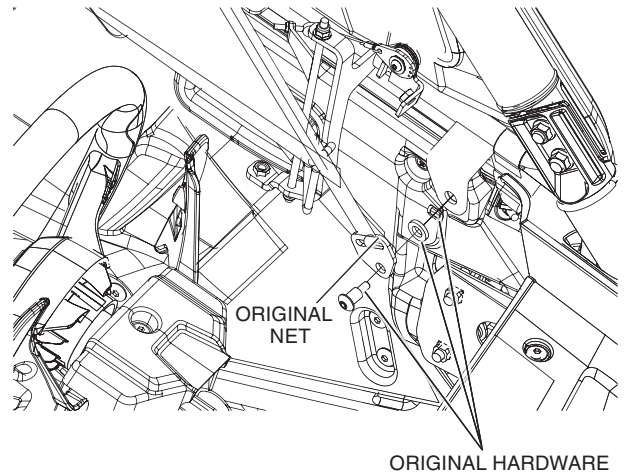

15. Wrap the front strap on the Fabric Upper Door around the front OPS tube then tighten.

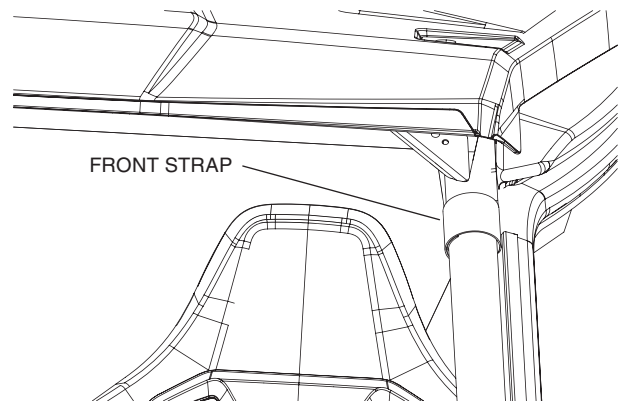

16. Position the handle so it fits and operates in the hole. Adjust the pin up and down using the two flange nylon nuts to achieve the best fit.

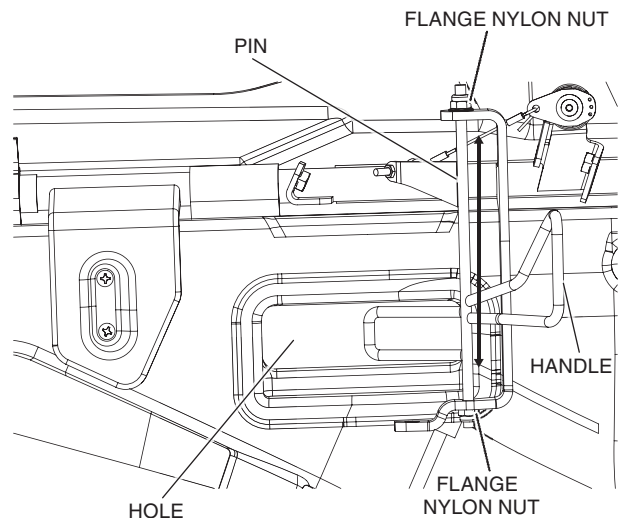

- Set the tension on the Fabric Upper Door by adjusting the 4 mm nuts on the eyebolt (as shown). Make sure the outside handle works properly.

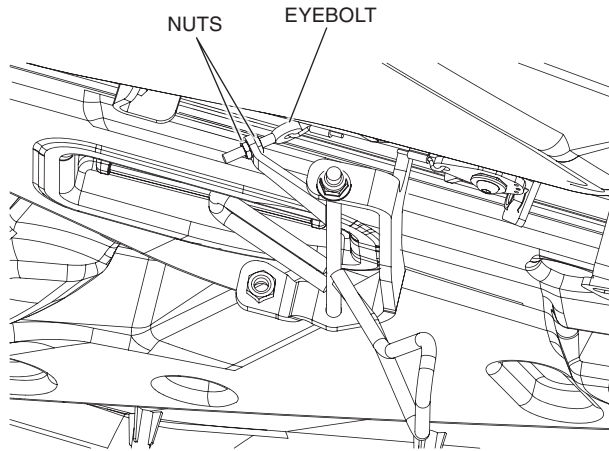

- Install the Driver Side Handle Cover using three 4 x 16 mm button head screws (as shown).

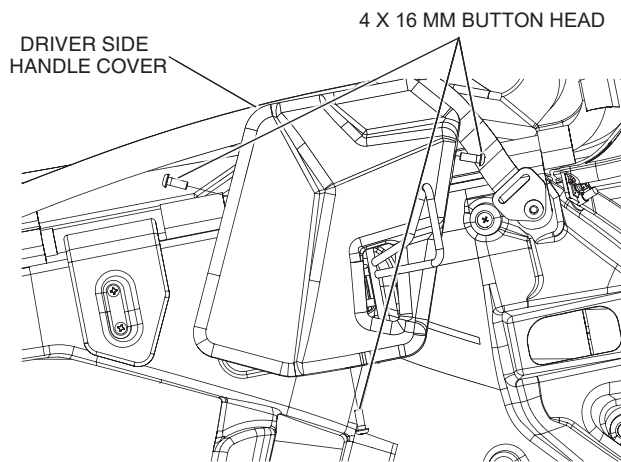

- Attach the Driver Side Rear Corner to the Fabric Upper Door using the hook and loop sections (as shown).

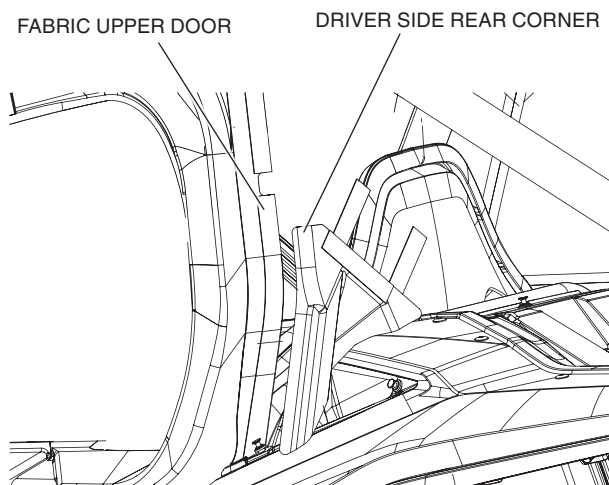

- Attach the Fabric Upper Door, the driver side rear corner, and the Rear Panel (if installed) using the hook and loop sections (as shown).

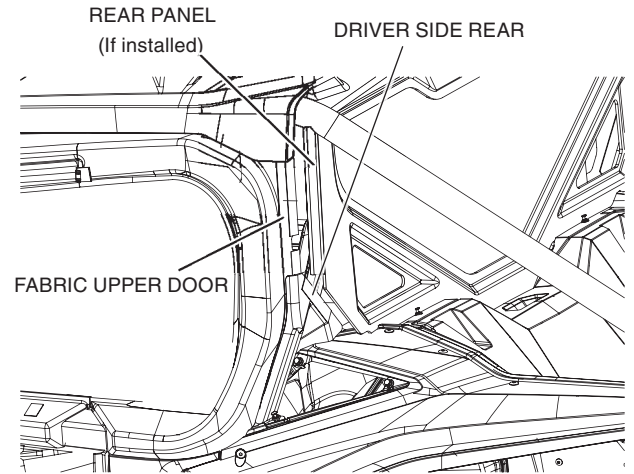

- Reinstall the roof using the original hardware.

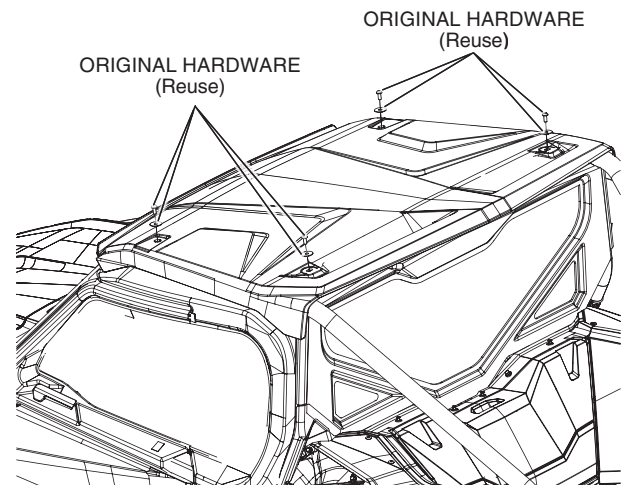

- Adjust the previously installed straps on the OPS bars and those on the Fabric Upper Door steel frame as needed to achieve the best fit.
- Repeat step 1 through 22 on the passenger side door.
- Tighten all the bolts to the values specified in the TORQUE CHART.

# Replacement Parts List

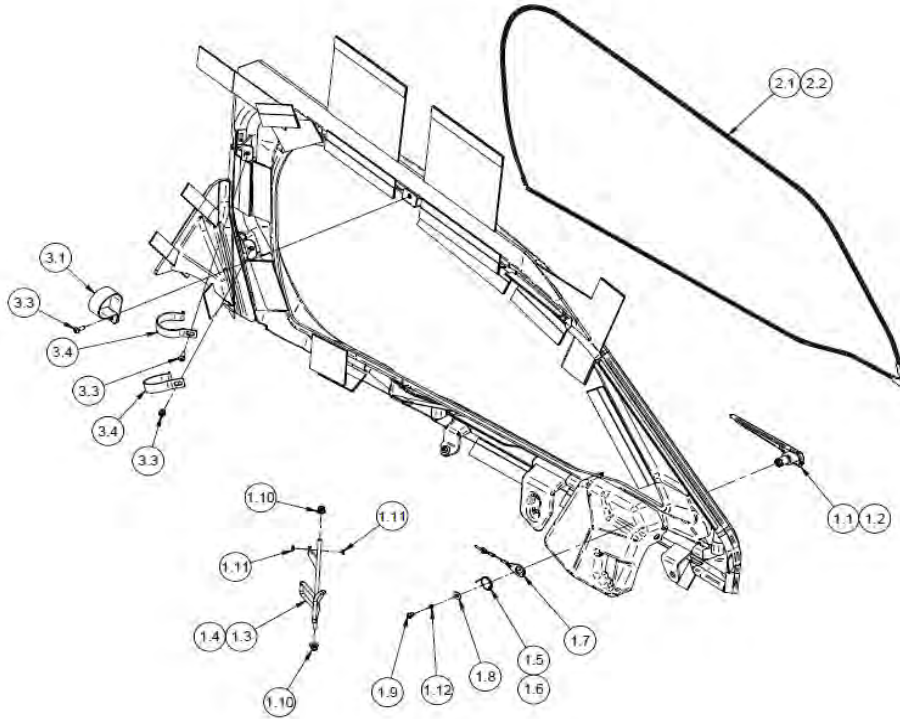

NO	DESCRIPTION	PART NUMBER	QTY
<b>1</b>	<b>FRONT HANDLE SERVICE KIT (L/R) (2P)</b>	<b>OSR90-HL6-A0K1</b>	<b>1</b>
1.1	OUTSIDE DRIVER SIDE HANDLE		1
1.2	OUTSIDE PASSENGER SIDE HANDLE		1
1.3	INSIDE DRIVER SIDE HANDLE		1
1.4	INSIDE PASSENGER SIDE HANDLE		1
1.5	DRIVER SIDE TORSION SPRING		1
1.6	PASSENGER SIDE TORSION SPRING		1
1.7	FRONT WIRE ASSEMBLY		2
1.8	FENDER WASHER M5		2
1.9	BUTTON HEAD M5-0.8 X 8MM		2
1.10	HEX NYLON NUT M6-1		4
1.11	HEX THIN NUT M4-0.7		4
1.12	SPRING LOCK WASHER M5		2
<b>2</b>	<b>VINYL WINDOW SERVICE KIT (2P)</b>	<b>OSR90-HL6-A0K2</b>	<b>1</b>
2.1	DRIVER SIDE VINYL WINDOW		1
2.2	PASSENGER SIDE VINYL WINDOW		1
<b>3</b>	<b>HARDWARE SERVICE KIT (2P/4P)</b>	<b>OSR90-HL6-A0K3</b>	<b>1</b>
3.1	P-CLAMP 2" TUBE		6
3.2	BUTTON HEAD M6-1 X 14MM (4P P-CLAMP FRONT DOOR)		4
3.3	BUTTON HEAD M6-1 X 16MM		10
3.4	CLAMP HOOK		4
3.5	CLAMP HOOK FRONT DOOR (4P ONLY)		4