



# INSTALLATION INSTRUCTIONS

Accessory

FUSE BOX WIRING KIT  
P/N 0SS26-HL4-A00

Application

SXS1000M3P/M3D/M3LS/  
M5P/M5D/M5LS

Publication No.

MII 17762

Issue Date

March 2022

**Honda Dealer: Please give a copy of these instructions to your customer.**

## PARTS LIST

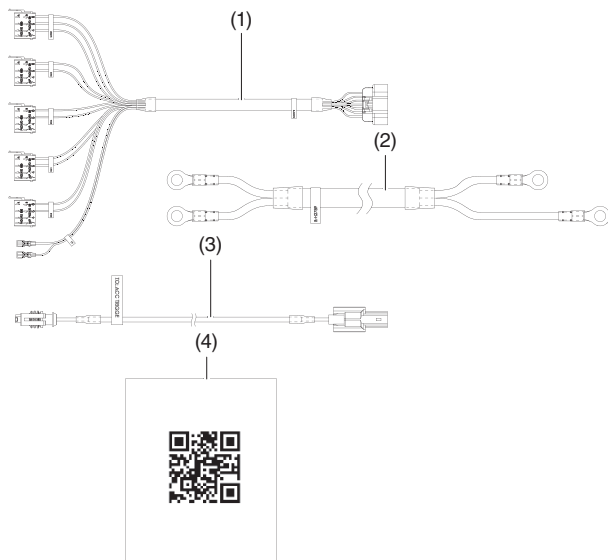

No.	Description	Qty
(1)	Switch Wire Harness	1
(2)	Power & Ground Cable	1
(3)	Ignition Power Wire	1
(4)	Installation Instructions URL	1

## TOOLS REQUIRED

Torque wrench or driver

Socket (7 mm)

Socket (10 mm)

#2 phillips head screwdriver/bit

Trim clip removal tool

Tape

Fuse box

Sold separately (P/N 0SS25-HL4-A00)

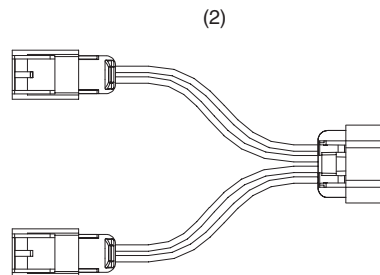
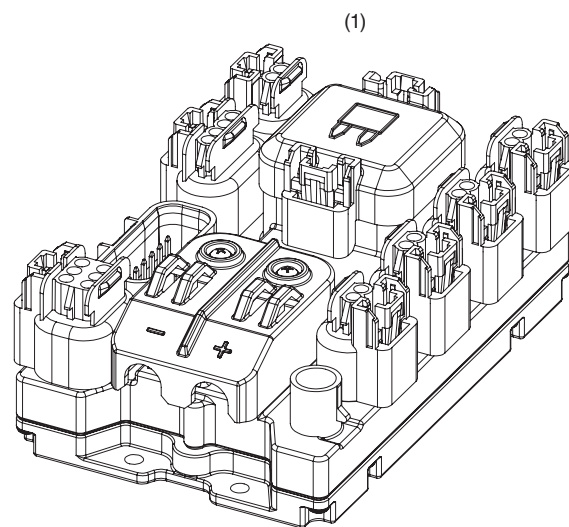

No.	Description	Qty
(1)	Fuse Box	1
(2)	Harness, 4-pin to 2-pin (Y-splitter)	1

Fuse Box & Audio Mount Bracket  
Sold separately (P/N 0SS27-HL4-A00)  
If already owned from installing Audio Kit,  
there is no need for an additional bracket.

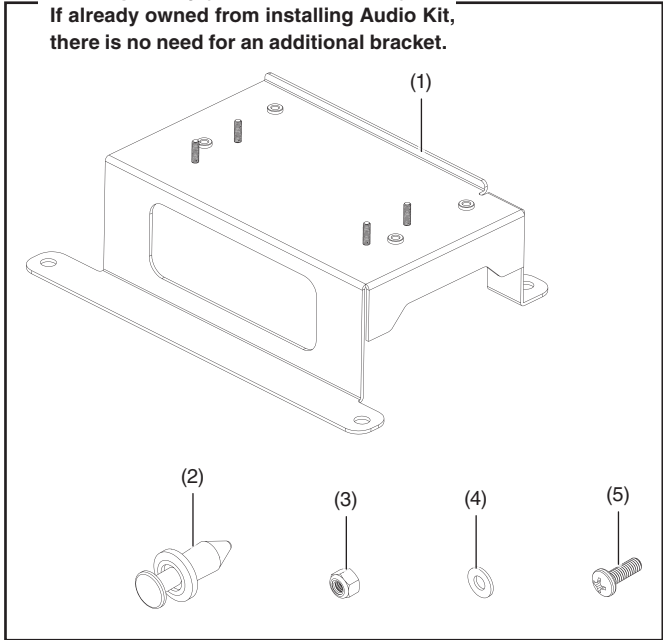

Item	Description	Qty
(1)	Mounting Bracket	1
(2)	Trim Clips	4
(3)	M4 × 0.7, Locking Hex Nut	4
(4)	M4 Flat Washer	8
(5)	M4 × 12 mm Phillips Pan-head Screw	4

TORQUE CHART

Item	N·m	kgf·m	lbf·ft
7 mm Locknut	4.2	0.4	3.1
10 mm Nut	12.0	1.2	9.0
Phillips Head Screw	2.5	0.3	2.0

FUSE BOX WIRING KIT INSTALLATION

1. Remove the hood by twisting the two hood locks and pulling the hood forward and off the vehicle.

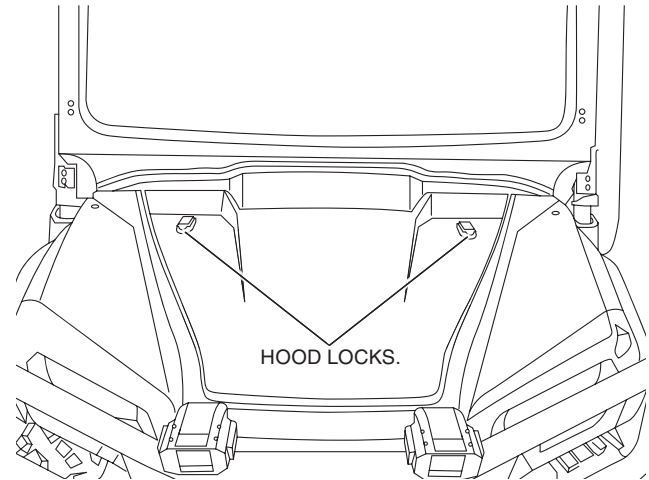

2. With the four 4mm, threaded posts facing up, place the fuse box on the mount bracket.

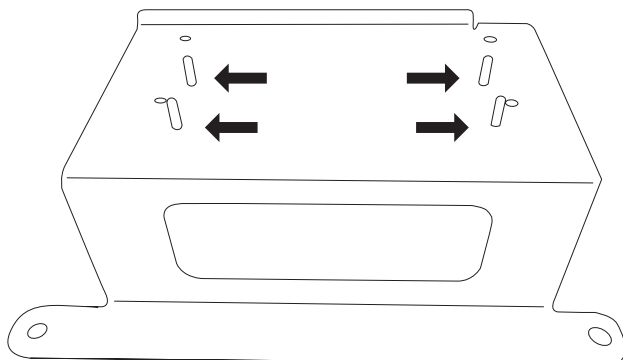

**NOTE:** The Fuse Box will only fit on the studs in one direction. If it does not slide on the posts, rotate the Fuse Box 180 degrees.

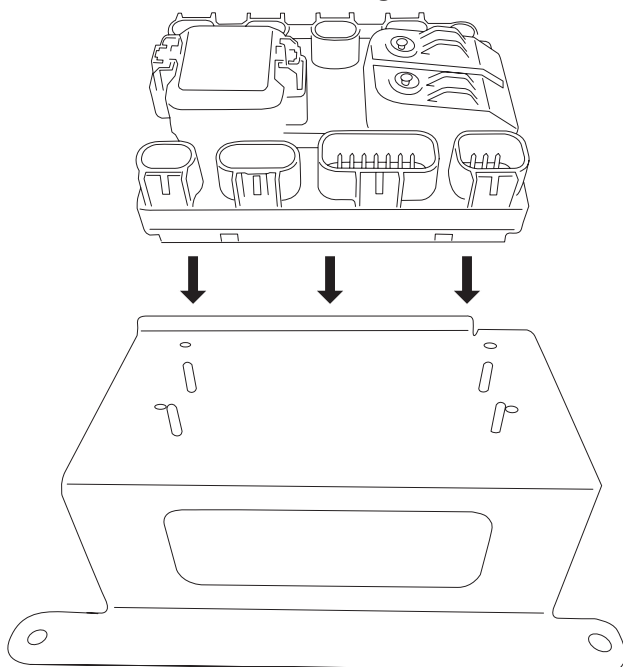

3. Remove the two (2) Phillips's head screws to detach the input terminal cover.

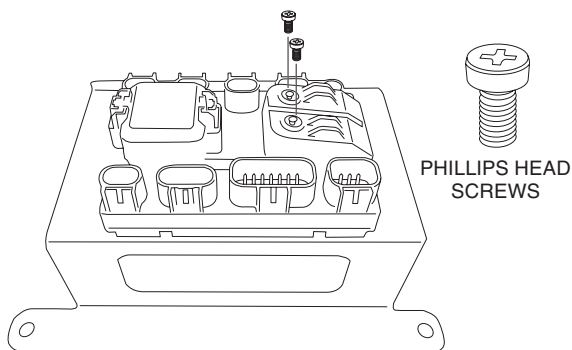

4. Secure the Fuse Box to the mount bracket studs using the four supplied 4mm lock nuts and washers.

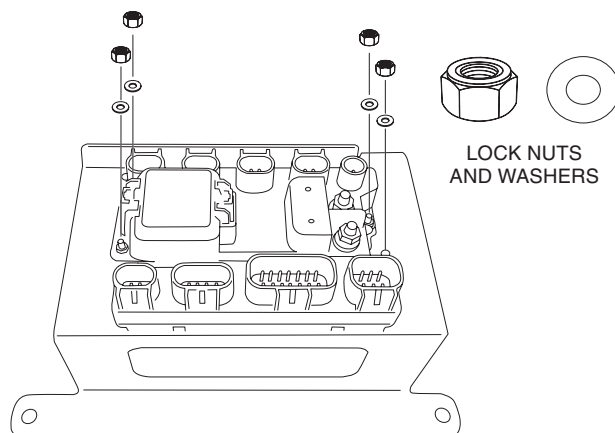

**NOTE:** To avoid a short you will be installing the power and ground cable to the fuse box first then connecting to the vehicle's battery in a later step.

5. Using a 10 mm socket, remove the input terminal nuts and attach the Power and Ground Cable using the previously removed 10 mm nuts.

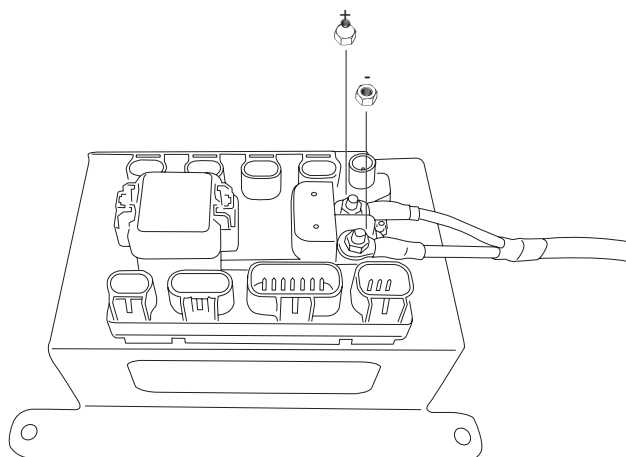

6. Remove the three trim clips from the unit as shown in the image below.

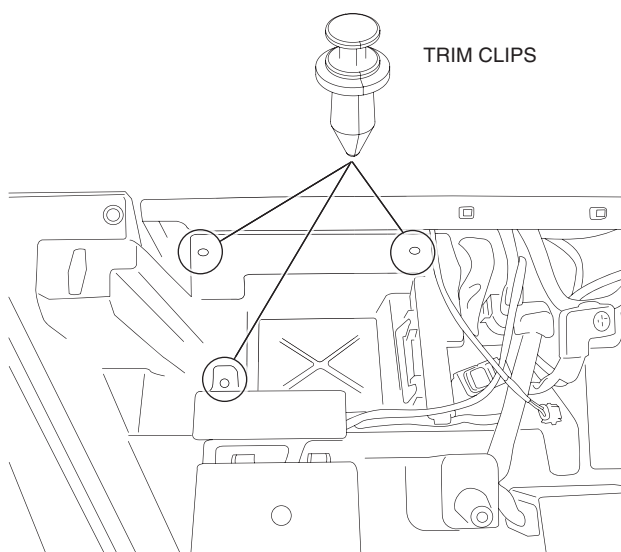

7. Slide the fuse box and mount bracket under the relay fuse box cover and replace the trim clips. Use the remaining trim clips supplied with your mount bracket to secure the two rear mounting points.

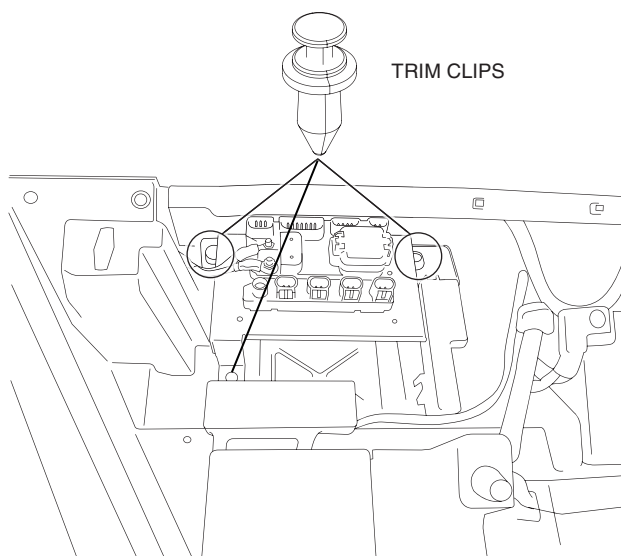

8. Route the power and ground cables along the cross bar at the rear of the under-hood compartment over to the battery. Secure with zip ties if needed (not included).

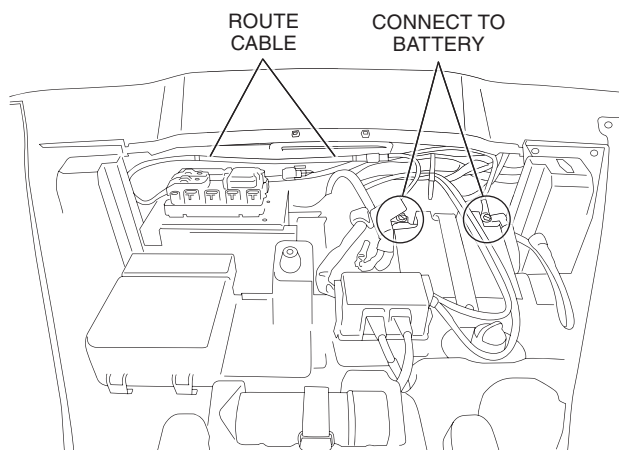

**NOTE: Connect the positive (+) cable to the battery first. Then connect the ground cable (-).**

9. Connect the switch wire harness cable connector to the Fuse Box.

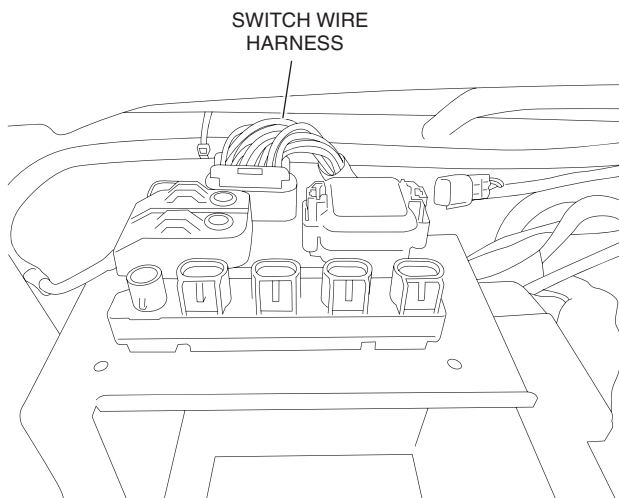

**NOTE: Fuse box comes with six (6) Weatherproof Caps installed for protection. Leave caps on connectors that are not to be used.**

**NOTE: Kit includes a 4-Pin to 2-Pin Harness to be used with additional Honda accessories. Please consult your local Honda dealer for more accessory options.**

10. Route wires towards the desired switch locations.

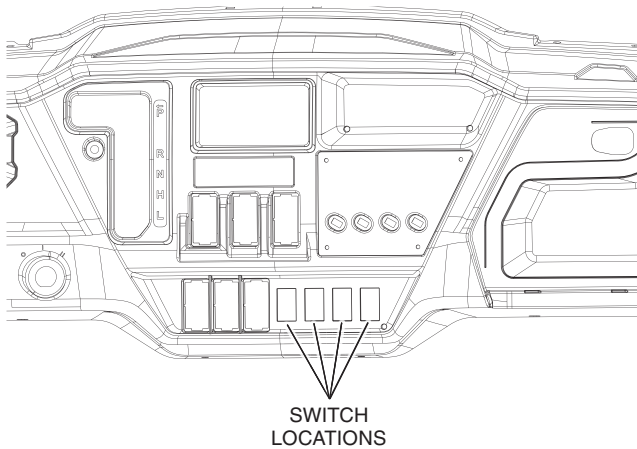

11. Locate the connector wrapped in blue tape near the battery. Proceed to remove the tape and cap. Set the cap aside to be used on the next step.

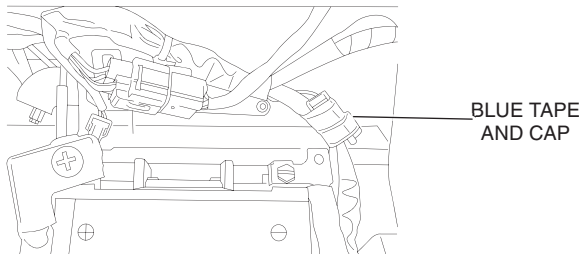

12. Connect the ACC Trigger Input Wire supplied according to the diagram and steps below.

12a. Plug connector shown into the vehicle harness

12b. Reinstall connector cap from step 11 onto harness

12c. Connect ACC Trigger Input Wire to TRIG port on Fuse Box

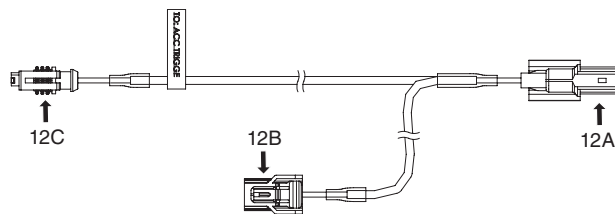

13. Secure harness with zip ties as needed (not provided).

14. Reinstall hood.