



INSTALLATION INSTRUCTIONS

Accessory

POWERED SUBWOOFER
P/N 0SS22-HL4-A50

Application

**SXS1000M3P/M3D/M3LS/
M5P/M5D/M5LS**

Publication No.

MII 17762

Issue Date

April 2022

Honda Dealer: Please give a copy of these instructions to your customer.

PARTS LIST

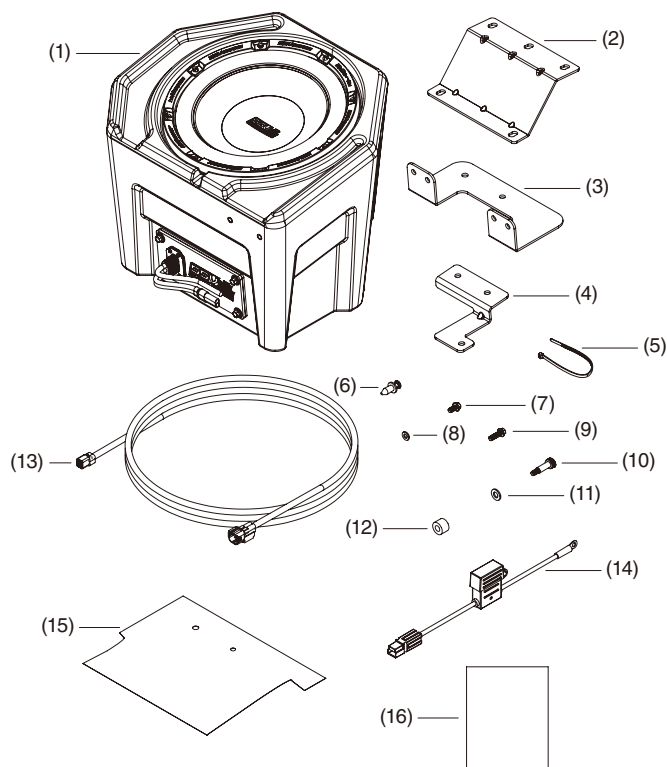

No.	Description	Qty
(1)	Powered subwoofer enclosure	1
(2)	Upper outside bracket	1
(3)	Lower center bracket	1
(4)	Upper inside bracket	1
(5)	10" zip ties, black	5
(6)	Plastic push-in snap rivet, 8 mm	1
(7)	M6 × 12 mm, hex head flange screw	10
(8)	M6 flat washer	11
(9)	M6 × 20 mm, hex head flange screw	1
(10)	M6 × 31 mm screw/20 mm shoulder (8 mm)	1
(11)	M8 flat washer	1
(12)	Vibration dampening bushing	1
(13)	Subwoofer extension harness	1
(14)	In-line fuse holder	1
(15)	Bottom bracket drill template	1
(16)	Honda instructions	1

TOOLS REQUIRED

Drill

Drill bit (5/16")

Torque wrench / driver

Allen bit (4 mm)

Socket (6 mm for 3-passenger models)

Socket (8 mm)

Trim clip removal tool

Tape

Blue liquid threadlocker

Fuse Box

Sold separately (P/N 0SS25-HL4-A00)

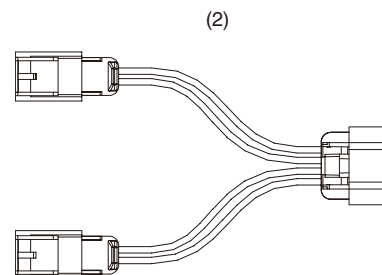
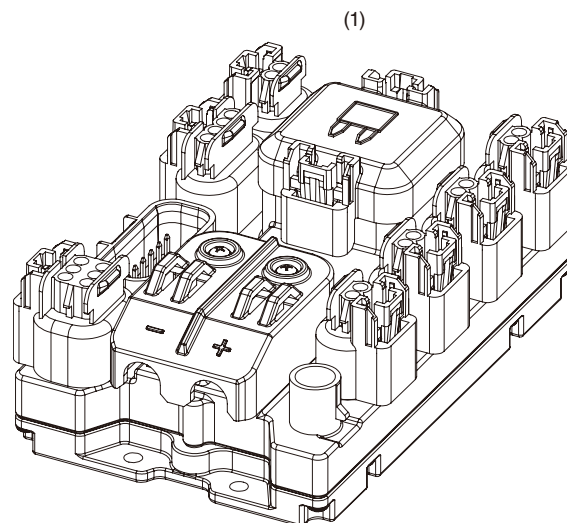

No.	Description	Qty
(1)	Fuse box switcher	1
(2)	Harness, 4-pin to 2-pin (Y-splitter)	1

Audio System & 2 Speakers (FR)
Sold separately (P/N 0SS22-HL4-A00)

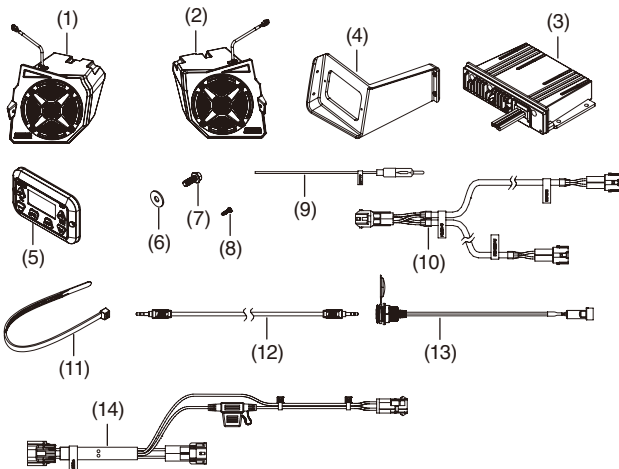

No.	Description	Qty
(3)	Driver side, front speaker pods, loaded 6.5" ssv speakers - hl4	1
(4)	Passenger, side, front speaker pods, loaded 6.5" ssv speakers - hl4	1
(5)	MRB3 black box	1
(6)	Mounting panel, mrb3, hl4	1
(7)	MRB3 controller	1
(8)	M6 flat washer	6
(9)	6 mm hex head bolt	6
(10)	#4-20 thread rolling screws	6
(11)	Universal fm antenna cable (55")	1
(12)	Harness, 4-pin speaker y-cable, 1x f recepticle and 2x m plugs, hl4 5-seat	1
(13)	Zip ties, 10 in	10
(14)	Harness, 3.5 mm mini-jack male to 3.5 mm mini-jack male cable (36")	1
(15)	Harness, aux input, 3.5	1
(16)	MRB3 power harness, hl6 & hl7	1

NOTE:
This accessory is not compatible with the UNDER SEAT STORAGE BOX or the WINDSHIELD WIPER & WASHER KIT.

Fuse Box Audio Bracket
Sold separately (P/N 0SS27-HL4-A00)
If already owned from installing Fuse Box, there is no need for an additional bracket.

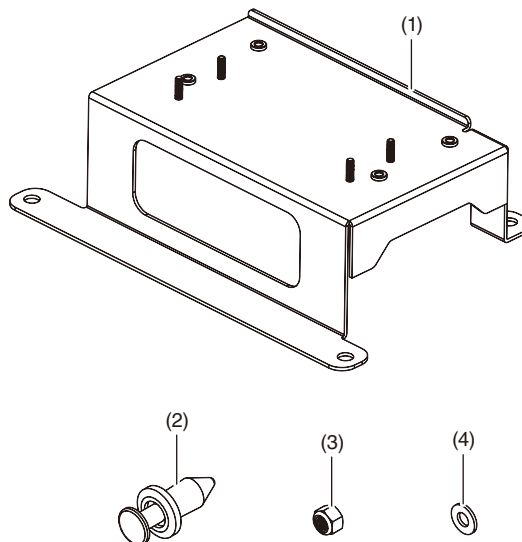

No.	Description	Qty
(1)	Mounting plate, fuse box, HL4	1
(2)	Snap rivet, push in style, 8 mm	4
(3)	M4 x 0.7, locking hex nut	4
(4)	M4 flat washer	8
(5)	M4 x 12 mm phillips pan-head screw	4

Fuse Box Wiring Kit
Sold separately (P/N 0SS26-HL4-A00)

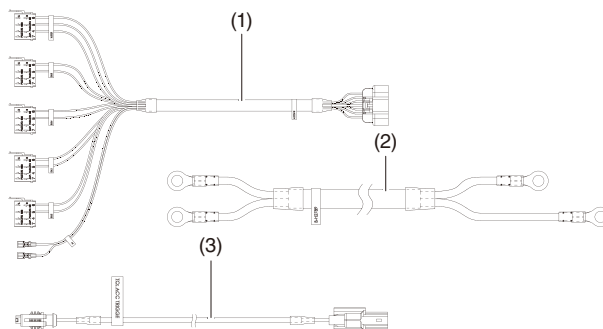

No.	Description	Qty
(1)	HL6 EVC switch wire harness	1
(2)	Power & ground input cables	1
(3)	Accessory trigger input wire	1

TORQUE CHART

Item	N·m	kgf·m	lbf·ft
8 mm flange screw (M6 thread)	7.8	0.8	5.8
4 mm allen screw (M6 thread)	7.8	0.8	5.8

SUBWOOFER KIT INSTALLATION

1. Using the seat release lever located in the middle front of the seat cushion, release the seat latch, and pull up and forward to remove the seat.

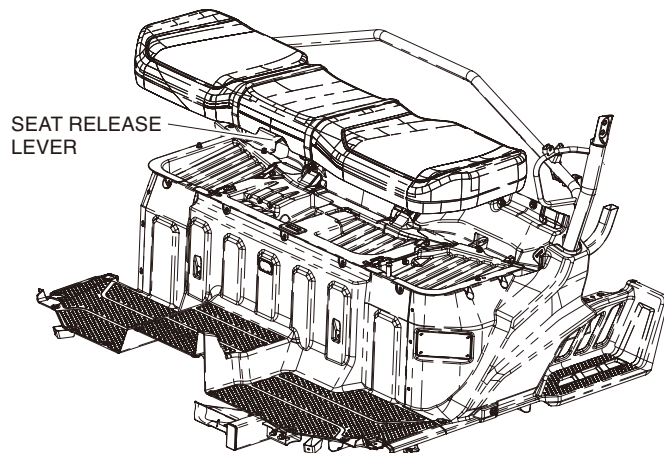

2. Remove the eight (8) trim clips that attach the under-seat panels to the seat frame and remove.

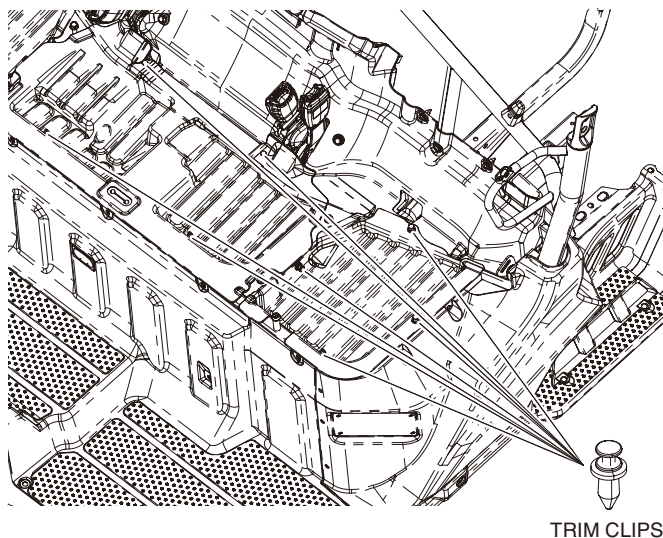

3. If you have a 5-seat vehicle proceed to step four (4).
For 3-seat vehicles remove (1) 6 mm Socket Hex bolt, the three (3) Allen bolts and six (6) trim clips securing the driver's side seat panel as shown. Remove panel from vehicle and skip to step six (6).

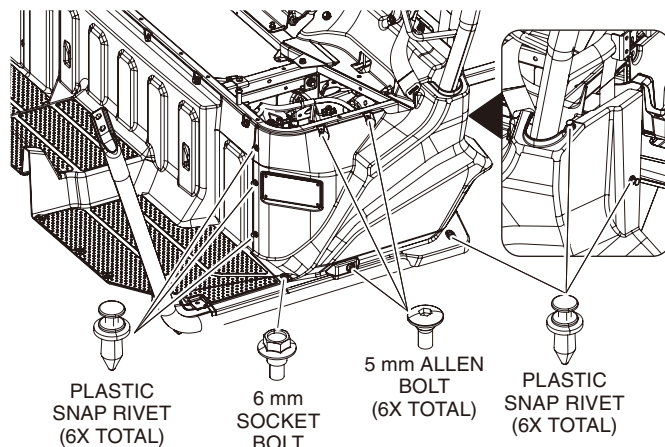

4. **For 5-seat vehicles** remove the six (6), 5 mm Allen bolts and seven (7) trim clips securing the driver's side seat and rear sidestep panel as shown.

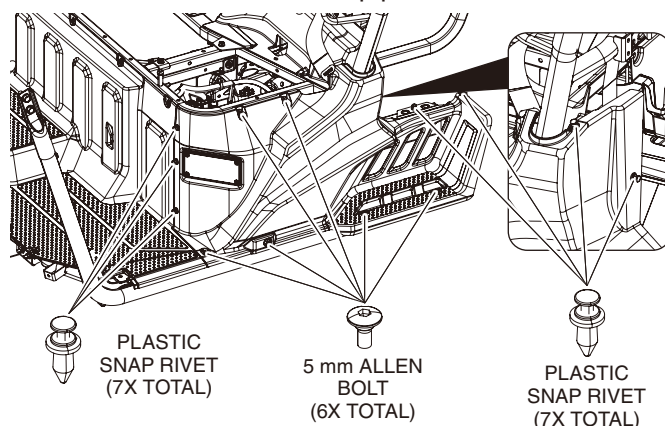

5. **For 5-seat vehicles** gently pull rear step portion of the panel away from the vehicle and off the support metal frame. Turn the entire panel clockwise and down so it clears the door and B pillar. Remove from the vehicle.

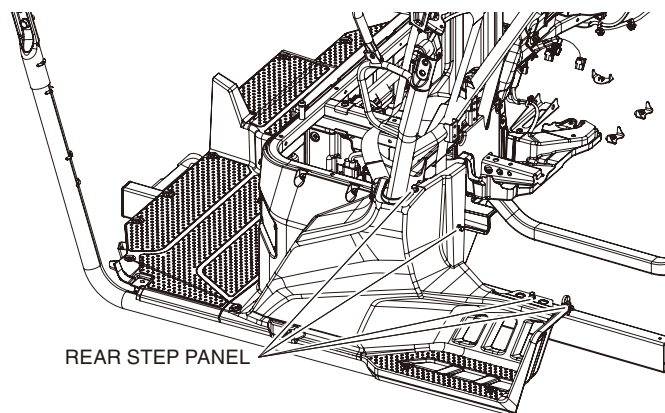

6. Align the Bottom Bracket Drill Template as shown and drill a 5/16" hole as directed. (It is recommended to use masking tape on the template to keep it in place while drilling the hole.)

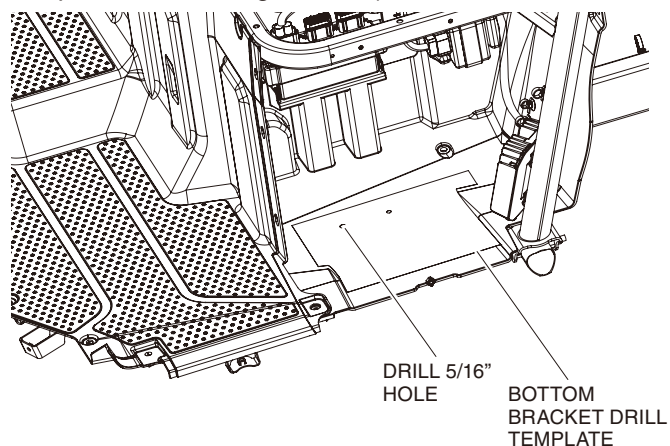

7. Attach Lower Center Bracket with supplied trim clip, and M6 × 20 mm bolt item nine (9) and washer.

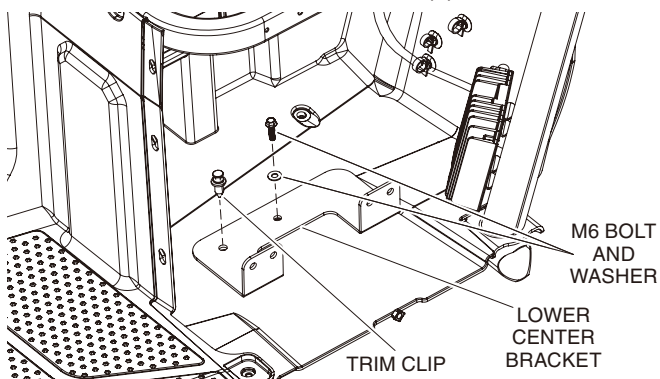

8. Attach the Upper Inside Bracket to the subwoofer enclosure with two (2) supplied M6 reduced hex head bolts and washers. Connect the supplied 4 pin Subwoofer Extension Harness to the subwoofer enclosure.

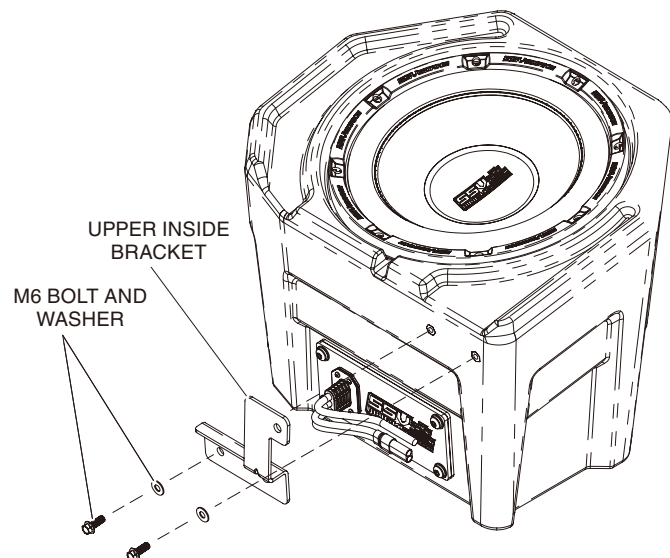

9. Lift subwoofer up and over the Lower CenterBracket, routing the wires towards the center of the vehicle.

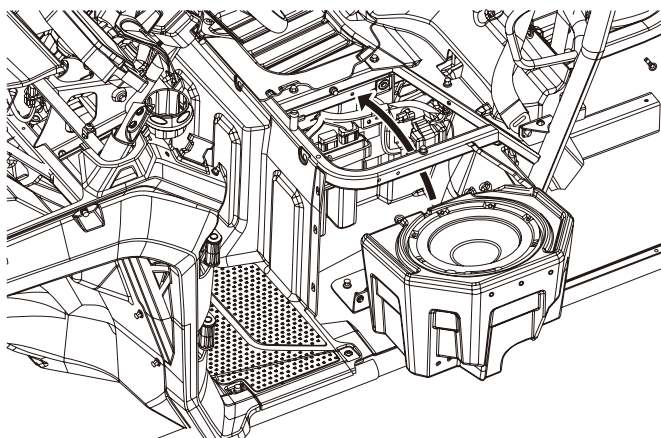

10. Secure enclosure to the Lower CenterBracket using four (4) supplied M6 reduced hex head bolts and washers.

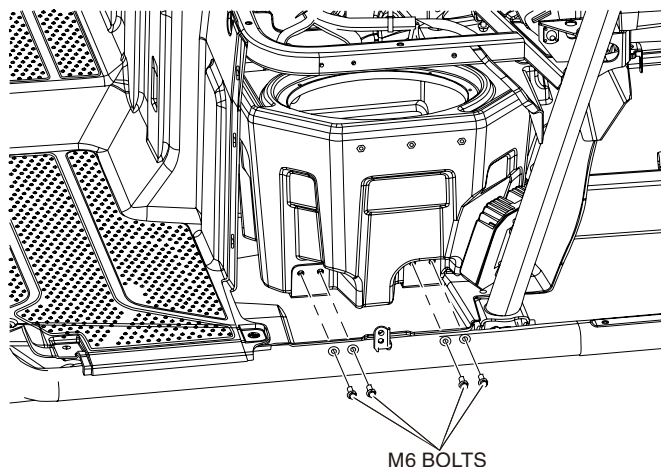

11. Connect the Upper Inside Mounting bracket to the frame by sliding the supplied M6 shoulder bolt and washer through the rubber spacer then tighten.

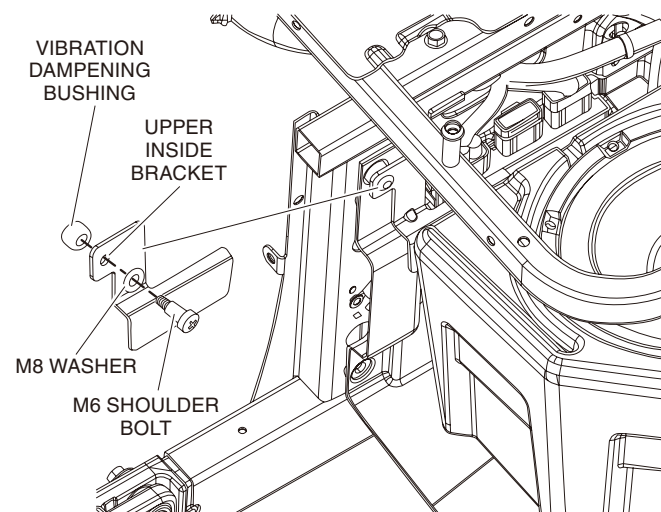

12. Secure top Upper Outside Bracket to the enclosure with three (3) supplied M6 reduced hex head bolts and washers. Remaining top holes in bracket will receive two (2) factory bolts upon panel installation.

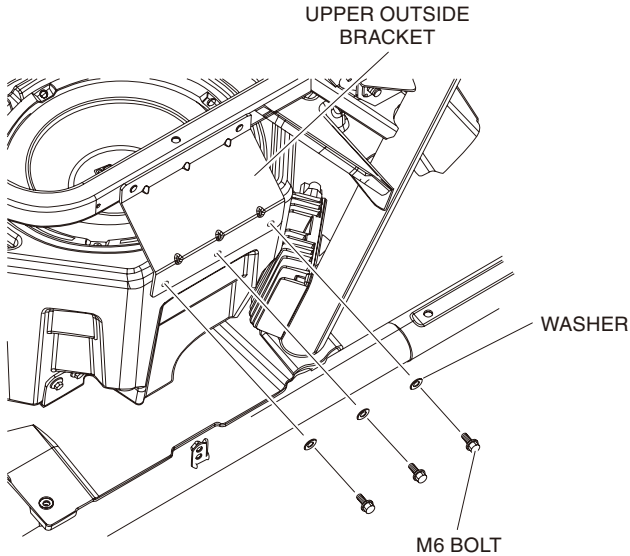

13. Remove eleven (11) of twelve (12) 10 mm bolts from the skid plate beneath the vehicle, leaving the center key holed bolt in place. Loosen but do not remove the remaining bolt. Carefully slide the skid plate towards the back of the vehicle to release from the remaining bolt.

Loosen. Do not remove.

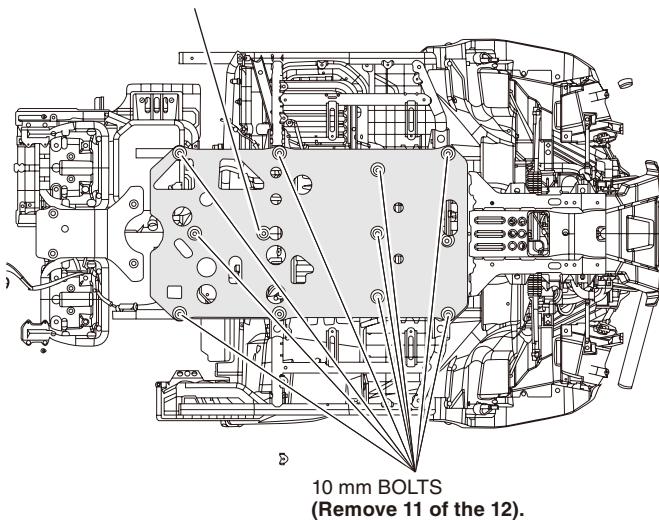

14. Route the subwoofer power and 4-Pin Subwoofer Extension Harness alongside the factory harness at the front of the seat frame. Follow this to the passenger side, downwards, and towards the front of the vehicle securing the power and signal harnesses with supplied zip ties.

⚠ WARNING: Make sure to secure wires properly and maintain a safe space between moving parts such as the prop shaft.

NOTE: The view shown is the undercarriage of the vehicle.

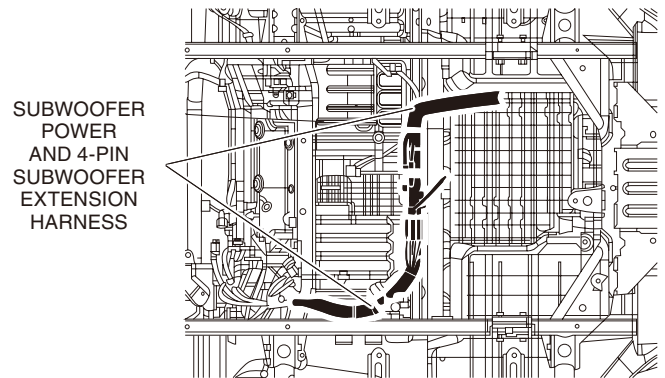

15. Continue routing the power and 4-Pin Subwoofer Extension Harness wires up the frame post next to the passenger side foot well up into the under-hood compartment. Zip tie as needed.

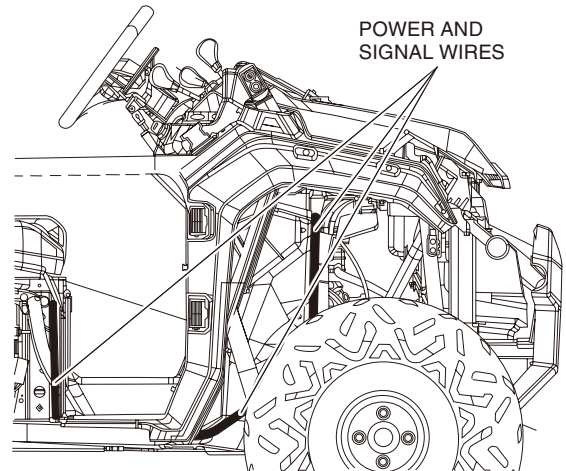

16. Connect the 4-pin Subwoofer Extension Harness to the Line Out of the radio mcu.

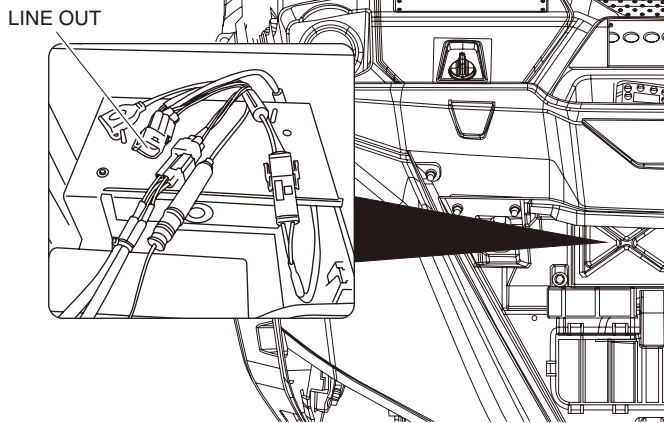

17. Continue to route the power cables to the battery as shown. Zip tie as needed.

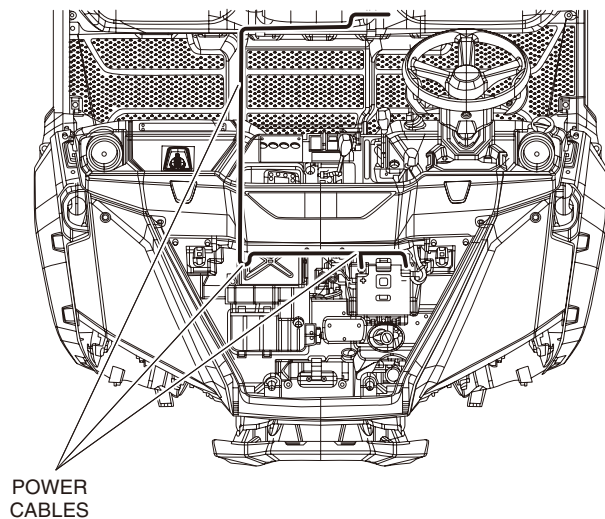

18. Connect the In-Line Fuse Holder to the battery post, once secured connect the In-Line Fuse Holder to the power cable. Finally, connect subwoofers ground cable to the negative post of the battery.

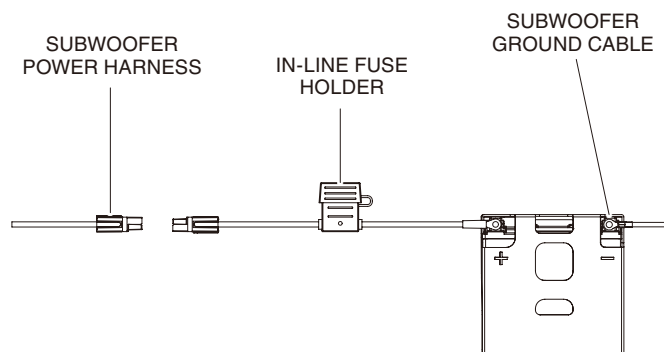

19. For 5-seat vehicles reinstall the driver's side seat and rear steppanel. For 3-seat vehicles reinstall driver's side seat panel. Ensure the top seat base bolts secure both the panel and the Upper Outside Bracket to the vehicle.

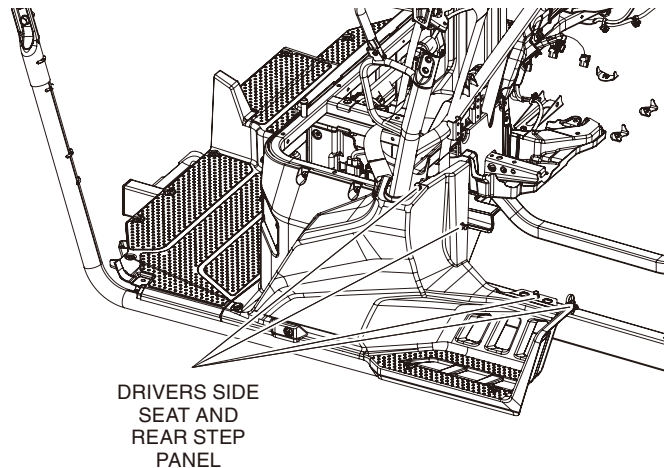

20. Re-assemble the remaining parts of the vehicle in the reverse order of removal.