



INSTALLATION INSTRUCTIONS

Accessory

TRAILING ARM MUD
GUARDS
P/N 0SK12-HL6-A00

Application

SXS1000S2X/S2XD/S2R/
S4X/S4XD

Publication No.

MII 17811

Issue Date

April 2022

Honda Dealer: Please give a copy of these instructions to your customer.

PARTS LIST

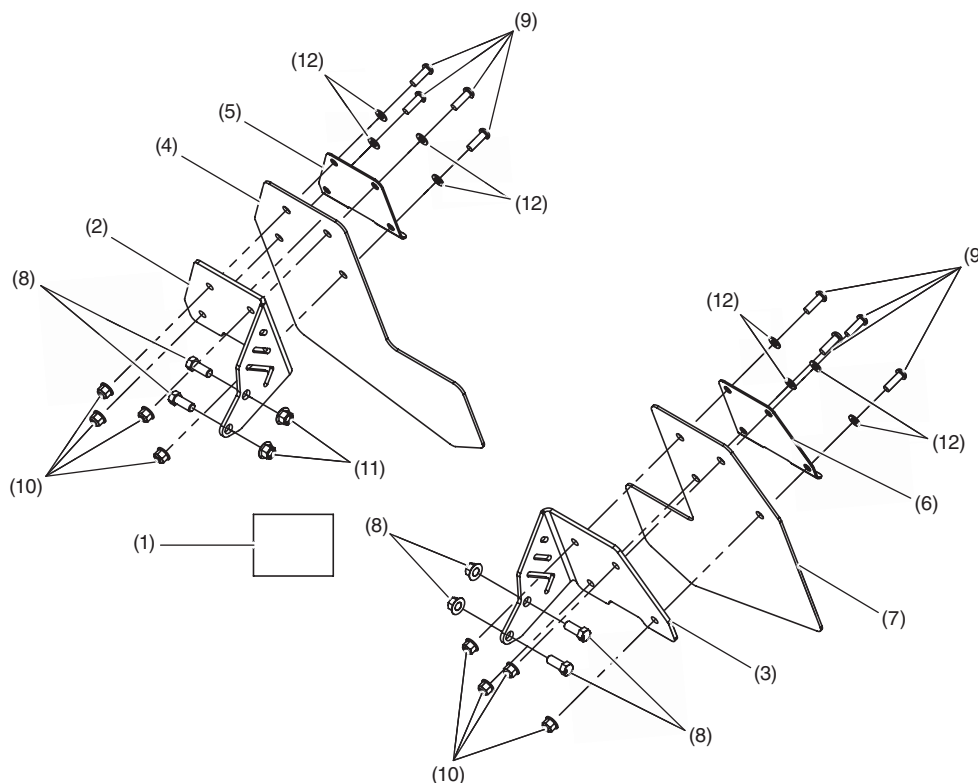

No.	Description	Qty
(1)	Installation instruction URL	1
(2)	Passenger splash guard support	1
(3)	Driver splash guard support	1
(4)	Passenger mud guard	1
(5)	Passenger plate	1
(6)	Driver plate	1
(7)	Driver mud guard	1
(8)	12 x 25 mm hexagonal bolt	4
(9)	14 x 25 mm button head bolt	8
(10)	12mm hexagonal nut	8
(11)	14mm hexagonal flange nut	4
(12)	Washer	8

TOOLS REQUIRED

Allen key (6 mm)
Ratchet
Torque wrench
Socket (12 mm)

Socket (14 mm)
Open-end wrench (12 mm)
Open-end wrench (14 mm)

TORQUE CHART

Item	N-m	kgf-m	lbf-ft
14 x 25 mm button head bolt	24.5 ± 3.5	2.49 ± 0.30	18 ± 3
12 x 25 mm hexagonal bolt	48 ± 6	4.89 ± 0.61	35 ± 4

INSTALLATION

⚠ CAUTION: To prevent burns, allow the engine, exhaust system, radiator, etc., to cool before installing the accessory.

1. Install all hardware as shown on the figure below.
Torque all bolts as shown in the TORQUE CHART above.(Passenger side)

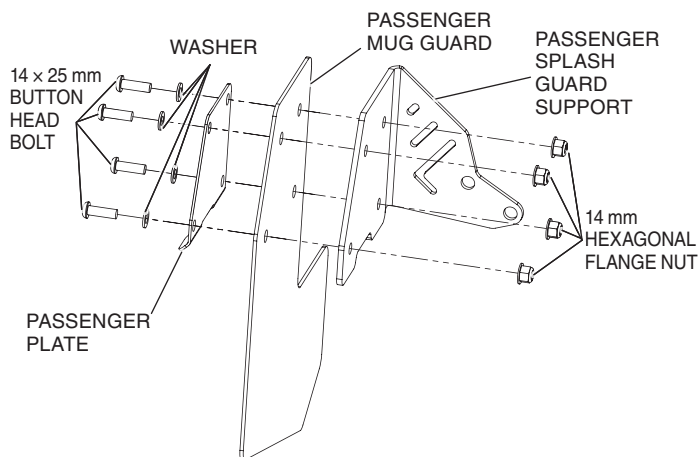

2. Install the splash guard using two 12 x 25 mm Hexagonal Bolts and two 12 mm Hexagonal Nuts then torque the bolts to the torque shown in the TORQUE CHART on page 1.

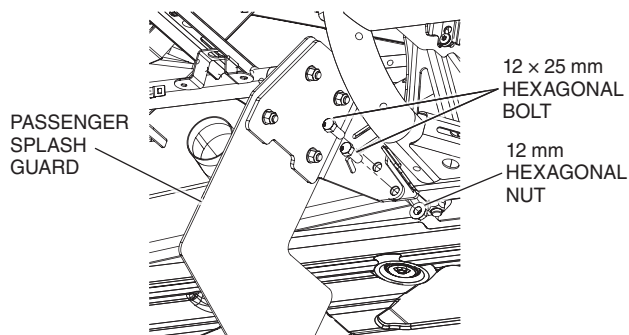

NOTE: If rock sliders (P/N 08P70-HL6-A40) are installed, use two 12 x 25 mm Hexagonal Bolts from the mud guard, since it is longer. The splash guard support must be between the vehicle chassis and the rock slider.

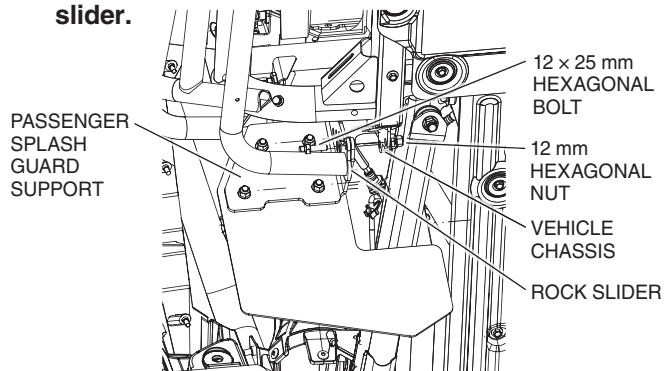

3. Repeat steps 1 & 2 for the driver side.