



# INSTALLATION INSTRUCTIONS

HEATER  
P/N 0SE08-HL4-A00

SXS1000M3P/M3D/  
M3DF/M3DT/M3LS/M5P/  
M5D/M5DF/M5DT/M5LS

Publication No.

MII 17762

Issue Date

April 2022

Honda Dealer: Please give a copy of these instructions to your customer.

## PARTS LIST

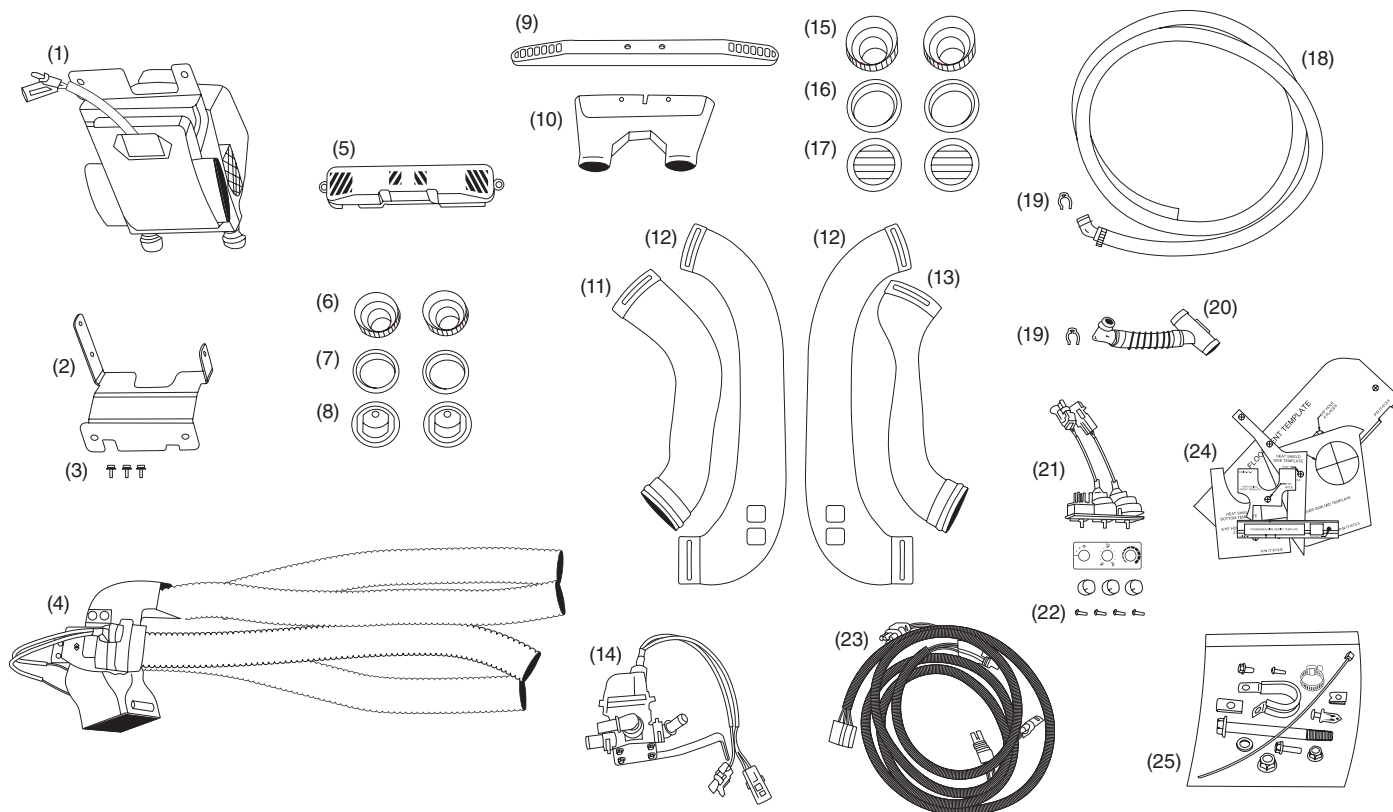

No.	Description	Qty
(1)	Heater assembly	1
(2)	Lower heater mount	1
(3)	Heater assembly mount screws	3
(4)	Mode control assembly	1
(5)	Floor vent assembly	1
(6)	Mid vent adapter housing	2
(7)	Mid vent adapter ring	2
(8)	Mid vent louver	2
(9)	Demist vent assembly	1
(10)	Demist duct adapter	1
(11)	Left return air duct	1
(12)	Return air duct extension	2
(13)	Right return air duct	1
(14)	Temperature control valve	1
(15)	Return vent adapter housing	2
(16)	Return vent adapter ring	2

No.	Description	Qty
(17)	Return vent grill	2
(18)	Heater inlet hose	1
(19)	Retaining clips	2
(20)	Heater return hose	1
(21)	Control panel assembly	1
(22)	Control panel screws	4
(23)	Heater harness	1
(24)	Template kit	1
(25)	Hardware kit	1

HARDWARE PARTS LIST

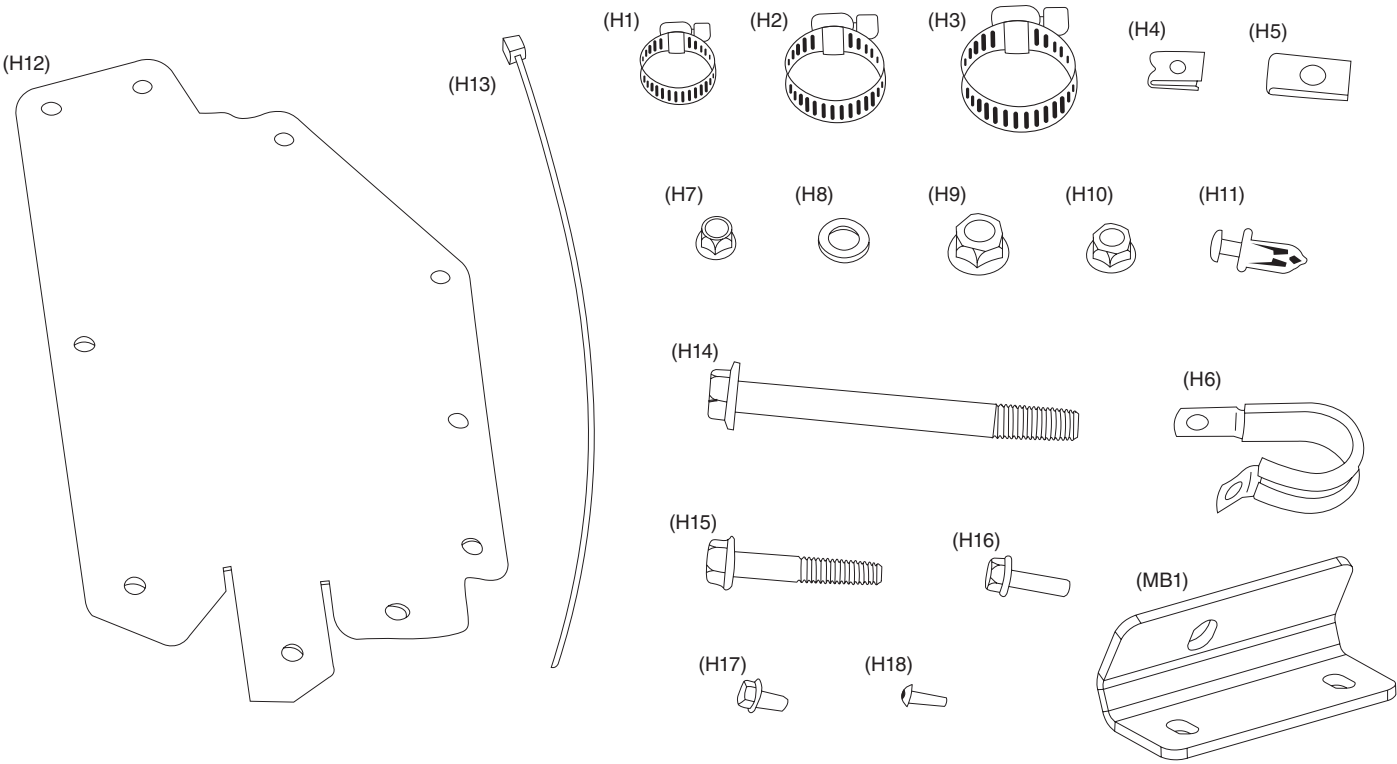

No.	Description	Qty
(H1)	7/8-inch hose clamp	2
(H2)	1-inch hose clamp	1
(H3)	1 1/2-Inch hose clamp	2
(H4)	#8 panel clip	2
(H5)	M6 panel clip	2
(H6)	1-inch p-clamp	2
(H7)	M6 lock nut	2
(H8)	M10 lock washer	1
(H9)	M10 nut	1
(H10)	M8 nut	2

No.	Description	Qty
(H11)	Trim clip	15
(H12)	Heat shield flap	1
(H13)	Cable tie	10
(H14)	M10 × 10 mm bolt	1
(H15)	M8 × 50 mm bolt	2
(H16)	M6 × 20 mm bolt	4
(H17)	M5 × 10 mm bolt	2
(H18)	#8 screw	4
(MB1)	Windshield bracket	1

# TOOLS AND SUPPLIES REQUIRED

- Phillips screwdriver
- Standard screwdriver
- Drill
- Socket (6 mm, 10 mm, 12 mm, 14 mm, 15 mm, 1/4 inch)
- Drill bit (3/16 inch, 1/4 inch, 5/16 inch, 3/8 inch)
- Hole saw (2 1/4 inch, 3 inch)
- Allen (5 mm)
- 15 mm combination wrench
- Rotary tool
- Hose cutter
- Deburr tool
- Clean drain pan (for reuse of coolant)
- Pro Honda HP Coolant

# USE AND CARE INFORMATION

- Check the accessory mounts frequently and re-tighten if necessary.
- Replace this accessory with a new one if it is damaged.

# TORQUE CHARTS

Tighten all screws, bolts, and nuts to their specified torque values.

Item	N·m	kgf·m	lbf·ft
1-1/2 inch hose clamp	4	0.4	3.0
1 inch hose clamp	4	0.4	3.0
7/8 inch hose clamp	2	0.2	1.5
5 mm flange bolt	4	0.4	3.0
6 mm flange bolt (10 mm head) and nut	12	1.2	9
8 mm flange bolt and nut	12	1.2	9
10 mm flange bolt and nut	12	1.2	9

Fuse Box  
Sold separately (P/N 0SS25-HL4-A00)

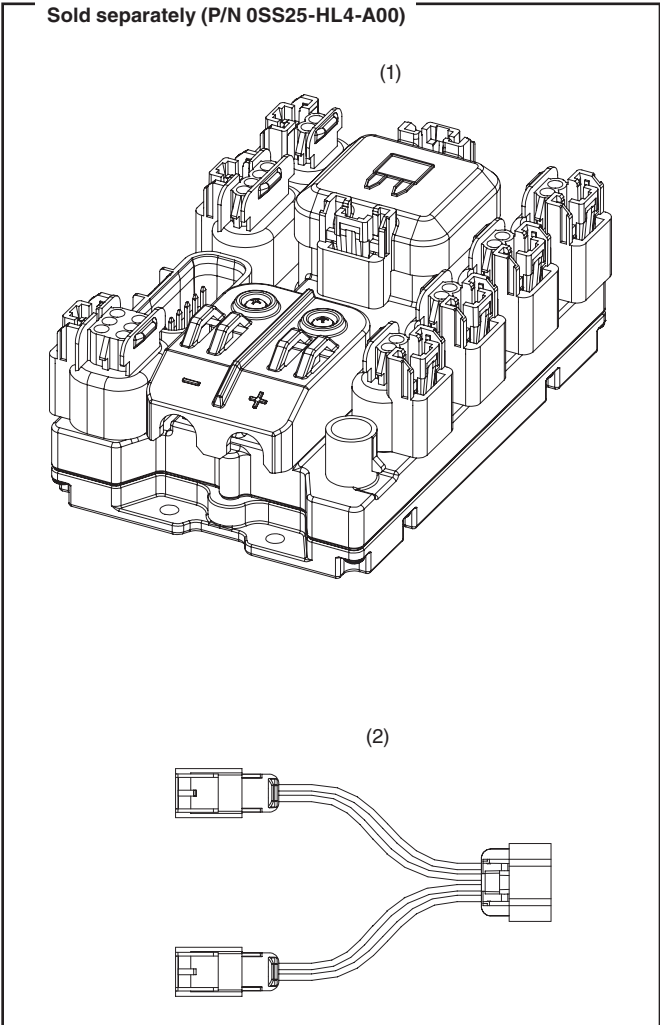

No.	Description	Qty
(1)	Fuse box switcher	1
(2)	Harness, 4-pin to 2-pin (Y-splitter)	1

**Fuse Box & Audio Mount Bracket**  
**Sold separately (P/N 0SS27-HL4-A00)**

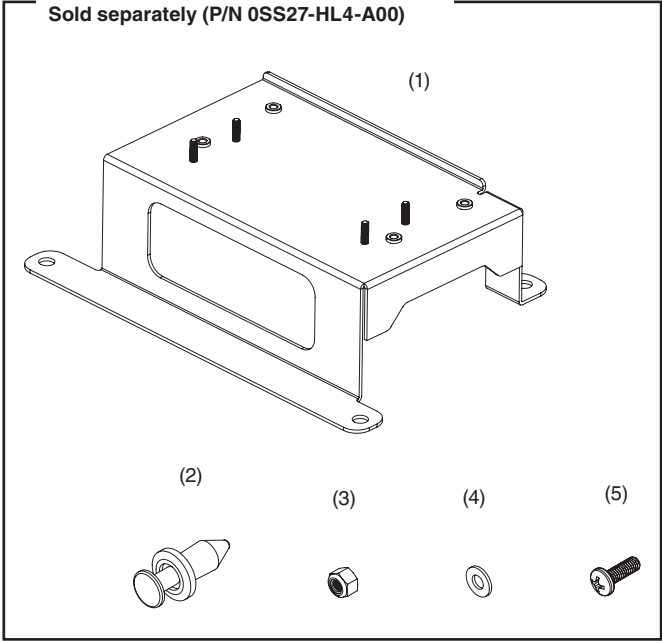

Item	Description	Qty
(1)	Mounting plate, fuse box, HL4	1
(2)	Trim Clip 8 mm	4
(3)	M4 × 0.7, locking hex nut	4
(4)	M4 flat washer	8
(5)	M4 × 12 mm phillips pan-head screw	4

**Fuse Box Wiring Kit**  
**Sold separately (P/N 0SS26-HL4-A00)**

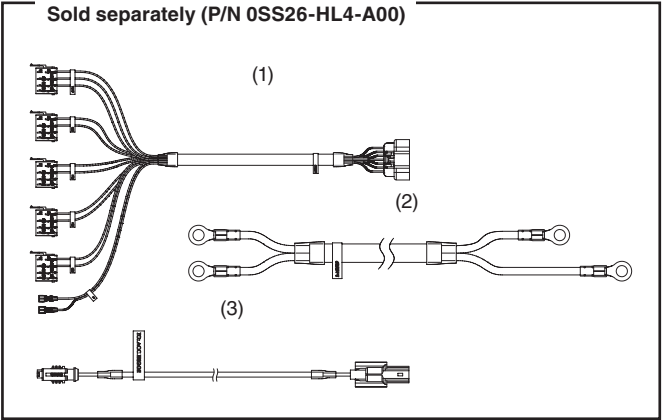

No.	Description	Qty
(1)	HL6 EVC switch wire harness	1
(2)	Power & ground input cables	1
(3)	Accessory trigger input wire	1



**HEATER OVERVIEW**

Upon completion of installation, vehicle will resemble the following:

NOTE: The numbers shown below can be referenced on page 1.

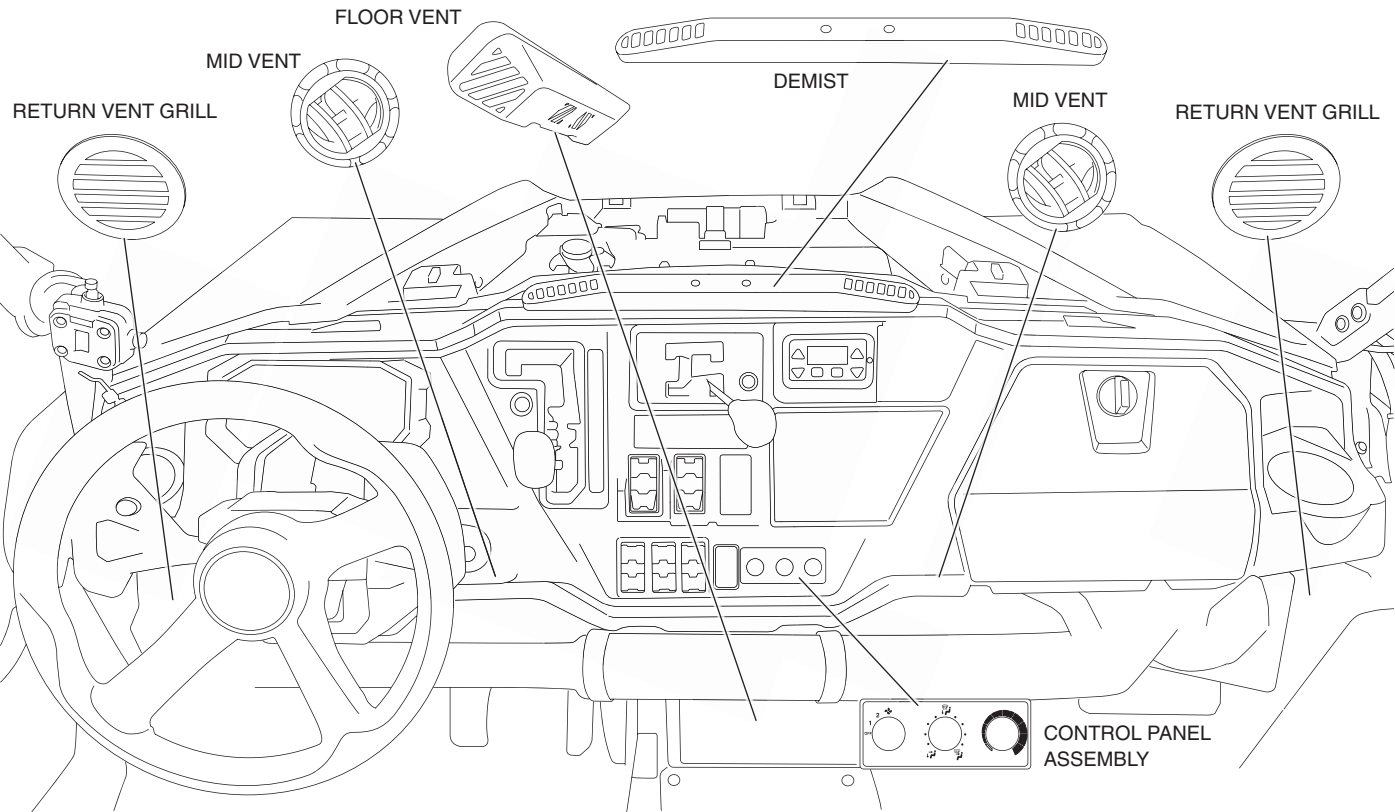
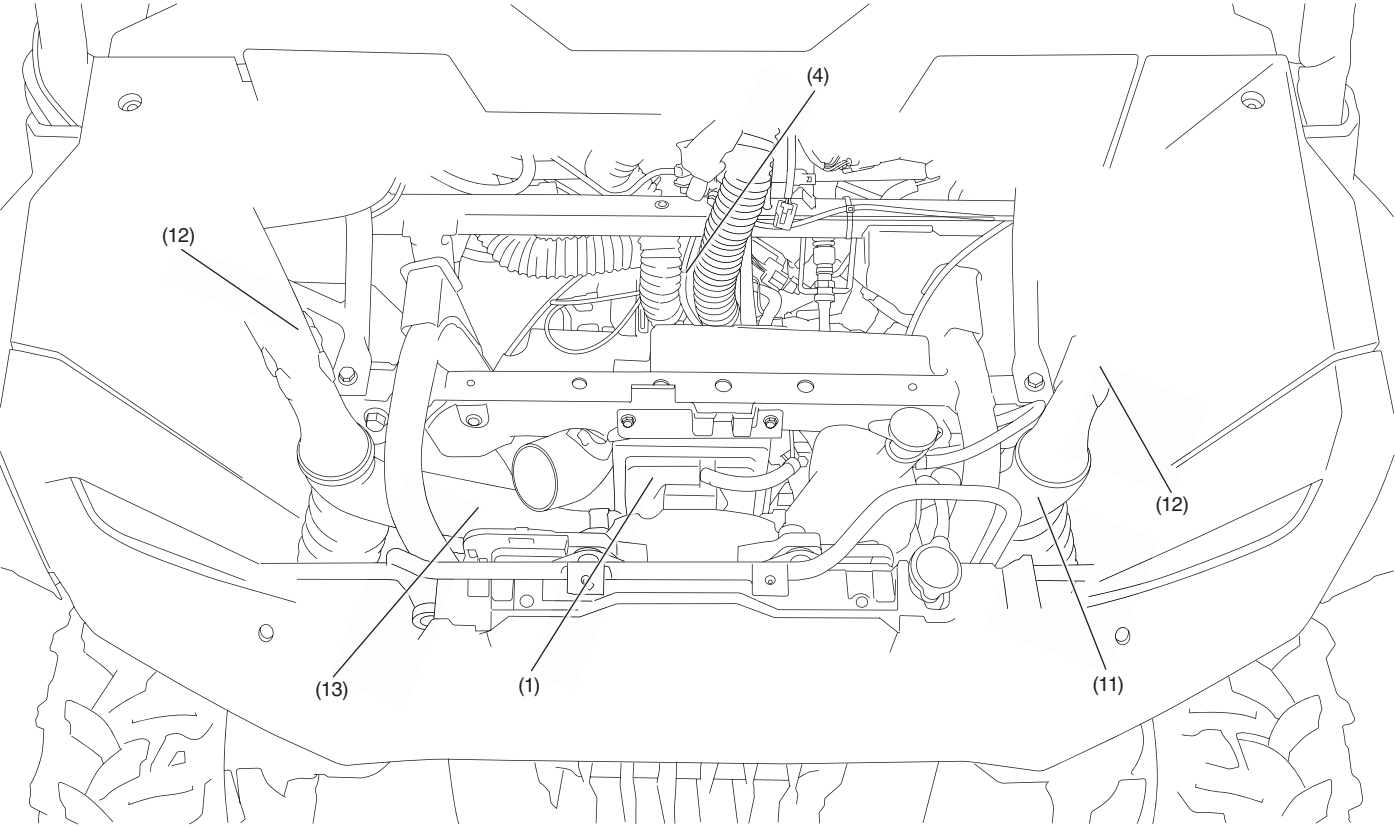

## VEHICLE PREPARATION FOR HEATER INSTALLATION

1. Refer to the Service Manual for the vehicle and remove:
  - Front hood
  - Front bumper (if equipped)
  - Left and right front doors
  - Front side covers
  - Battery
  - Front fender
  - Front support bar
  - Seat cushion
  - Under seat cover
  - Rear side covers (5-passenger models only)
  - Rear footwell (5-passenger models only)
  - Skid plate(s)
  - Heat shield
  - Dash under storage assembly
2. Remove radiator cap and drain the coolant from the system by removing the drain bolts and sealing washers from the coolant lines.

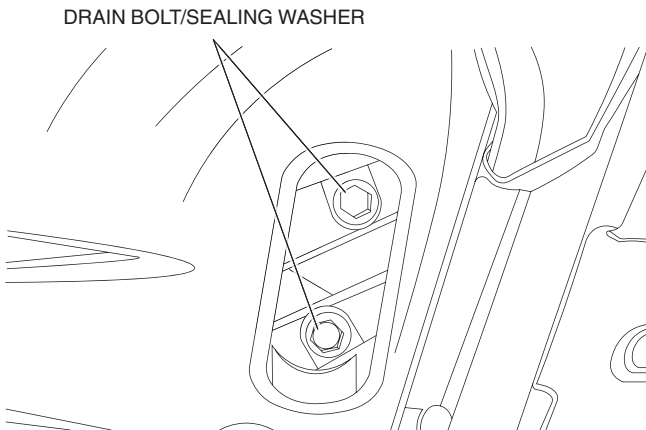

3. Drain the remaining coolant from the system by removing the drain bolt and sealing washer at the crankcase.

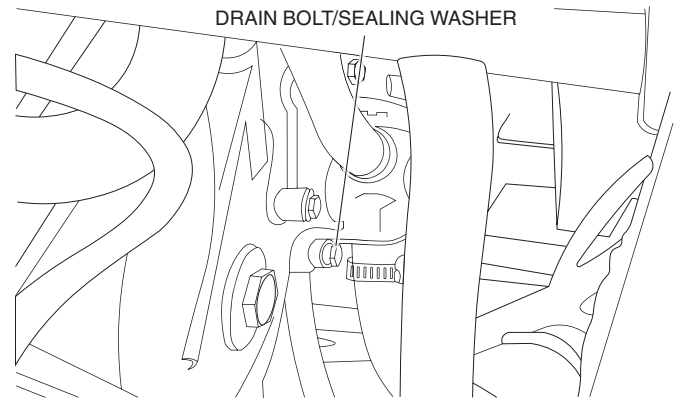

## HEATER INSTALLATION

4. In front of vehicle, remove trim clip from Snorkel Duct B.

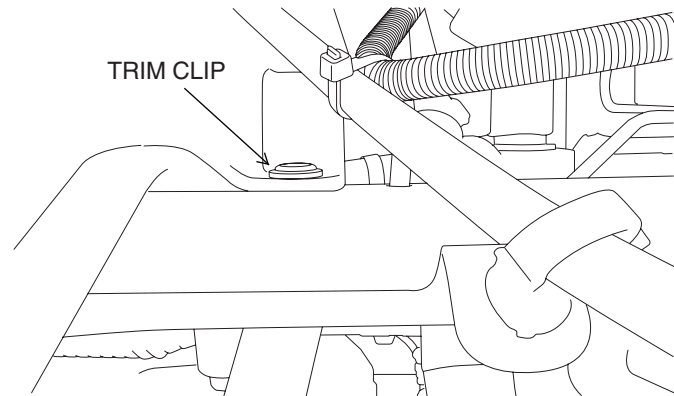

5. Remove side mount bolts from radiator. (Tip: Put bolts back in a few threads behind radiator to create workspace wedge).

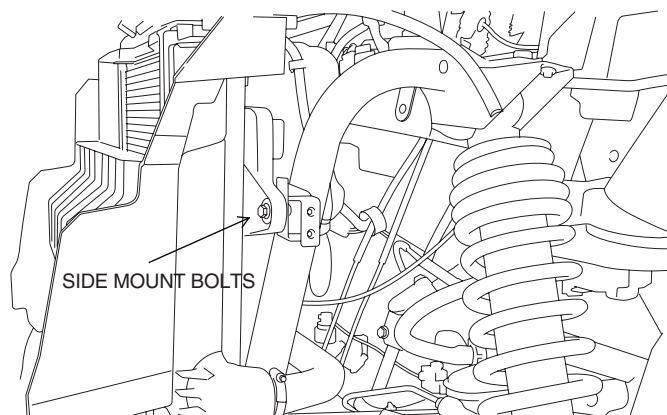

6. Remove coolant reservoir fasteners and temporarily relocate to the side.

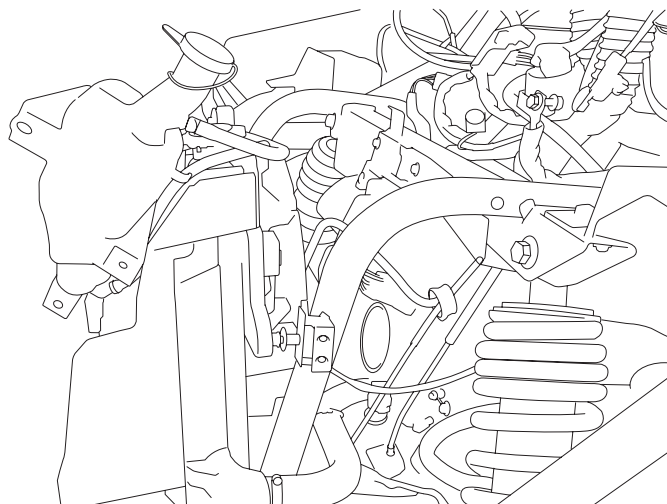

7. Remove gear shift cable hold down.

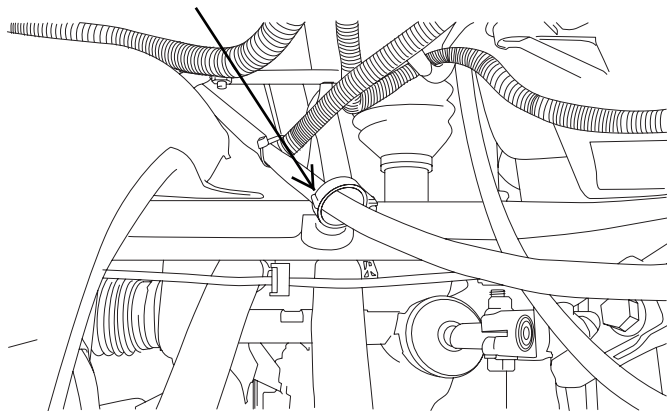

8. Remove front speaker assemblies (if installed).

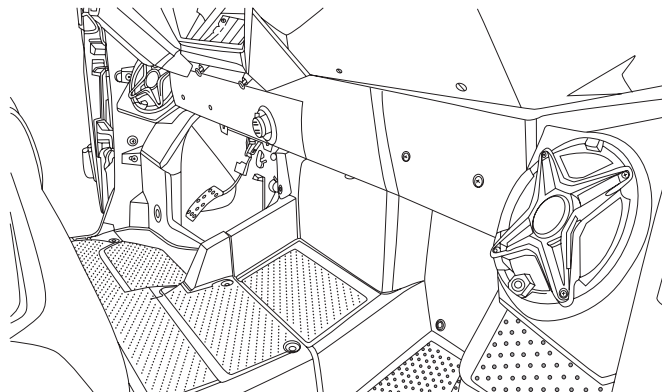

9. Install and cut templates using a drill or rotary tool. Deburr edges as needed.

**NOTE: All templates call out drill hole sizes.**

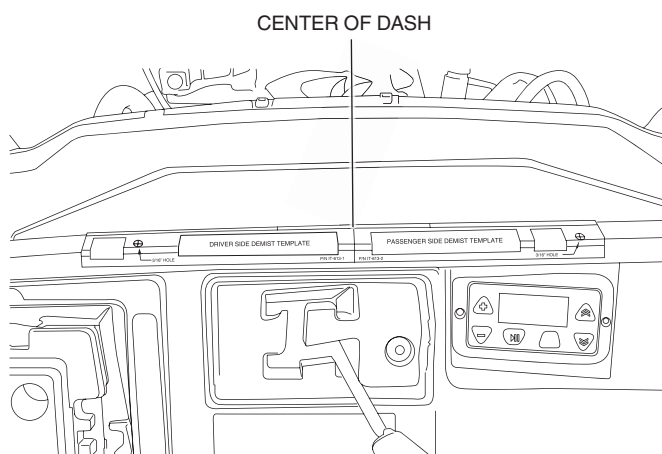

**NOTE: Mark center of dash before applying demist templates.**

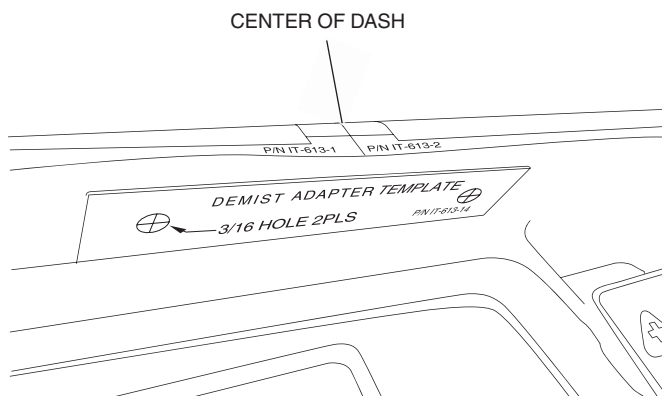

**NOTE: Line up de-mist templates along center line as shown above.**

## DRIVER SIDE RETURN

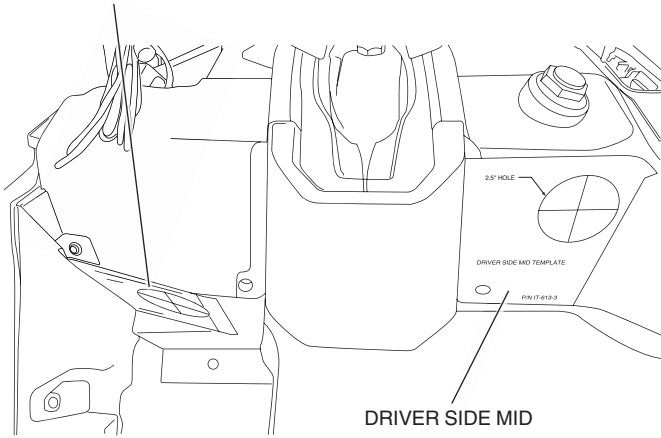

## PASSENGER SIDE MID

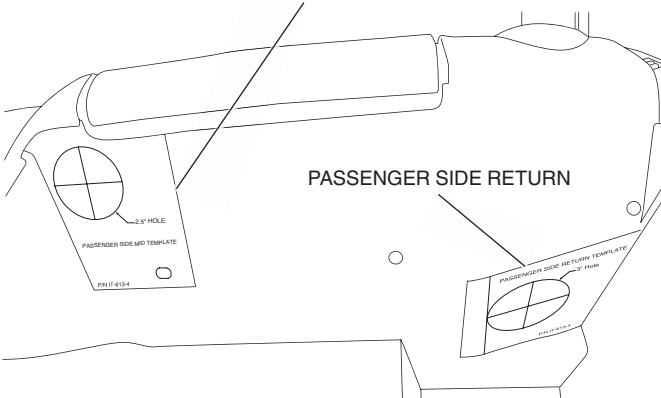

## FLOOR VENT TEMPLATE

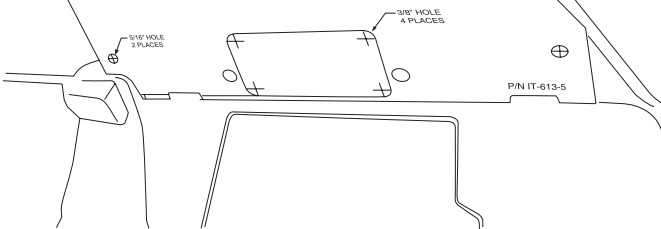

## FRONT FENDER

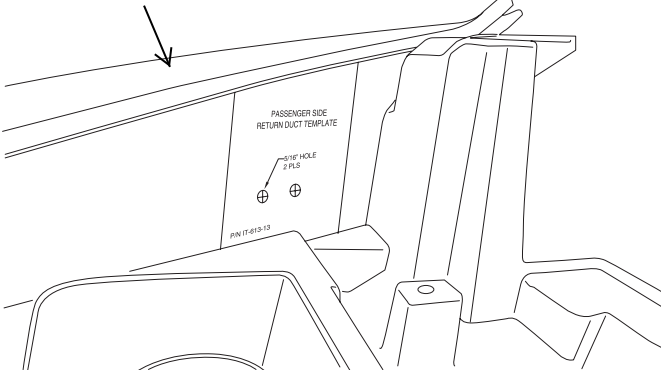

**NOTE: Using a heat gun, remove emission control information label and set aside for step 54.**

## FRONT FENDER

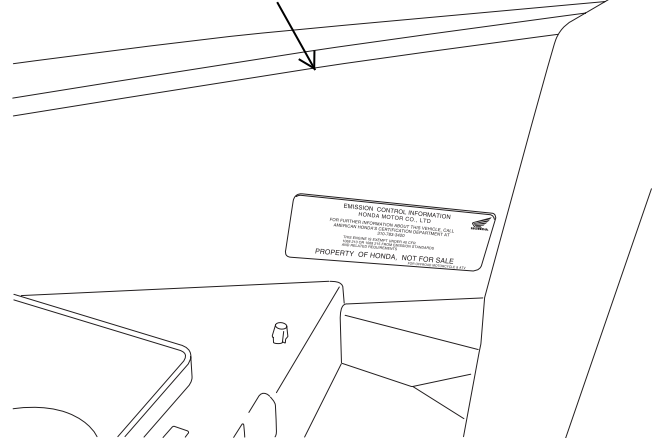

## FRONT FENDER

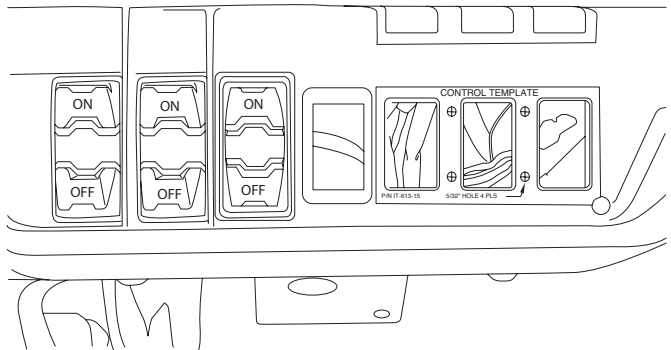
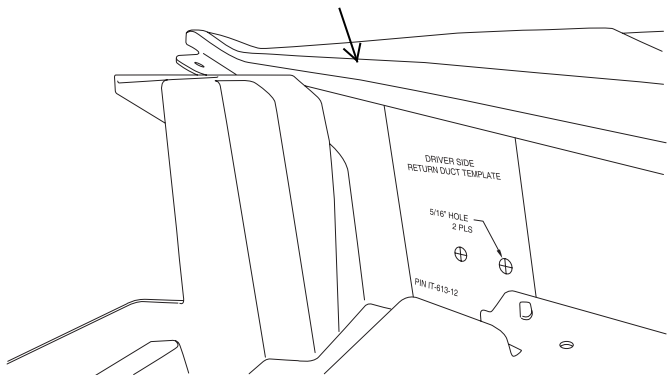

**NOTE: Cut and remove heat shield along edges outlined by templates as shown. Make slit on bottom right of Splash Panel Template to fit over groove as shown.**

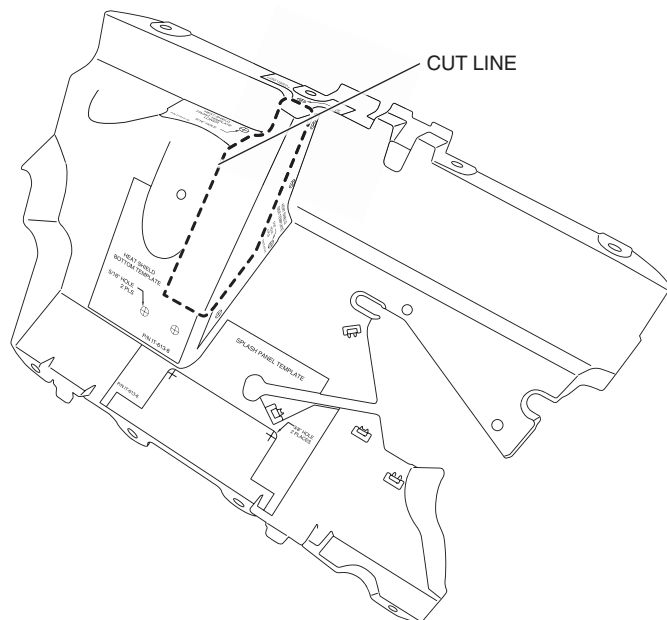

10. Install Control Panel Assembly (21) into dash using four Control Panel Screws (22) as shown, then snap cover and knobs onto assembly.

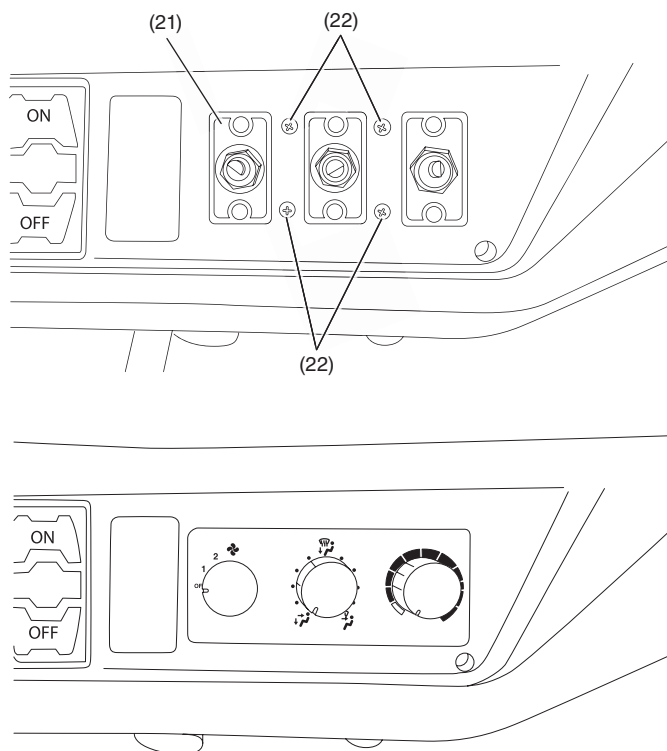

11. Install Heat Shield Flap (H12) over hole in heat shield using nine new Trim Clips (H11).

**NOTE: Marked hole in image below must be marked and drilled after flap is installed.**

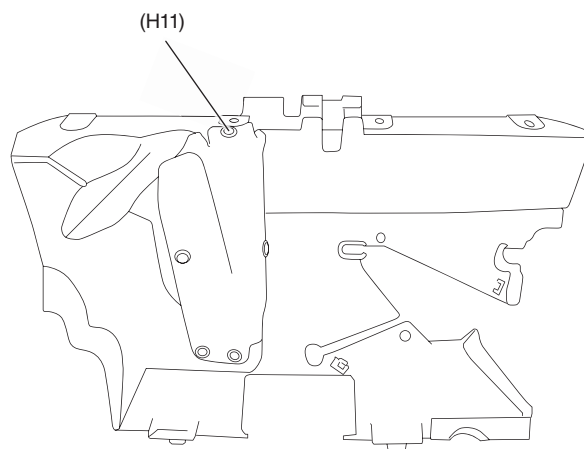
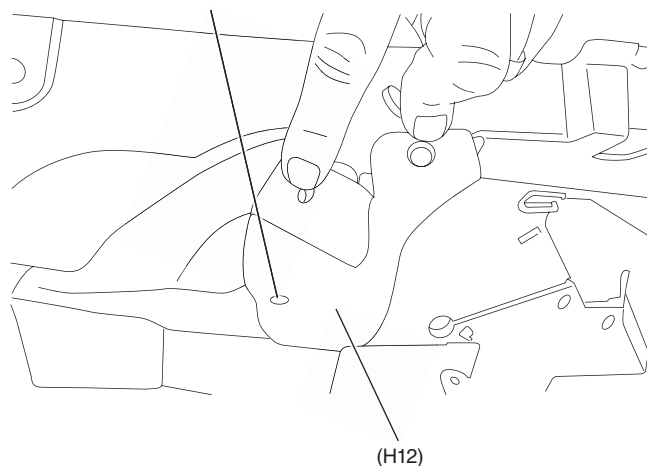

12. Mark, cut and remove 1-inch section of return coolant hose from radiator as shown.

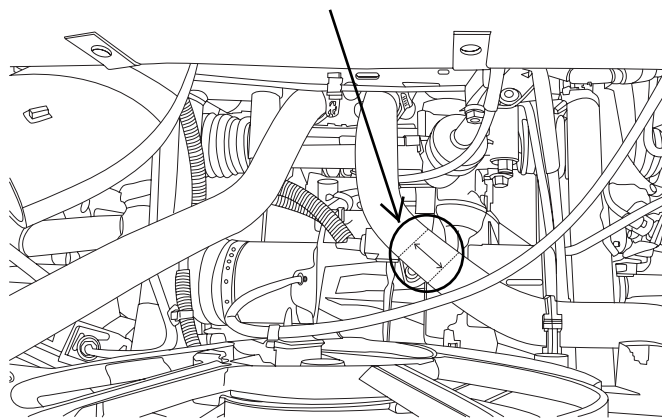

13. Install Heater Return Hose (20) as shown. Secure using 1-1/2 inch Hose Clamps (H3). Refer to Torque Chart and tighten hose clamps.

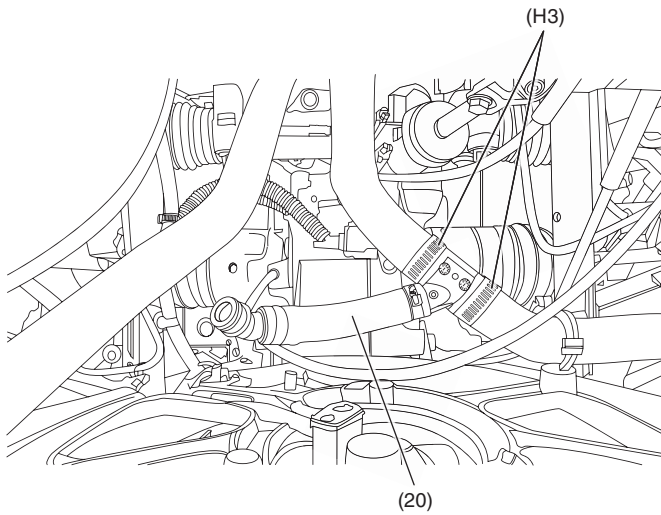

14. Remove oil cooler hose, then measure, mark and cut hose.

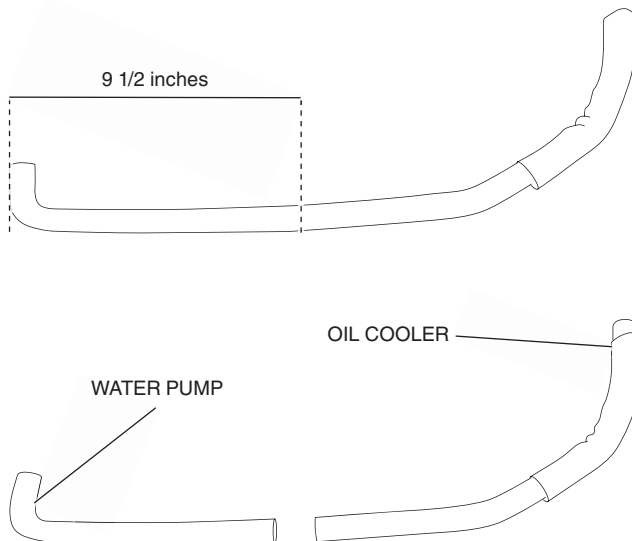

15. Connect hose from oil cooler to 45° port and hose to water pump to 90° port on Temperature Control Valve (14). Install 7/8-inch Hose Clamps (H1) loosely over ports.

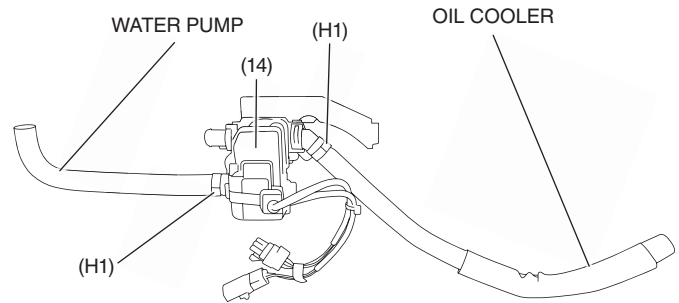

16. On the starter motor, remove rubber cap (from the starter motor terminal), terminal nut, and starter motor cable.

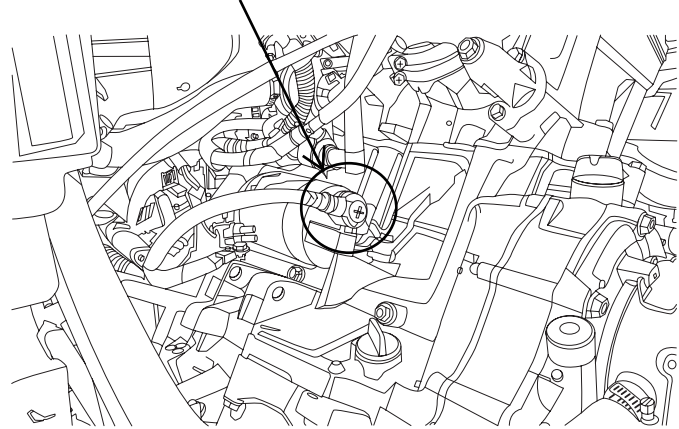

17. Cut 30 inches off Heater Inlet Hose (18), then connect to Temperature Control Valve (14) using 1-inch Hose Clamp (H2) as shown. Refer to Torque Chart and tighten hose clamp.

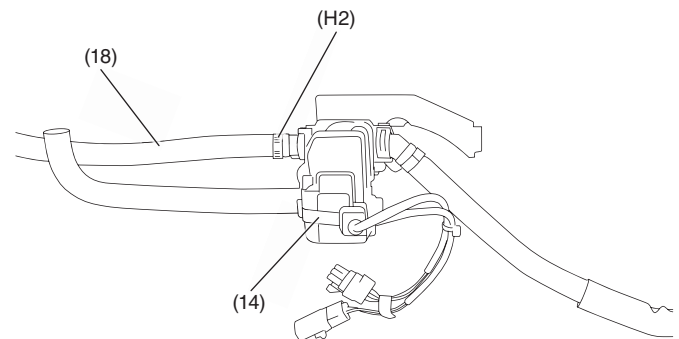



18. Route Heater Inlet Hose (18) starting at rear of vehicle to front of vehicle as shown.

**NOTE: Heater Inlet Hose must be routed and secured away from propeller shaft.**

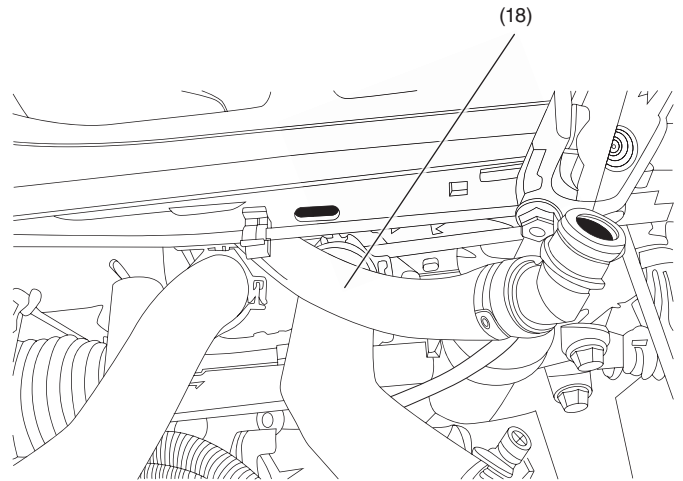
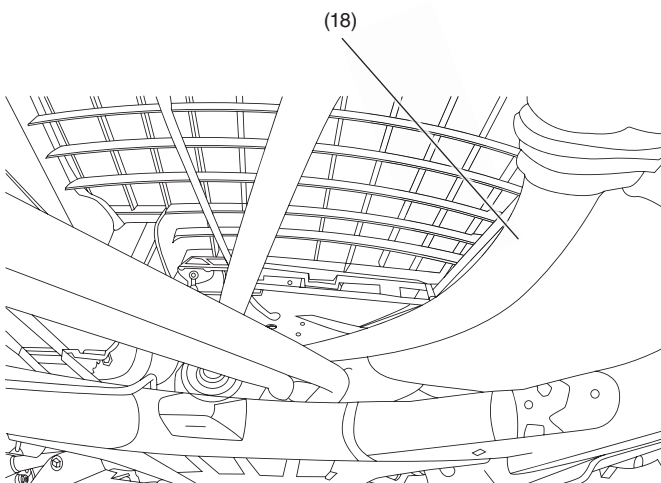
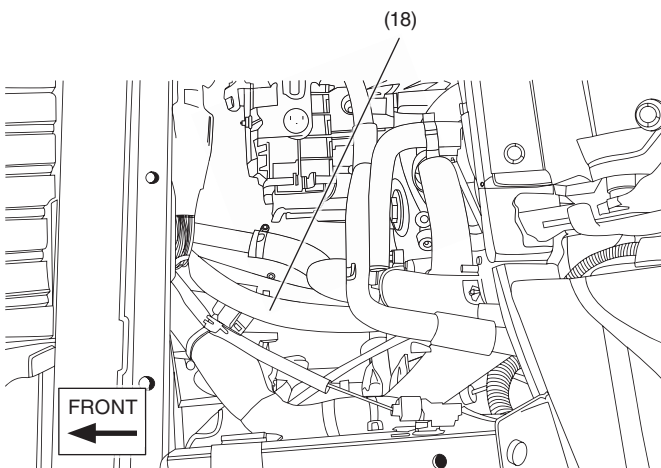
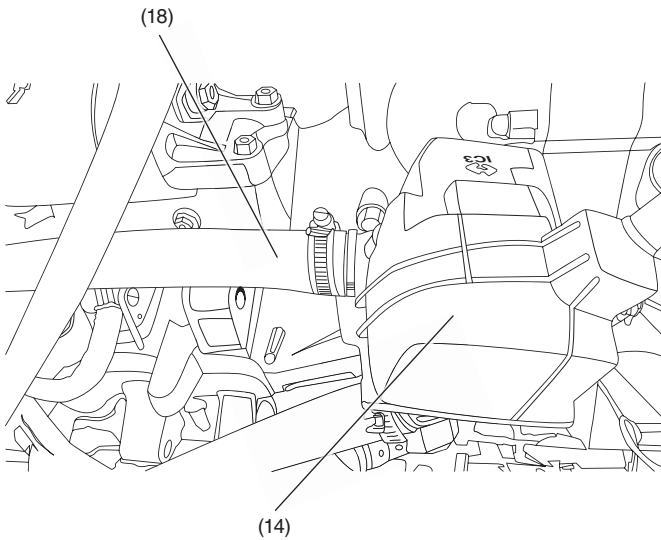

19. Mount Temperature Control Valve (14) to engine with one M10 × 110 mm Bolt (H14), M10 Lock Washer (H8) and M10 Nut (H9). Route starter motor cable over Temperature Control Valve, and reattach terminal nut and rubber cap.

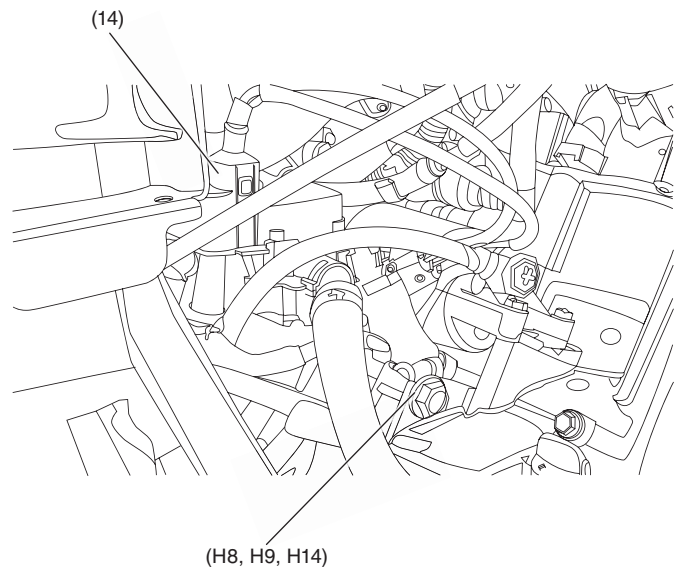

20. Reconnect oil cooler hose using existing 7/8-inch hose clamp as shown. Refer to Torque Chart and tighten hose clamp.

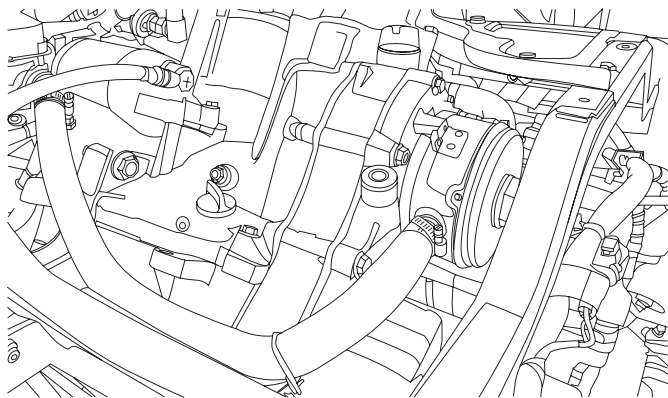

21. Reconnect hose to water pump using existing 7/8-inch hose clamp as shown. Refer to Torque Chart and tighten hose clamp.

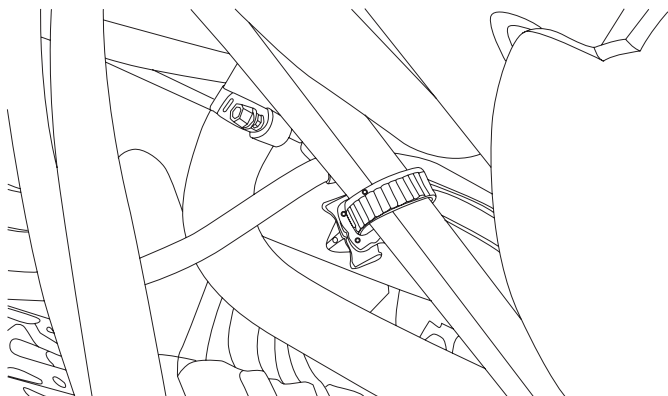

22. Refer to Torque Chart and tighten hose clamps on Temperature Control Valve (14).

23. Under vehicle, remove fastener from Snorkel Duct B, and secure Heater Inlet Hose (18) using 1-inch P-clamp (H6) and existing bolt as shown.

**NOTE: Heater Inlet Hose must be routed and secured away from drive shaft.**

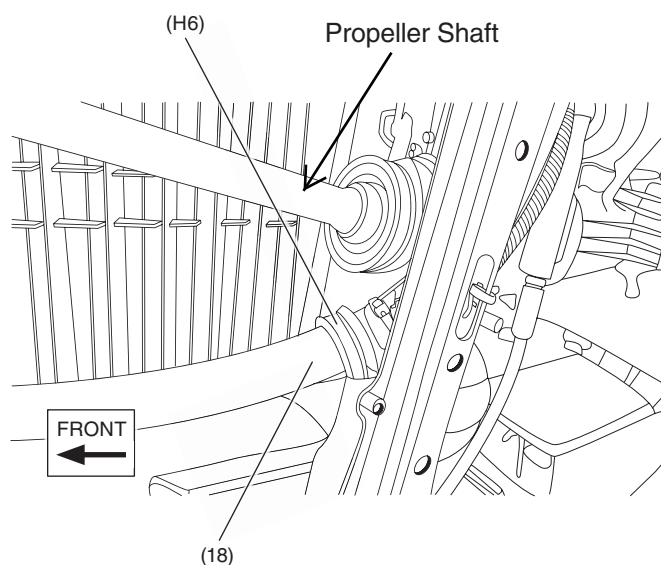

24. At front of vehicle, install M6 Panel Clips (H5) on cross member as shown.

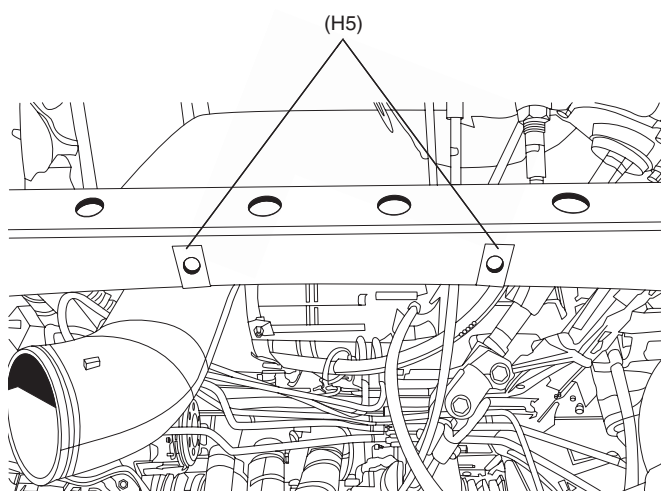



25. Install Lower Heater Mount (2) to frame cross-member using the two M8 × 50 mm Bolts (H15) and the two M8 Nuts (H10).

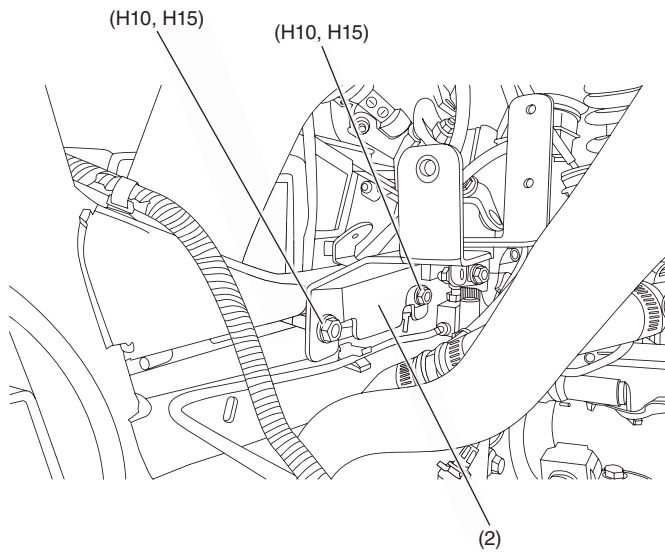

26. Place heat shield back into position, remove plugs from heater core ports and maneuver Heater Assembly (1) into place and leave loose.

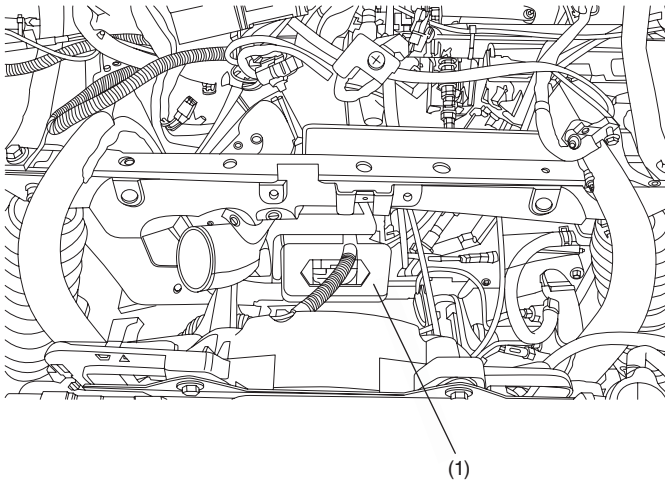

27. Attach ports from Heater Return Hose (20) and Heater Inlet Hose (18) to heater using Retaining Clips (19). Ensure ports are locked into position.

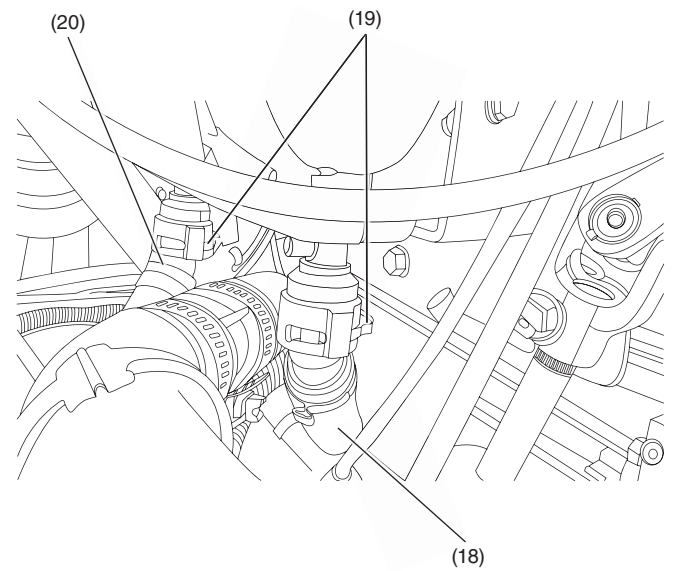

28. From back side of dash, disconnect connector to DC power outlet, remove nut, and remove DC power outlet.

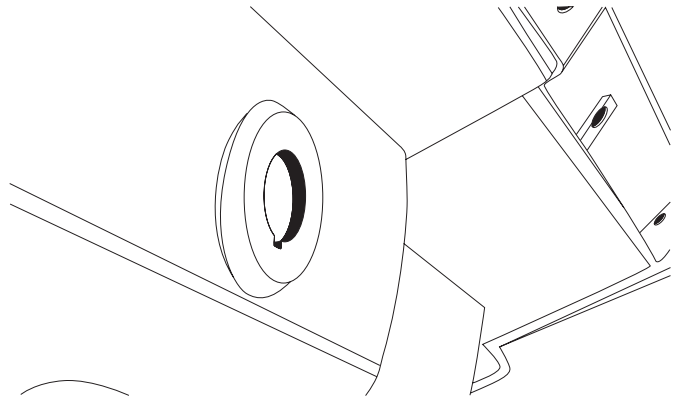

29. While standing in front of vehicle, install Mode Control Assembly (4) with servo motor facing left side by routing assembly over top of heat shield, inserting Mode Control Assembly through cutout of heat shield, then pushing Mode Control Assembly onto Heater Assembly (1).

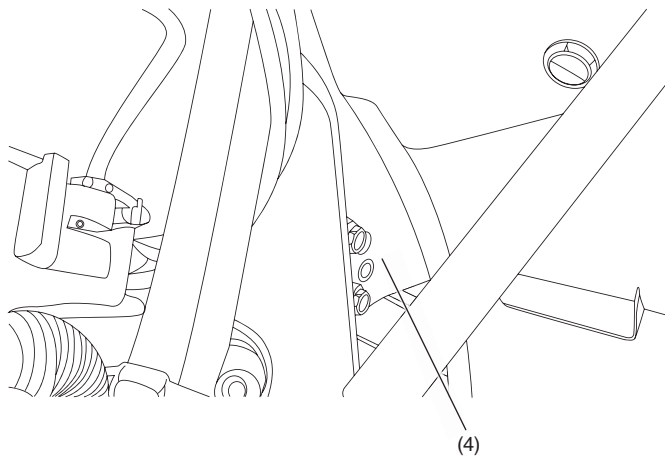
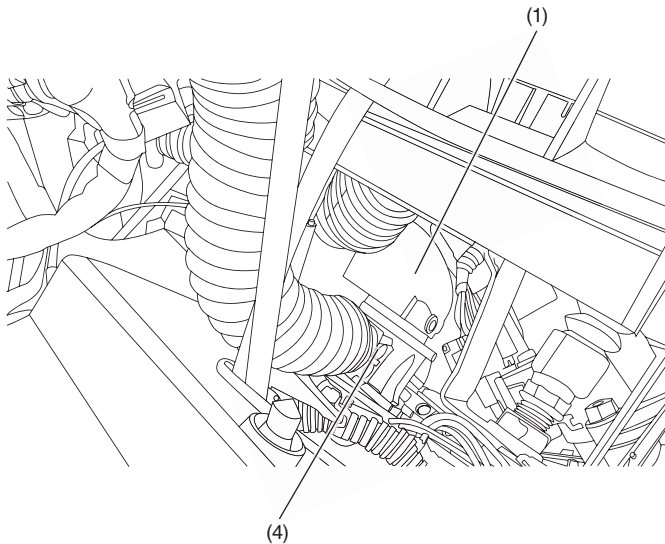

30. Install two M6 × 20 mm Bolts (H16) for upper heater mount bracket and two existing trim clips into heat shield.

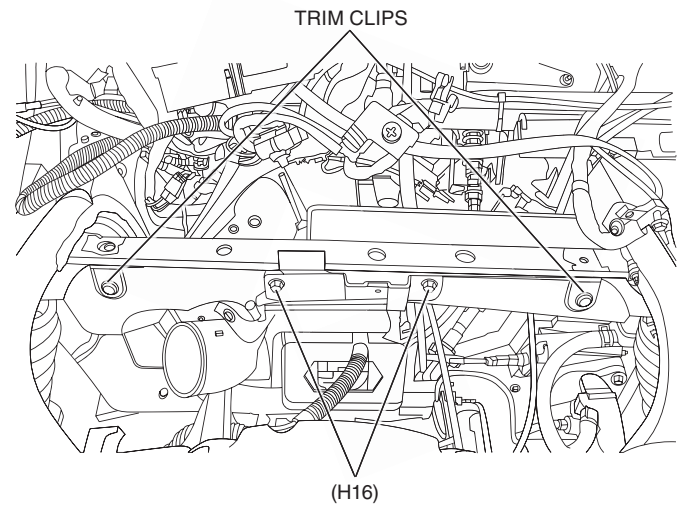

31. Install one Heater Assembly Mount Screw (3) on each side of Lower Heater Mount (2). Leave upper mounting hole out.

**NOTE: Snug Heater Assembly Mount Screws, overtightening can cause threads to strip out.**

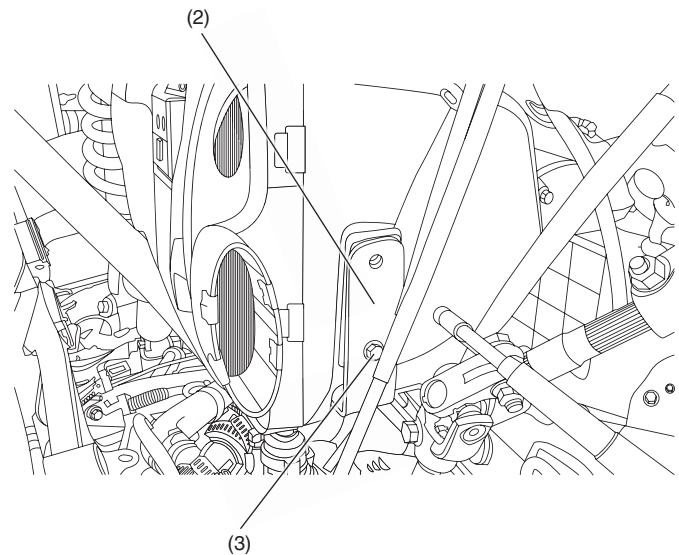

32. Reinstall DC power outlet.

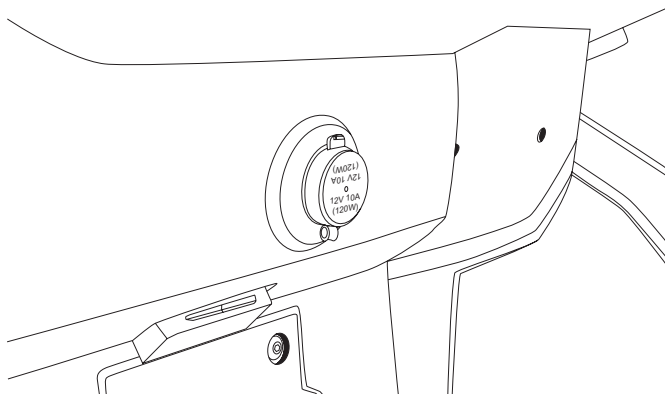

33. Install Mid Vent Adapter Housings (6) onto flex hose, then secure with Cable Ties (H13).

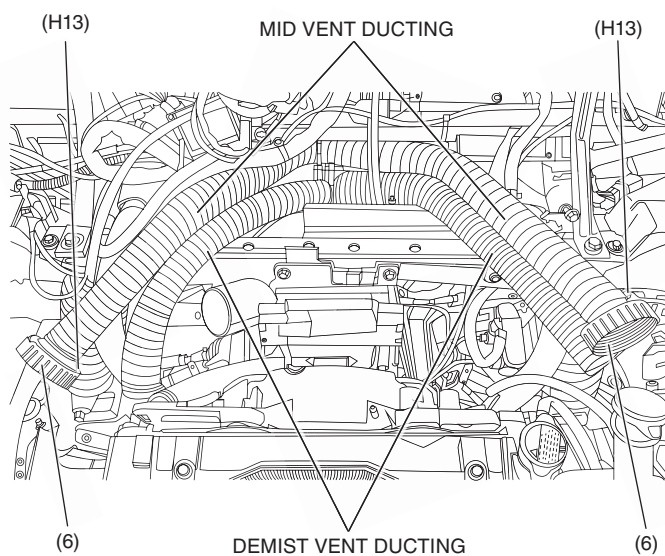

34. Install Mid Vent Adapter Housings (6) into dash by threading Mid Vent Adapter Rings (7) together through dash on both left and right sides. Then snap Mid Vent Louvers (8) into Mid Vent Adapter Rings as shown.

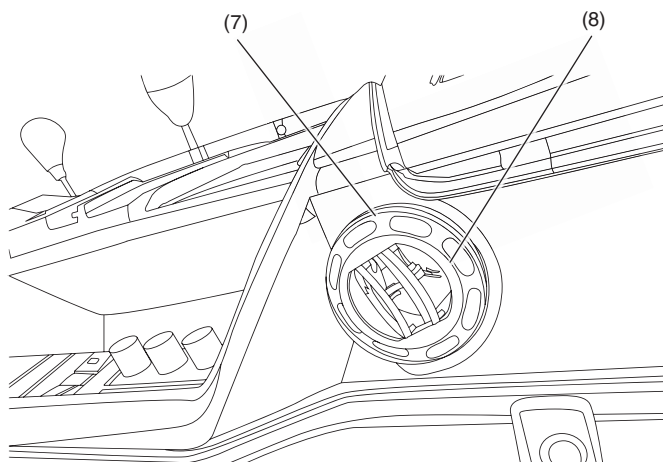

**NOTE: Reverse side of dash with Mid Vent Adapter Housings (6) not shown.**

35. Flex hoses should be routed as shown.

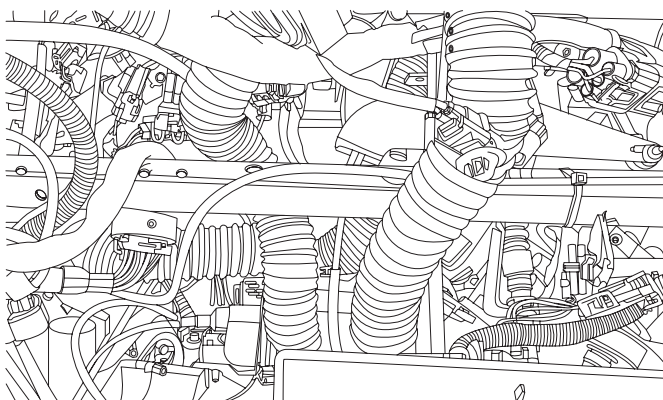

36. Position Demist Duct Adapter (10) from behind dash, attach flex hose and secure with Cable Ties (H13).

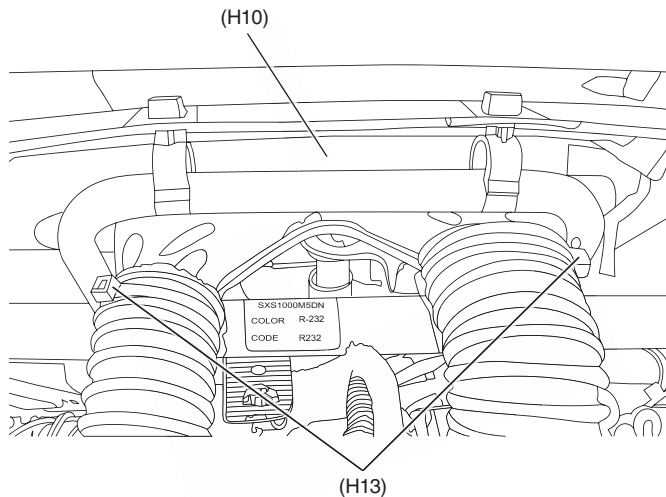

37. Push Demist Duct Adapter (10) toward cab and secure in place using two #8 Screws (H18) from edge of dash as shown.

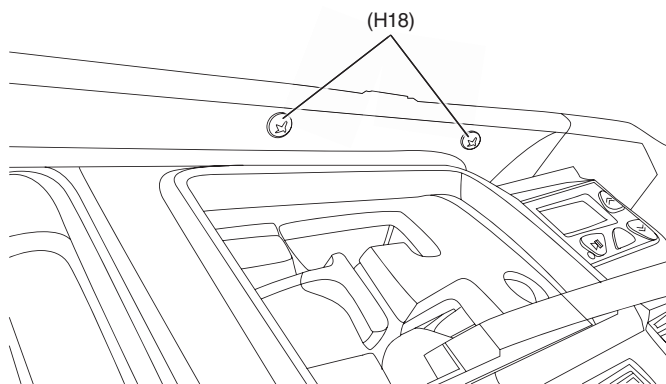

**NOTE: Reverse side of dash with Demist Duct Adapter (10) not shown.**

38. Install #8 Trim Clips (H4) as shown.

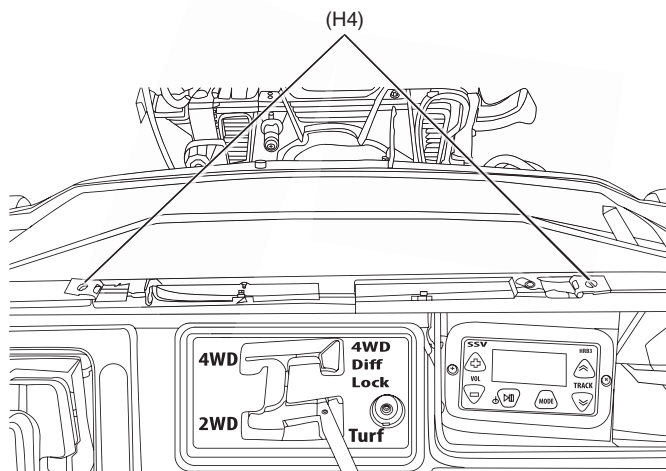

39. Install Demist Vent Assembly (9) to dash using two #8 Screws (H18) from the top.

**NOTE: Verify orientation of Demist Vent Assembly by matching contour of assembly bottom with top of dash.**

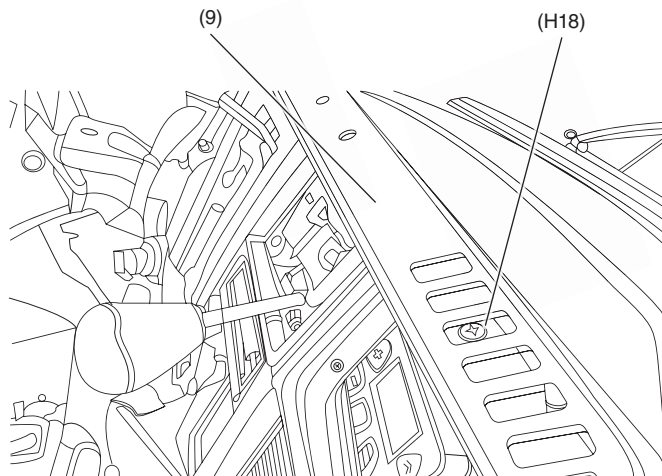

40. Snap Floor Vent Assembly (5) through lower dash onto Mode Control Assembly (4) and secure with two new Trim Clips (H11).

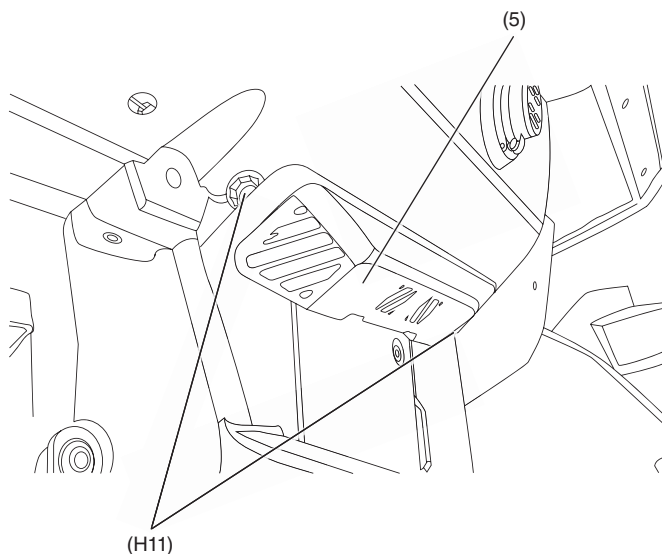

**NOTE: Reverse side of dash with Mode Control Assembly (4) not shown.**



41. Install Heater Harness (23).

**NOTE: Temperature control valve harness routes along Heater Inlet Hose (18) away from propeller shaft.**

Connect temperature control valve harness, mode control assembly harness, fan motor, two connections at PWM controller, and three connections at Control Panel Assembly (21).

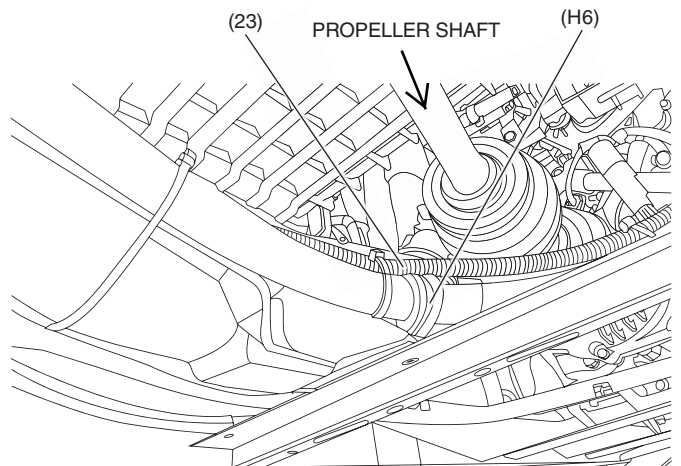
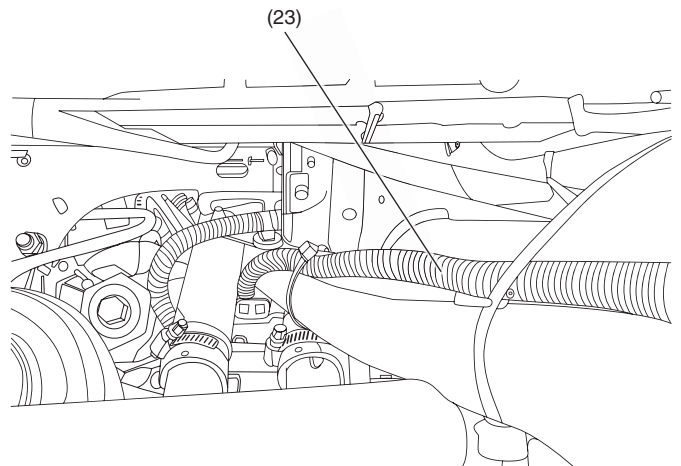
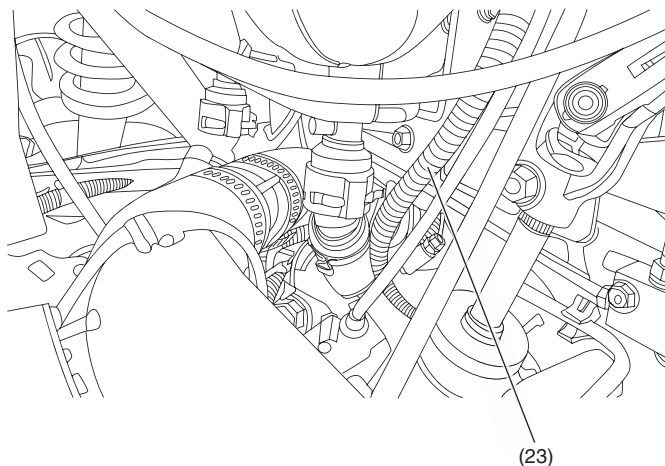
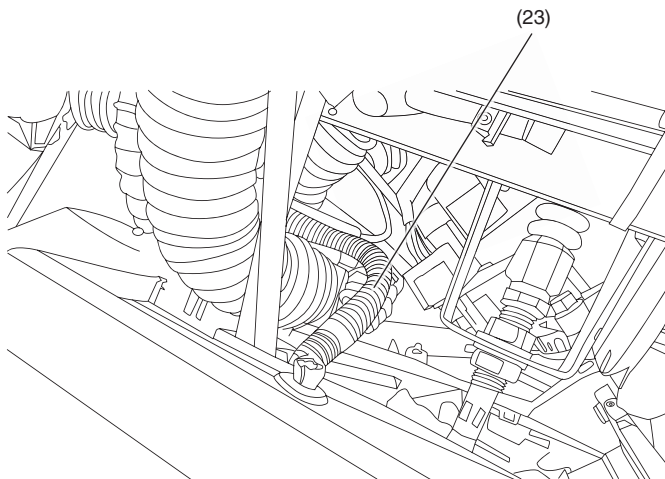
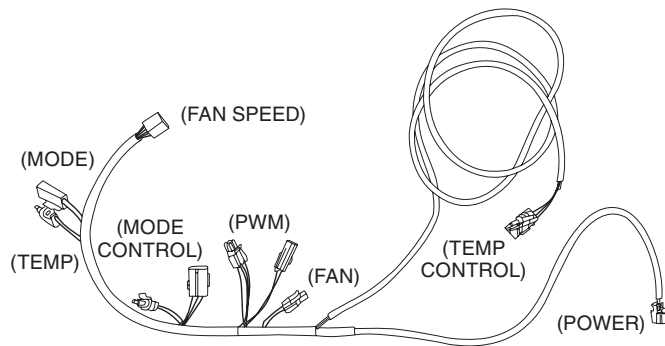

42. For HL4, coil excess Heater Harness (23) under seat using two Cable Ties (H13) as shown.

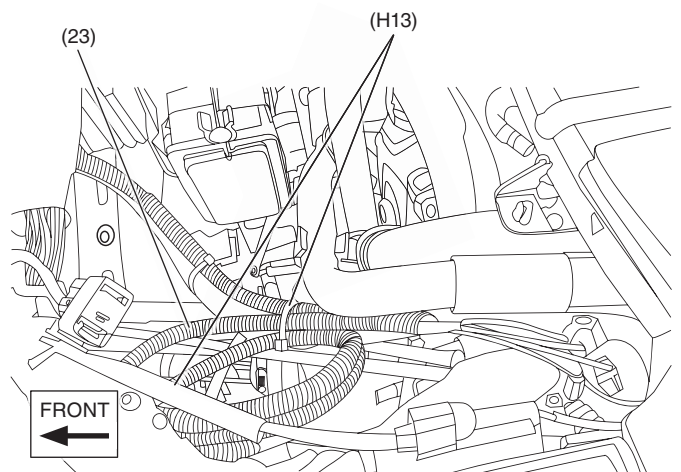

43. Wrap 1-inch P-clamp (H6) around Heater Harness (23), final clutch cable, and front differential lock cable. Then install remaining Lower Heater Assembly Mount Screw (3) as shown.

**NOTE: Use Cable Tie (H13) to secure throttle cable to cables in P-clamp. Snug Heater Assembly Mount Screw, overtightening can cause threads to strip out.**

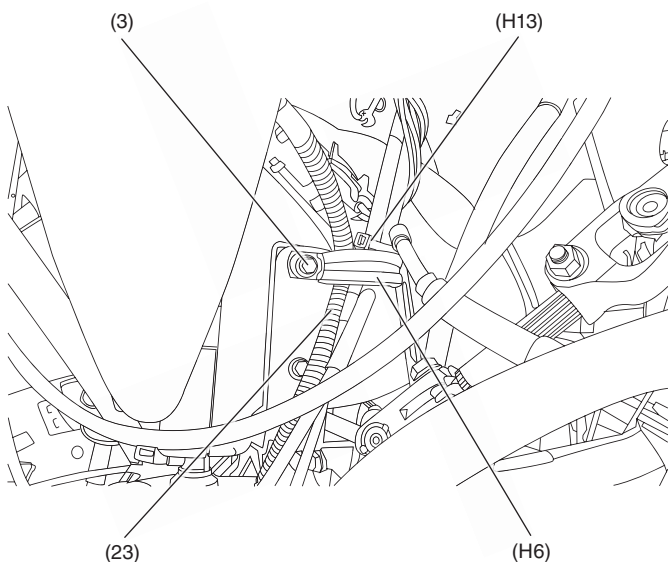

44. Install Return Vent Adapter Rings (16) by threading into Return Vent Adapter Housings (15) through dash. Then install Left Return Air Duct (11) and Right Return Air Duct (13) onto front cover of Heater Assembly (1). Then connect Return Air Duct Extensions (12) into ducts and onto Return Air Vent Housings.

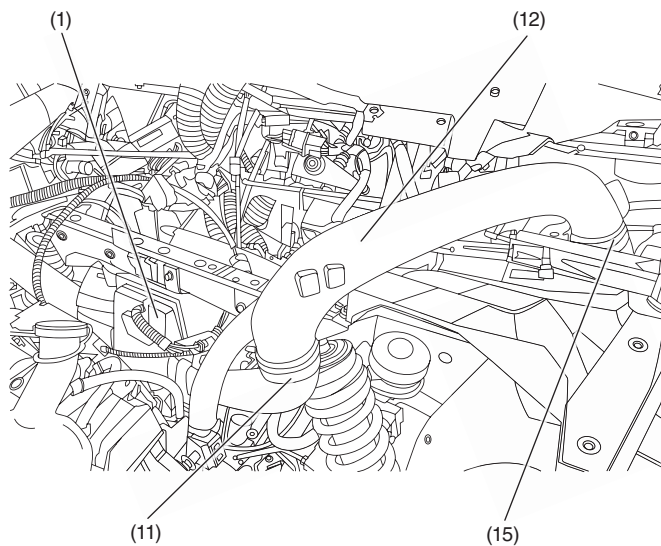
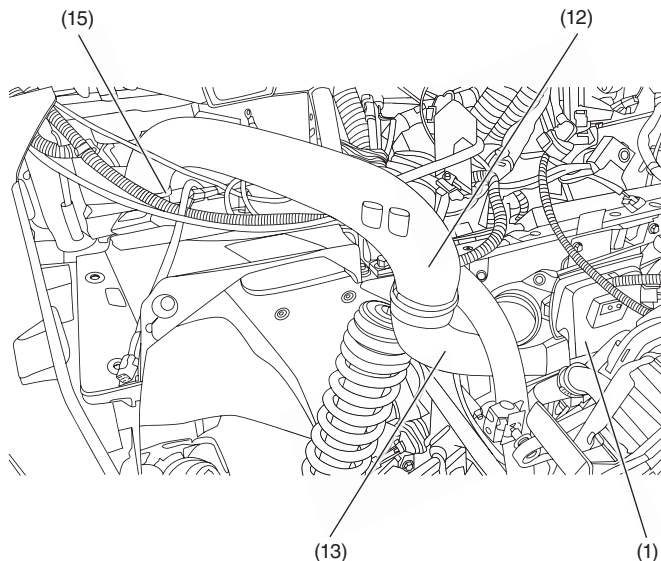

**NOTE: Reverse side of dash with Return Vent Adapter Rings (16) not shown.**

45. Snap Return Vent Grills (17) into Return Vent Adapter Rings (16) from under dash on both left and right side.

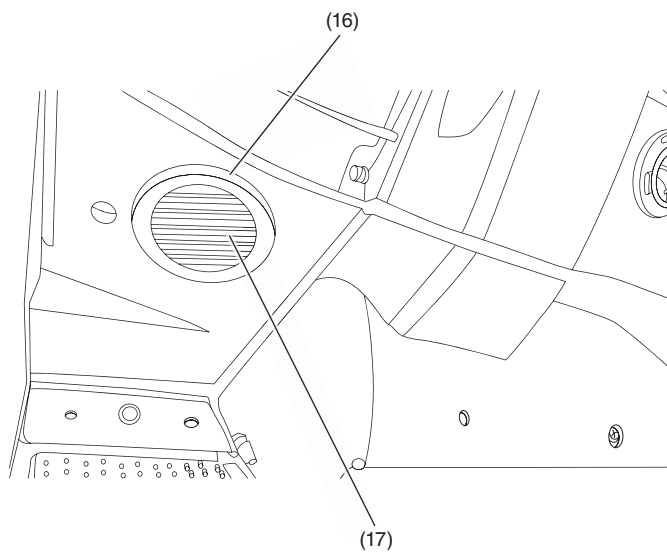

46. Reinstall front speaker assemblies (if installed).

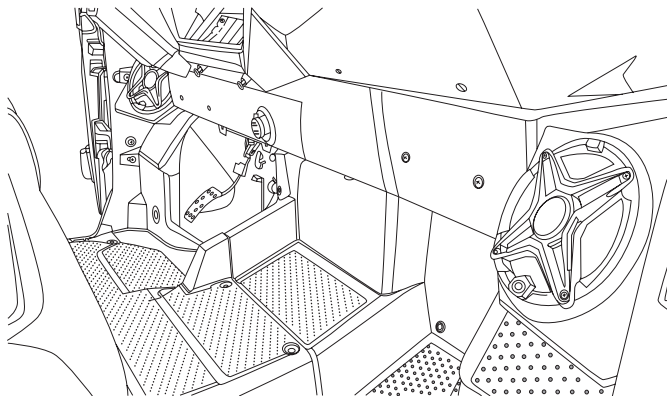

47. Re-mount coolant reservoir using existing hardware.

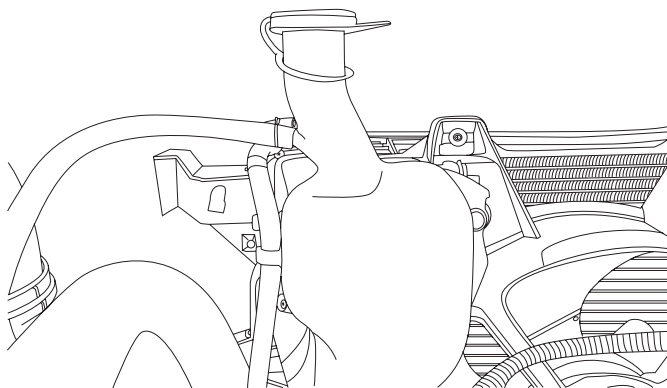

48. Re-mount side mount bolts from radiator using existing hardware as shown.

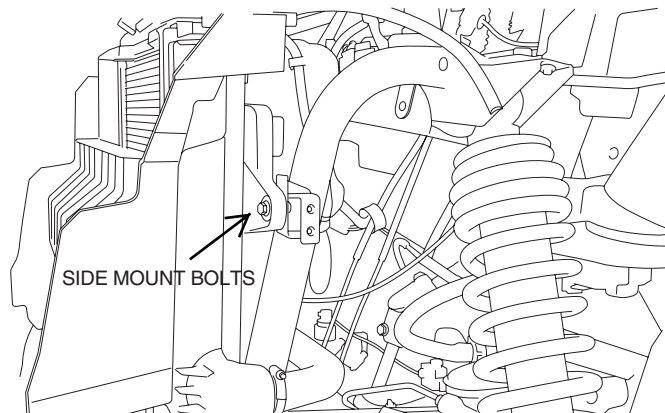

49. Re-mount front support frame using existing hardware as shown.

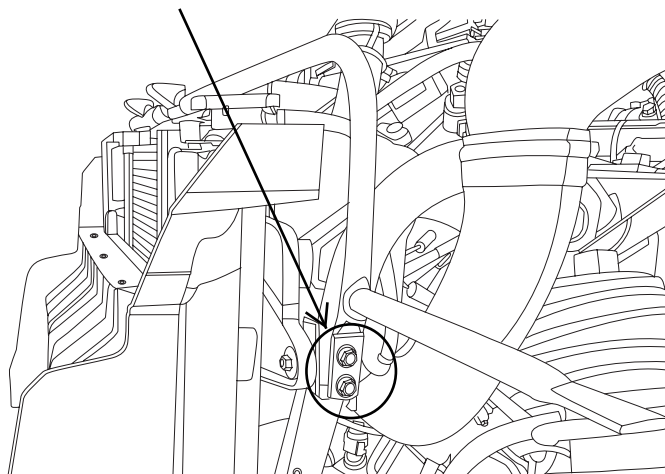

50. Remove cap from back of headlights. Unplug light and clip of front fender assembly on left and right side.

**NOTE: Do not unscrew bulb.**

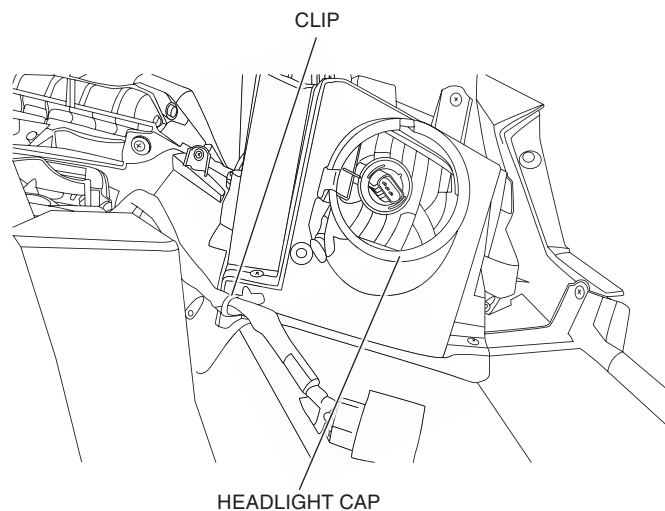

51. Install front fender assembly.

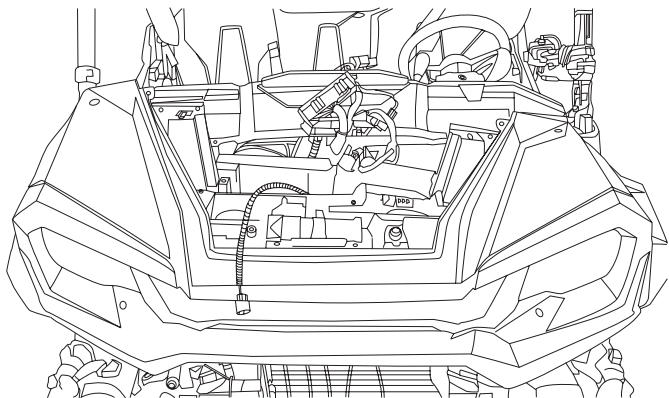

52. Route Heater Harness (23) power lead and connector through central hole of front fender assembly, pulling harness through to remove slack. Then secure heater power lead to headlight harness using Cable Tie (H13) as shown.

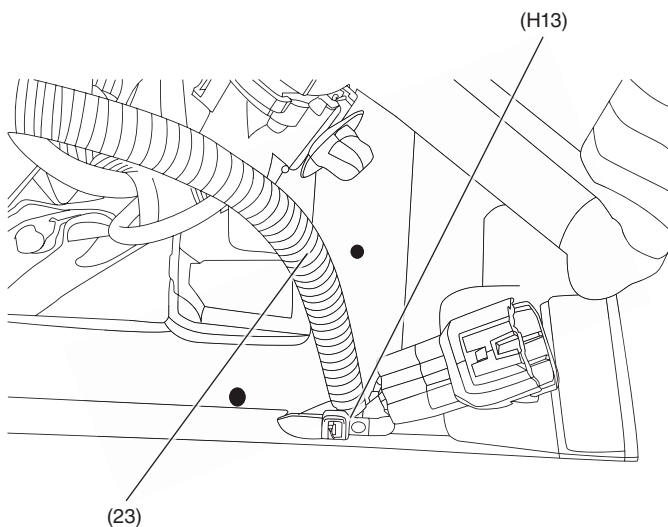

53. Route light wires under Return Air Duct Extensions (12) and plug lights back in, then reattach clips and reinstall caps to back of headlights.

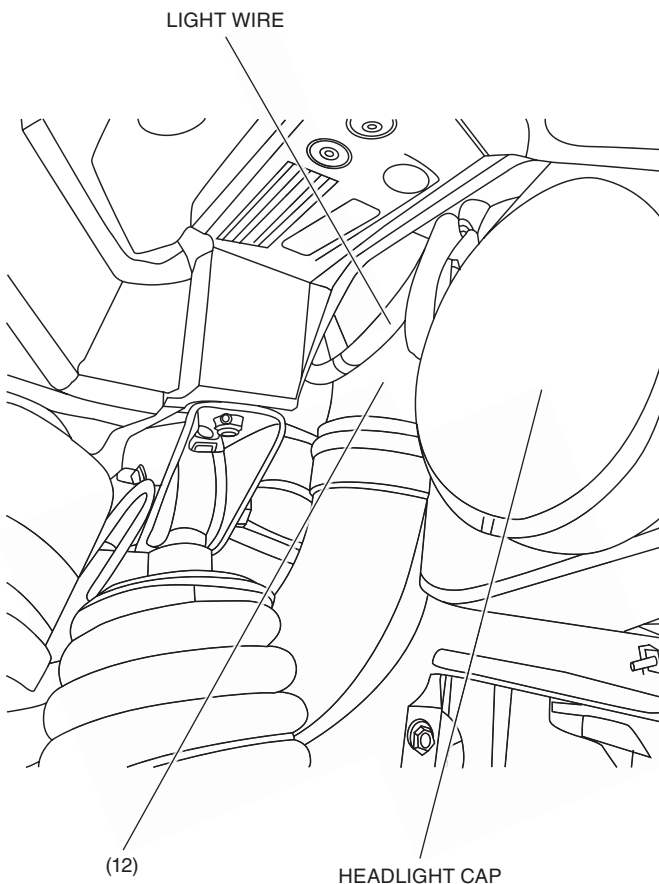

54. Using holes previously cut out in front fender for return air ducts, drill four 5/16-inch holes into Return Air Duct Extensions (12). Then install four new Trim Clips (H11) through fender and into Return Air Duct Extensions as shown. Reinstall emission control information label that was removed during step 9.

**NOTE: Take care in drilling only one side of Return Air Duct Extensions.**

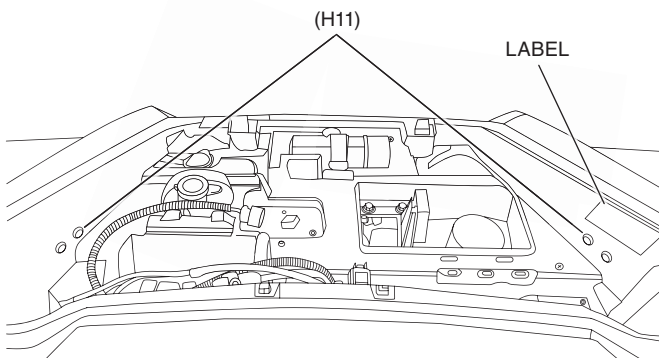

**NOTE: Reverse side of fender with Return Air Duct Extensions (12) not shown.**



55. Connect Heater Harness (23) power lead to accessory fuse block assembly.

**NOTE: Must be protected by 10 amp fuse.**

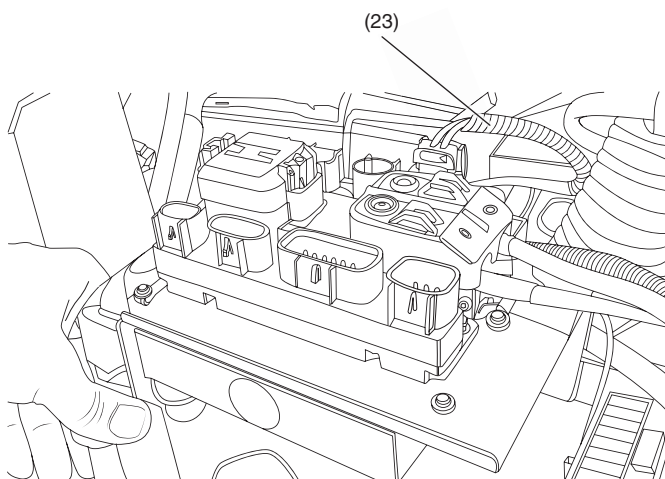

56. Reassemble vehicle in the following order, in accordance to the Service Manual:

- Dash under storage assembly
- Skid plate(s)
- Rear footwell (5-passenger models only)
- Rear side covers (5-passenger models only)
- Under seat cover
- Seat cushion
- Front side covers
- Left and right front doors
- Front bumper (if equipped)
- Battery
- Front hood

57. If equipped with polycarbonate windshield accessory, install Windshield Bracket (MB1) to Demist Vent Assembly (9) using two M5 × 10 mm Bolts (H17) as shown. Then insert M6 × 20 mm Bolt (H16) through windshield and Windshield Bracket and secure using M6 Lock Nut (H7).

**NOTE: Overtightening M6 × 20 mm Bolt and M6 Lock Nut could damage windshield.**

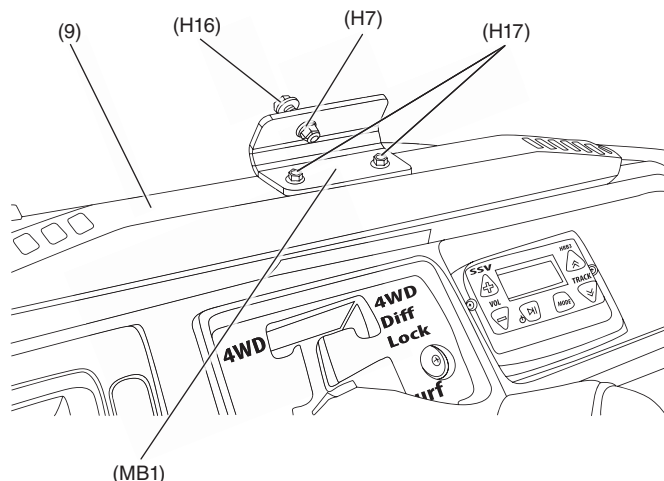

58. Fill radiator with Pro Honda HP coolant.

59. Bleed engine cooling system according to Service Manual.

60. Verify heater functions properly by warming vehicle up to operating temperature, turning temp control to maximum heat, turning fan speed on high, and rotating mode control selection through all configurations. Unit should be blowing warm air. Test drive the vehicle and check the heater performance. Check for leaks and correct as necessary.

61. Top off engine coolant. Make sure the coolant level in the reserve tank is at the MAX level. Coolant will be consumed from the reserve tank as air is expelled from the cooling system during and after test drives. Add coolant to reserve tank as necessary.

TEMPLATES

Print templates at 1:1 scale to ensure proper fit during installation.

**NOTE:** For Floor Vent Template (P/N IT-613-5), attach the two pieces together along dashed line before cutting and applying.

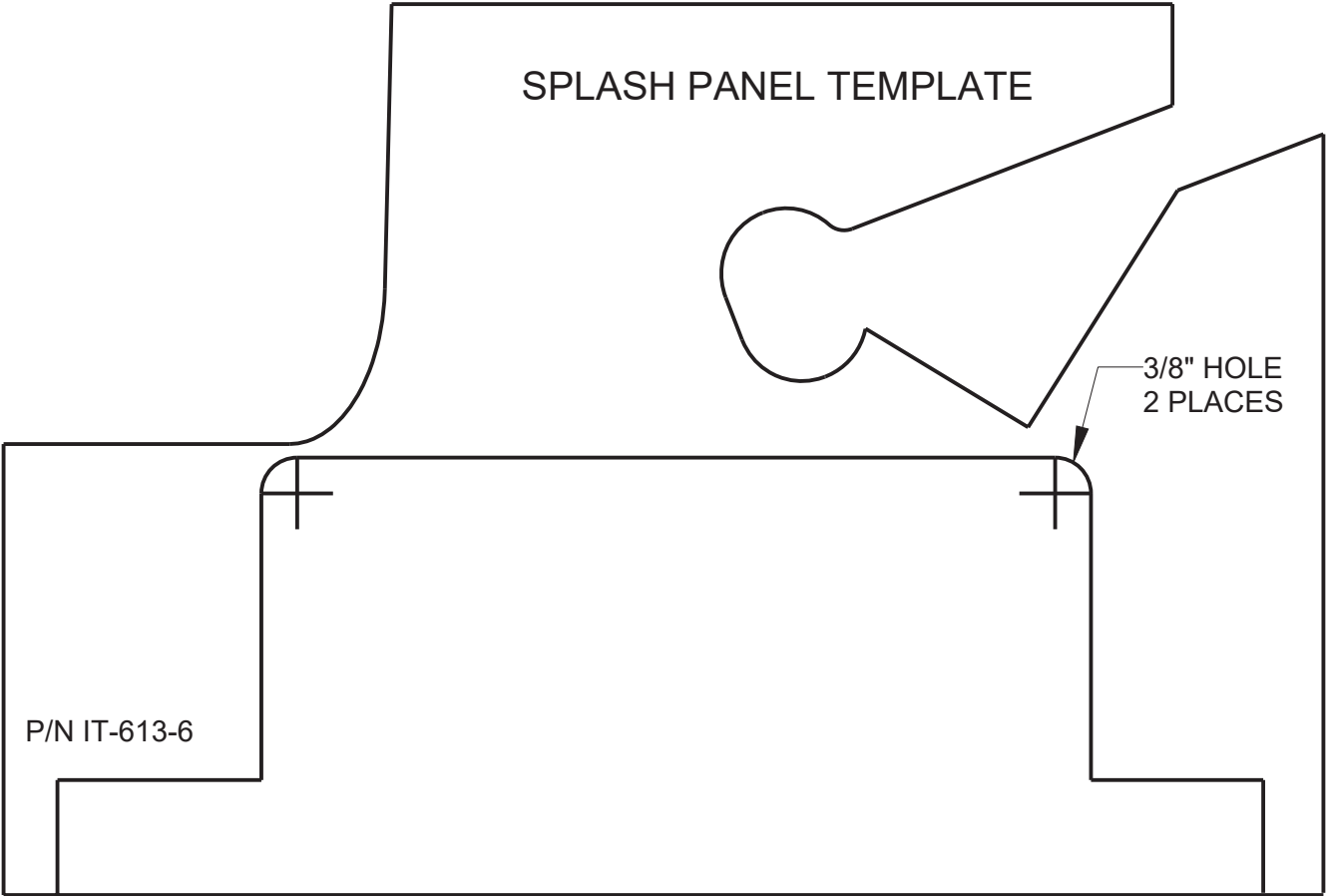
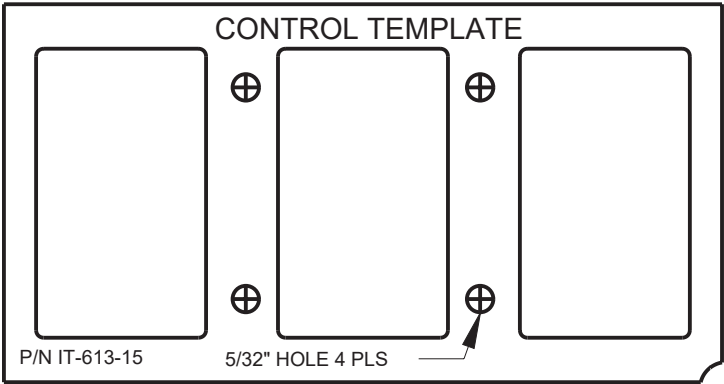
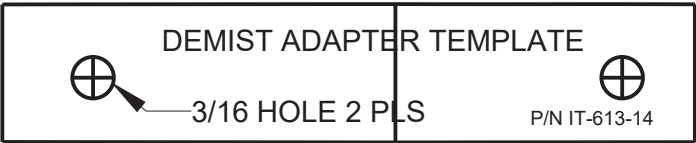
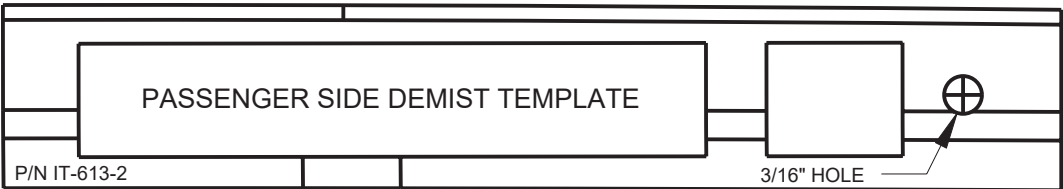

NOTE

For Floor Vent Template (P/N IT-613-5), cut along cut mark and then register the two pieces together along dashed line before applying.

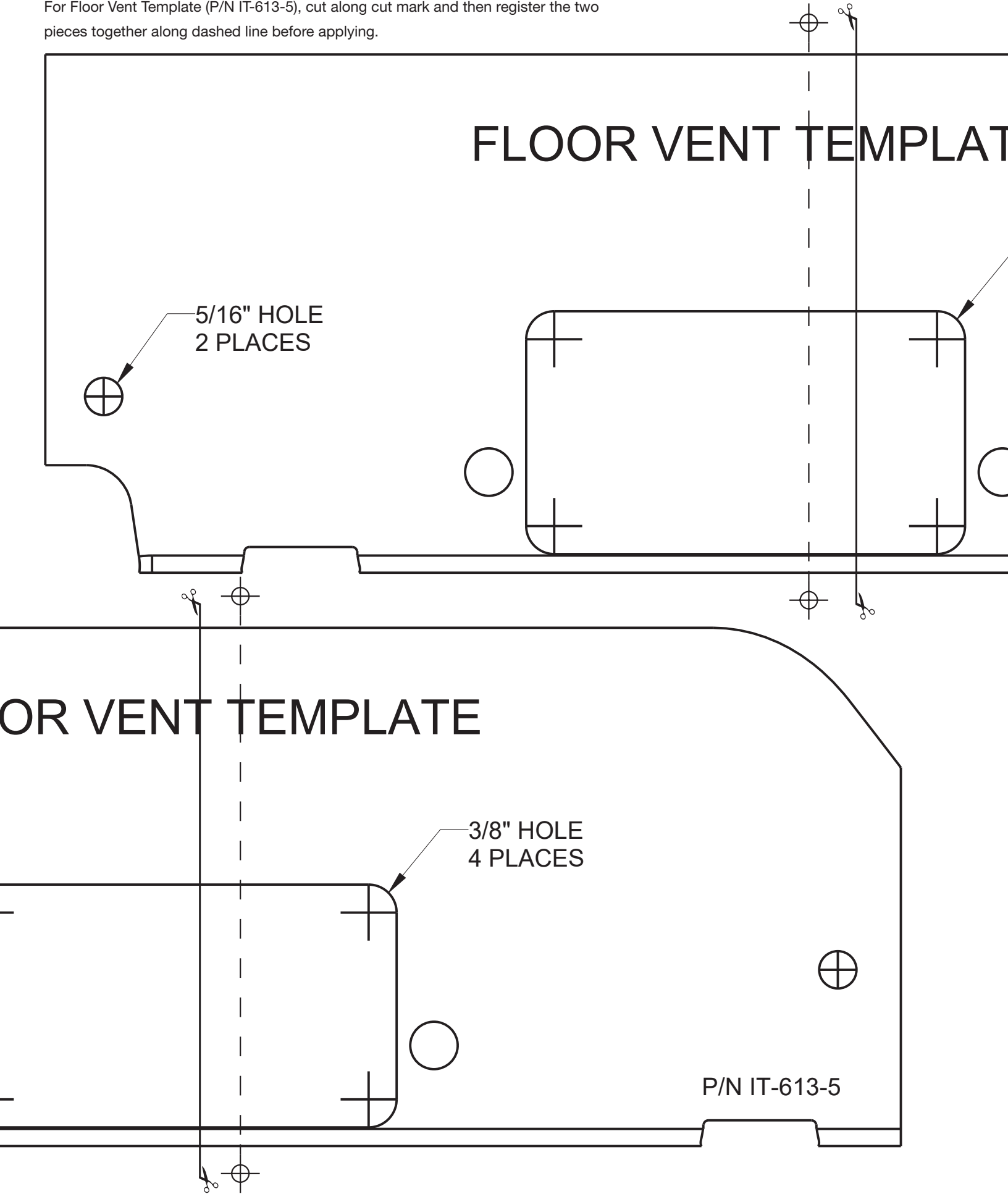

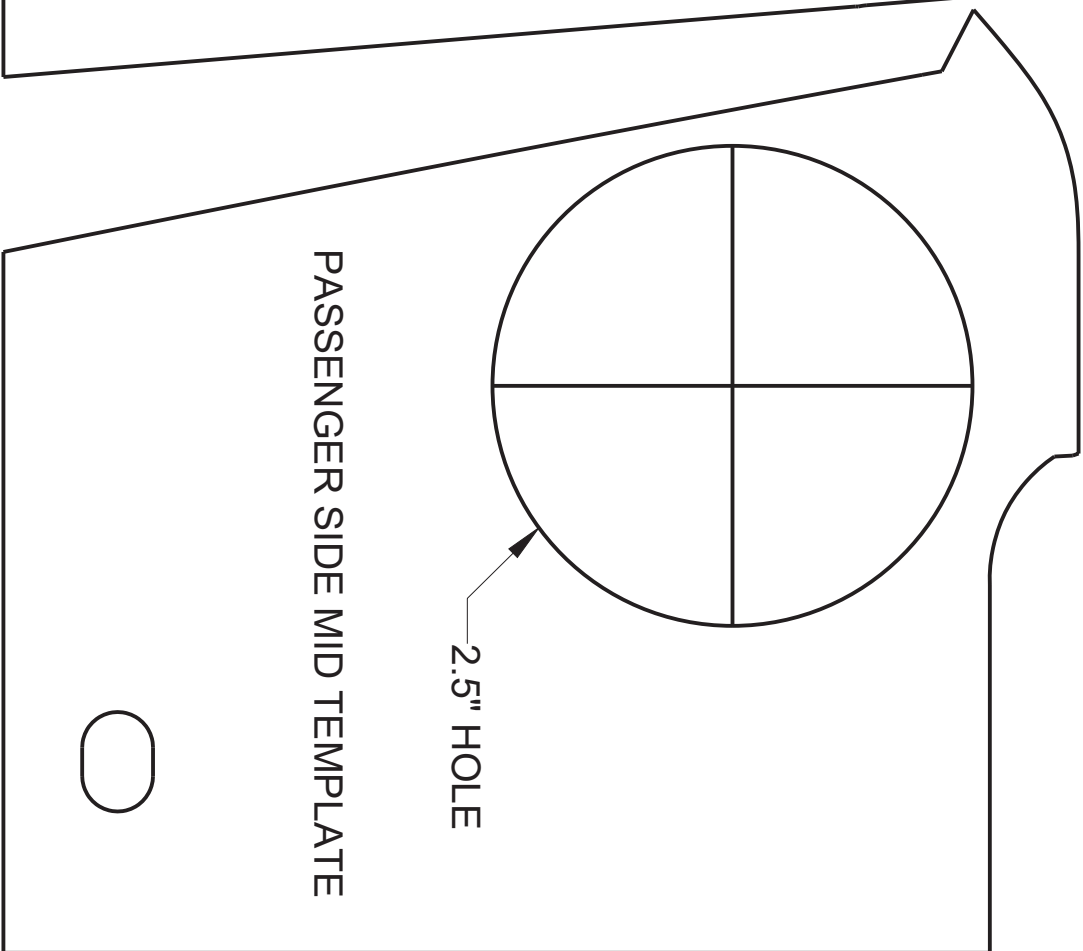
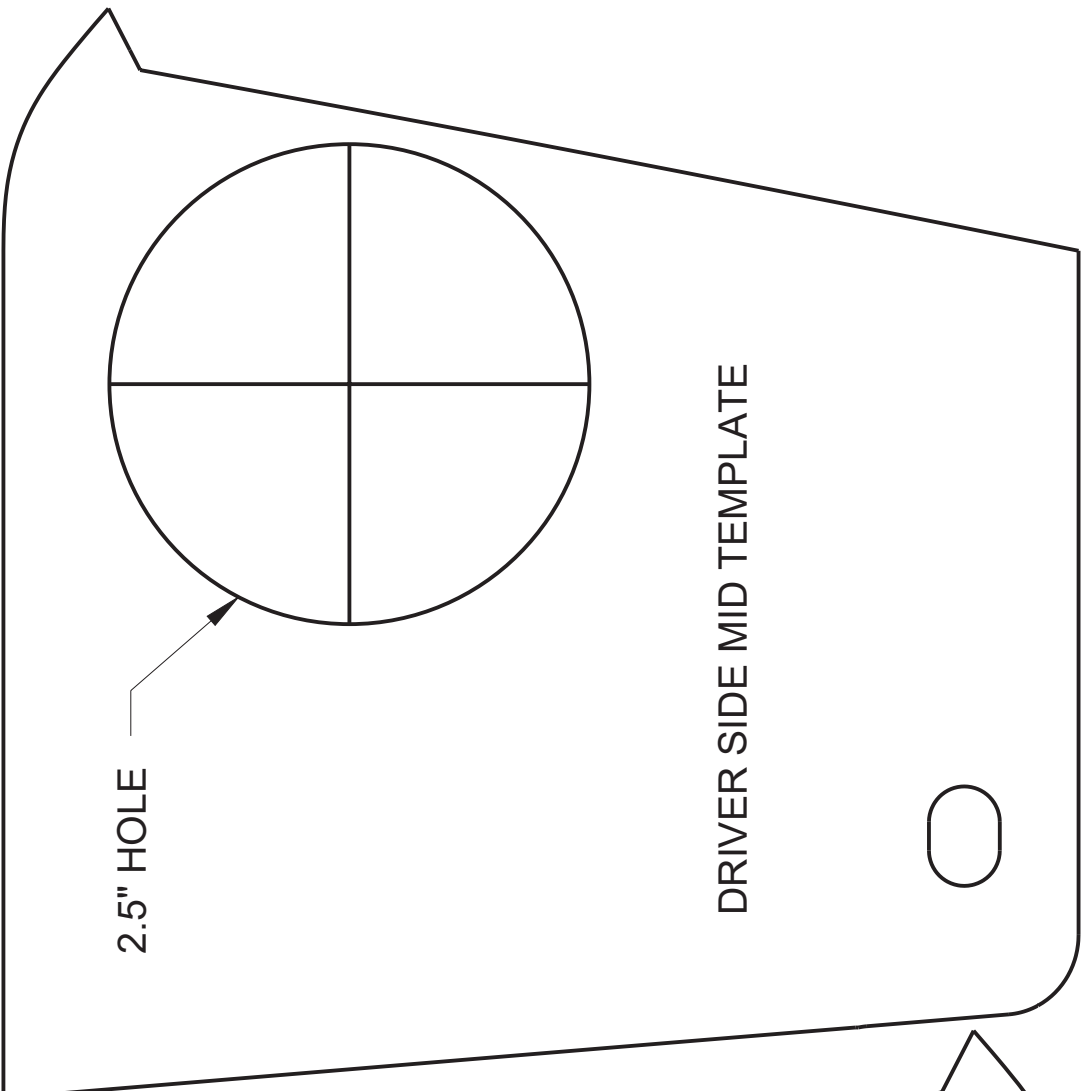

DRIVER SIDE RETURN TEMPLATE

3" HOLE

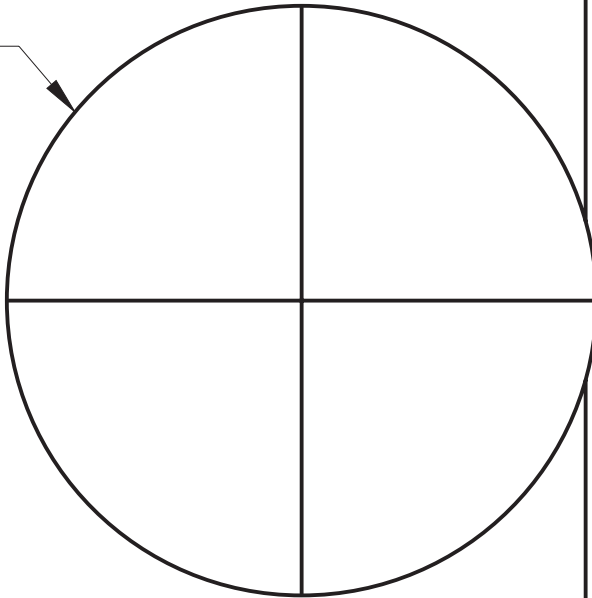

P/N IT-613-10

DRIVER SIDE  
RETURN DUCT TEMPLATE

5/16" HOLE  
2 PLS



P/N IT-613-12

# PASSENGER SIDE RETURN TEMPLATE

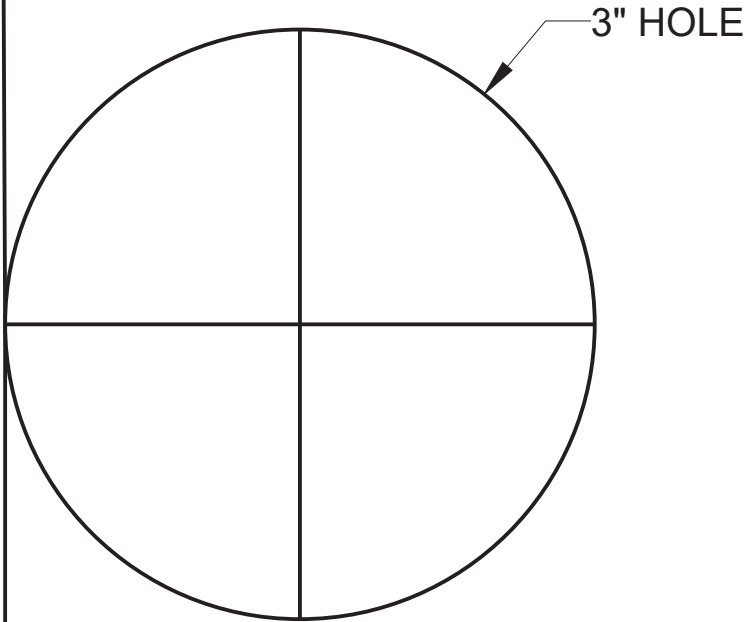

P/N IT-613-11

# PASSENGER SIDE RETURN DUCT TEMPLATE

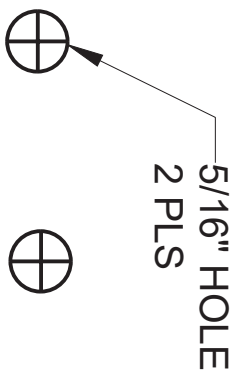

P/N IT-613-13

