



INSTALLATION INSTRUCTIONS

Accessory

QUICK SHIFTER
P/N 08U72-MKN-D50

Application

CB650RA
CBR650RA

Publication No.

MII

Issue Date

October 2018

Honda Dealer: Please give a copy of these instructions to your customer.

PARTS LIST

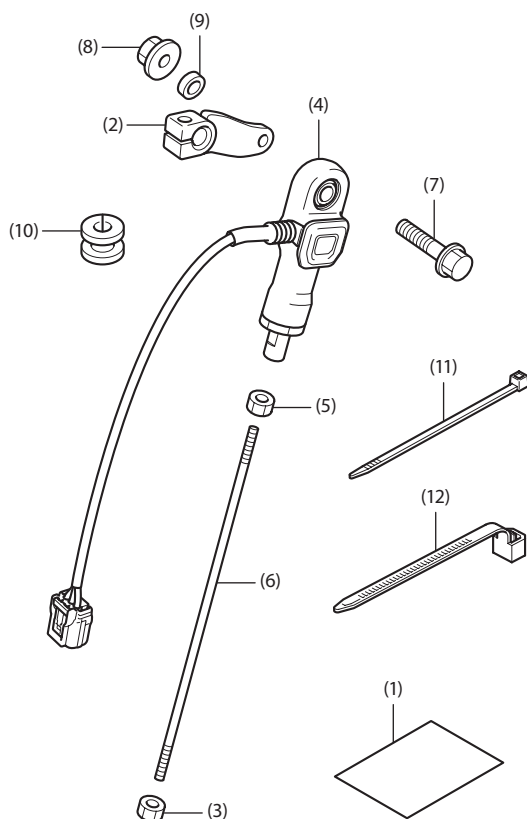

No.	Description	Qty
(1)	URL paper	1
(2)	Gear change arm	1
(3)	6 mm nut	1
(4)	Gear change sensor	1
(5)	6 mm nut (left hand thread)	1
(6)	Tie rod bolt	1
(7)	7 mm flange bolt	1
(8)	7 mm flange nut	1
(9)	Collar	1
(10)	Protector	1
(11)	Wire tie (narrow)	1
(12)	Wire tie (wide)	1

TOOLS AND SUPPLIES REQUIRED

Socket (10 mm)
Ratchet
Box-end wrench (10 mm)
Open-end wrench (10 mm)
Scale
Nippers
Marker
Electrical tape
Grease
Torque wrench

TORQUE CHART

Tighten all screws, bolts, and nuts to their specified torque values. Refer to the Service Manual for the torque values of the removed parts.

Item	N·m	kgf·m	lbf·ft
6 mm nut	10	1.0	7
7 mm flange nut	12	1.2	9

INSTALLATION

▲ CAUTION

- To prevent burns, allow the engine, exhaust system, radiator, etc., to cool before installing the accessory.
- Be sure to observe all safety messages and precautions described in the Service Manual while removing and installing the fuel tank.

NOTE:

- Do not disassemble the gear change sensor.
- Disconnect the negative (-) cable from the battery before installing this accessory.
- The memories of the clock will be erased when you disconnect the battery. Reset the memories after reconnecting the battery.
- Trim the excess ends off the wire ties after attaching them to the wire harnesses. Do not allow the cut part of the wire tie to interfere with another harness or brake hose.
- Reinstall the removed parts on the motorcycle and make sure that the wires and harnesses are not pinched.
- Although the illustration is of CB650RA, use the same procedures for other models.

1. Remove the pillion seat as shown.

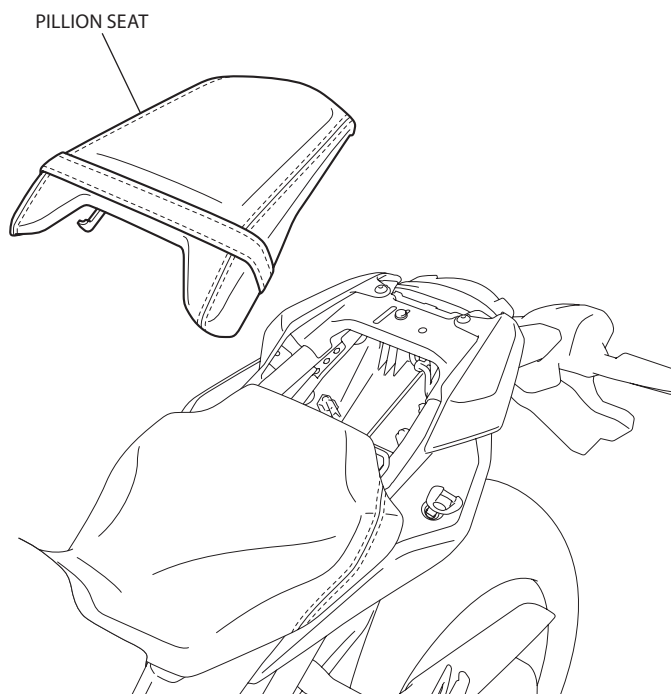

2. Remove the main seat as shown, and disconnect the negative (-) cable of the battery.

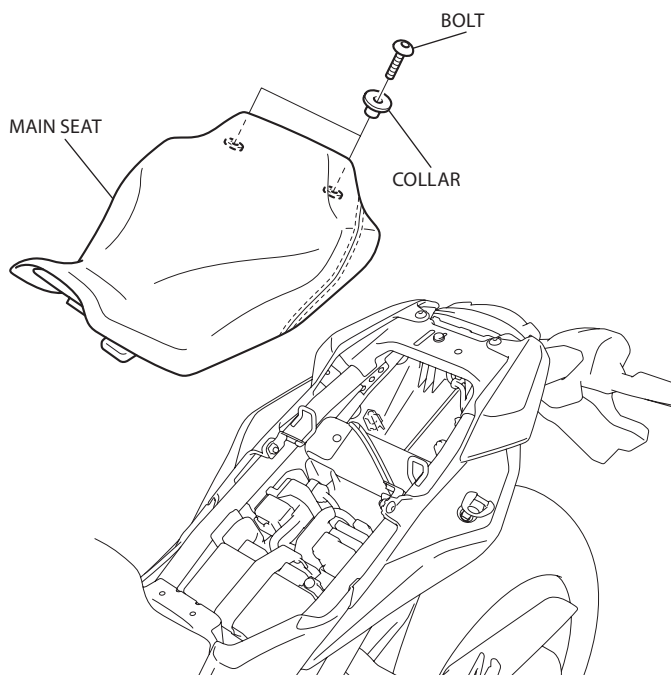

3. Remove the left side cover as shown.

- Repeat on the right side.

<Left side>

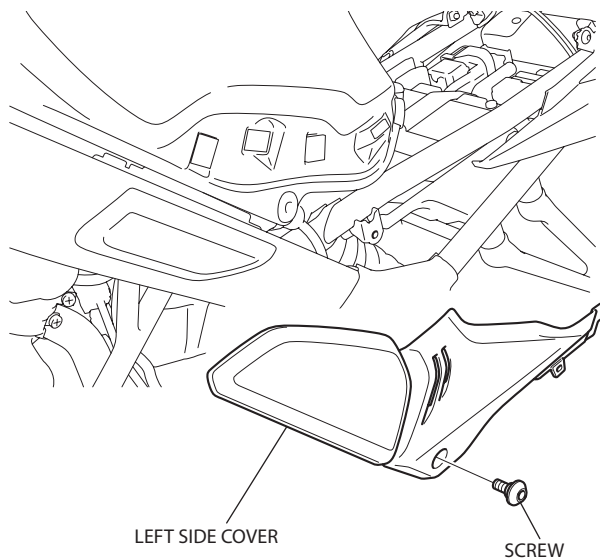

4. Remove the screws as shown.

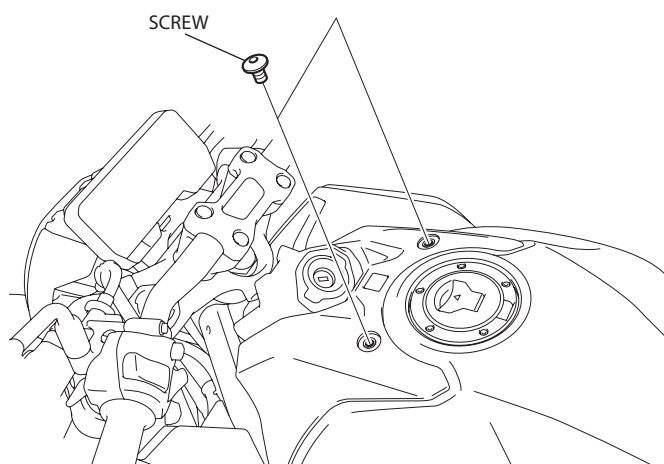

5. Remove the tank front cover as shown.

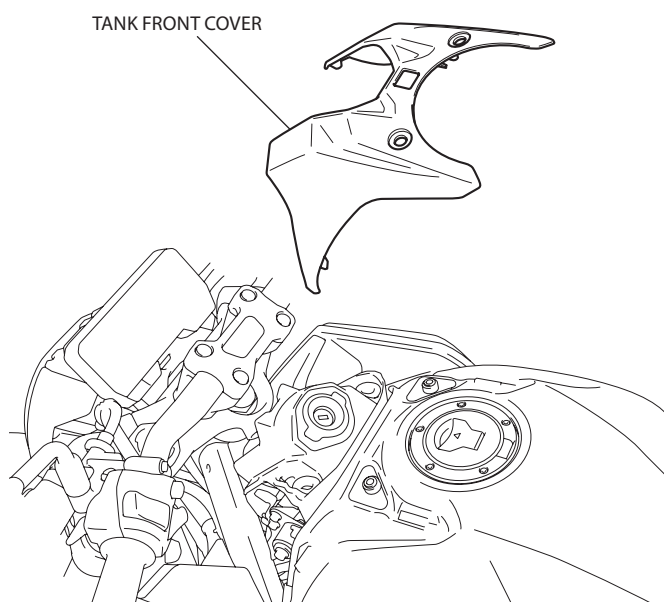

6. Remove the switch cover as shown.

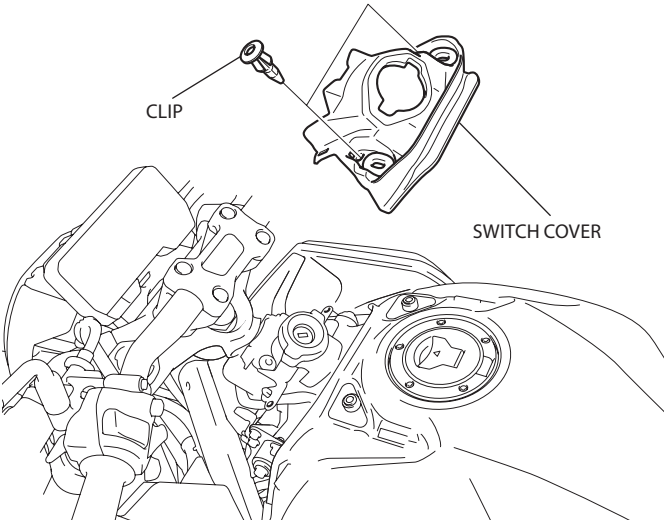

7. Remove the bolt as shown.
• Repeat on the right side.

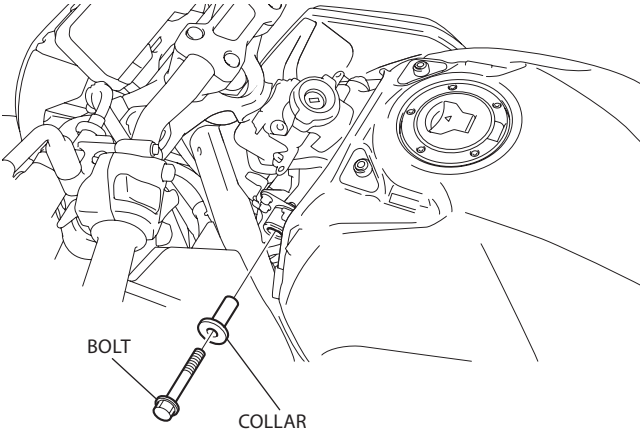

8. Remove the indicated parts with raising the front part of the fuel tank.
<Left side>

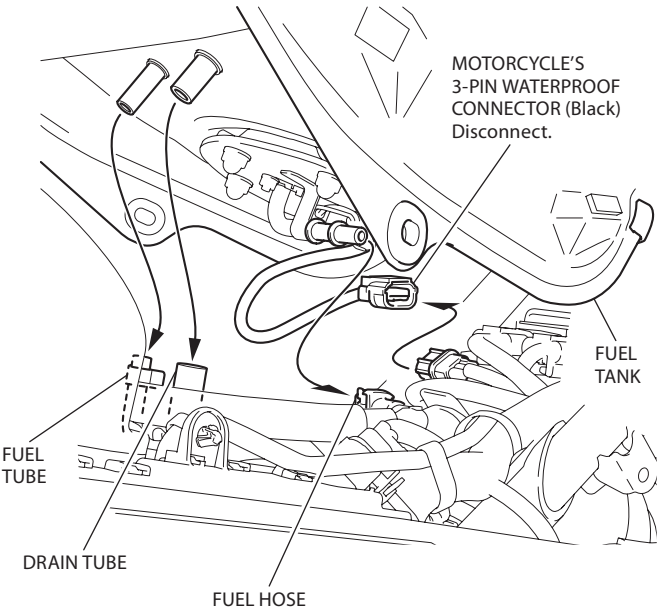

9. Remove the bolt as shown.

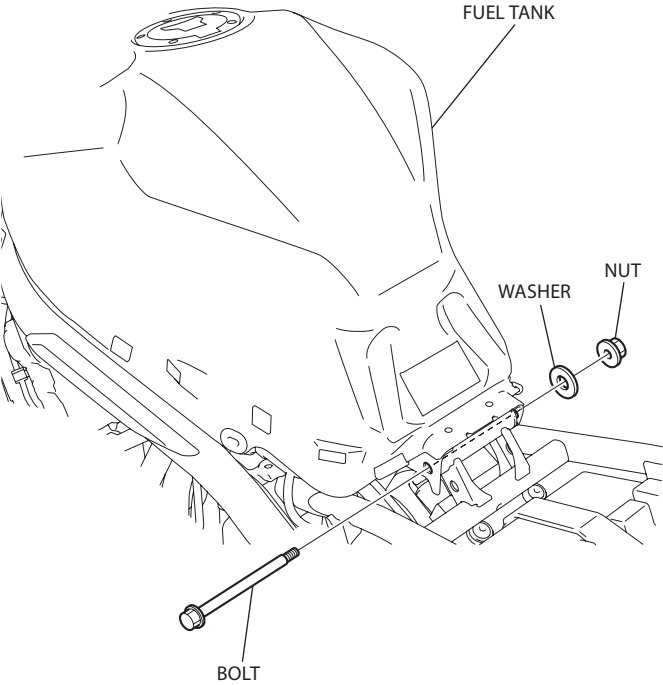

10. Remove the fuel tank as shown.

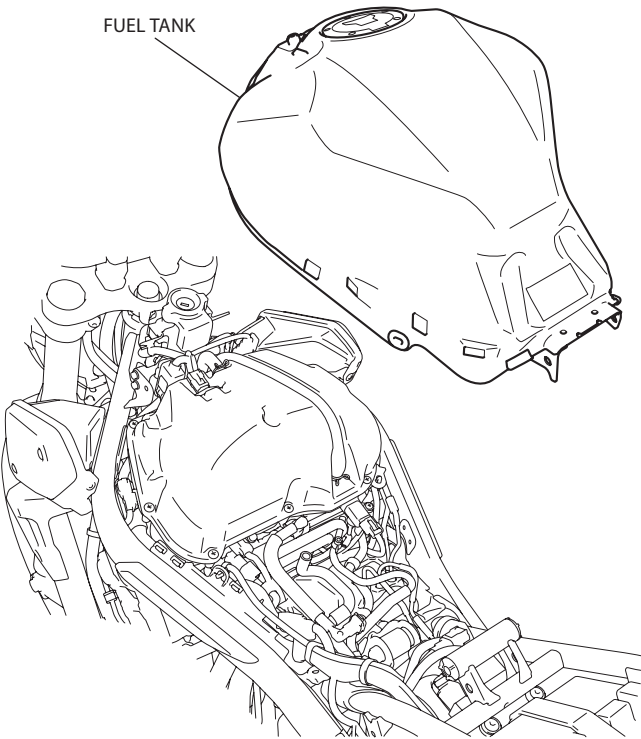

11. Remove the bolt as shown.
<Left side>

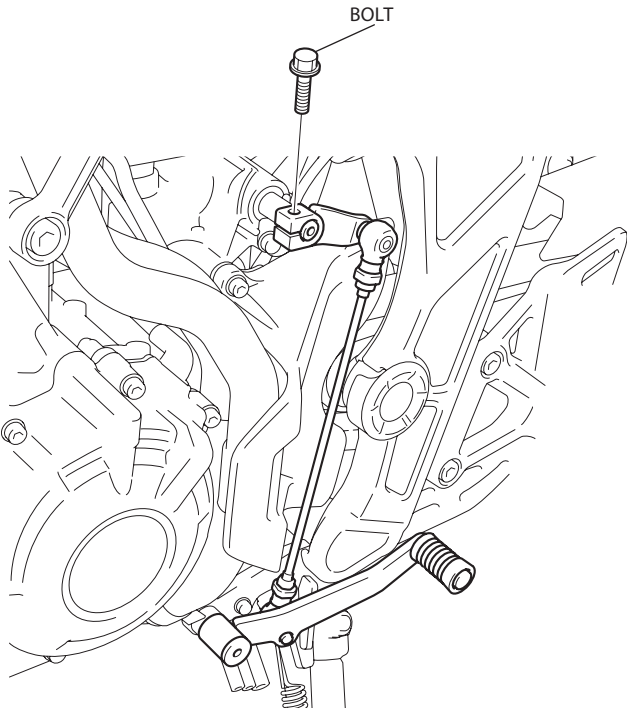

12. Remove the gear change pedal as shown.

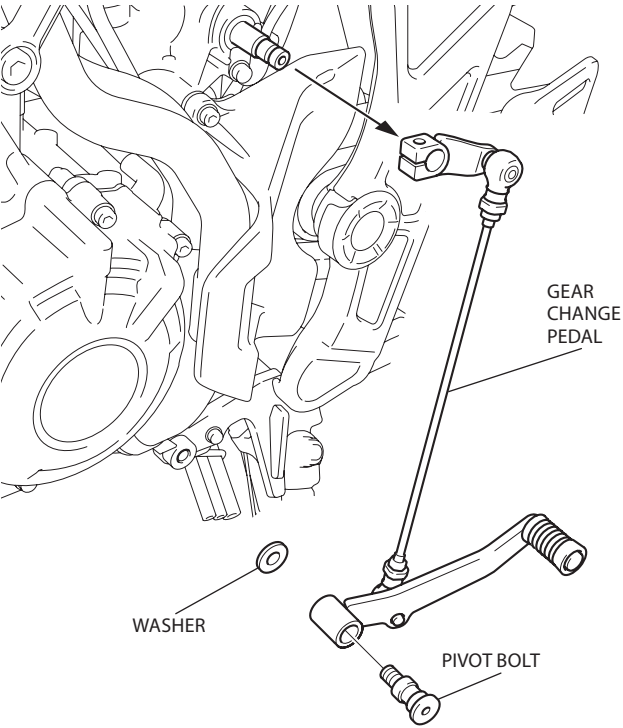

13. Remove the rod and arm as shown.

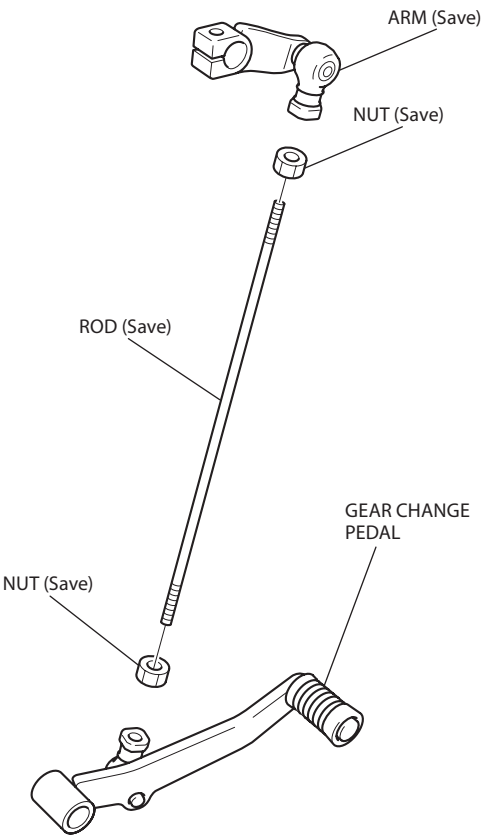

14. Loosely install the tie rod bolt and gear change pedal as shown.

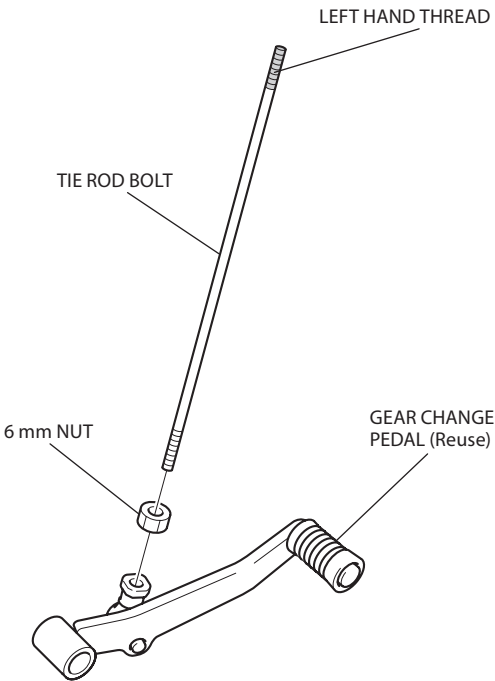

15. Mark the gear change sensor harness in the position shown.

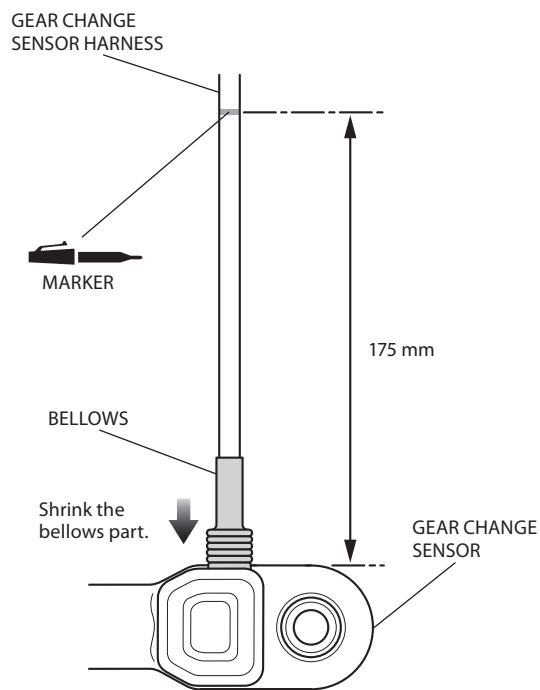

16. Install the protector as shown.

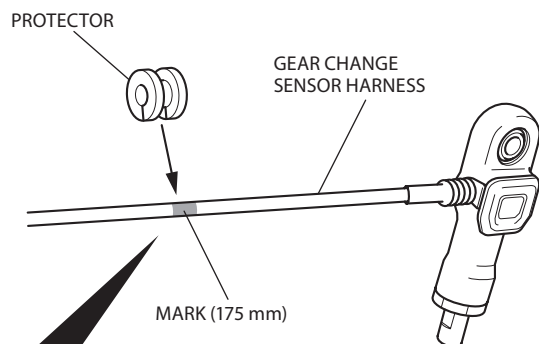

Secure the protector with the electrical tape.

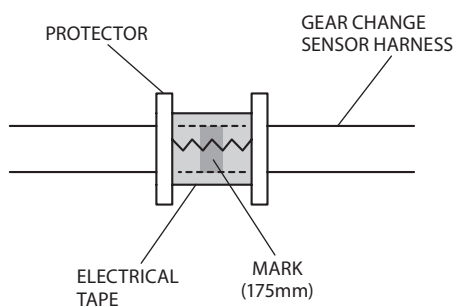

17. Loosely install the gear change sensor as shown.

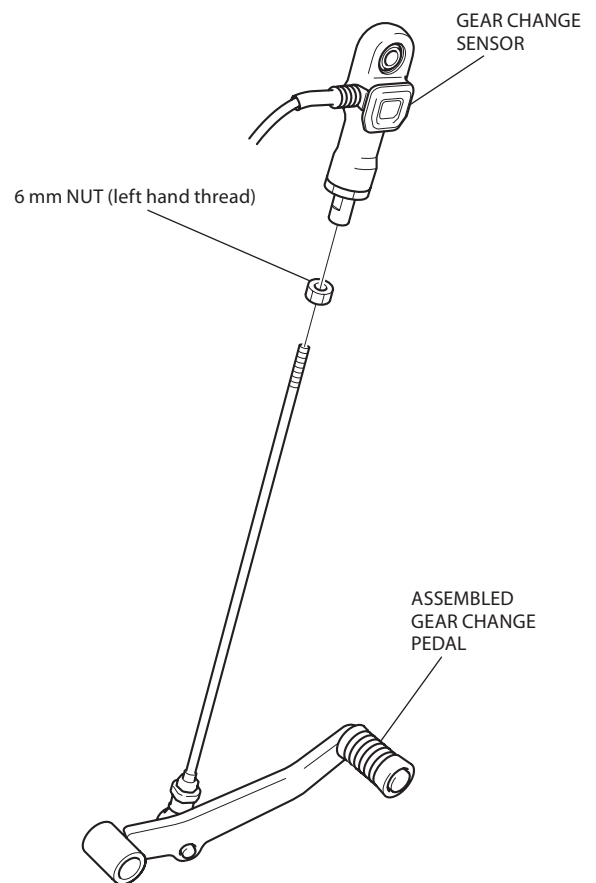

18. Install the gear change arm as shown.

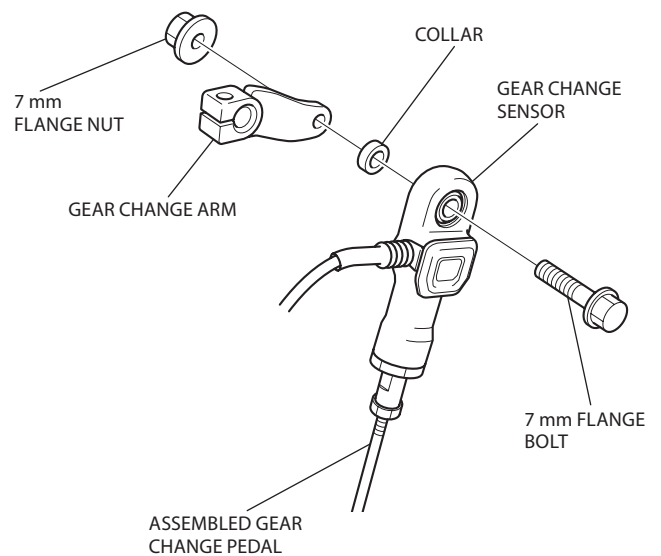

19. Install the assembled gear change pedal as shown.

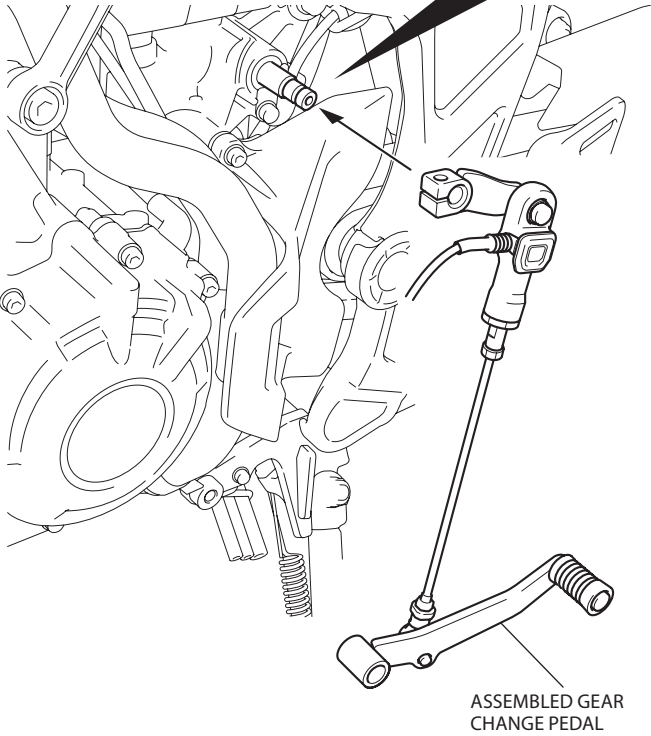
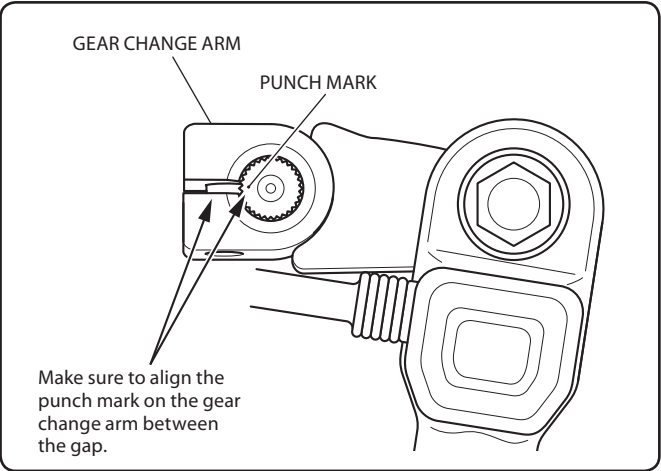

20. Apply grease to the bolt as shown.

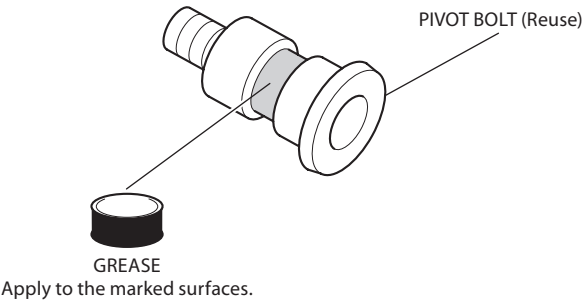

21. Secure the gear change pedal as shown.

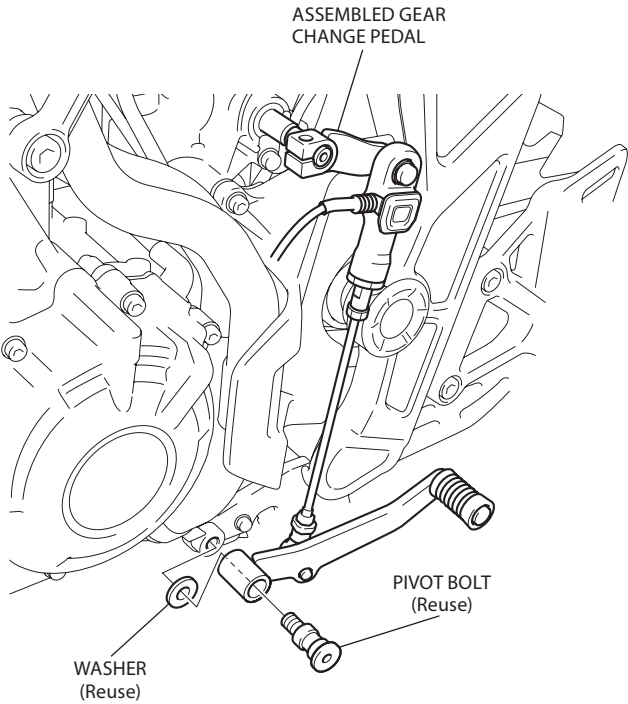

22. Install the bolt as shown.

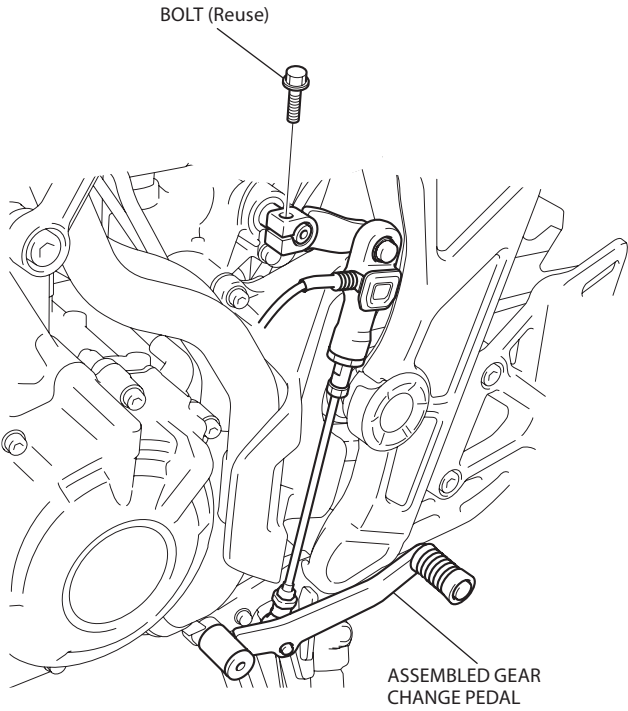

23. Tighten the loosely installed parts securely to the dimension shown.

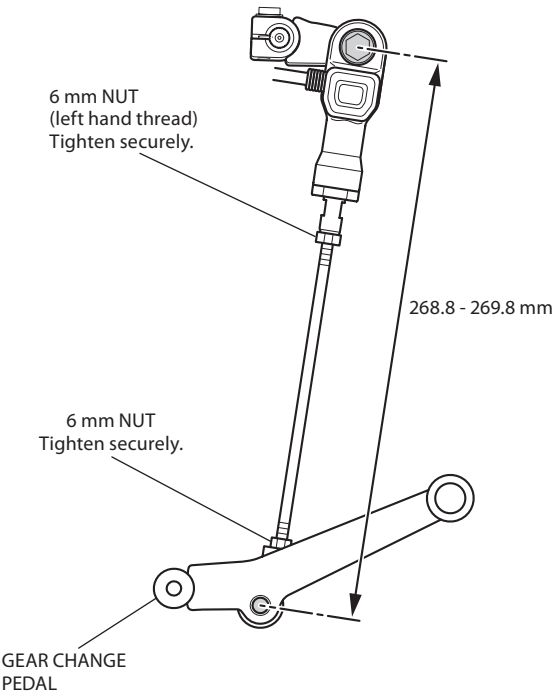

24. Disconnect the dummy connector as shown.

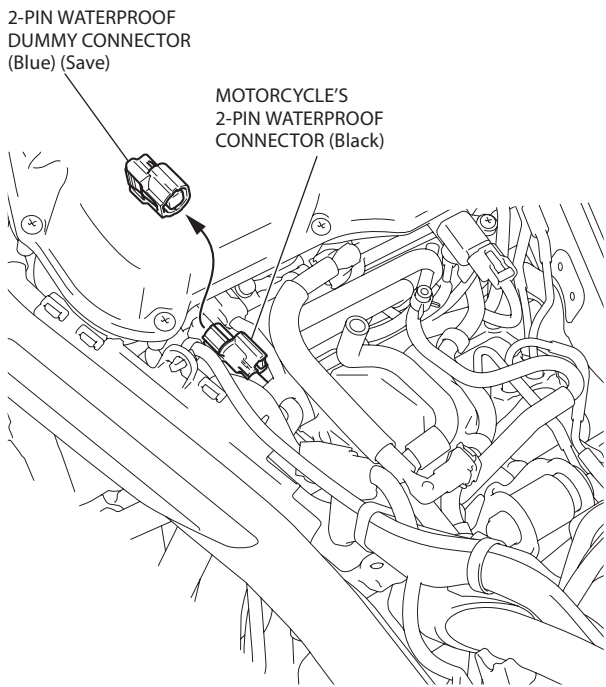

25. Route the gear change sensor harness as shown.

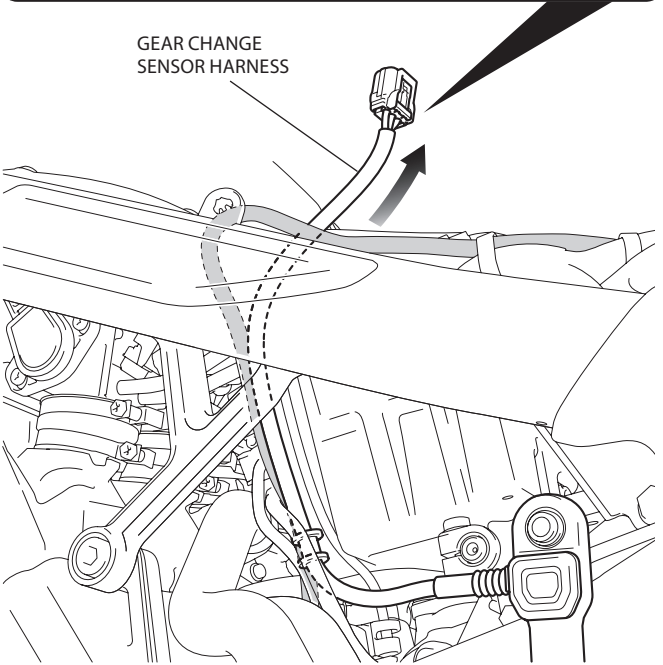
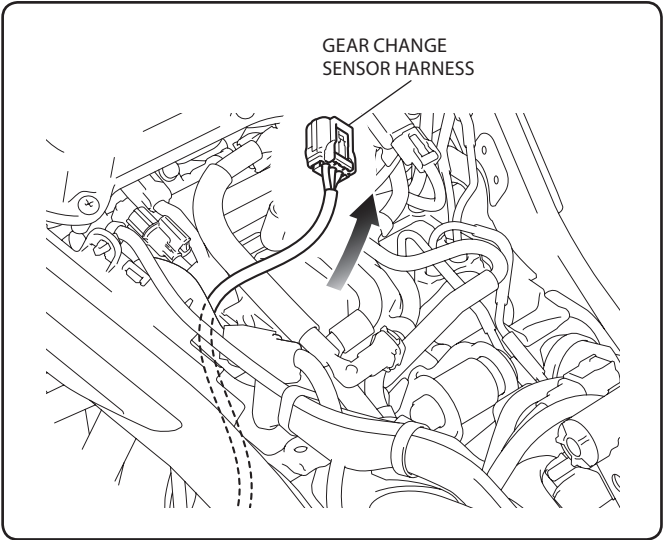

26. Connect the gear change sensor harness as shown.

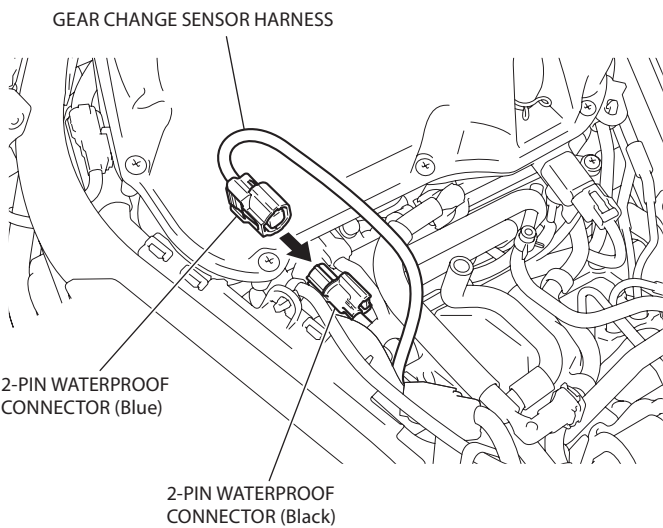

27. Secure the gear change sensor harness with the wire tie as shown.

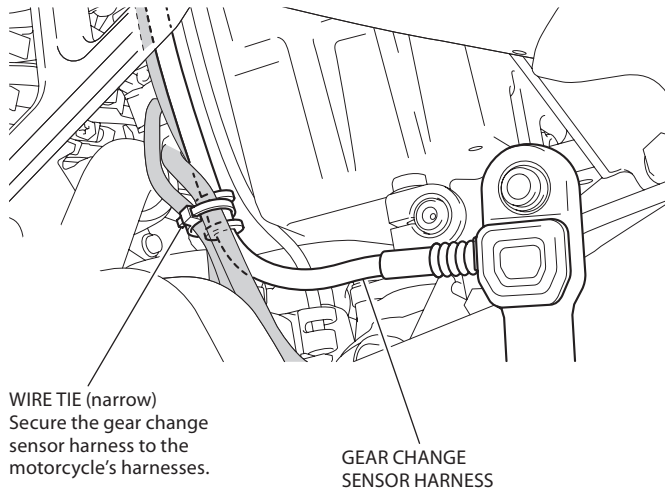

28. Bundle the excess harness with the wire tie as shown.

- Do not cut the excess wire tie ends.

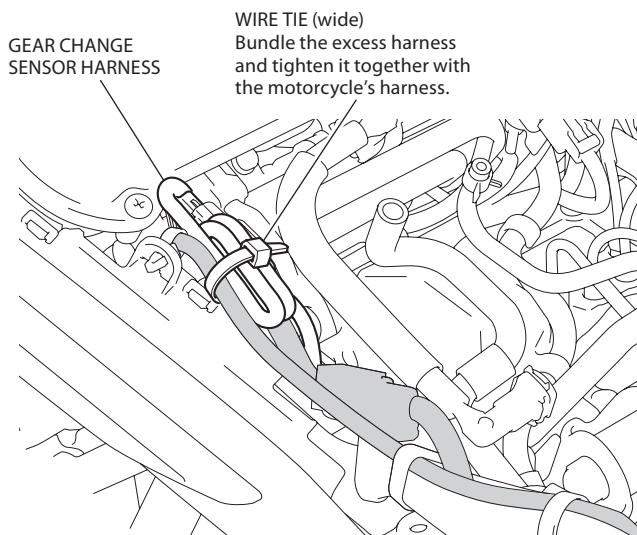

29. Install the motorcycle's parts in the reverse order of removal.

- Confirm that any wire harness is not caught or too tight.

30. Check the quick shifter for proper operation.

OPERATING INSTRUCTIONS

This accessory enable the shifting up without clutch operation when shifting up during acceleration (Engine speed is more than 1,500 rpm).

- If the gear position display is not normal, the shift feeling may change.
- When the shift change do not operate normally, the shift change by clutch operation can be operated.

<Shift up>

- Shifting up without clutch and throttle operations.

<Shift down>

- Make sure to operate clutch to shift down.

TROUBLESHOOTING

If you cannot shift up by operating the gear change pedal during acceleration (Engine speed is more than 1,500 rpm), a failure may occur. Please diagnose by following the procedure below.

